

अंतिम सिमांकन वाणिज्य प्रयोजनासाठी
 अकृषिक परवानगी कामी भूखंड आखणी मोजणी नकाशा
 प्रकरण क्र. विगरशेती मोर क्र. -163/2016
 दि 05/07/2016 अन्वये

DEMARKATED RE-REVISE WITH ADDL. AREA
 COMMERCIAL (Multiplex / Shopping Mall etc.)
 LAY-OUT PLAN FOR (PADDMAYATI DEVELOPERS)
 ON GUT NO. 207/E/PT, 208/B/PT. & 209/A/5/PT.
 AT-WADI "B" TQ. & DIST. - NANDED

SITE PLAN

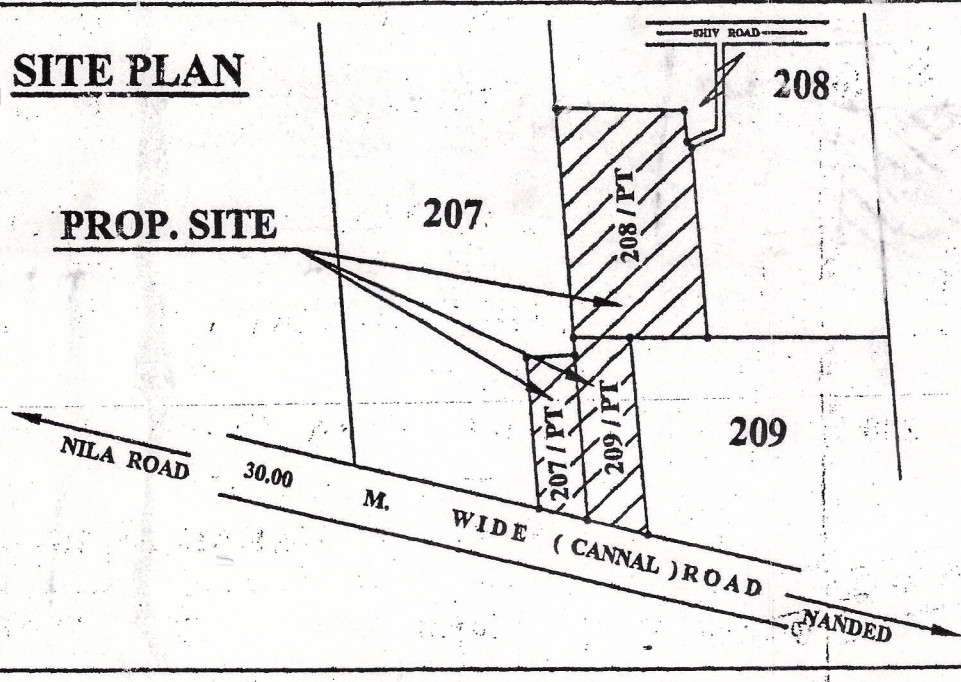

PADMAVATI DEVELOPER NAME	SIGNATURE
SHRI - BHARAT VISHVNATH RAMINWAR	भारत
SMT - MIRA BHARAT RAMINWAR	मीरा
SHRI - PADMAKAR BHARAT RAMINWAR	पद्मकर

AREA	STATEMENT	IN	SQ.M.
TOTAL AREA UNDER LAYOUT LAND	-----		12700.00
AREA UNDER ADDITIONAL AREA (ABCD)	-----		1647.12
AREA UNDER RE-REVISE LAY OUT	-----		11052.88
AREA UNDER OPEN SPACE	-----		1298.00
AREA UNDER LAY OUT ROAD	-----		854.00
AREA UNDER COMMERCIAL PLOTS	-----		10548.00

NET AREA FOR FSI CALCULATION

$$= \frac{90 \times (12700.00 - 0)}{100} = \frac{11430}{10548.00} = 1.08$$

PLOT WISE AREA STATEMENT

PLOT NO.	PLOT AREA	ROAD CURT.	NET PLOT AREA	EACH PLOT B/U ON PROFORMA BASIS
1	10548.0	-	10548.00	11391.84
TOTAL	10548.0		10548.00	-

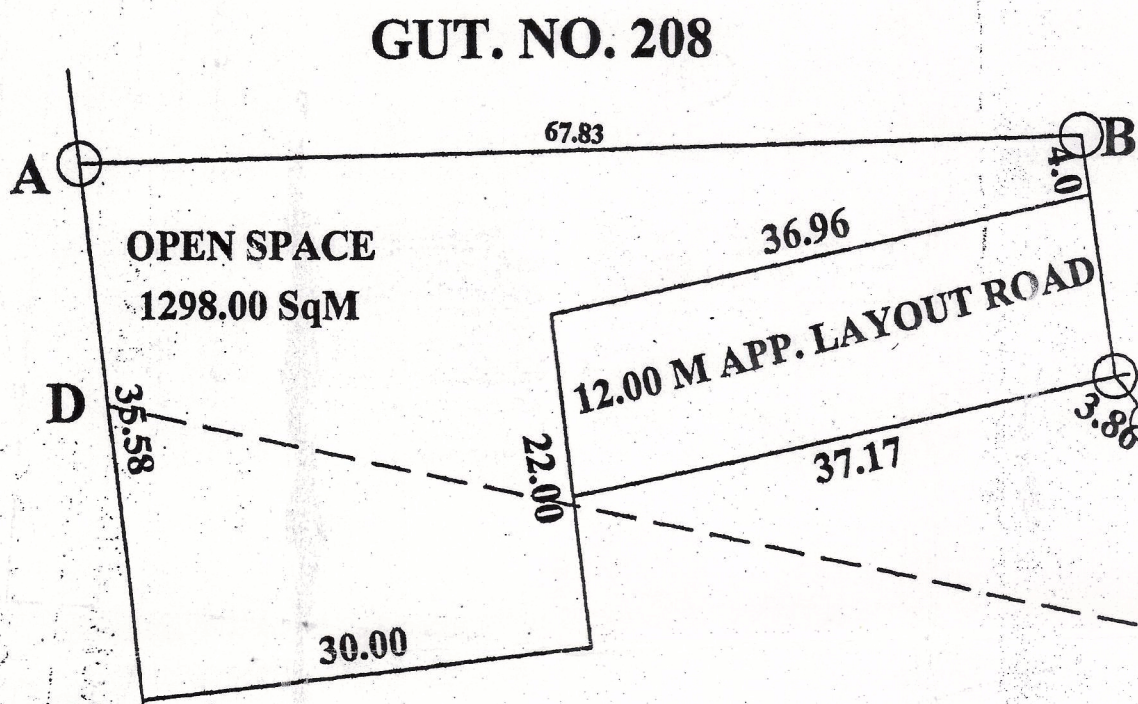

GUT NO. 208
 GUT NO. 208
 APPROVED COMM. LAY OUT WIDE
 LETTER NO.930 Dt.05/12/2014

GUT NO. 207
 UNDER CONSTRUCTION

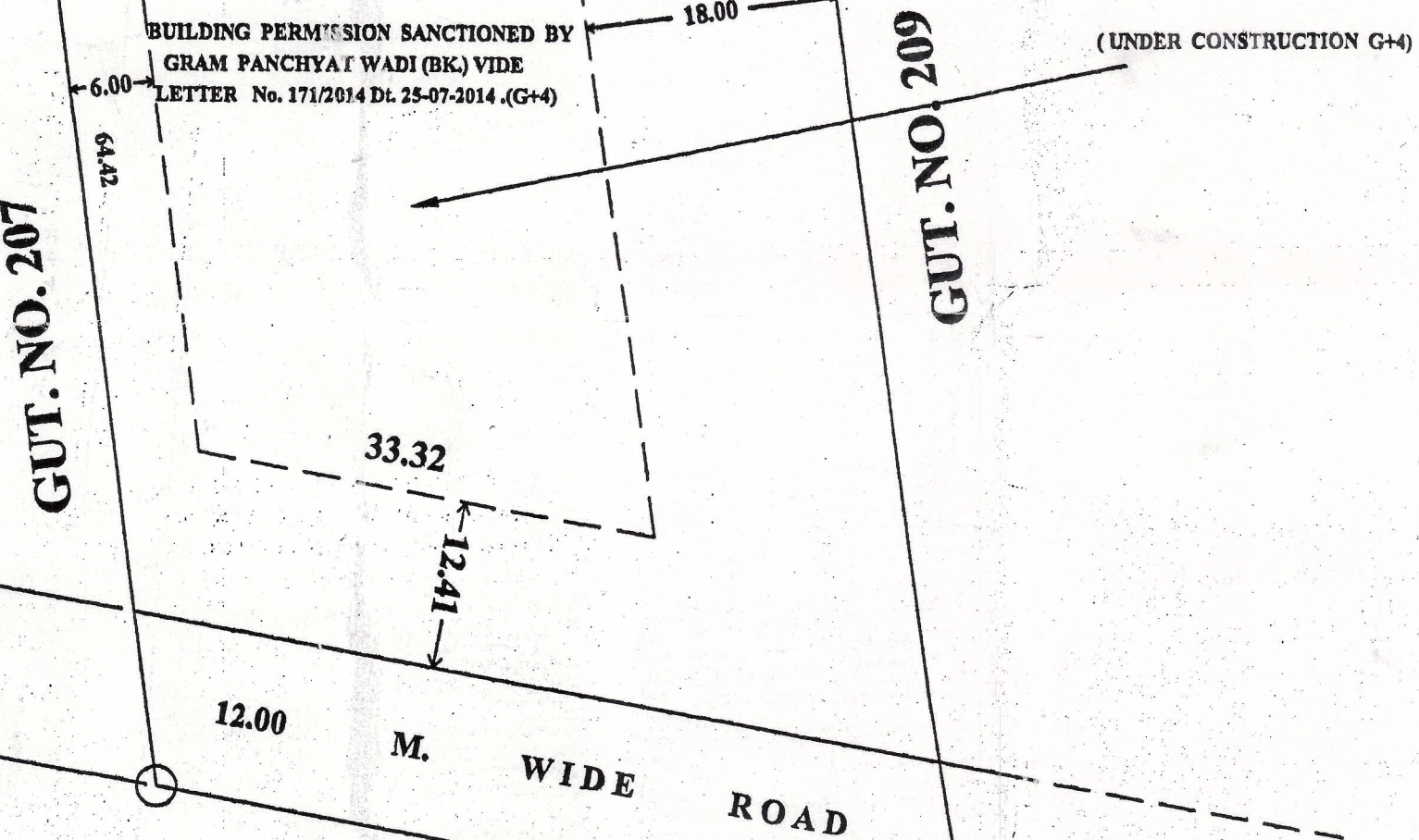

GUT NO. 207

GUT NO. 209



Finally recommended for approval as amended in _____ and subject to the conditions mentioned in this office letter No. _____ dated _____

767
 ASST. DIRECTOR OF TOWN PLANNING, NANDED

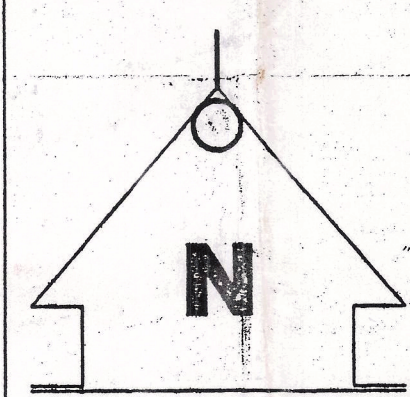

SCALE = 1 : 500

Ar. Shrihari Purohit
 18, Z.P. Shopping Complex, Nanded
 ARCHITECT'S SIGN.