



VASTUKALA
Unlocking Excellence

www.vastukala.co.in

MSME Reg No: UDYAM-MH-18-0083617

An ISO 9001 : 2015 Certified Company

CIN: U74120MH2010PTC207869

Vastukala Consultants (I) Pvt. Ltd.

Valuation Report of the Immovable Property



Details of the property under consideration:

Name of A/c: **Sahakar Global Ltd.**

Name of Owner: **Mr. Kishore Pravesh Agrawal & Mrs. Yogita Kishore Agrawal (Survey No. 126/2),
Mr. Karan Kishore Agrawal & Mr. Pranay Kishore Agrawal (Survey No. 6/6) &
Mr. Kishore Pravesh Agrawal (Survey No. 6/2/2C)**

N.A. Land bearing Survey No. 126/2, 6/6 & 6/2/2C at Village Dohole, Near Walia Dhaba, Mumbai Nashik Highway, Taluka - Bhiwandi, District Thane, PIN - 421 601, State - Maharashtra, Country - India.

Latitude Longitude: 19°22'46.0"N 73°12'11.1"E

Valuation Done for:

Union Bank of India

MID Corporate Branch Nariman Point

21, Veena Chambers, Mezzanine Floor, Dalal Street, Fort, Mumbai – 400 001,
State – Maharashtra, Country – India

Our Pan India Presence at :

- | | | | |
|------------|--------|-----------|-----------|
| Nanded | Thane | Ahmedabad | Delhi NCR |
| Mumbai | Nashik | Rajkot | Raipur |
| Aurangabad | Pune | Indore | Jaipur |

Regd. Office

BI-001, U/B Floor, BOOMERANG, Chandivali Farm Road, Powai, Andheri East, **Mumbai:** 400072, (M.S), India

+91 2247495919

mumbai@vastukala.co.in

www.vastukala.co.in





VASTUKALA
Unlocking Excellence

www.vastukala.co.in

MSME Reg No: UDYAM-MH-18-0083617

An ISO 9001 : 2015 Certified Company

CIN: U74120MH2010PTC207869

Vastukala Consultants (I) Pvt. Ltd.

Valuation Report Prepared for: UBI / MID Corporate Branch / Mr. Kishore P. Agrawal (13493/2310096)

Page 2 of 26

Vastu/Mumbai/01/2025/13493/2310096

17/11-215-V

Date: 17.01.2025

VALUATION OPINION REPORT

This is to certify that the N.A. Land bearing Survey No. 126/2, 6/6 & 6/2/2C at Village Dohole, Near Walia Dhaba, Mumbai Nashik Highway, Taluka - Bhiwandi, District Thane, PIN - 421 601, State - Maharashtra, Country - India belongs to **Mr. Kishore Pravesh Agrawal & Mrs. Yogita Kishore Agrawal (Survey No. 126/2), Mr. Karan Kishore Agrawal & Mr. Pranay Kishore Agrawal (Survey No. 6/6) & Mr. Kishore Pravesh Agrawal (Survey No. 6/2/2C).**

Boundaries of the property.

| | | |
|-------|---|---|
| North | : | Bhokri Village & Open Land |
| South | : | Nashik Mumbai Highway & Baldevsingh Walia Dhaba |
| East | : | Open Plot & Dohole Village Road |
| West | : | Appeal & Antariksh Godowns |

Considering various parameters recorded, existing economic scenario, and the information that is available with reference to the development of neighborhood and method selected for valuation, we are of the opinion that, the property premises can be assessed and valued for the purpose at:

| Particulars | Fair Market Value (₹) | Realizable Value (₹) | Distress Sale Value (₹) |
|-------------|--------------------------|-------------------------|----------------------------|
| Open Land | 10,57,94,500.00 | 9,52,15,050.00 | 8,46,35,600.00 |

The valuation of the property is based on the documents produced by the concerned. Legal aspects have not been taken into consideration while preparing this valuation report.

Hence certified

For VASTUKALA CONSULTANTS (I) PVT. LTD.

Director

Sharadkumar B. Chalikwar

Govt. Reg. Valuer

Chartered Engineer (India)

Reg. No. (N) CCIT/1-14/52/2008-09

UBI Emp No. ROS:ADV:Valuer/033:008:2021-22

Encl: Valuation report.

Auth. Sign.



Our Pan India Presence at :

- | | | | |
|------------|--------|-----------|-----------|
| Nanded | Thane | Ahmedabad | Delhi NCR |
| Mumbai | Nashik | Rajkot | Raipur |
| Aurangabad | Pune | Indore | Jaipur |

Regd. Office

BI-001, U/B Floor, BOOMERANG, Chandivali Farm Road, Powai, Andheri East, **Mumbai:** 400072, (M.S), India

+91 2247495919

mumbai@vastukala.co.in

www.vastukala.co.in

Vastukala Consultants (I) Pvt. Ltd.B1-001, U/B Floor, **Boomerang**, Chandivali Farm Road, Powai, Andheri (East), Mumbai – 400 072

To,

The Branch Manager,**Union Bank of India****MID Corporate Branch Nariman Point**

21, Veena Chambers, Mezzanine Floor, Dalal Street, Fort, Mumbai – 400 001,

State – Maharashtra, Country – India.

VALUATION REPORT (IN RESPECT OF OPEN PLOT)

| I | General | | | | | | | | | | | | | | | | | | | | | |
|--------------|--|---|---------------------|--------------------------------|------------|---------------------|------------|---|-------|---------|------------|--|-----|---------|------------|-----------------------------|--------|---------|--------------|--|--|-----------------|
| 1. | Purpose for which the valuation is made | : As per the request from Union Bank of India, Mid Corporate Branch Nariman Point to assess Market value of the property for Bank Loan purpose. | | | | | | | | | | | | | | | | | | | | |
| 2. | a) | Date of inspection : 10.01.2025 | | | | | | | | | | | | | | | | | | | | |
| | b) | Date on which the valuation is made : 17.01.2025 | | | | | | | | | | | | | | | | | | | | |
| 3. | Copy of List of documents produced for perusal | : | | | | | | | | | | | | | | | | | | | | |
| | 1. Copy of Deed of Conveyance date 23.06.2017 b/w. Mr. Kishore Pravesh Agrawal (the Purchaser) AND Smt. Anandibai Damu Gharat (the Vendor) (Survey No. 6/2/2C) 2. Copy of Deed of Conveyance date 23.06.2017 b/w. Mr. Karan Kishore Agrawal & Mr. Pranay Kishore Agrawal (the Purchasers) AND Smt. Anandibai Damu Gharat (the Vendor) (Survey No. 6/6) 3. Copy of Deed of Conveyance date 28.01.2016 b/w. Mrs. Bhimabai Ramkrushna Gharat (the Vendor) AND Mr. Kishore Pravesh Agrawal & Mrs. Yogita Kishore Agrawal (the Purchasers) (Survey No. 126/2) 4. Copy of N.A. Order from District Collector Thane No. Mahasul / K – 1 / T-8 / BP / Dohole – Bhiwandi / SR -62/2021 date 06.08.2024 (Survey No. 126/2), 6/6 & 6/2/2C 5. Copy of 7/12 Extract are as under: <table border="1" data-bbox="347 1400 1268 1702"> <thead> <tr> <th>Date</th> <th>As per 7/12 Extract Owner Name</th> <th>Survey No.</th> <th>Land Area in Sq. M.</th> </tr> </thead> <tbody> <tr> <td>03.09.2024</td> <td>Mr. Kishore Pravesh Agrawal & Mrs. Yogita Kishore Agrawal</td> <td>126/2</td> <td>9000.00</td> </tr> <tr> <td>03.09.2024</td> <td>Mr. Karan Kishore Agrawal & Mr. Pranay Kishore Agrawal</td> <td>6/6</td> <td>2000.00</td> </tr> <tr> <td>03.09.2024</td> <td>Mr. Kishore Pravesh Agrawal</td> <td>6/2/2C</td> <td>1670.00</td> </tr> <tr> <td colspan="3" style="text-align: center;">Total</td> <td>12670.00</td> </tr> </tbody> </table> | | Date | As per 7/12 Extract Owner Name | Survey No. | Land Area in Sq. M. | 03.09.2024 | Mr. Kishore Pravesh Agrawal & Mrs. Yogita Kishore Agrawal | 126/2 | 9000.00 | 03.09.2024 | Mr. Karan Kishore Agrawal & Mr. Pranay Kishore Agrawal | 6/6 | 2000.00 | 03.09.2024 | Mr. Kishore Pravesh Agrawal | 6/2/2C | 1670.00 | Total | | | 12670.00 |
| Date | As per 7/12 Extract Owner Name | Survey No. | Land Area in Sq. M. | | | | | | | | | | | | | | | | | | | |
| 03.09.2024 | Mr. Kishore Pravesh Agrawal & Mrs. Yogita Kishore Agrawal | 126/2 | 9000.00 | | | | | | | | | | | | | | | | | | | |
| 03.09.2024 | Mr. Karan Kishore Agrawal & Mr. Pranay Kishore Agrawal | 6/6 | 2000.00 | | | | | | | | | | | | | | | | | | | |
| 03.09.2024 | Mr. Kishore Pravesh Agrawal | 6/2/2C | 1670.00 | | | | | | | | | | | | | | | | | | | |
| Total | | | 12670.00 | | | | | | | | | | | | | | | | | | | |
| | 6. Copy of N.A. Order No. SD. BP / Village – Dohole / Taluka – Bhiwandi / Survey No. 124/6 & others / SSThane / 2781 date 24.07.2024 issued by Assistant Director Town Planning Thane | | | | | | | | | | | | | | | | | | | | | |
| | 7. Copy of Approved Plan No. BS / SD / BP / Village - Dohole / Taluka - Bhiwandi / SSThane / 2781 dated 24.07.2024 issued by Assistant Director of Town Planning Thane. | | | | | | | | | | | | | | | | | | | | | |
| | Name of the owner(s) and his / their address (es) with Phone no. (details of share of each owner in case of joint ownership) | : Mr. Kishore Pravesh Agrawal & Mrs. Yogita Kishore Agrawal (Survey No. 126/2), Mr. Karan Kishore Agrawal & Mr. Pranay Kishore | | | | | | | | | | | | | | | | | | | | |

| | | | Agrawal (Survey No. 6/6) & Mr. Kishore Pravesh Agrawal (Survey No. 6/2/2C) Address: N.A. Land bearing Survey No. 126/2, 6/6 & 6/2/2C at Village Dohole, Near Walia Dhaba, Mumbai Nashik Highway, Taluka - Bhiwandi, District Thane, PIN - 421 601, State - Maharashtra, Country - India Contact Person: Mr. Omkar Pawar (Manager) Contact No.: + 8291925646 Joint Ownership (Survey No. 126/2 & Survey No. 6/6) Sole Ownership (Survey No. 6/2/2C) | | | | | | | | | | | | | | | |
|--------------|--|---------------------|---|---------|------------|---------------------|---|-------|---------|---|-----|---------|---|--------|---------|--------------|--|------------------|
| 5. | Brief description of the property (Including Leasehold / freehold etc.) | : | | | | | | | | | | | | | | | | |
| | <p>Property: The immovable property under valuation is a N.A. Land bearing Survey No. 126/2, 6/6 & 6/2/2C at Village Dohole, Near Walia Dhaba, Mumbai Nashik Highway, Taluka - Bhiwandi, District Thane, PIN - 421 601, State - Maharashtra, Country - India. The property is located in a developing area having basic infrastructure, well connected by road. The property is at 28.1 KM. travel distance from Kalyan Railway Station.</p> <p>Land: As per Approved Plan & 7/12 Extract, the Plot area is as under and considered for valuation.</p> <table border="1"> <thead> <tr> <th>Sr. No.</th> <th>Survey No.</th> <th>Plot area in Sq. M.</th> </tr> </thead> <tbody> <tr> <td>1</td> <td>126/2</td> <td>9000.00</td> </tr> <tr> <td>2</td> <td>6/6</td> <td>2000.00</td> </tr> <tr> <td>3</td> <td>6/2/2C</td> <td>1670.00</td> </tr> <tr> <td colspan="2">Total</td> <td>12,670.00</td> </tr> </tbody> </table> <p>Note: At the time of inspection, we observed that structure area is in poor and dilapidated condition and vegetation has been grown on the site. Hence not considered the structure area for the purpose of valuation.</p> | | | Sr. No. | Survey No. | Plot area in Sq. M. | 1 | 126/2 | 9000.00 | 2 | 6/6 | 2000.00 | 3 | 6/2/2C | 1670.00 | Total | | 12,670.00 |
| Sr. No. | Survey No. | Plot area in Sq. M. | | | | | | | | | | | | | | | | |
| 1 | 126/2 | 9000.00 | | | | | | | | | | | | | | | | |
| 2 | 6/6 | 2000.00 | | | | | | | | | | | | | | | | |
| 3 | 6/2/2C | 1670.00 | | | | | | | | | | | | | | | | |
| Total | | 12,670.00 | | | | | | | | | | | | | | | | |
| 6. | Location of property | : | | | | | | | | | | | | | | | | |
| | a) Plot No. / Survey No. | : | Survey Nos. 126/2, 6/6 & 6/2/2C | | | | | | | | | | | | | | | |
| | b) Door No. | : | N.A. | | | | | | | | | | | | | | | |
| | c) T.S. No. / Village | : | Village - Dohole | | | | | | | | | | | | | | | |
| | d) Ward / Taluka | : | Taluka - Bhiwandi | | | | | | | | | | | | | | | |
| | e) Mandal / District | : | District Thane | | | | | | | | | | | | | | | |
| 7. | Postal address of the property | : | N.A. Land bearing Survey No. 126/2, 6/6 & 6/2/2C at Village Dohole, Near Walia Dhaba, Mumbai Nashik Highway, Taluka - Bhiwandi, District Thane, PIN - 421 601, State - Maharashtra, Country - India | | | | | | | | | | | | | | | |
| 8. | City / Town | : | Bhiwandi | | | | | | | | | | | | | | | |

| | | | | | |
|------|---|---|---|----------------------------|---|
| | Residential area | : | No | | |
| | Commercial area | : | No | | |
| | Industrial area | : | Yes | | |
| 9. | Classification of the area | : | | | |
| | i) High / Middle / Poor | : | Middle Class | | |
| | ii) Urban / Semi Urban / Rural | : | Semi Urban | | |
| 10. | Coming under Corporation limit / Village Panchayat / Municipality | : | Village - Dohole | | |
| 11. | Whether covered under any State / Central Govt. enactments (e.g., Urban Land Ceiling Act) or notified under agency area/ scheduled area / cantonment area | : | No | | |
| 12. | In Case it is Agricultural land, any conversion to house site plots is contemplated | : | N.A. | | |
| 13. | Boundaries of the property | As per the Documents | | | Actual |
| | | Survey No. 126/2 | Survey No. 6/6 | Survey No. 6/2/2C | |
| | North | Village Bhikari Road | Mr. Kishore P. Agrawal | Mr. Kishore P. Agrawal | Bhokri Village & Open Land |
| | South | Property Belonging to Kishor P. Agarwal | Mr. Kishore P. Agrawal | Mr. Kishore P. Agrawal | Nashik Mumbai Highway & Baldevsingh Walia Dhaba |
| | East | Survey No. 126/5 (p) | Mr. Kishore P. Agrawal | Mr. Kishore P. Agrawal | Open Plot & Dohole Village Road |
| West | Survey No. 126/3, 126/4b, 126/6 | Mr. Kishore P. Agrawal | Mr. Kishore P. Agrawal | Appeal & Antariksh Godowns | |
| 14.1 | Dimensions of the site | | | | |
| | | | A As per the Agreement | B Actuals | |
| | North | : | | | |
| | South | : | | | |
| | East | : | | | |
| | West | : | | | |
| 14.2 | Latitude, Longitude & Co-ordinates of Property | : | 19°22'46.0"N 73°12'11.1"E | | |
| 15. | Extent of the site | : | Total Plot Area = 12,670.00 Sq. M. (As per Approved Plan & 7/12 extract) | | |
| 16. | Extent of the site considered for Valuation (least of 14A& 14B) | : | Total Plot Area = 12,670.00 Sq. M. (As per Approved Plan & 7/12 extract) | | |
| 17. | Whether occupied by the owner / tenant? If | : | N.A. as the property is an Open Land | | |

| | | |
|-------------------------------------|--|---|
| | occupied by tenant since how long? Rent received per month. | |
| II | CHARACTERSTICS OF THE SITE | |
| 1. | Classification of locality | : Located in Middle class locality |
| 2. | Development of surrounding areas | : Developing Industrial area |
| 3. | Possibility of frequent flooding/ sub-merging | : No |
| 4. | Feasibility to the Civic amenities like School, Hospital, Bus Stop, Market etc. | : All available at the radius of 2 – 4 Km. |
| 5. | Level of land with topographical conditions | : Plain |
| 6. | Shape of land | : Irregular |
| 7. | Type of use to which it can be put | : For Industrial purpose |
| 8. | Any usage restriction | : Industrial |
| 9. | Is plot in town planning approved layout? | : Copy of Approved Plan No. BS / SD / BP / Village - Dohole / Taluka - Bhiwandi / SSThane / 2781 dated 24.07.2024 issued by Assistant Director of Town Planning Thane |
| 10. | Corner plot or intermittent plot? | : Intermittent Plot |
| 11. | Road facilities | : |
| 12. | Type of road available at present | : B. T. Road |
| 13. | Width of road – is it below 20 ft. or more than 20 ft. | : More than 20 ft. |
| 14. | Is it a Land – Locked land? | : No |
| 15. | Water potentiality | : Yes |
| 16. | Underground sewerage system | : N.A. as the property is open plot |
| 17. | Is Power supply available in the site | : Yes |
| 18. | Advantages of the site | : Located in developing Industrial area |
| 19. | Special remarks, if any like threat of acquisition of land for publics service purposes, road widening or applicability of CRZ provisions etc. (Distance from sea-cost / tidal level must be incorporated) | : No |
| Part – A (Valuation of land) | | |
| 1 | Size of plot | : Total Plot Area = 12,670.00 Sq. M. (As per Approved Plan & 7/12 extract) |
| | North & South | : - |
| | East & West | : - |
| 2 | Total extent of the plot | : Total Plot Area = 12,670.00 Sq. M. (As per Approved Plan & 7/12 extract) |
| 3 | Prevailing market rate (Along With details / reference of at least two latest deals / transactions with respect to adjacent properties in the areas) | : ₹ 6,000.00 to ₹ 9,000.00 per Sq. M. for Land Details of online listings are attached with the report. |
| 4 | Guideline rate obtained from the Register's Office (evidence thereof to be enclosed) | : ₹ 1,970.00 per Sq. M. for Land |

| | | | |
|---|---|---|--|
| | Guideline Value | : | ₹ 2,49,59,900.00 |
| 5 | Assessed / adopted rate of valuation | : | ₹ 8,350.00 per Sq. M. |
| 6 | Estimated value of land | : | ₹ 10,57,94,500.00 |
| Part – B (Valuation of Building) | | | |
| 1 | Technical details of the building | : | |
| | a) Type of Building (Residential / Commercial / Industrial) | : | N.A. as the property is an open plot |
| | b) Type of construction (Load bearing / RCC / Steel Framed) | : | N.A. as the property is an open plot |
| | c) Year of construction | : | N.A. as the property is an open plot |
| | d) Number of floors and height of each floor including basement, if any | : | N.A. as the property is an open plot |
| | e) Plinth area floor-wise | : | N.A. as the property is an open plot |
| | f) Condition of the building | : | N.A. as the property is an open plot |
| | i) Exterior – Excellent, Good, Normal, Poor | : | N.A. as the property is an open plot |
| | ii) Interior – Excellent, Good, Normal, Poor | : | N.A. as the property is an open plot |
| | g) Date of issue and validity of layout of approved map | : | Copy of Approved Plan No. BS / SD / BP / Village - Dohole / Taluka - Bhiwandi / SStane / 2781 dated 24.07.2024 issued by Assistant Director of Town Planning Thane |
| | h) Approved map / plan issuing authority | : | |
| | i) Whether genuineness or authenticity of approved map / plan is verified | : | |
| | j) Any other comments by our empaneled valuers on authenticity of approved plan | : | No |

Specifications of construction (floor-wise) in respect of

| Sr. No. | Description | Amount in ₹ |
|---------|--|--|
| 1. | Foundation | : N.A. as the property is an open plot |
| 2. | Basement | : N.A. as the property is an open plot |
| 3. | Superstructure | : N.A. as the property is an open plot |
| 4. | Joinery / Doors & Windows (Please furnish details about size of frames, shutters, glazing, fitting etc. and specify the species of timber) | : N.A. as the property is an open plot |
| 5. | RCC Works | : N.A. as the property is an open plot |
| 6. | Plastering | : N.A. as the property is an open plot |
| 7. | Flooring, Skirting, dado | : N.A. as the property is an open plot |
| 8. | Special finish as marble, granite, wooden paneling, grills etc. | : N.A. as the property is an open plot |
| 9. | Roofing including weather proof course | : N.A. as the property is an open plot |
| 10. | Drainage | : Connected to municipal sewerage |

| | | | |
|-----------|--|---|--------------------------------------|
| 2. | Compound Wall | : | Amount in ₹ |
| | Height | : | RCC brick masonry wall |
| | Length | : | |
| | Type of construction | : | |
| 3. | Electrical installation | : | N.A. as the property is an open plot |
| | Type of wiring | : | - |
| | Class of fittings (superior / ordinary / poor) | : | - |
| | Number of light points | : | - |
| | Fan points | : | - |
| | Spare plug points | : | - |
| | Any other item | : | - |
| 4. | Plumbing installation | : | Amount in ₹ |
| | a) No. of water closets and their type | : | N.A. as the property is an open plot |
| | b) No. of wash basins | : | - |
| | c) No. of urinals | : | - |
| | d) No. of bath tubs | : | - |
| | e) Water meters, taps etc. | : | - |
| | f) Any other fixtures | : | - |

| | | | |
|-------------------------------|--------------------------------------|---|--------------------------------------|
| Part – C (Extra Items) | | : | Amount in ₹ |
| 1. | Portico | : | N.A. as the property is an open plot |
| 2. | Ornamental front door | : | - |
| 3. | Sit out / Verandah with steel grills | : | - |
| 4. | Overhead water tank | : | - |
| 5. | Extra steel / collapsible gates | : | - |
| | Total | : | - |

| | | | |
|-----------------------------|---------------------------------|---|--------------------------------------|
| Part – D (Amenities) | | : | Amount in ₹ |
| 1. | Wardrobes | : | N.A. as the property is an Open Land |
| 2. | Glazed tiles | : | - |
| 3. | Extra sinks and bath tub | : | - |
| 4. | Marble / ceramic tiles flooring | : | - |
| 5. | Interior decorations | : | - |
| 6. | Architectural elevation works | : | - |
| 7. | Paneling works | : | - |
| 8. | Aluminum works | : | - |
| 9. | Aluminum hand rails | : | - |
| 10. | False ceiling | : | - |
| | Total | : | - |

| Part – E (Miscellaneous) | | : | Amount in ₹ |
|--------------------------|----------------------------|---|--------------------------------------|
| 1. | Separate toilet room | : | N.A. as the property is an Open Land |
| 2. | Separate lumber room | : | - |
| 3. | Separate water tank / sump | : | - |
| 4. | Trees, gardening | : | - |
| | Total | | - |

| Part – F (Services) | | : | Amount in ₹ |
|---------------------|------------------------------|---|--------------------------------------|
| 1. | Water supply arrangements | : | N.A. as the property is an Open Land |
| 2. | Drainage arrangements | : | - |
| 3. | Compound wall | : | - |
| 4. | C.B. deposits, fittings etc. | : | - |
| 5. | Pavement | : | - |
| | Total | | - |

Government Value

| Particulars | Land Area in Sq. M. | Rate in ₹ | Value in ₹ |
|-------------|---------------------|-----------|----------------|
| Land | 12,670.00 | 1970.00 | 2,49,59,900.00 |

Total abstract of the entire property

| | | | |
|----------------|--|---|--|
| Part – A | Land | : | ₹ 10,57,94,500.00 |
| Part – B | Building | : | - |
| Part – C | Compound wall | : | - |
| Part – D | Amenities | : | - |
| Part – E | Pavement | : | - |
| Part – F | Services | : | - |
| | Market Value | : | ₹ 10,57,94,500.00 |
| | Realizable Value | : | ₹ 9,52,15,050.00 |
| | Distress Sale Value | : | ₹ 8,46,35,600.00 |
| | Value as per Circle Rate | : | ₹ 2,49,59,900.00 |
| | Insurable value (Full Replacement Cost - Subsoil Structure Cost (15%)) | : | N.A. being valuation of plot of land only |
| Remarks | <p>1. <u>At the time of inspection, we observed that structure area is in poor and dilapidated condition and vegetation has been grown on the site. Hence not considered the structure area for the purpose of valuation.</u></p> <p>2. <u>For the purpose of valuation, we have considered the land area as per Approved Plan & 7/12 Extract.</u></p> | | |

- Land cost can be estimated using the Sales Comparison Approach by studying recent sales of land close to the subject property, and these sales should be comparable in size and location with subject property.
- It may be noted that the Govt. guideline values are for Stamp duty purpose, they are generally constant along a particular road i.e., it doesn't take into account the advantage/disadvantage of particular property vis-a-vis its

locations. Rate of land parcels vary from site to site and within a site from macro-site to micro-site. That is why our valuation differs from Govt. stamp duty ready reckoner value.

- As the property is an open land, we have adopted Sales Comparison Method for the purpose of valuation. The Price for similar type of property in the nearby vicinity is in the range of ₹ 6,000.00 to ₹ 9,000.00 per Sq. M. for land.
- Considering the rate with attached report, current market conditions, demand and supply position, Land size, location, upswing in real estate prices, sustained demand for Plot, all round development of commercial and Industrial application in the locality etc., we estimate ₹ 8,350.00 per Sq. M. for valuation of Land.
- The salability of the property is: Average
- Likely rental values in future in Amount: N.A.
- Any likely income it may generate: N.A.



Actual Site Photographs



Actual Site Photographs



Route Map of the property

Site u/r

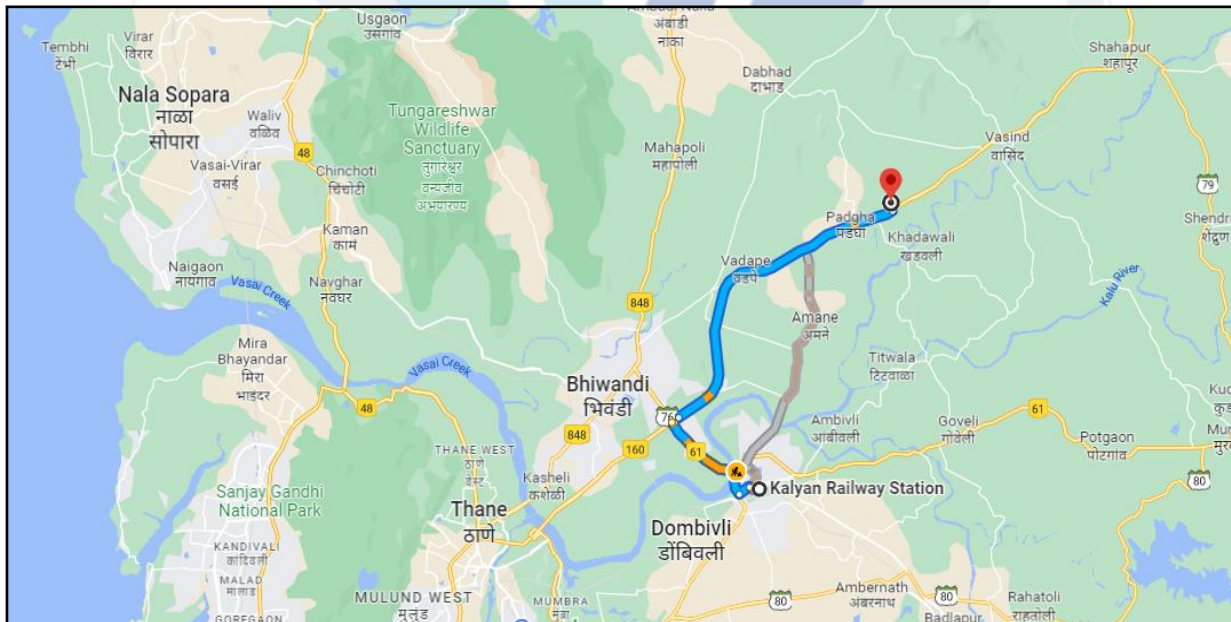

Latitude Longitude: 19°22'46.0"N 73°12'11.1"E

Note: The Blue line shows the route to site from nearest Railway Station (Kalyan – 28.1 Km)

Ready Reckoner Rate



Department of Registration and Stamp
Government of Maharashtra

नोंदणी व मुद्रांक विभाग
महाराष्ट्र शासन



Annual Statement of Rates Ver. 2.0 (बाजारमूल्य दर पत्रक आवृत्ती 2.0)

[Home](#)
[Valuation Guidelines | User Manual](#)

Year Language

Selected District

Select Taluka

Select Village

Vibhag Number **7**

| Assesment Type | Assesment Range | Rate Rs/- | Unit |
|--|-----------------|-----------|-----------|
| दुकाने | 0-0 | 32000 | चौरस मीटर |
| कार्यालये | 0-0 | 30600 | चौरस मीटर |
| गावठाणातील मिळकती | 0-0.00 | 2610 | चौरस मीटर |
| हायवेवरील जमिनी | 0-0 | 2000 | चौरस मीटर |
| विनशेती जमीनी/भूखंड | 0-0 | 1970 | चौरस मीटर |
| औद्योगिक विनशेती जमिनी | 0-0.00 | 2850 | चौरस मीटर |
| महाराष्ट्र औद्योगिक विकास क्षेत्र (MIDC)औद्योगिक | 0-0.00 | 4000 | चौरस मीटर |

12

Survey Map

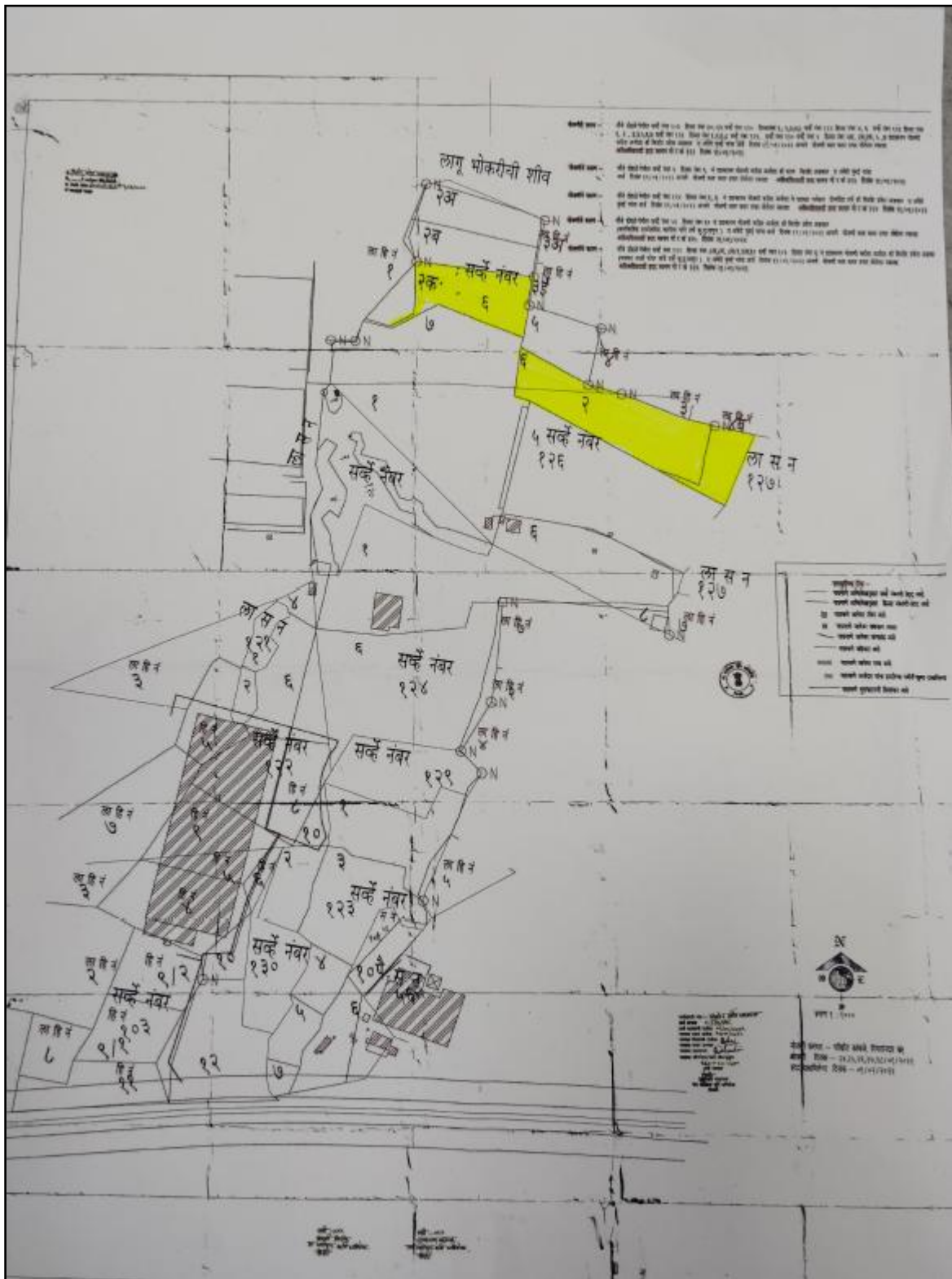

Price Indicators

99acres
Commercial Buy | Enter Locality / Project / Society / Landmar

Home > Commercial land for sale in Thane Outskirts > Industrial land for sale in Thane Outskirts > Industrial land for sale in Bhiwandi

₹ 8 Cr @ 4,00,00,000 per acres
Estimated EMI ₹ 6,38,963

Industrial Lands/Plots for Sale
 in Bhiwandi, Thane

[Contact Dealer FREE](#)

[Shortlist](#)

RERA STATUS NOT AVAILABLE | Website: <https://maharera.maharashtra.gov.in/>

[Overview](#) | [Dealer Details](#) | [Recommendations](#)

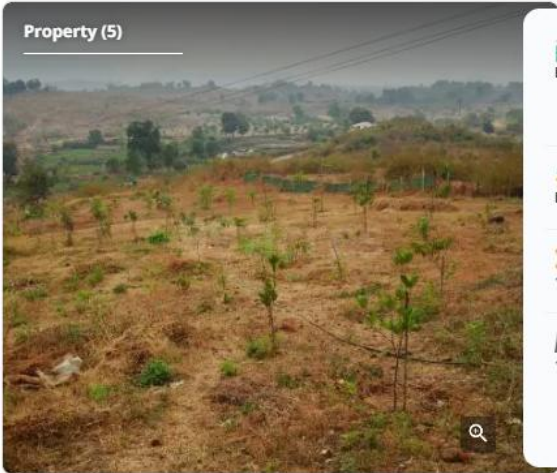

Property (5)

Area
Plot area 8096.65 sq.m.

Price
₹ 8 Crore
@ 4,00,00,000 per acres (Negotiable) [View Price Details](#)

Address
Bhiwandi, Thane

Facing
East

No. of Open Sides
1

Possession
Immediate

Width of facing road
164.0 Feet

Places nearby [View All \(14\)](#)

Vadpe, Bhiwandi, Thane

[MEETESH CHOUDHARI HOUSE NEAR AGNIMATA TEMPLE TEMGHAR](#)
[Shushrusha Hospital Thane](#)
[Lotus Hospital](#)
[Guru Kr](#)

Price Indicators

magicbricks Buy ▾ Rent ▾ Sell ▾ Home Loans ▾

₹5.20 Cr EMI - ₹2.35L | [Get Loan offers from 34+ banks](#)

Industrial Land For Sale in [Anjurphata, Bhiwandi](#) [View on map](#)

 Plot Area
6525 sqm ▾ Transaction Type
Resale

[Contact Owner](#) [Get Phone No.](#) 👤 Last contact made 3 days ago

More Details

Price ₹5.2 Cr

Address Bhiwandi, Maharashtra

[Contact Owner](#)

As a result of my appraisal and analysis, it is my considered opinion that the present Market value of the above property in the prevailing condition with aforesaid specifications is **₹ 10,57,94,500.00 (Rupees Ten Crore Fifty Seven Lakh Ninety Four Thousand Five Hundred Only)**. The **Realizable Value** of the above property is **₹ 9,52,15,050.00 (Rupees Nine Crore Fifty Two Lakh Fifteen Thousand Fifty Only)** and the **Distress Value** is **₹ 8,46,35,600.00 (Rupees Eight Crore Forty Six Lakh Thirty Five Thousand Six Hundred Only)**.

Place: Mumbai

Date: 17.01.2025

For VASTUKALA CONSULTANTS (I) PVT. LTD.

Director

Auth. Sign.

Sharadkumar B. Chalikwar

Govt. Reg. Valuer

Chartered Engineer (India)

Reg. No. (N) CCIT/1-14/52/2008-09

UBI Emp No. ROS:ADV:Valuer/033:008:2021-22

The undersigned has inspected the property detailed in the Valuation Report dated _____

on _____. We are satisfied that the fair and reasonable market value of the property is

₹ _____ (Rupees _____

_____ only).

Date

Signature

(Name of the Branch Manager with Official seal)

| Enclosures | |
|--|----------|
| Declaration From Valuers (Annexure- I) | Attached |
| Model code of conduct for valuer - (Annexure II) | Attached |

Annexure-I

DECLARATION FROM VALUERS

I, Sharadkumar B. Chalikwar son of Shri. Baburao Chalikwar hereby declare that:

- a. The information furnished in my valuation report dated 17.01.2025 is true and correct to the best of my knowledge and belief and I have made an impartial and true valuation of the property.
- b. I have no direct or indirect interest in the property valued;
- c. I/ my authorized representative have personally inspected the property on 10.01.2025. The work is not sub - contracted to any other valuer and carried out by myself.
- d. I have not been convicted of any offence and sentenced to a term of Imprisonment;
- e. I have not been found guilty of misconduct in my professional capacity.
- f. I have read the Handbook on Policy, Standards and procedure for Real Estate Valuation, 2011 of the IBA and this report is in conformity to the "Standards" enshrined for valuation in the Part - B of the above handbook to the best of my ability.
- g. I have read the International Valuation Standards (IVS) and the report submitted to the Bank for the respective asset class is in conformity to the "Standards" as enshrined for valuation in the IVS in "General Standards" and "Asset Standards" as applicable. The valuation report is submitted in the prescribed format of the bank.
- h. I abide by the Model Code of Conduct for empanelment of valuer in the Bank. (Annexure III - A signed copy of same to be taken and kept along with this declaration)
- i. I am Director of the company, who is competent to sign this valuation report.
- j. Further, I hereby provide the following information.

| Sr. No. | Particulars | Valuer comment |
|---------|---|--|
| 1. | Background information of the asset being valued; | The property under consideration is owned by Mr. Kishore Pravesh Agrawal & Mrs. Yogita Kishore Agrawal (Survey No. 126/2), Mr. Karan Kishore Agrawal & Mr. Pranay Kishore Agrawal (Survey No. 6/6) & Mr. Kishore Pravesh Agrawal (Survey No. 6/2/2C) |
| 2. | Purpose of valuation and appointing authority | As per the request from Union Bank of India, MID Corporate Branch Nariman Point for Bank Loan purpose. |
| 3. | Identity of the valuer and any other experts involved in the valuation; | Sharadkumar B. Chalikwar – Regd. Valuer Mr. Manoj B. Chalikwar - Regd. Valuer Ajay Rewale – Valuation Engineer Vinita Surve – Technical Manager |
| 4. | Disclosure of valuer interest or conflict, if any; | We have no interest, either direct or indirect, in the property valued. Further to state that we do not have relation or any connection with property owner / applicant directly or indirectly. Further to state that we are an independent Valuer and in no way related to property owner / applicant |
| 5. | Date of appointment, valuation date and date of report; | Date of Appointment – 10.01.2025 Valuation Date – 17.01.2025 Date of Report - 17.01.2025 |
| 6. | Inspections and/or investigations undertaken; | Physical Inspection done on 10.01.2025 |
| 7. | Nature and sources of the information used or relied upon; | <ul style="list-style-type: none"> • Market Survey at the time of site visit • Ready Reckoner rates / Circle rates • Online Price Indicators on real estate portals • Enquiries with Real estate consultants • Existing data of Valuation assignments carried out by us |
| 8. | Procedures adopted in carrying out the valuation and valuation standards followed; | Sales Comparison Method (For Land component) |
| 9. | Restrictions on use of the report, if any; | This valuation is for the use of the party to whom it is addressed and for no other purpose. No responsibility is accepted to any third party who may use or rely on the whole or any part of this valuation. The valuer has no pecuniary interest that would conflict with the proper valuation of the property. |
| 10. | Major factors that were taken into account during the valuation; | current market conditions, demand and supply position, Land size, location, upswing in real estate prices, sustained demand for open Land, all round development of commercial and Industrial application in the locality etc. |
| 11. | Major factors that were not taken into account during the valuation; | Nil |
| 12. | Caveats, limitations and disclaimers to the extent they explain or elucidate the limitations faced by valuer, which shall not be for the purpose of limiting his responsibility for the valuation report. | Attached |

Assumptions, Disclaimers, Limitations & Qualifications

Value Subject to Change

The subject appraisal exercise is based on prevailing market dynamics as on **17th January 2025** and does not take into account any unforeseeable developments which could impact the same in the future.

Our Investigations

We are not engaged to carry out all possible investigations in relation to the subject property. Where in our report we identify certain limitations to our investigations, this is to enable the reliant party to instruct further investigations where considered appropriate or where we recommend as necessary prior to reliance. Vastukala Consultants India Pvt. Ltd. (VCIPL) is not liable for any loss occasioned by a decision not to conduct further investigations

Assumptions

Assumptions are a necessary part of undertaking valuations. VCIPL adopts assumptions for the purpose of providing valuation advice because some matters are not capable of accurate calculations or fall outside the scope of our expertise, or out instructions. The reliant party accepts that the valuation contains certain specific assumptions and acknowledge and accept the risk of that if any of the assumptions adopted in the valuation are incorrect, then this may have an effect on the valuation.

Information Supplied by Others

The appraisal is based on the information provided by the client. The same has been assumed to be correct and has been used for appraisal exercise. Where it is stated in the report that another party has supplied information to VCIPL, this information is believed to be reliable but VCIPL can accept no responsibility if this should prove not to be so.

Future Matters

To the extent that the valuation includes any statement as to a future matter, that statement is provided as an estimate and/or opinion based on the information known to VCIPL at the date of this document. VCIPL does not warrant that such statements are accurate or correct.

Map and Plans

Any sketch, plan or map in this report is included to assist the reader while visualising the property and assume no responsibility in connection with such matters.

Site Details

Based on inputs received from Client's representative and site visit conducted, we understand that the subject property is currently a contiguous land parcel admeasuring **12,670.00 Sq. M.** and is a Freehold land in the name of **Mr. Kishore Pravesh Agrawal & Mrs. Yogita Kishore Agrawal (Survey No. 126/2), Mr. Karan Kishore Agrawal & Mr. Pranay Kishore Agrawal (Survey No. 6/6) & Mr. Kishore Pravesh Agrawal (Survey No. 6/2/2C).** Further, VCIPL has assumed that the subject property is free from any encroachment and is available as on the date of the appraisal.



Since 1989

Vastukala Consultants (I) Pvt. Ltd.

An ISO 9001 : 2015 Certified Company



Property Title

Based on our discussion with the Client, we understand that the subject property is Freehold land in the name of **Mr. Kishore Pravesh Agrawal & Mrs. Yogita Kishore Agrawal (Survey No. 126/2), Mr. Karan Kishore Agrawal & Mr. Pranay Kishore Agrawal (Survey No. 6/6) & Mr. Kishore Pravesh Agrawal (Survey No. 6/2/2C)**. For the purpose of this appraisal exercise, we have assumed that the subject property has a clear title and is free from any encumbrances, disputes and claims. VCIPL has made no further enquiries with the relevant local authorities in this regard and does not certify the property as having a clear and marketable title. Further, no legal advice regarding the title and ownership of the subject property has been obtained for the purpose of this appraisal exercise. It has been assumed that the title deeds are clear and marketable.

Environmental Conditions

We have assumed that the subject property is not contaminated and is not adversely affected by any existing or proposed environmental law and any processes which are carried out on the property are regulated by environmental legislation and are properly licensed by the appropriate authorities.

Town Planning

The permissible land use, zoning, achievable FSI, area statement adopted for purpose of this valuation is based on the information provided by the Client's representative and the same has been adopted for this valuation purpose. VCIPL has assumed the same to be correct and permissible. VCIPL has not validated the same from any authority.

Area

Based on the information provided by the Client's representative, we understand that the subject property is a vacant, contiguous land parcel admeasuring **12,670.00 Sq. M.**

Condition & Repair

In the absence of any information to the contrary, we have assumed that there are no abnormal ground conditions, nor archaeological remains present which might adversely affect the current or future occupation, development or value of the property. The property is free from rat, infestation, structural or latent defect. No currently known deleterious or hazardous materials or suspect techniques will be used in the construction of or subsequent alteration or additions to the property and comments made in the property details do not purport to express an opinion about, or advise upon, the condition of uninspected parts and should not be taken as making an implied representation or statement about such parts

Valuation Methodology

For the purpose of this valuation exercise, the valuation methodology used is Direct Comparison Approach Method and proposed Current Use / Existing Use premise is considered for this assignment.

The Direct Comparison Approach involves a comparison of the property being valued to similar properties that have actually been sold in arms - length transactions or are offered for sale. This approach demonstrates what buyers have historically been willing to pay (and sellers willing to accept) for similar properties in an open and competitive market and is particularly useful in estimating the value of the land and properties that are typically traded on a unit basis.

In case of inadequate recent transaction activity in the subject micro-market, the appraiser would collate details of older transactions. Subsequently, the appraiser would analyse rental / capital value trends in the



Since 1989

Vastukala Consultants (I) Pvt. Ltd.

An ISO 9001 : 2015 Certified Company



subject micro-market in order to calculate the percentage increase / decrease in values since the date of the identified transactions. This percentage would then be adopted to project the current value of the same.

Where reliance has been placed upon external sources of information in applying the valuation methodologies, unless otherwise specifically instructed by Client and/or stated in the valuation, VCIPL has not independently verified that information and VCIPL does not advise nor accept it as reliable. The person or entity to whom the report is addressed acknowledges and accepts the risk that if any of the unverified information in the valuation is incorrect, then this may have an effect on the valuation.

Not a Structural Survey

We state that this is a valuation report and not a structural survey

Other

All measurements, areas and ages quoted in our report are approximate

Legal

We have not made any allowances with respect to any existing or proposed local legislation relating to taxation on realization of the sale value of the subject property. VCIPL is not required to give testimony or to appear in court by reason of this appraisal report, with reference to the property in question, unless arrangement has been made thereof. Further, no legal advice on any aspects has been obtained for the purpose of this appraisal exercise

Property specific assumptions

Based on inputs received from the client and site visit conducted, we understand that the subject property is currently in Vacant, contiguous land parcel admeasuring **12,670.00 Sq. M.**

ASSUMPTIONS, CAVEATS, LIMITATION AND DISCLAIMERS

1. We assume no responsibility for matters of legal nature affecting the property appraised or the title thereto, nor do we render our opinion as to the title, which is assumed to be good and marketable.
2. The property is valued as though under responsible ownership.
3. It is assumed that the property is free of liens and encumbrances.
4. It is assumed that there are no hidden or unapparent conditions of the subsoil or structure that would render it more or less valuable. No responsibility is assumed for such conditions or for engineering that might be required to discover such factors.
5. There is no direct/ indirect interest in the property valued.
6. The rates for valuation of the property are in accordance with the Govt. approved rates and prevailing market rates

Annexure - II

MODEL CODE OF CONDUCT FOR VALUERS

{Adopted in line with Companies (Registered Valuers and Valuation Rules, 2017)}

All valuers empanelled with bank shall strictly adhere to the following code of conduct:

Integrity and Fairness

1. A valuer shall, in the conduct of his/its business, follow high standards of integrity and fairness in all his/its dealings with his/its clients and other valuers.
2. A valuer shall maintain integrity by being honest, straightforward, and forthright in all professional relationships.
3. A valuer shall endeavour to ensure that he/it provides true and adequate information and shall not misrepresent any facts or situations.
4. A valuer shall refrain from being involved in any action that would bring disrepute to the profession.
5. A valuer shall keep public interest foremost while delivering his services.

Professional Competence and Due Care

6. A valuer shall render at all times high standards of service, exercise due diligence, ensure proper care and exercise independent professional judgment.
7. A valuer shall carry out professional services in accordance with the relevant technical and professional standards that may be specified from time to time.
8. A valuer shall continuously maintain professional knowledge and skill to provide competent professional service based on up-to-date developments in practice, prevailing regulations / guidelines and techniques.
9. In the preparation of a valuation report, the valuer shall not disclaim liability for his/its expertise or deny his/its duty of care, except to the extent that the assumptions are based on statements of fact provided by the company or its auditors or consultants or information available in public domain and not generated by the valuer.
10. A valuer shall not carry out any instruction of the client insofar as they are incompatible with the requirements of integrity, objectivity and independence.
11. A valuer shall clearly state to his client the services that he would be competent to provide and the services for which he would be relying on other valuers or professionals or for which the client can have a separate arrangement with other valuers.



Since 1989

Vastukala Consultants (I) Pvt. Ltd.

An ISO 9001 : 2015 Certified Company



Independence and Disclosure of Interest

12. A valuer shall act with objectivity in his/its professional dealings by ensuring that his/its decisions are made without the presence of any bias, conflict of interest, coercion, or undue influence of any party, whether directly connected to the valuation assignment or not.
13. A valuer shall not take up an assignment if he/it or any of his/its relatives or associates is not independent in terms of association to the company.
14. A valuer shall maintain complete independence in his/its professional relationships and shall conduct the valuation independent of external influences.
15. A valuer shall wherever necessary disclose to the clients, possible sources of conflicts of duties and interests, while providing unbiased services.
16. A valuer shall not deal in securities of any subject company after any time when he/it first becomes aware of the possibility of his / its association with the valuation, and in accordance with the Securities and Exchange Board of India (Prohibition of Insider Trading) Regulations, 2015 or till the time the valuation report becomes public, whichever is earlier.
17. A valuer shall not indulge in "mandate snatching" or offering "convenience valuations" in order to cater to a company or client's needs.
18. As an independent valuer, the valuer shall not charge success fee. (Success fees may be defined as a compensation / incentive paid to any third party for successful closure of transaction. In this case, approval of credit proposals).
19. In any fairness opinion or independent expert opinion submitted by a valuer, if there has been a prior engagement in an unconnected transaction, the valuer shall declare the association with the company during the last five years.

Confidentiality

20. A valuer shall not use or divulge to other clients or any other party any confidential information about the subject company, which has come to his / its knowledge without proper and specific authority or unless there is a legal or professional right or duty to disclose.

Information Management

21. A valuer shall ensure that he/ it maintains written contemporaneous records for any decision taken, the reasons for taking the decision, and the information and evidence in support of such decision. This shall be maintained so as to sufficiently enable a reasonable person to take a view on the appropriateness of his /its decisions and actions.
22. A valuer shall appear, co-operate and be available for inspections and investigations carried out by the authority, any person authorized by the authority, the registered valuers organization with which he/it is registered or any other statutory regulatory body.



Since 1989

Vastukala Consultants (I) Pvt. Ltd.

An ISO 9001 : 2015 Certified Company



23. A valuer shall provide all information and records as may be required by the authority, the Tribunal, Appellate Tribunal, the registered valuers organization with which he/it is registered, or any other statutory regulatory body.
24. A valuer while respecting the confidentiality of information acquired during the course of performing professional services, shall maintain proper working papers for a period of three years or such longer period as required in its contract for a specific valuation, for production before a regulatory authority or for a peer review. In the event of a pending case before the Tribunal or Appellate Tribunal, the record shall be maintained till the disposal of the case.

Gifts and hospitality:

25. A valuer or his / its relative shall not accept gifts or hospitality which undermines or affects his independence as a valuer.

Explanation: For the purposes of this code the term 'relative' shall have the same meaning as defined in clause (77) of Section 2 of the Companies Act, 2013 (18 of 2013).

26. A valuer shall not offer gifts or hospitality or a financial or any other advantage to a public servant or any other person with a view to obtain or retain work for himself / itself, or to obtain or retain an advantage in the conduct of profession for himself / itself.

Remuneration and Costs.

27. A valuer shall provide services for remuneration which is charged in a transparent manner, is a reasonable reflection of the work necessarily and properly undertaken, and is not inconsistent with the applicable rules.
28. A valuer shall not accept any fees or charges other than those which are disclosed in a written contract with the person to whom he would be rendering service.

Occupation, employability and restrictions.

29. A valuer shall refrain from accepting too many assignments, if he/it is unlikely to be able to devote adequate time to each of his/ its assignments.
30. A valuer shall not conduct business which in the opinion of the authority or the registered valuer organization discredits the profession.

For VASTUKALA CONSULTANTS (I) PVT. LTD.

Director

Auth. Sign.

Sharadkumar B. Chalikwar

Govt. Reg. Valuer
Chartered Engineer (India)
Reg. No. (N) CCIT/1-14/52/2008-09
UBI Emp No. ROS:ADV:Valuer/033:008:2021-22



Since 1989

Vastukala Consultants (I) Pvt. Ltd.

An ISO 9001 : 2015 Certified Company

