

APPROVING AUTHORITY

OFFICE OF THE ASSISTANT DIRECTOR OF
TOWN PLANNING

NASHIK BRANCH, NASHIK
DEMARCATED LAYOUT

RECOMMENDED FOR SANCTION

Subject to conditions mentioned in the
LETTER NO. 2677 DATE 06 / 10 / 2016
FOR RESIDENTIAL PURPOSE

SD/-

ASSISTANT DIRECTOR OF TOWN PLANNING,
NASHIK

TENTATIVE LAYOUT APPROVED ;
LETTER NO: 2201. DATED: 27 / 07 / 2016

N.A. ORDER NO:
JAMA / NASR / 17 / 2015. DATED: 27/11/2015

DILR DEMARCATION NUMBER: 1462/2016
DATED: 05/05/2016.

AREA STATEMENT (342 to 345)

| | | |
|----|--|----------------|
| 1. | GROSS AREA OF PLOT / LAND | 60600.00 SQ.M. |
| 2. | DEDUCTIONS FOR | |
| | a. ROAD ACQUISITION AREA (A-601.84 (B-910.40) | 1512.24 SQ.M. |
| | b. PROPOSED ROAD | ----- SQ.M. |

ASSISTANT DIRECTOR OF TOWN PLANNING
NASHIK

TENTATIVE LAYOUT APPROVED :
LETTER NO: 2201. DATED: 27 / 07 / 2016

N.A. ORDER NO:
JAMA / NASR / 17 / 2015. DATED: 27/11/2015

DILR DEMARCATION NUMBER: 1462/2016
DATED: 05/05/2016.

AREA STATEMENT (342 to 345)

| | | |
|----|--|----------------|
| 1. | GROSS AREA OF PLOT / LAND | 60600.00 SQ.M. |
| 2. | DEDUCTIONS FOR | |
| | a. ROAD ACQUISITION AREA (A-601.84) (B-910.40) | 1512.24 SQ.M. |
| | b. PROPOSED ROAD | ---- SQ.M. |
| | c. ANY RESERVATIONS | ---- SQ.M. |
| | TOTAL (a+b+c) | 1512.24 SQ.M. |
| 3. | REMAINING AREA OF LAND (1-2) | 59087.76 SQ.M. |
| 4. | DEDUCTIONS FOR | |
| | a. RECREATION OPEN SPACE (C- 3598.75) (D- 2473.25-ROAD ROUNDING=2461.25) | 6060.00 SQ.M. |
| | b. INTERNAL ROADS AND ROAD WIDENING | 11412.64 SQ.M. |
| | c. AMENITY SPACE, IF ANY | 6060.00 SQ.M. |
| | TOTAL (a+b+c) | 23532.64 SQ.M. |
| 5. | AREA UNDER PLOTS (3-4) | 35555.12 SQ.M. |
| 6. | ROAD FANNING AREA | 148.00 SQ.M. |
| 7. | REMAINING PLOT AREA (5 - 6) | 35407.12 SQ.M. |
| 8. | NET AREA FOR FSI CALCULATIONS= 90% OF 1-(2+4C) | 47724.98 SQ.M. |
| 9. | PERMISSIBLE FSI OF LAYOUT (8/5) | 1.34 |

NOTES :

- 01 ALL DIMENSIONS ARE IN METERS.
- 02 PLOT BOUNDRY SHOWN IN BLACK,
- 03 OPEN SPACE SHOWN IN GREEN,
- 04 AMENITY PLOT SHOWN IN PINK,



FINAL DEMARCATED LAYOUT FOR
RESIDENTIAL PURPOSE

| PLOT AREA STATEMENT | | | | | | PERMISSIBLE NORMAL FSI | PERMISSIBLE B/U AREA ON G (E X G) | TYPE OF PLOT |
|---------------------|----------------------|---|----------------------------------|---|------------------------|------------------------|-----------------------------------|---------------|
| A PLOT NO | B PLOT AREA IN SQ.M. | C ROUNDING AREA OF ROAD (N, S, E, W, F ANY) | D REMAINING AREA OF PLOT (SQ.M.) | E B/U AREA ON PRO-RATA BASIS (D X 1.34) | F FRONT ROAD WIDTH (M) | | | |
| 1 | 944.29 | 20.00 | 924.29 | 1238.55 | 18.00 | 1.00 | 1362.40 | DETACHED |
| 2 | 345.31 | 0.00 | 345.31 | 462.72 | 12.00 | 1.00 | 462.72 | DETACHED |
| 3 | 345.31 | 0.00 | 345.31 | 462.72 | 12.00 | 1.00 | 462.72 | DETACHED |
| 4 | 345.31 | 0.00 | 345.31 | 462.72 | 12.00 | 1.00 | 462.72 | DETACHED |
| 5 | 345.31 | 0.00 | 345.31 | 462.72 | 12.00 | 1.00 | 462.72 | DETACHED |
| 6 | 343.46 | 0.00 | 343.46 | 460.24 | 12.00 | 1.00 | 460.24 | DETACHED |
| 7 | 335.54 | 0.00 | 335.54 | 449.62 | 12.00 | 1.00 | 449.62 | DETACHED |
| 8 | 327.30 | 0.00 | 327.30 | 438.58 | 12.00 | 1.00 | 438.58 | DETACHED |
| 9 | 327.46 | 0.00 | 327.46 | 438.80 | 12.00 | 1.00 | 438.80 | DETACHED |
| 10 | 356.29 | 8.00 | 348.29 | 466.71 | 12.00 | 1.00 | 466.71 | DETACHED |
| 11 | 314.32 | 0.00 | 314.32 | 421.19 | 12.00 | 1.00 | 421.19 | DETACHED |
| 12 | 312.28 | 0.00 | 312.28 | 418.46 | 12.00 | 1.00 | 418.46 | DETACHED |
| 13 | 333.15 | 0.00 | 333.15 | 446.42 | 12.00 | 1.00 | 446.42 | DETACHED |
| 14 | 330.80 | 0.00 | 330.80 | 443.27 | 12.00 | 1.00 | 443.27 | DETACHED |
| 15 | 328.46 | 0.00 | 328.46 | 440.14 | 12.00 | 1.00 | 440.14 | DETACHED |
| 16 | 326.11 | 0.00 | 326.11 | 436.99 | 12.00 | 1.00 | 436.99 | DETACHED |
| 17 | 312.64 | 0.00 | 312.64 | 418.94 | 12.00 | 1.00 | 418.94 | DETACHED |
| 18 | 310.46 | 0.00 | 310.46 | 416.02 | 12.00 | 1.00 | 416.02 | DETACHED |
| 19 | 286.32 | 0.00 | 286.32 | 383.67 | 12.00 | 1.00 | 383.67 | DETACHED |
| 20 | 276.56 | 0.00 | 276.56 | 370.59 | 12.00 | 1.00 | 370.59 | DETACHED |
| 21 | 733.08 | 0.00 | 733.08 | 982.33 | 12.00 | 1.00 | 982.33 | DETACHED |
| 22 | 849.37 | 0.00 | 849.37 | 1138.16 | 12.00 | 1.00 | 1138.16 | DETACHED |
| 23 | 277.67 | 0.00 | 277.67 | 372.08 | 12.00 | 1.00 | 372.08 | DETACHED |
| 24 | 273.00 | 0.00 | 273.00 | 365.82 | 12.00 | 1.00 | 365.82 | DETACHED |
| 25 | 273.00 | 0.00 | 273.00 | 365.82 | 12.00 | 1.00 | 365.82 | DETACHED |
| 26 | 273.00 | 0.00 | 273.00 | 365.82 | 12.00 | 1.00 | 365.82 | DETACHED |
| 27 | 273.00 | 0.00 | 273.00 | 365.82 | 12.00 | 1.00 | 365.82 | DETACHED |
| 28 | 273.00 | 0.00 | 273.00 | 365.82 | 12.00 | 1.00 | 365.82 | DETACHED |
| 29 | 283.50 | 0.00 | 283.50 | 379.89 | 12.00 | 1.00 | 379.89 | DETACHED |
| 30 | 430.50 | 8.00 | 422.50 | 566.15 | 12.00 | 1.00 | 566.15 | DETACHED |
| 31 | 410.00 | 6.00 | 404.00 | 541.36 | 12.00 | 1.00 | 541.36 | DETACHED |
| 32 | 230.00 | 0.00 | 230.00 | 308.20 | 9.00 | 1.00 | 308.20 | SEMI-DETACHED |
| 33 | 230.00 | 0.00 | 230.00 | 308.20 | 9.00 | 1.00 | 308.20 | SEMI-DETACHED |
| 34 | 230.00 | 0.00 | 230.00 | 308.20 | 9.00 | 1.00 | 308.20 | SEMI-DETACHED |
| 35 | 230.00 | 0.00 | 230.00 | 308.20 | 9.00 | 1.00 | 308.20 | SEMI-DETACHED |
| 36 | 230.00 | 0.00 | 230.00 | 308.20 | 9.00 | 1.00 | 308.20 | SEMI-DETACHED |
| 37 | 230.00 | 0.00 | 230.00 | 308.20 | 9.00 | 1.00 | 308.20 | SEMI-DETACHED |
| 38 | 230.00 | 0.00 | 230.00 | 308.20 | 9.00 | 1.00 | 308.20 | SEMI-DETACHED |
| 39 | 224.44 | 0.00 | 224.44 | 300.75 | 9.00 | 1.00 | 300.75 | SEMI-DETACHED |
| 40 | 219.93 | 0.00 | 219.93 | 294.71 | 9.00 | 1.00 | 294.71 | SEMI-DETACHED |
| 41 | 215.25 | 0.00 | 215.25 | 288.44 | 9.00 | 1.00 | 288.44 | SEMI-DETACHED |
| 42 | 246.00 | 0.00 | 246.00 | 329.64 | 9.00 | 1.00 | 329.64 | SEMI-DETACHED |
| 43 | 246.00 | 0.00 | 246.00 | 329.64 | 9.00 | 1.00 | 329.64 | SEMI-DETACHED |
| 44 | 246.00 | 0.00 | 246.00 | 329.64 | 9.00 | 1.00 | 329.64 | SEMI-DETACHED |
| 45 | 246.00 | 0.00 | 246.00 | 329.64 | 9.00 | 1.00 | 329.64 | SEMI-DETACHED |
| 46 | 246.00 | 0.00 | 246.00 | 329.64 | 9.00 | 1.00 | 329.64 | SEMI-DETACHED |
| 47 | 246.00 | 0.00 | 246.00 | 329.64 | 9.00 | 1.00 | 329.64 | SEMI-DETACHED |
| 48 | 420.25 | 6.00 | 414.25 | 555.10 | 12.00 | 1.00 | 555.10 | DETACHED |
| 49 | 420.25 | 8.00 | 412.25 | 552.42 | 12.00 | 1.00 | 552.42 | DETACHED |
| 50 | 246.00 | 0.00 | 246.00 | 329.64 | 12.00 | 1.00 | 329.64 | SEMI-DETACHED |
| 51 | 246.00 | 0.00 | 246.00 | 329.64 | 12.00 | 1.00 | 329.64 | SEMI-DETACHED |
| 52 | 246.00 | 0.00 | 246.00 | 329.64 | 12.00 | 1.00 | 329.64 | SEMI-DETACHED |
| 53 | 246.00 | 0.00 | 246.00 | 329.64 | 12.00 | 1.00 | 329.64 | SEMI-DETACHED |
| 54 | 246.00 | 0.00 | 246.00 | 329.64 | 12.00 | 1.00 | 329.64 | SEMI-DETACHED |
| 55 | 246.00 | 0.00 | 246.00 | 329.64 | 12.00 | 1.00 | 329.64 | SEMI-DETACHED |
| 56 | 246.00 | 0.00 | 246.00 | 329.64 | 12.00 | 1.00 | 329.64 | SEMI-DETACHED |
| 57 | 221.54 | 0.00 | 221.54 | 296.86 | 12.00 | 1.00 | 296.86 | DETACHED |
| 58 | 324.65 | 0.00 | 324.65 | 435.03 | 12.00 | 1.00 | 435.03 | DETACHED |
| 59 | 315.00 | 0.00 | 315.00 | 422.10 | 12.00 | 1.00 | 422.10 | DETACHED |
| 60 | 315.00 | 0.00 | 315.00 | 422.10 | 12.00 | 1.00 | 422.10 | DETACHED |
| 61 | 315.00 | 0.00 | 315.00 | 422.10 | 12.00 | 1.00 | 422.10 | DETACHED |
| 62 | 315.00 | 0.00 | 315.00 | 422.10 | 12.00 | 1.00 | 422.10 | DETACHED |
| 63 | 315.00 | 0.00 | 315.00 | 422.10 | 12.00 | 1.00 | 422.10 | DETACHED |
| 64 | 1497.13 | 30.00 | 1467.13 | 1965.95 | 18.00 | 1.10 | 2162.55 | DETACHED |
| 65 | 234.00 | 0.00 | 234.00 | 313.56 | 9.00 | 1.00 | 313.56 | SEMI-DETACHED |
| 66 | 234.00 | 0.00 | 234.00 | 313.56 | 9.00 | 1.00 | 313.56 | SEMI-DETACHED |
| 67 | 234.00 | 0.00 | 234.00 | 313.56 | 9.00 | 1.00 | 313.56 | SEMI-DETACHED |
| 68 | 234.00 | 0.00 | 234.00 | 313.56 | 9.00 | 1.00 | 313.56 | SEMI-DETACHED |
| 69 | 234.00 | 0.00 | 234.00 | 313.56 | 9.00 | 1.00 | 313.56 | SEMI-DETACHED |
| 70 | 234.00 | 0.00 | 234.00 | 313.56 | 9.00 | 1.00 | 313.56 | SEMI-DETACHED |
| 71 | 251.30 | 0.00 | 251.30 | 336.74 | 9.00 | 1.00 | 336.74 | DETACHED |
| 72 | 365.66 | 0.00 | 365.66 | 489.98 | 9.00 | 1.00 | 489.98 | DETACHED |
| 73 | 354.77 | 0.00 | 354.77 | 475.39 | 9.00 | 1.00 | 475.39 | DETACHED |
| 74 | 362.67 | 0.00 | 362.67 | 485.98 | 9.00 | 1.00 | 485.98 | DETACHED |
| 75 | 370.57 | 0.00 | 370.57 | 496.56 | 9.00 | 1.00 | 496.56 | DETACHED |
| 76 | 376.68 | 0.00 | 376.68 | 496.56 | 9.00 | 1.00 | 496.56 | DETACHED |
| 77 | 809.29 | 10.00 | 799.29 | 1071.05 | 18.00 | 1.10 | 1178.15 | DETACHED |
| 78 | 987.19 | 12.00 | 975.19 | 1306.75 | 18.00 | 1.10 | 1437.43 | DETACHED |
| 79 | 426.92 | 0.00 | 426.92 | 572.07 | 12.00 | 1.00 | 572.07 | DETACHED |
| 80 | 307.23 | 0.00 | 307.23 | 411.69 | 12.00 | 1.00 | 411.69 | DETACHED |
| 81 | 304.43 | 0.00 | 304.43 | 407.94 | 12.00 | 1.00 | 407.94 | DETACHED |
| 82 | 301.64 | 0.00 | 301.64 | 404.20 | 12.00 | 1.00 | 404.20 | DETACHED |
| 83 | 331.87 | 0.00 | 331.87 | 444.71 | 12.00 | 1.00 | 444.71 | DETACHED |
| 84 | 350.19 | 0.00 | 350.19 | 469.25 | 12.00 | 1.00 | 469.25 | DETACHED |
| 85 | 346.26 | 0.00 | 346.26 | 463.99 | 12.00 | 1.00 | 463.99 | SEMI-DETACHED |
| 86 | 224.71 | 8.00 | 216.71 | 290.39 | 12.00 | 1.00 | 290.39 | SEMI-DETACHED |
| 87 | 209.83 | 0.00 | 209.83 | 281.17 | 12.00 | 1.00 | 281.17 | DETACHED |
| 88 | 402.63 | 6.00 | 396.63 | 528.80 | 12.00 | 1.00 | 528.80 | DETACHED |
| 89 | 387.12 | 0.00 | 387.12 | 510.70 | 12.00 | 1.00 | 510.70 | DETACHED |
| 90 | 303.02 | 0.00 | 303.02 | 406.05 | 12.00 | 1.00 | 406.05 | DETACHED |
| | 290.23 | 0.00 | 290.23 | 388.91 | 9.00 | 1.00 | 388.91 | DETACHED |
| | | 0.00 | 276.11 | 369.99 | 9.00 | 1.00 | 369.99 | DETACHED |
| | | 0.00 | 205.42 | 409.26 | 9.00 | 1.00 | 409.26 | DETACHED |
| | | 0.00 | | 393.96 | 9.00 | 1.00 | 393.96 | DETACHED |
| | | 0.00 | | 365.82 | 9.00 | 1.00 | 365.82 | DETACHED |

OFFICE OF THE ASS
TOWN PL
NASHIK BRAN
DEMARCAT
RECOMMENDED
Subject to condition
LETTER NO. 2677 D
FOR RESIDENT

SE
ASSISTANT DIRECTOR
NAS

TENTATIVE LAYOUT APPROVED
LETTER NO. 2201. DATED: 27
N.A. ORDER NO:
JAMA / NASR / 17 / 2015, DA
DILR DEMARCATION NUMBER
DATED: 05/05/2016.

AREA STATEMENT (3

- GROSS AREA OF PLOT / L
- DEDUCTIONS FOR
 - a. ROAD ACQUISITION AREA (A)
 - b. PROPOSED ROAD
 - c. ANY RESERVATIONS
 TOTAL (a+b+c)
- REMAINING AREA OF LAND
- DEDUCTIONS FOR
 - a. RECREATION OPEN SPACE (C)
 - b. INTERNAL ROADS AND ROAD V
 - c. AMENITY SPACE, IF ANY
 TOTAL (a+b+c)
- AREA UNDER PLOTS (3-4)
- ROAD FANNING AREA
- REMAINING PLOT AREA (5 - 6)
- NET AREA FOR FSI CALCULATI
90% OF 1-(2+4C)
- PERMISSIBLE FSI OF LAYOUT (8/

NOTES:
01 ALL DIMENSIONS ARE IN METE
02 PLOT BOUNDRY SHOWN IN E
03 OPEN SPACE SHOWN IN GR
04 AMENITY PLOT SHOWN IN PIN

FINAL DEMARCATED LAYO
RESIDENTIAL PURPOSE IN
GAT NO. 342/(1+2)/1,344(P
AT JALALPUR, TAL. - NASHIK.
FOR MANOJ TIBREWALA AN
G.P.A HOLDER MANOJ TIBER

M. Manoj
1. MANOJ JAYKUMAR

S. Sanjay
2. SANJAY BHASKER RAO

K. Kirtikumar
3. KIRTIKUMAR HARISHCH

OWNER

| SR. NO. | GAT. NO. | TOTAL AREA (IN SQ.M) | OWNER'S NAME | AREA (IN SQ.M) | AREA UNDER DEVELOPMENT (IN SQ.M) | G.P.A HOLDER | REMAINING AREA |
|--------------------|-----------------|----------------------|---|----------------|----------------------------------|---|----------------|
| 1. | 342/ (1+2)/1 | 28000 | TARABAI RAMESH KATHE | 12000 | 12000 | M J TIBEREWALA | |
| | | | MANOJ JAYKUMAR TIBEREWALA | 8000 | 8000 | SELF | |
| | | | KAMAL RAMESH KATHE | 8000 | 8000 | M J TIBEREWALA | |
| 2. | 344 | 13700 | SANJAY BHASKER RAO BHATAMBREKAR | 10300 | 10300 | SELF | |
| | | | POPAT DADAJI AHER | 3400 | | CONSENT ATTACHED | 3400 |
| 3. | 345 | 12300 | KIRTIKUMAR DHANYAKUMAR BHORE | 4500 | 4500 | MANOJ JAYKUMAR TIBEREWALA PARTNER JAYAM DEVELOPERS. | |
| | | | ANUPAMA KIRTIKUMAR BHORE | | | | |
| | | | KSHEMKAR KIRTIKUMAR BHORE | | | | |
| | | | YOGESH ARUN DIXIT | | | | |
| | | | ANITA ARUN DIXIT | | | | |
| | | | NILESH ARUN DIXIT | | | | |
| | | | SWATI ABHAY SAKARE | | | | |
| RAJESH SOPAN PATIL | 900 | 900 | | | | | |
| | | | MILIND JAGDISH AGRWAL | 2000 | 2000 | | |
| 4. | 355 | 5300 | MANOJ JAYKUMAR TIBEREWALA PARTNER JAYAM DEVELOPERS. | 5300 | 5300 | SELF | |
| 5. | 356 | 4700 | MARJIYAN HOSI PATEL | 4700 | 4700 | KIRTIKUMAR HARISHCHANDRA SHAH. | |
| TOTAL | | 64000 | | 64000 | 60600 | | 3400 |



PLOT AREA STATEMENT

| A PLOT NO | B PLOT AREA (IN SQ.M) | C ROUNDING AREA OF ROAD (IN SQ.M. F. AREA) | REM AREA (IN SQ.M.) |
|--------------|--------------------------|---|------------------------|
| 1 | 944.29 | 20.00 | 924.29 |
| 2 | 345.31 | 0.00 | 345.31 |
| 3 | 345.31 | 0.00 | 345.31 |
| 4 | 345.31 | 0.00 | 345.31 |
| 5 | 345.31 | 0.00 | 345.31 |
| 6 | 343.46 | 0.00 | 343.46 |
| 7 | 335.54 | 0.00 | 335.54 |
| 8 | 327.30 | 0.00 | 327.30 |
| 9 | 327.46 | 0.00 | 327.46 |
| 10 | 356.29 | 8.00 | 348.29 |
| 11 | 314.32 | 0.00 | 314.32 |
| 12 | 312.28 | 0.00 | 312.28 |
| 13 | 333.15 | 0.00 | 333.15 |
| 14 | 330.80 | 0.00 | 330.80 |
| 15 | 328.46 | 0.00 | 328.46 |
| 16 | 326.11 | 0.00 | 326.11 |
| 17 | 312.64 | 0.00 | 312.64 |
| 18 | 310.46 | 0.00 | 310.46 |
| 19 | 286.32 | 0.00 | 286.32 |
| 20 | 276.56 | 0.00 | 276.56 |
| 21 | 733.08 | 0.00 | 733.08 |
| 22 | 849.37 | 0.00 | 849.37 |
| 23 | 277.67 | 0.00 | 277.67 |
| 24 | 273.00 | 0.00 | 273.00 |
| 25 | 273.00 | 0.00 | 273.00 |
| 26 | 273.00 | 0.00 | 273.00 |
| 27 | 273.00 | 0.00 | 273.00 |
| 28 | 273.00 | 0.00 | 273.00 |
| 29 | 283.50 | 0.00 | 283.50 |
| 30 | 430.50 | 8.00 | 422.50 |
| 31 | 410.00 | 6.00 | 404.00 |
| 32 | 230.00 | 0.00 | 230.00 |
| 33 | 230.00 | 0.00 | 230.00 |
| 34 | 230.00 | 0.00 | 230.00 |
| 35 | 230.00 | 0.00 | 230.00 |
| 36 | 230.00 | 0.00 | 230.00 |
| 37 | 230.00 | 0.00 | 230.00 |
| 38 | 230.00 | 0.00 | 230.00 |
| 39 | 224.44 | 0.00 | 224.44 |
| 40 | 219.93 | 0.00 | 219.93 |
| 41 | 215.25 | 0.00 | 215.25 |
| 42 | 246.00 | 0.00 | 246.00 |
| 43 | 246.00 | 0.00 | 246.00 |
| 44 | 246.00 | 0.00 | 246.00 |
| 45 | 246.00 | 0.00 | 246.00 |
| 46 | 246.00 | 0.00 | 246.00 |
| 47 | 246.00 | 0.00 | 246.00 |
| 48 | 420.25 | 6.00 | 414.25 |
| 49 | 420.25 | 8.00 | 412.25 |
| 50 | 246.00 | 0.00 | 246.00 |
| 51 | 246.00 | 0.00 | 246.00 |
| 52 | 246.00 | 0.00 | 246.00 |
| 53 | 246.00 | 0.00 | 246.00 |
| 54 | 246.00 | 0.00 | 246.00 |
| 55 | 246.00 | 0.00 | 246.00 |
| 56 | 246.00 | 0.00 | 246.00 |
| 57 | 221.54 | 0.00 | 221.54 |
| 58 | 324.65 | 0.00 | 324.65 |
| 59 | 318.00 | 0.00 | 318.00 |
| 60 | 315.00 | 0.00 | 315.00 |
| 61 | 315.00 | 0.00 | 315.00 |
| 62 | 315.00 | 0.00 | 315.00 |
| 63 | 315.00 | 0.00 | 315.00 |
| 64 | 1497.13 | 30.00 | 1467.13 |
| 65 | 234.00 | 0.00 | 234.00 |
| 66 | 234.00 | 0.00 | 234.00 |
| 67 | 234.00 | 0.00 | 234.00 |
| 68 | 234.00 | 0.00 | 234.00 |

12.28
13.00
14.00
14.00
14.50
15.50
15.70
00.6

ADJOINING GAT. NO. 342(2) AS PER OUR LAYOUT NOT APPROVED

ADJOINING GAT. NO. 343 LAYOUT NOT APPROVED

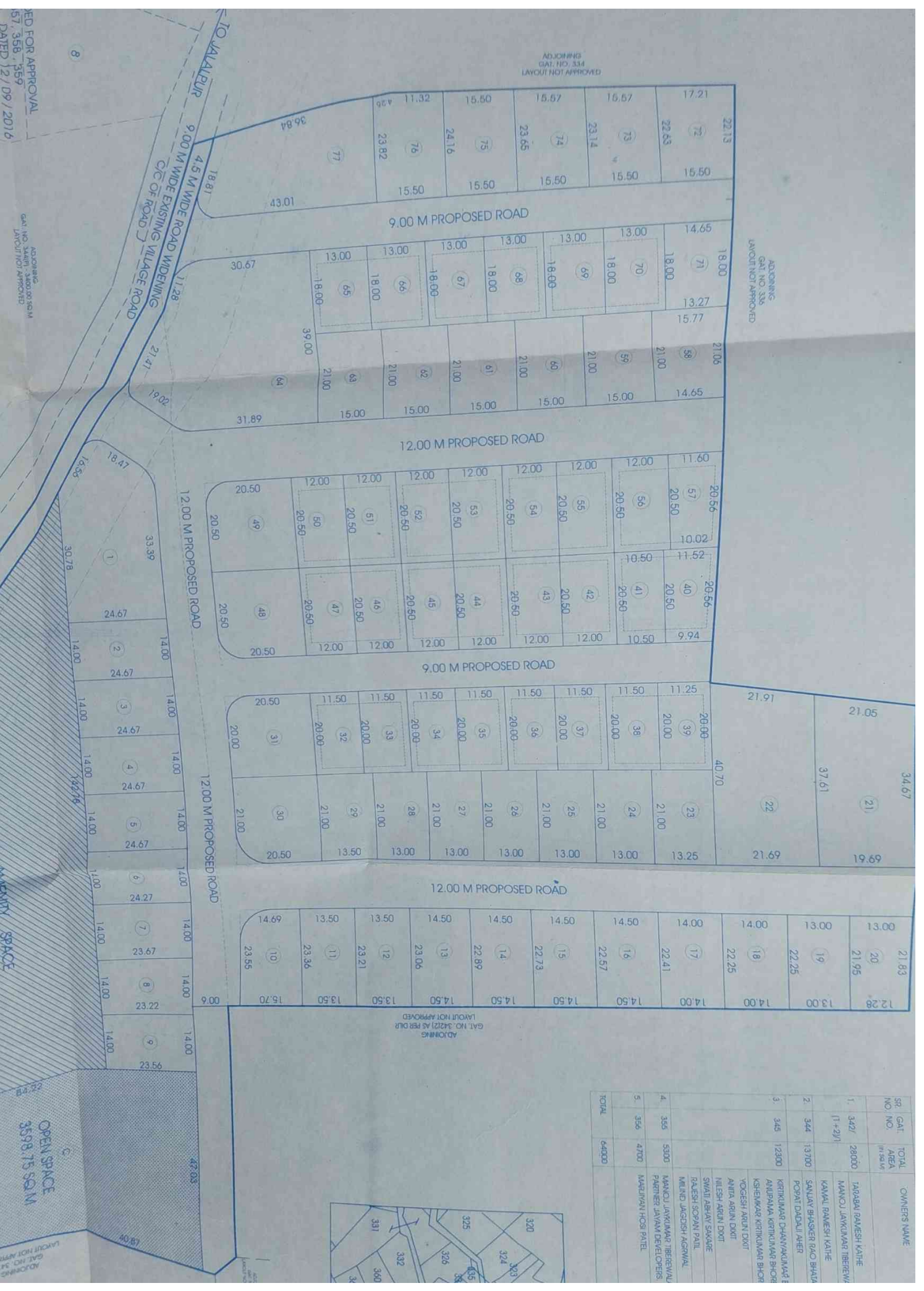

FOR APPROVAL
GAT NO. 334
LAYOUT NOT APPROVED
DATED 21/09/2016

ADJOINING
GAT NO. 334
LAYOUT NOT APPROVED

ADJOINING
GAT NO. 334
LAYOUT NOT APPROVED

ADJOINING
GAT NO. 334
LAYOUT NOT APPROVED

| Sr. | GAT NO. | TOTAL AREA (sq.m) | OWNERS NAME |
|-------|--------------|-------------------|--------------------------|
| 1 | 342/ (1+2/1) | 29000 | TARABAI RAMESH KATHE |
| 2 | 344 | 13700 | MANOJ LAKSHMIBHAI |
| 3 | 345 | 12300 | KANAI RAMESH KATHE |
| 4 | 355 | 5300 | SAULAN BHASKER RAO BHATA |
| 5 | 356 | 4700 | POBAY DADAJI AHER |
| TOTAL | | 64000 | |

