

CONTENTS OF SHEET - CLUSTER - 2
 2ND TO 7TH, 9TH TO 12TH, 14TH TO 17TH, 19TH TO 22ND, 24TH TO 28TH TYPICAL FLOOR PLAN AND LINE AREA DIAGRAM AND CALCULATION AREA STATEMENT, BUILT-UP AREA SUMMARY
 8TH, 13TH, 18TH & 23RD REFUGE FLOOR PLAN, LINE AREA DIAGRAM & CALCULATION, REFUGE AREA STATEMENT
 STAMP AND DATE OF APPROVAL OF PLAN

PLANS APPROVED BY THE OFFICERS OF DRAWINGS WHICH ARE TO BE USED ALONG WITH THE APPROVED PERMITS AND CONSENTS OF THE MUNICIPAL CORPORATION, PUNE. DATE: 17/11/2022. AND THE CONDITIONS MENTIONED THEREIN.

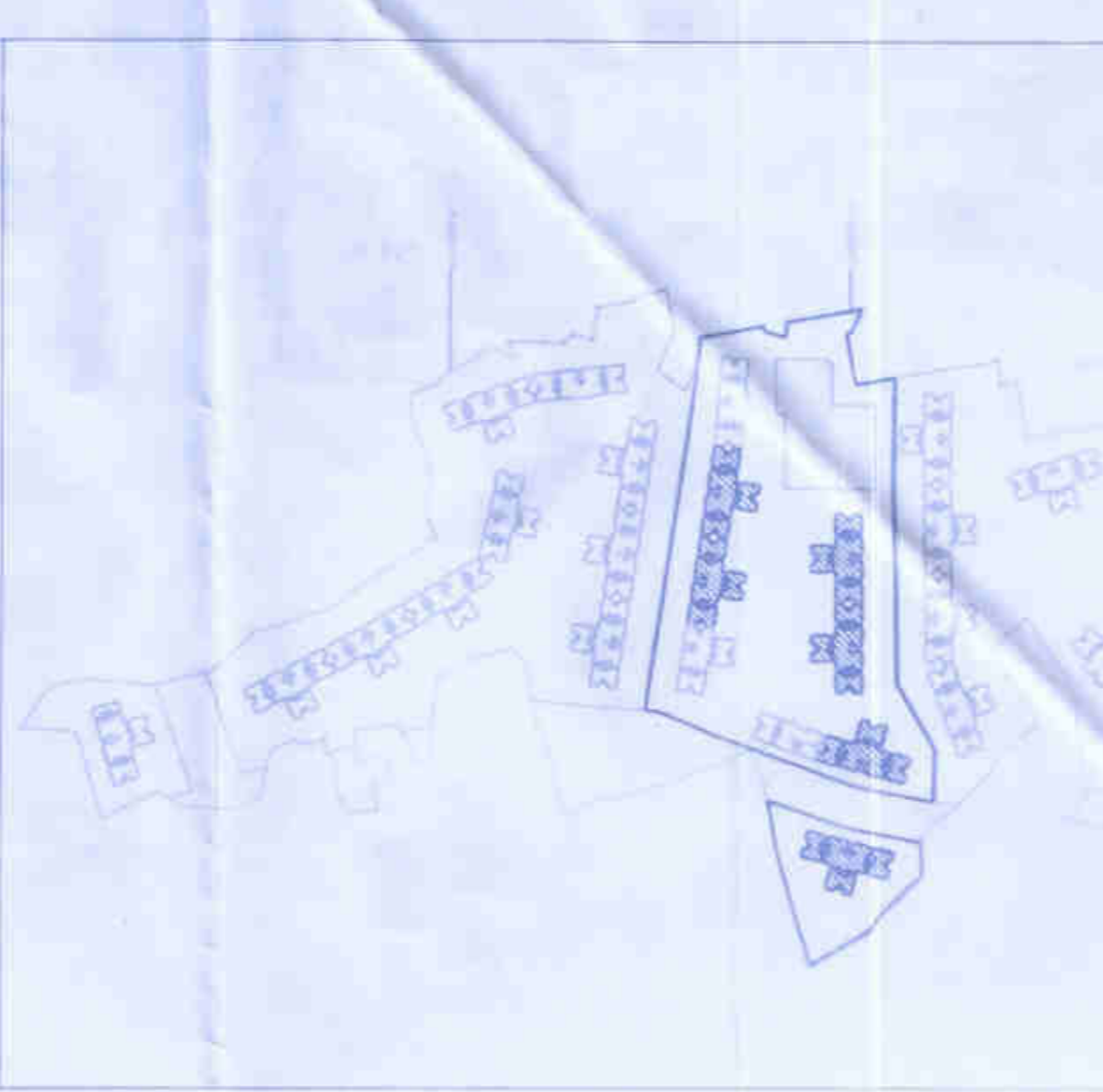

KEY PLAN
 SCALE - 1:4000

DESCRIPTION OF PROPOSAL & PROPERTY
 No. 202, 253, 254, 255, 256, 257, 258, 259, 260, 261, 262, 263, 264, 265, 266, 267, 268, 269, 270, 271, 272, 273, 274, 275, 276, 277, 278, 279, 280, 281, 282, 283, 284, 285, 286, 287, 288, 289, 290, 291, 292, 293, 294, 295, 296, 297, 298, 299, 300, 301, 302, 303, 304, 305, 306, 307, 308, 309, 310, 311, 312, 313, 314, 315, 316, 317, 318, 319, 320, 321, 322, 323, 324, 325, 326, 327, 328, 329, 330, 331, 332, 333, 334, 335, 336, 337, 338, 339, 340, 341, 342, 343, 344, 345, 346, 347, 348, 349, 350, 351, 352, 353, 354, 355, 356, 357, 358, 359, 360, 361, 362, 363, 364, 365, 366, 367, 368, 369, 370, 371, 372, 373, 374, 375, 376, 377, 378, 379, 380, 381, 382, 383, 384, 385, 386, 387, 388, 389, 390, 391, 392, 393, 394, 395, 396, 397, 398, 399, 400, 401, 402, 403, 404, 405, 406, 407, 408, 409, 410, 411, 412, 413, 414, 415, 416, 417, 418, 419, 420, 421, 422, 423, 424, 425, 426, 427, 428, 429, 430, 431, 432, 433, 434, 435, 436, 437, 438, 439, 440, 441, 442, 443, 444, 445, 446, 447, 448, 449, 450, 451, 452, 453, 454, 455, 456, 457, 458, 459, 460, 461, 462, 463, 464, 465, 466, 467, 468, 469, 470, 471, 472, 473, 474, 475, 476, 477, 478, 479, 480, 481, 482, 483, 484, 485, 486, 487, 488, 489, 490, 491, 492, 493, 494, 495, 496, 497, 498, 499, 500, 501, 502, 503, 504, 505, 506, 507, 508, 509, 510, 511, 512, 513, 514, 515, 516, 517, 518, 519, 520, 521, 522, 523, 524, 525, 526, 527, 528, 529, 530, 531, 532, 533, 534, 535, 536, 537, 538, 539, 540, 541, 542, 543, 544, 545, 546, 547, 548, 549, 550, 551, 552, 553, 554, 555, 556, 557, 558, 559, 560, 561, 562, 563, 564, 565, 566, 567, 568, 569, 570, 571, 572, 573, 574, 575, 576, 577, 578, 579, 580, 581, 582, 583, 584, 585, 586, 587, 588, 589, 590, 591, 592, 593, 594, 595, 596, 597, 598, 599, 600, 601, 602, 603, 604, 605, 606, 607, 608, 609, 610, 611, 612, 613, 614, 615, 616, 617, 618, 619, 620, 621, 622, 623, 624, 625, 626, 627, 628, 629, 630, 631, 632, 633, 634, 635, 636, 637, 638, 639, 640, 641, 642, 643, 644, 645, 646, 647, 648, 649, 650, 651, 652, 653, 654, 655, 656, 657, 658, 659, 660, 661, 662, 663, 664, 665, 666, 667, 668, 669, 670, 671, 672, 673, 674, 675, 676, 677, 678, 679, 680, 681, 682, 683, 684, 685, 686, 687, 688, 689, 690, 691, 692, 693, 694, 695, 696, 697, 698, 699, 700, 701, 702, 703, 704, 705, 706, 707, 708, 709, 710, 711, 712, 713, 714, 715, 716, 717, 718, 719, 720, 721, 722, 723, 724, 725, 726, 727, 728, 729, 730, 731, 732, 733, 734, 735, 736, 737, 738, 739, 740, 741, 742, 743, 744, 745, 746, 747, 748, 749, 750, 751, 752, 753, 754, 755, 756, 757, 758, 759, 760, 761, 762, 763, 764, 765, 766, 767, 768, 769, 770, 771, 772, 773, 774, 775, 776, 777, 778, 779, 780, 781, 782, 783, 784, 785, 786, 787, 788, 789, 790, 791, 792, 793, 794, 795, 796, 797, 798, 799, 800, 801, 802, 803, 804, 805, 806, 807, 808, 809, 810, 811, 812, 813, 814, 815, 816, 817, 818, 819, 820, 821, 822, 823, 824, 825, 826, 827, 828, 829, 830, 831, 832, 833, 834, 835, 836, 837, 838, 839, 840, 841, 842, 843, 844, 845, 846, 847, 848, 849, 850, 851, 852, 853, 854, 855, 856, 857, 858, 859, 860, 861, 862, 863, 864, 865, 866, 867, 868, 869, 870, 871, 872, 873, 874, 875, 876, 877, 878, 879, 880, 881, 882, 883, 884, 885, 886, 887, 888, 889, 890, 891, 892, 893, 894, 895, 896, 897, 898, 899, 900, 901, 902, 903, 904, 905, 906, 907, 908, 909, 910, 911, 912, 913, 914, 915, 916, 917, 918, 919, 920, 921, 922, 923, 924, 925, 926, 927, 928, 929, 930, 931, 932, 933, 934, 935, 936, 937, 938, 939, 940, 941, 942, 943, 944, 945, 946, 947, 948, 949, 950, 951, 952, 953, 954, 955, 956, 957, 958, 959, 960, 961, 962, 963, 964, 965, 966, 967, 968, 969, 970, 971, 972, 973, 974, 975, 976, 977, 978, 979, 980, 981, 982, 983, 984, 985, 986, 987, 988, 989, 990, 991, 992, 993, 994, 995, 996, 997, 998, 999, 1000.

TOWER 1 - (I, J, K, L & M)
 BUILT UP AREA CALCULATION FOR 2ND, 3RD REFUGE FLOOR

SR	LENGTH	WIDTH	MULTIPLIER	NUMBER OF FLOOR	TOTAL BUILT UP AREA
1	51.88	29.71	X	1	1541.35 SQM
2	2.86	0.60	X	1	30.89 SQM
3	1.25	0.07	X	1	10.37 SQM
4	1.25	0.07	X	1	25.38 SQM
5	4.75	2.00	X	4	38.00 SQM
6	17.96	13.75	X	2	493.90 SQM
7	1.00	0.60	X	1	1.20 SQM
8	0.88	0.57	X	2	9.97 SQM
9	10.43	1.25	X	1	10.43 SQM
10	4.19	1.25	X	1	11.72 SQM
11	2.00	2.53	X	1	10.48 SQM
12	1.91	0.07	X	2	0.27 SQM
13	0.45	1.75	X	1	4.73 SQM
14	1.71	2.21	X	1	22.67 SQM
15	1.50	4.31	X	3	19.40 SQM
16	1.50	4.31	X	1	4.73 SQM
17	2.28	5.07	X	1	11.46 SQM
18	2.28	5.07	X	1	11.46 SQM
SUB TOTAL DEDUCTION (Y1)					704.83 SQM
SUB TOTAL DEDUCTION (Y2)					3.29 SQM
SUB TOTAL DEDUCTION (Y3)					5.38 SQM
SUB TOTAL DEDUCTION (Y4)					0.67 SQM
SUB TOTAL DEDUCTION (Y5)					0.67 SQM
SUB TOTAL DEDUCTION (Y6)					10.00 SQM
SUB TOTAL DEDUCTION (Y7)					28.78 SQM
SUB TOTAL DEDUCTION (Y8)					48.13 SQM
SUB TOTAL DEDUCTION (Y9)					786.27 SQM
TOTAL BUILT UP AREA (Y10) = (Y1 - Y9)					756.09 SQM

REFUGE AREA STATEMENT (III)

NO.	AREA	CONSTRUCTION	COVERED	UNCOVERED	TOTAL
1	1.00	1.00	1.00	0.00	2.00
2	1.00	1.00	1.00	0.00	2.00
3	1.00	1.00	1.00	0.00	2.00
4	1.00	1.00	1.00	0.00	2.00
5	1.00	1.00	1.00	0.00	2.00
6	1.00	1.00	1.00	0.00	2.00
7	1.00	1.00	1.00	0.00	2.00
8	1.00	1.00	1.00	0.00	2.00
9	1.00	1.00	1.00	0.00	2.00
10	1.00	1.00	1.00	0.00	2.00
11	1.00	1.00	1.00	0.00	2.00
12	1.00	1.00	1.00	0.00	2.00
13	1.00	1.00	1.00	0.00	2.00
14	1.00	1.00	1.00	0.00	2.00
15	1.00	1.00	1.00	0.00	2.00
16	1.00	1.00	1.00	0.00	2.00
17	1.00	1.00	1.00	0.00	2.00
18	1.00	1.00	1.00	0.00	2.00
19	1.00	1.00	1.00	0.00	2.00
20	1.00	1.00	1.00	0.00	2.00
21	1.00	1.00	1.00	0.00	2.00
22	1.00	1.00	1.00	0.00	2.00
23	1.00	1.00	1.00	0.00	2.00
24	1.00	1.00	1.00	0.00	2.00
25	1.00	1.00	1.00	0.00	2.00
26	1.00	1.00	1.00	0.00	2.00
27	1.00	1.00	1.00	0.00	2.00
28	1.00	1.00	1.00	0.00	2.00
29	1.00	1.00	1.00	0.00	2.00
30	1.00	1.00	1.00	0.00	2.00
31	1.00	1.00	1.00	0.00	2.00
32	1.00	1.00	1.00	0.00	2.00
33	1.00	1.00	1.00	0.00	2.00
34	1.00	1.00	1.00	0.00	2.00
35	1.00	1.00	1.00	0.00	2.00
36	1.00	1.00	1.00	0.00	2.00
37	1.00	1.00	1.00	0.00	2.00
38	1.00	1.00	1.00	0.00	2.00
39	1.00	1.00	1.00	0.00	2.00
40	1.00	1.00	1.00	0.00	2.00
41	1.00	1.00	1.00	0.00	2.00
42	1.00	1.00	1.00	0.00	2.00
43	1.00	1.00	1.00	0.00	2.00
44	1.00	1.00	1.00	0.00	2.00
45	1.00	1.00	1.00	0.00	2.00
46	1.00	1.00	1.00	0.00	2.00
47	1.00	1.00	1.00	0.00	2.00
48	1.00	1.00	1.00	0.00	2.00
49	1.00	1.00	1.00	0.00	2.00
50	1.00	1.00	1.00	0.00	2.00
51	1.00	1.00	1.00	0.00	2.00
52	1.00	1.00	1.00	0.00	2.00
53	1.00	1.00	1.00	0.00	2.00
54	1.00	1.00	1.00	0.00	2.00
55	1.00	1.00	1.00	0.00	2.00
56	1.00	1.00	1.00	0.00	2.00
57	1.00	1.00	1.00	0.00	2.00
58	1.00	1.00	1.00	0.00	2.00
59	1.00	1.00	1.00	0.00	2.00
60	1.00	1.00	1.00	0.00	2.00
61	1.00	1.00	1.00	0.00	2.00
62	1.00	1.00	1.00	0.00	2.00
63	1.00	1.00	1.00	0.00	2.00
64	1.00	1.00	1.00	0.00	2.00
65	1.00	1.00	1.00	0.00	2.00
66	1.00	1.00	1.00	0.00	2.00
67	1.00	1.00	1.00	0.00	2.00
68	1.00	1.00	1.00	0.00	2.00
69	1.00	1.00	1.00	0.00	2.00
70	1.00	1.00	1.00	0.00	2.00
71	1.00	1.00	1.00	0.00	2.00
72	1.00	1.00	1.00	0.00	2.00
73	1.00	1.00	1.00	0.00	2.00
74	1.00	1.00	1.00	0.00	2.00
75	1.00	1.00	1.00	0.00	2.00
76	1.00	1.00	1.00	0.00	2.00
77	1.00	1.00	1.00	0.00	2.00
78	1.00	1.00	1.00	0.00	2.00
79	1.00	1.00	1.00	0.00	2.00
80	1.00	1.00	1.00	0.00	2.00
81	1.00	1.00	1.00	0.00	2.00
82	1.00	1.00	1.00	0.00	2.00
83	1.00	1.00	1.00	0.00	2.00
84	1.00	1.00	1.00	0.00	2.00
85	1.00	1.00	1.00	0.00	2.00
86	1.00	1.00	1.00	0.00	2.00
87	1.00	1.00	1.00	0.00	2.00
88	1.00	1.00	1.00	0.00	2.00
89	1.00	1.00	1.00	0.00	2.00
90	1.00	1.00	1.00	0.00	2.00
91	1.00	1.00	1.00	0.00	2.00
92	1.00	1.00	1.00	0.00	2.00
93	1.00	1.00	1.00	0.00	2.00
94	1.00	1.00	1.00	0.00	2.00
95	1.00	1.00	1.00	0.00	2.00
96	1.00	1.00	1.00	0.00	2.00
97	1.00	1.00	1.00	0.00	2.00
98	1.00	1.			