

FORM No. 4

Prescribed under rule 7

## LICENCE TO WORK A FACTORY

Registration number : 2524

Fee paid Rs. 480/-

Licence number : 2524

Excess/Due Rs. ---

Licence is hereby granted to M/s. Seagull Cooling Pvt. Ltd. valid only for the premises described below for use as a factory employing not more than 50 persons on any one day during the year and using motive power not exceeding 100 H. P., subject to the provisions of the Factories Act, 1948, and the Rules made under.

This Licence shall remain in force till the 31st day of December, 2012....

### DESCRIPTION OF THE LICENCED PREMISES

No. TPS/CP/Dadra/S.No.221/1/96/829

The Licenced premises on plan number          dated 03.12.1996 are situated in Srv. No. 221/1, 'G' Building, Part-II, Zero Tax Industrial Estate, Dadra, Silvassa.

and consist of a factory engaged in the manufacture of Airconditioners, Kits and Fan motor with capacitor.



Date : 11.07.2012.

Place : Silvassa.

  
Chief Inspector of Factories  
Chief Inspector of Factories & Boilers  
Administration of Dadra & Nagar Haveli  
SILVASSA.

### RENEWALS

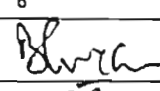
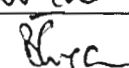
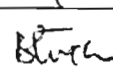
See rule 9

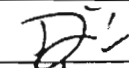
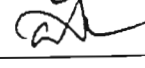
| Date of renewal | For workers | For H. P. | Fees Excess / Due | Date of expiry 31st December | Signature of renewing authority   |
|-----------------|-------------|-----------|-------------------|------------------------------|---|
| 1               | 2           | 3         | 4                 | 5                            | 6   |
| 15.3.2013       | NE/E 50     | NE/E 100  | e/d 2013 to       | 31.12.2014                   |  |
| 19.1.2015       | NE/E 50     | NE/E 100  | e/d 2015 to       | 31.12.2016.                  |  |
| 22.05.2017      | NE/E 50     | NE/E 100  | e/d 2017 to       | 31.12.2018.                  |  |
| 17.12.2018      | NE/E 50     | NE/E 100  | e/d 2019 to       | 31.12.2020.                  |  |
| 21.1.2021       | NE/E 50     | NE/E 100  | e/d 2021 to       | 31.12.2022.                  |  |
| 12.1.2023       | NE/E 50     | NE/E 100  | e/d 2023 to       | 31.12.2024.                  |  |
|                 | NE/E        | NE/E      | e/d               |                              |   |

NE - Not exceeding  
e - excess paid

E - Exceeding  
d - due to be paid

# VASTUKALA CONSULTANTS INDIA PVT. LTD.

## PROPERTY DETAILS

|  |   |                           |                              |
|--|---|---------------------------|------------------------------|
| Bank Name                              |   | Branch Name               |                              |
| Date of Visit                          | 15.09.2023  | Site Engineer             | Meetalj Rasal /<br>Manoj Sir |
| Name of Client                         | Cruise Electric Pvt. Ltd.   | Contact No.               |                              |
| Property Address                       | Ground, Survey No. 221/1, Gala No. G, Part II, Zerota<br>Industrial Estate, Vapi-Silvassa Road, Dadra & Nagar Haveli. |                           |                              |
| Premises of Flat/Office                | Contact Person Name & No.   | Narendra Jagir-8696280147 |                              |
| Distance from Station                  | 13 km from Vapi Station   | No. of Wings -            |                              |
| Latitude & Longitude                   | 20.326165, 72.963453  |                           |                              |
| Boundaries                             | Building Boundaries   |                           | Flat / Office / Shop / Gala  |
| North                                  | Ishan Industries  |                           |                              |
| South                                  | Open Plot   |                           |                              |
| East                                   | Ishan Industries  |                           |                              |
| West                                   | Access Road & Do Well<br>Moulds, LIZA factory   |                           |                              |
| Landmark                               |   |                           |                              |
| Present Occupied By                    | Owner / Tenant / Vacant   | Tenure Period             |                              |
| Name & Contact No. of Tenant           |   |                           |                              |
| Type of Road                           | B.T. / Cement / W.B.M. Road   | Width -                   | Corner / Intermittent        |
| <b>Area Calculation:</b>               | Builder's Saleable area   | Builder's Rate            |                              |
|  | Estate Agent Name   | Contact No.               |                              |
|  | Engineer Rate   | Lumpsum Value             |                              |
| Year of Construction                   | No. of Floors   | G+1                       |                              |
| No of Flats / Unit per floor           | Shop / Flat on ground floor in case   |                           |                              |
| Type of Parking                        | Open / Stilt / Podium / Basement / Tower Parking / Covered / Stack  |                           |                              |
| Source of Water Supply                 | No. of Lifts  | 1                         |                              |
| Type of Sewerage Syst.                 | Septic Tank / Sewerage Line   |                           |                              |
| Type of Finishing in Compound area     | Type of Door & Window   |                           |                              |
| Flooring                               | Kitchen   | Wiring                    | Plumbing                     |
| <b>If Under Construction Building:</b> | Slab  | Internal Brickwork        | External Brickwork           |
| Internal Plaster                       | External Plaster  | Internal Painting         | External Painting            |
| Door & Windows                         | Flooring / Tiling   | Kitchen Platform          | Electrification              |
| Plumbing & Sanitary Installation       | Lift Installation   |                           |                              |
| <b>MAHARERA DETAILS:</b>               | RERA PROJECT - YES / NO   | Certificate No.           |                              |

Specifications. → GF → RCC, structure  
 1<sup>st</sup> Floor → AC sheet Roofing, I-section beams,  
 concrete flooring, MS Grill windows,  
 powder coating Sliding Window.

Documents - Maintenance

- Light Bill
- PLAN

# ZERO TAX INDUSTRIAL ESTATE

CO-OPERATIVE INDUSTRIAL SERVICE SOCIETY LIMITED

Reg No. COOP/IND(S)/431

Survey No. 221/1, Main Gate, Zero Tax Industrial Estate, Vapi-Silvassa Road,  
Near Check Post, Dadra (D & N. H. & Daman & Diu) - 396 193. Email: zerotaxind@gmail.com

## MAINTENANCE CHARGES

Bill No.: **081**

GALA No.: Gr 2

DATE: 31/8/2023

Name of the Company: Cruise electre Private Limited

To,  
The Gala Owner  
Zero Tax Estate, Dadra(U.T.)

Dear Sirs,

We wish to inform you that your **ZERO TAX INDUSTRIAL ESTATE** to Maintain General Facilities such as Lighting, Water, Security, Garden and Street Cleaning of Industrial Estate for Month

of July & Aug 2023 is Rs. 3000/- Per month = 6000

Your Outstanding Maintenance as of Date is Rs. 5560/-

Kindly pay the regular Maintenance before the 10th of every month for the smooth running of the Society.

Please co-operate us to maintain the Zero Tax Industrial Estate Properly.

Thanking you,  
Your's Faithfully,

For **ZERO TAX INDUSTRIAL ESTATE**  
CO-OPERATIVE INDUSTRIAL SERVICE SOCIETY LIMITED

|                 |
|-----------------|
| PASS BY:.....   |
| CHECK BY:.....  |
| PAID            |
| CHEQUE NO:..... |
| CASH:.....      |
| DATE:.....      |
| AMOUNT:.....    |

Chairman / Secretary / Treasurer / Manager.

B. Mahi

CEDNK31EX/57  
14-09-23



Area DNH  
DN05/DN050007/  
T. No. 3004537568  
Billing mode 30 days  
ACT NO D/1729  
Bill No 208013969279



HELP US SERVE YOU BETTER  
**SCAN TO UPDATE YOUR DETAILS**  
 Mobile Number  
 E-mail id  
 PAN Card

NOTE: For all future transaction with us, request you to use your unique 9-digit new customer ID as shown below.

**YOUR DETAILS**

M/S. CRUISE ELECTRIC PVT. LTD.  
GALA NO.6-A & G.2  
ZEROTEX INDL. ESTATE, DADRA.  
DADRA (CT)  
DADRA

Registered Mobile No : \*\*\*\*\*9302

CATEGORY INDUSTRIAL  
SUPPLY TYPE Three Phase  
SANCTIONED LOAD 71.00 KW (95.0 HP)  
MAX. RECORDED DEMAND 106.52kVA  
BILLING MONTH August 2023  
READING DATE 04/09/2023  
BILL DATE 12/09/2023  
POWER FACTOR 0.91

**LTI**  
CUSTOMER ID 740003659  
SUB STATION 66 KV Dadra SS

**YOUR BILL**

DUE BY

SECURITY DEPOSIT HELD

ADDITIONAL SECURITY DEPOSIT REQUIRED

**METER DETAILS**

| Meter No.: SIL59586 |           |           |         |
|---------------------|-----------|-----------|---------|
|                     | KWH       | KVAH      | MDKVA   |
| Present Reading     | 779556.00 | 939830.00 | 106.520 |
| Previous Reading    | 762671.00 | 921286.00 | 0       |
| Multiplier *        | 1.00      | 1.00      | 1.00    |
| Consumption         | 16885.00  | 18544.00  | 106.520 |

**MAJOR BILL COMPONENTS**

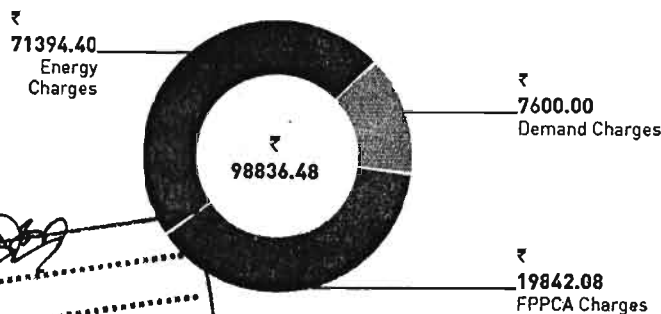

You consumed **18544.00 Units** this billing cycle.

**TOD CONSUMPTION**

|                  | Zone-1 | Zone-2 | Zone-3 |
|------------------|--------|--------|--------|
| Present Reading  | 0.00   | 0.00   | 0.00   |
| Previous Reading | 0.00   | 0.00   | 0.00   |
| Multiplier *     | 1.00   | 1.00   | 1.00   |
| Consumption      | 0.00   | 0.00   | 0.00   |

PASS BY: [Signature]  
CHECK BY: [Signature]  
PAID  
CONSUMPTION TREND (IN UNITS)  
DATE: [Signature]  
AMOUNT: [Signature]

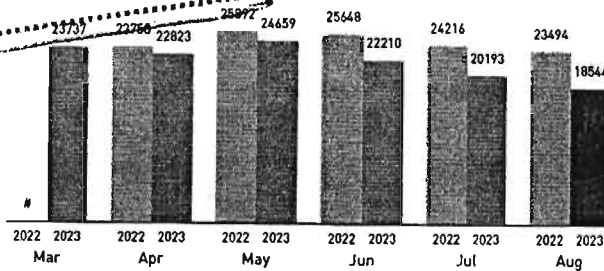

**PAYMENT OPTIONS**

1. SCAN THIS QR CODE TO PAY USING MOBILE WALLETS OR PAY ONLINE



2. PAY BY CASH/CHEQUE

You may pay your Bills at "Sarat Seva Kendra" near by you. You can pay Cash/Cheque at below addresses.

1st Floor, Vidvut Bhavan, Next to Secretariat, Kharali Colony, Dadra, Daman & Diu.

| 1 | 2    | 3    | 4   | 5 | 6 |
|---|------|------|-----|---|---|
|   | NE/E | NE/E | e/d |   |   |
|   | NE/E | NE/E | e/d |   |   |
|   | NE/E | NE/E | e/d |   |   |
|   | NE/E | NE/E | e/d |   |   |
|   | NE/E | NE/E | e/d |   |   |

**AMENDMENT**

| Year when amended | Amended<br>Workers               | Date of payment of amendment fee | Additional fee | Date of payment | Signature of the issuing authority |
|-------------------|----------------------------------|----------------------------------|----------------|-----------------|------------------------------------|
|                   | Installed power capacity in H.P. |                                  |                |                 |                                    |
|                   |                                  |                                  |                |                 |                                    |
|                   |                                  |                                  |                |                 |                                    |
|                   |                                  |                                  |                |                 |                                    |
|                   |                                  |                                  |                |                 |                                    |

**TRANSFERS**

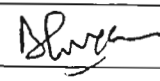
| To whom transferred                  | Year of transfer | Date of payment of transfer fee | Signature of the issuing authority  |
|--------------------------------------|------------------|---------------------------------|---|
| M/s. Cruis Electric Private Limited. | 2017             | 11.08.2017.                     |  |
|                                      |                  |                                 |   |

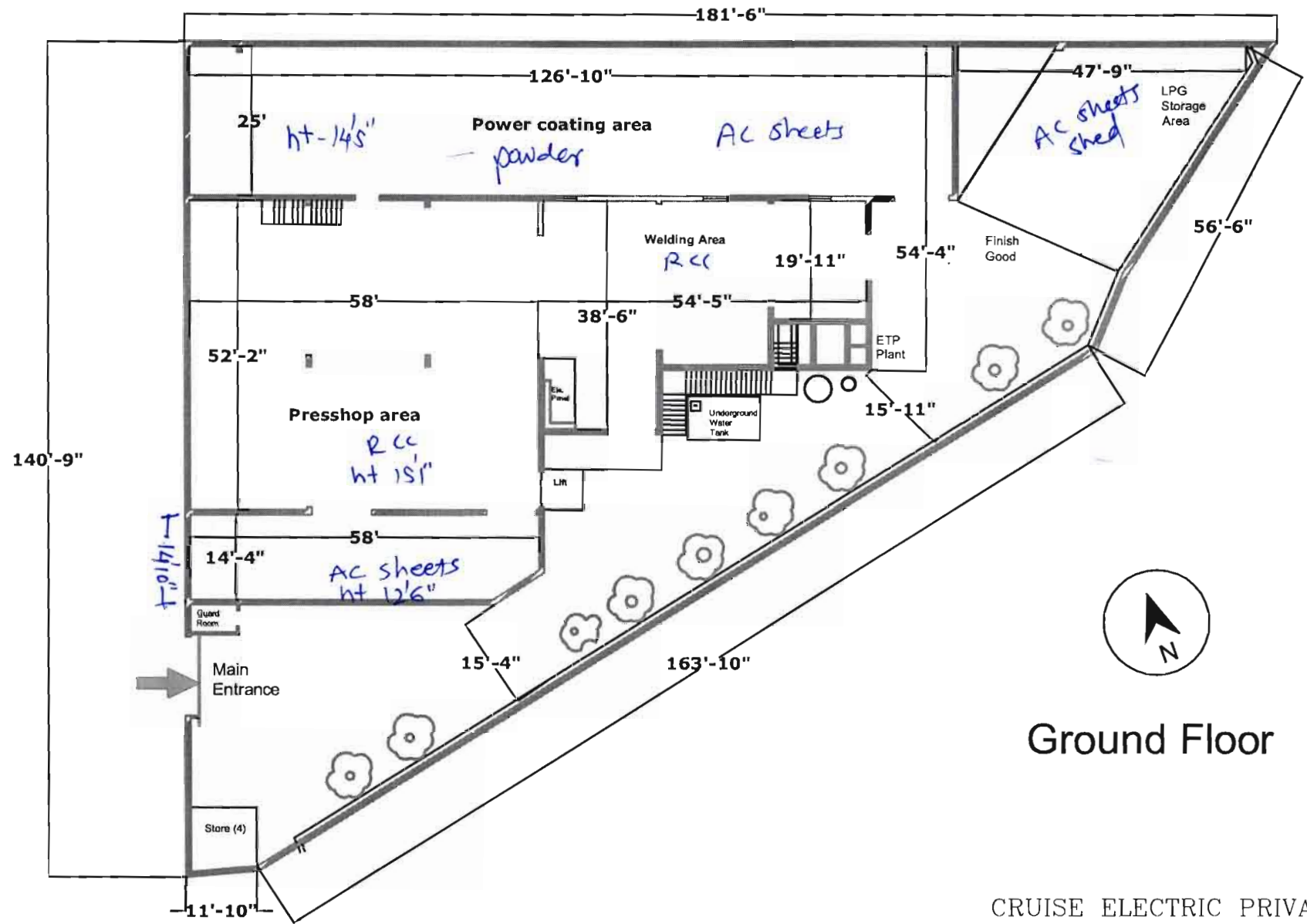

Ground Floor

CRUISE ELECTRIC PRIVATE LIMITED

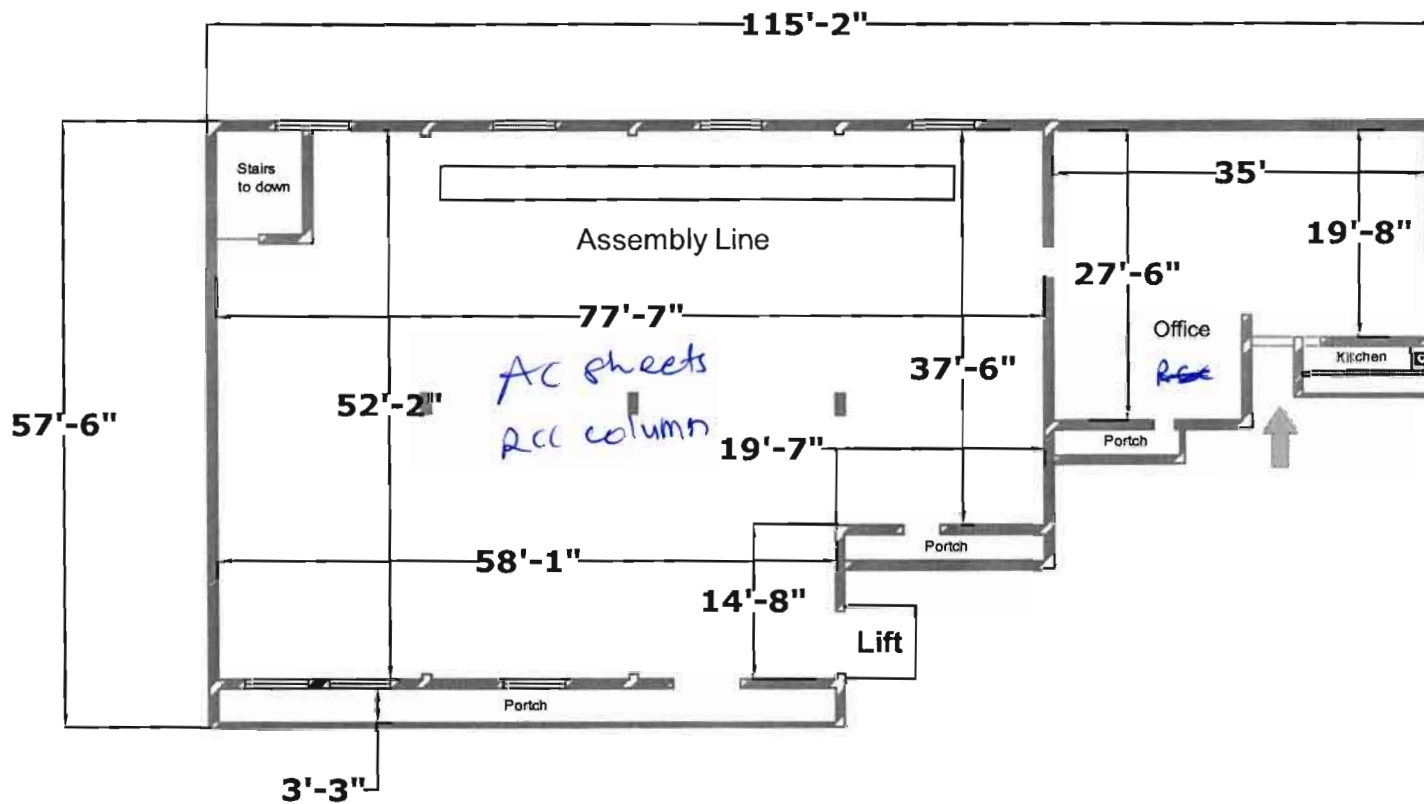

### 1st Floor UNIT 1

CRUISE ELECTRIC PRIVATE LIMITED





(Amended)

Government of India  
Form GST REG-06  
[See Rule 10(1)]

Registration Certificate

Registration Number :26AACCS7671Q1ZK

|  |  |  |   |    |    |
|--|--|--|---|----|----|
| 1.   | Legal Name                             | CRUISE ELECTRIC PRIVATE LIMITED  |   |    |    |
| 2.   | Trade Name, if any                     | CRUISE ELECTRIC PRIVATE LIMITED  |   |    |    |
| 3.   | Constitution of Business               | Private Limited Company  |   |    |    |
| 4.   | Address of Principal Place of Business | Ground, Surver No. 221/1, Gala No. G, Part - II, Zero Tax Industrial Estate, Vapi silvassa Road, Dadra, Dadra & Nagar Haveli, Dadra and Nagar Haveli, 396230 |   |    |    |
| 5.   | Date of Liability                      | 01/07/2017   |   |    |    |
| 6.   | Date of Validity                       | From   | 15/09/2017  | To | NA |
| 7.   | Type of Registration                   | Regular  |  |    |    |
| 8.   | Particulars of Approving Authority     |  |   |    |    |
| Dadra and Nagar Haveli Goods and Services Tax Act, 2017  |  |  |   |    |    |
| <i>Signature</i>   |  |  |   |    |    |
| Name   |  | Divyeshkumar Amrutsinh Mori  |   |    |    |
| Designation  |  | GST Officer  |   |    |    |
| Jurisdictional Office  |  | Silvassa   |   |    |    |
| 9.   | Date of issue of Certificate           | 26/09/2018   |   |    |    |
| Note: The registration certificate is required to be prominently displayed at all places of Business/Office(s) in the State. |  |  |   |    |    |

This is a system generated digitally signed Registration Certificate issued based on the approval of application granted on

**Details of Additional Place of Business(s)**



GSTIN 26AACCS7671Q1ZK  
Legal Name CRUISE ELECTRIC PRIVATE LIMITED  
Trade Name, if any CRUISE ELECTRIC PRIVATE LIMITED  
Total Number of Additional Places of Business(s) in the State 2

| Sr. No. | Address   |
|---------|---|
| 1       | Survey No.221/1, Gala No. A5,6,17,18,19, Ground, Zero Tax Industrial Estate, Dadra Silvassa Road, Dadra, Dadra & Nagar Haveli, Dadra and Nagar Haveli, 396230 |
| 2       | Survey No.221/1, Gala G Part II, Ground, Zero Tax Industrial Estate, Vapi Silvasa Road, Dadra, Dadra & Nagar Haveli, Dadra and Nagar Haveli, 396230           |





GSTIN 26AACCS7671Q1ZK  
Legal Name CRUISE ELECTRIC PRIVATE LIMITED  
Trade Name, if any CRUISE ELECTRIC PRIVATE LIMITED

**Details of Managing / Whole-time Directors and Key Managerial Persons**

|   |   |                    |                              |
|---|---|--------------------|------------------------------|
| 1 |  | Name               | PARASMAL BHIKAMCHAND SIROHLA |
|   |   | Designation/Status | DIRECTOR                     |
|   |   | Resident of State  | Maharashtra                  |
| 2 |  | Name               | SHAIENDRA KANT MISHRA        |
|   |   | Designation/Status | DIRECTOR                     |
|   |   | Resident of State  | Delhi                        |



ई- स्थायी लेखा संख्या कार्ड  
e - Permanent Account Number (e-PAN) Card  
AACCS7671Q

|   |  |   |
|---|--|---|
| पावती संख्या /<br>Acknowledgement Number                | 882031240185071  |    |
| नाम / Name  | CRUISE ELECTRIC PRIVATE LIMITED  |   |
| निगमन/गठन की तारीख<br>Date of Incorporation / Formation | 13/01/1998   |   |
| संचार का पता / Comm. Address                            | CRUISE ELECTRIC PRIVATE LIMITED<br>G-2 INDUSTRY HOUSE 23-B, MAHAL INDUSTRIAL EST<br>ANDHERI EAST MUMBAI MAHARASHTRA - 400093 |   |
|   |   | Signature valid<br>Digitally signed by Income Tax<br>PAN Services Unit, I.T.D.L.<br>eGovernance<br>Date: 2017.07.27 15:50:57 IST<br>Reason: My e-PAN Sign<br>Location: Mumbai |

- ✓ Permanent Account Number (PAN) facilitate Income Tax Department linking of various documents, including payment of taxes, assessment, tax demand, tax arrears, matching of information and easy maintenance & retrieval of electronic information etc. relating to a taxpayer.  
स्थायी लेखा संख्या (पैन) एक कार्यक्षमता से संबंधित विभिन्न दस्तावेजों को जोड़ने में आयकर विभाग को सहायक होता है, जिसमें करों के भुगतान, आकलन, कर मांग, टैक्स वसूली, सूचना के मिलान और इलेक्ट्रॉनिक जानकारी का आसान खरखाब व बहाली आदि भी शामिल है।
- ✓ Quoting of PAN is now mandatory for several transactions specified under Income Tax Act, 1961 (Refer Rule 114B of Income Tax Rules, 1962)  
आयकर अधिनियम, 1961 के तहत निर्दिष्ट कई लेवदेन के लिए स्थायी लेखा संख्या (पैन) का उल्लेख अब अनिवार्य है (आयकर नियम, 1962 के नियम 114B, का संदर्भ लें)
- ✓ Possessing or using more than one PAN is against the law & may attract penalty of upto Rs. 10,000.  
एक से अधिक स्थायी लेखा संख्या (पैन) का रखना या उपयोग करना, कानून के विरुद्ध है और इसके लिए 10,000 रुपये तक का दंड लगाया जा सकता है।

Gut

