

Reg No. : P-7386/22-1-1962



The Nasik Industrial Co-Operative Estate Ltd.

A-9, 2nd Floor, Nice Sankul, Padmashree Babubhai Rathi Chowk, Trimbak Road,

NICE-MIDC, Satpur, Nasik - 422 007. (+91 253 2350177, 2354477)

Fax : +91_253 2354477

E-mail : nicensik@gmail.com

Website : www.nicenashik.com

NICE

Ref.: No.: NICE/459/2022

Date :

Vikram Sarda
Chairman

Ramesh Vaishya
Vice Chairman

POSSESSION RECEIPT

This is to certify that M/s.Hotel Curry Leaves, Partnership Firm, Partners 1.Mr.Vikram Chaburao Ugale 2.Mrs.Jyoti Vikram Ugale, is a member of Nasik Industrial Co-operative Estate Ltd. Satpur, Nashik-422007 and Plot No.C-4/3, Area- 2035 Sq.Mtrs. has been allotted to them for industrial purpose.

The said plot No.C-4/3 is in the possession of M/s.Hotel Curry Leaves, Partnership Fir, Satpur, Nashik.

Dinesh Patil
MANAGER

Date : 15/12/2022

Place : Nashik

नासिक इंडस्ट्रियल को-ऑपरेटिव्ह इस्टेट लिमिटेड

अ-९, २ रा, मजला, नाईस संकुल, कै. पद्मश्री बाबुभाई राठी चौक, त्र्यंबक रोड, NICE MIDC एरिया, सातपूर नाशिक - ४२२ ००७.



Reg No. P -7386/22-1-1962

The Nasik Industrial Co-Operative Estate Ltd.

NICE

A-9, 2nd Floor, Nice Sankul, Padmashree Babubhai Rathi Chowk, Trimbak Road,

NICE-MIDC, Satpur, Nasik - 422 007. +91 253 2350177, 2354477

Fax : +91 253 2354477

E-mail : nicensik@gmail.com

Website : www.nicenashik.com

Ref.: No.: NICE / 460 / 2022

Date :

Vikram Sarda
Chairman

Ramesh Vaishya
Vice Chairman

CERTIFICATE

This is to certify that M/s. Hotel Curry Leaves, Partnership Firm, Partners 1. Mr. Vikram Chaburao Ugale 2. Mrs. Jyoti Vikram Ugale, is a member of Nasik Industrial Co-operative Estate Ltd. Satpur, Nashik-422007 and Plot No. C-4/3 has been allotted to them for industrial purpose.

The said plot No. C-4/3 is in the possession of M/s. Hotel Curry Leaves, Partnership Firm, Satpur, Nashik.

Dinesh Patil
MANAGER

Date : 15/12/2022

Place : Nashik

नासिक इंडस्ट्रियल को-ऑपरेटिव्ह इस्टेट लिमिटेड

अ-९, २ रा, मजला, नाईस संकुल, कै. पद्मश्री बाबुभाई राठी चौक, त्र्यंबक रोड, NICE MIDC एरिया, सातपूर नाशिक - ४२२ ००७.

Maharashtra Industrial Development Corporation

(A Government Of Maharashtra Undertaking)

Tel: (0253) 2364011, 2353489
Fax: 2352706
E-mail: ronashik@midcindia.org

REGIONAL OFFICE, NASHIK
UDYOG BHAVAN 2ND FLOOR, NEAR
I.T.I TRIMBAK ROAD, SATPUR,
NASHIK - 422007

By Regd. Post A.D.

Letter No.: MIDC/RO(NSK)/SAT/LMS-528/ D-75353

Date: - 07-DEC-2022.

Subject :- SATPUR INDUSTRIAL AREA
(NICE)
Plot No. C-4/3
Sub divided plot (Area 2035 Sq m.)
Request for grant of consent for transfer of...

Read :- Letter dated 14/11/2022.

ORDER

Lease dated the 06th day of August, 1978

Lessee

THE CHAIRMAN,
THE NASHIK INDUSTRIAL CO OP ESTATE LTD''''

Sub Lessee Date : 21ST-MAY-1985

SHRI. SHANTILAL MATHURBHAI PATEL.
Prop.Of. M/S. SHIVAM INDUSTRIES.

TRANSFER NO.-1 Date : 17/01/1985

1. SHRI. SHANTILAL MATHURBHAI PATEL.
2. SHRI .RAMESH SHANTILAL PATEL.
3. SHRI. DINESH SHANTILAL PATEL.
4. SHRI.DEEPAK SHANTILAL PATEL.

Partners of M/S. SHIVAM
INDUSTRIES.

TRANSFER NO.-02 (As Per 1986 Partnership Deed)

- 1.SHRI. SHANTILAL MATHURBHAI PATEL.
- 2.SHRI .RAMESH SHANTILAL PATEL.
- 3.SHRI. DINESH SHANTILAL PATEL.
- 4.SHRI.DEEPAK SHANTILAL PATEL.
- 5.SMT.DAHIBEN SHANTILAL PATEL

Partners of M/S. SHIVAM
INDUSTRIES.

TRANSFER NO.-03 (As Per 1987 Partnership Deed)

1. SHRI. SHANTILAL MATHURBHAI PATEL.
2. SHRI .RAMESH SHANTILAL PATEL.
3. SHRI.DEEPAK SHANTILAL PATEL.
4. SMT.DAHIBEN SHANTILAL PATEL

Partners of M/S. SHIVAM
INDUSTRIES.



MIDC/RO(NSK)/SAT/LMS-321/

TRANSFER NO-04 (As Per 1994 Partnership Deed)

1. SHRI. SHANTILAL MATHURBHAI PATEL.
2. SHRI .RAMESH SHANTILAL PATEL.
3. SHRI. DEEPAK SHANTILAL PATEL.
4. SHRI. BHAVIN DEEPAK PATEL.
5. SHRI. JITEN RAMESH PATEL.

Partners of M/S. SHIVAM INDUSTRIES.

TRANSFER NO-05 (As Per 2011 Partnership Deed)

1. SHRI .RAMESH SHANTILAL PATEL.
2. SHRI. DEEPAK SHANTILAL PATEL.
3. SHRI. BHAVIN DEEPAK PATEL.
4. SHRI. JITEN RAMESH PATEL.

Partners of M/S. SHIVAM INDUSTRIES.

TRANSFER NO-06 (As Per 2017 Partnership Deed)

1. SMT. AARTI RAMESH PATEL
2. SHRI. DEEPAK SHANTILAL PATEL.
3. SHRI. JITEN RAMESH PATEL.
4. SHRI. BHAVIN DEEPAK PATEL.

Partners of M/S. SHIVAM INDUSTRIES

SUBDIVISION ORDER NO. D-66607 DT. 08/11/2022

CURRENT TRANSFER- 07

SUBDIVISION PLOT NO C-4/2 (2035 sq.mt)

M/S. HOTEL CURRY LEAVES , Partnership Firm Partners

- 1) SHRI. VIKRAM CHABURAO UGALE & 2) SMT. JYOTI VIKRAM UGALE

By a marginally noted Lease executed by the Maharashtra Industrial Development Corporation in favour of the Lessee the Corporation in consideration of the stipulation and conditions on the part of the Lessee therein contained, agreed to grant in favour of the Lessee a lease of above plot of land and building and constructions erected thereon in the matter specified in the said lease. At the request of the Lessee the Corporation subdivided the said Plot No C-4 area admeasuring 9215 m².

The Lessees in pursuance of sub-clause (t) of clause-2 of the said Lease represented to the Corporation for grant to its consent for transfer and assignment of its interest under or the benefit of the said Lease in respect of the subdivided plot No. C-4/3 in favour of the transferee as under

Sr. No.	Plot No	Area in Sqm	Built-up Area	Transferee Name	Transferee Address	Mfg. Item
1	C-4/3	2035.00 Sqm.	00.00 Sq m.	M/S. HOTEL CURRY LEAVES	PLOT NO C-4/3 SATPUR (NICE)	ICE CREAM PLANT

The Corporation has after due consideration of the said request of the Lessee decided to grant its consent to the transfer by the Lessees at the benefit of its interest under the said Lease subject to the following condition:

- (a) The consent is hereby granted subject to payment to the Corporation by the Lessee of the sum of Rs. 19,01,393/- (Rs Nineteen Lakh One Thousand Three



Hundred Ninty Three only) Paid vide Online ERP Receipt.No.GL23437690 dated 05-December-2022.

(b)The consent is restricted to the transfer and assignment of the said agreement in favour of the transferees alone and in case the transferees purposes to make any further transfer of assignment or parting wholly or partially with the possession of the plot of land or any part thereof the transferees will have to make a fresh application for consent.

(c)The revised time schedule for obtaining B.C.C. is hereby granted for 2 years from the date of issue of sub division of plot order dt.08/11/2022.

(d)The Transferee should obtain all necessary Government permission and consent from MPCB before starting production.

(e)The lessee/s shall deliver at the Lessee/s expense a copy of the Deed of Assignment to the Corporation as provided in sub-clause(t) of clause-2 of the said lease and such copy shall be furnished in duplicate within 30 days of from the date of issue of this order.

(f) MIDC has no objection for grant of 75KW of Electrical load for manufacturing activity of transferee as mentioned above.

(g) The transferee shall utilize at least 40% FSI & obtain BCC on or before 07/11/2024 otherwise the terms and conditions mentioned in the circular No.C-05579 dt. 21/06/2019 will be binding on transferee.

(h) The transferee shall start its production activities within 2 years from the date of issue of this office Sub Divided of plot vide No.D-66607 dt. 08/11/2022 otherwise the guidelines for grant of extension of time limit will be binding on the transferee.

(i) The terms & conditions laid down in the Sub division order Dated- 08/11/2022 is binding on the transferee.

(j) The infrastructure of water supply is provided by MIDC, considering the water requirement of your plot at the rate of the 25 m³ per hect. Per day. For the requirement in excess of 25 m³ per Hect. Per day of your plot, you will be required to pay the capital contribution at rate of Rs.31,900/- per m³ on excess quantity of water or monthly standing charges @1.25% on the amount of capital contribution.

Thanking You,

MAHENDRA A SALI

Digitally signed by MAHENDRA A

SALI

Date: 2022.12.08 15:17:58 +05'30'

Area Manager,
MIDC, Nashik

TO,

**THE CHIARMAN, NICE,
PLOT NO. A-9, MIDC, NICE AREA, SATPUR, NASHIK,
Copy with compliments to**

1) **M/S. SHIVAM INDUSTRIES.
PLOT NO. C-4, MIDC, SATPUR INDL. AREA,
SATPUR NASIHK 422007.**

2) **SHRI VIKRAM CHABURAO UGALE & SMT. JYOTI VIKRAM UGALE
M/S. HOTEL CURRY LEAVES .
PLOT NO. C-4/3,
MIDC, SATPUR INDUSTRIAL AREA,
SATPUR, NASHIK 422007.**

Copy with compliments to:

1. **THE EXECUTIVE ENGINEER, MIDC, NASHIK DIVISION, NASHIK.**



MIDC/RO(NSK)/SAT/LMS-321/



NASHIK (SATPUR) INDUSTRIAL AREA
VILLAGE.-SATPUR
TAL.- NASHIK DIST.- NASHIK

MIDC ROAD 18.30 M R/W



SCALE : 1CM = 10 M

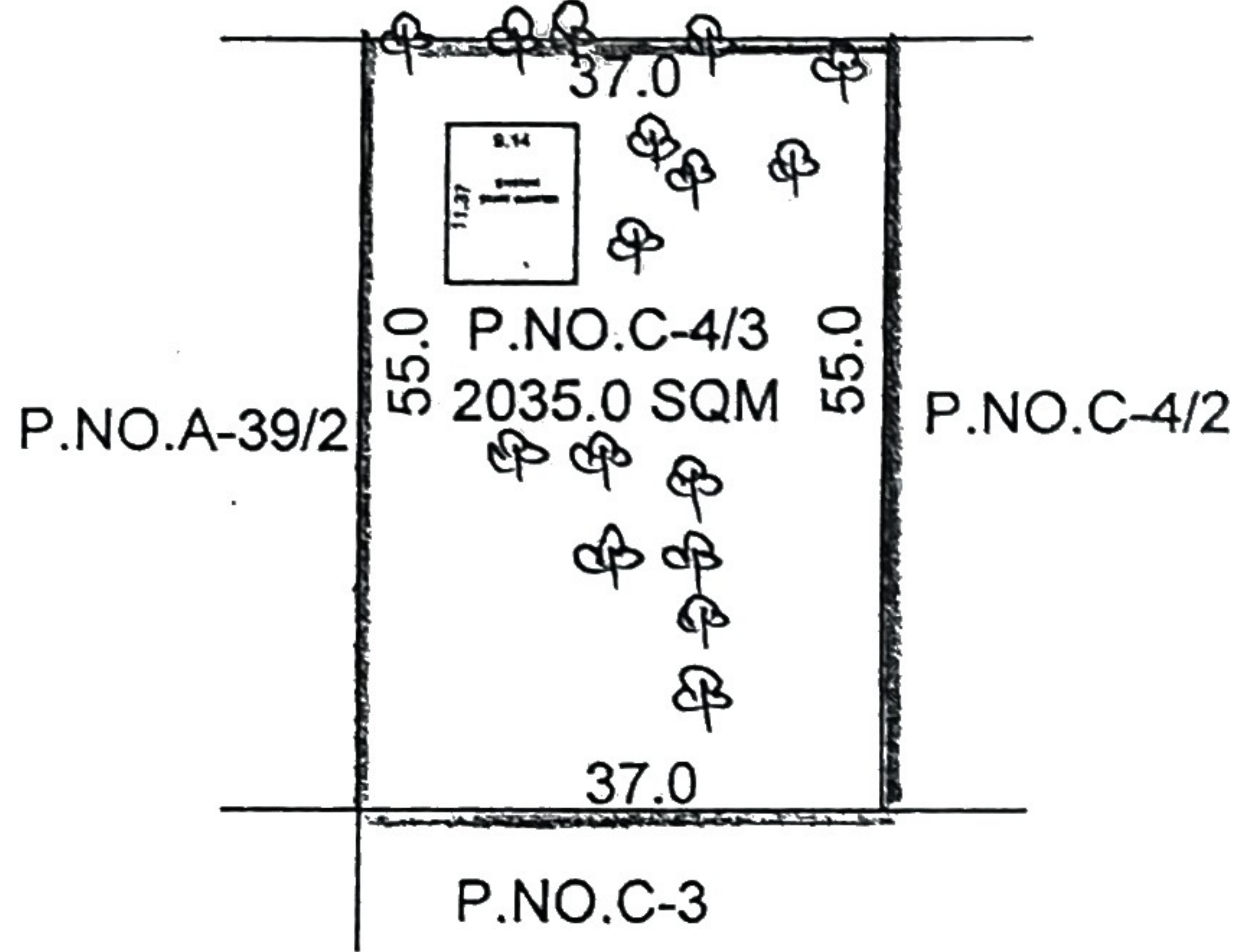

ककक याहमाणे म्हयण्य वामेवर झाडे मसे.

COPY PREPARED BY:-

(M.L.CHAUHAN)
SURVEYOR
R.O.NASHIK, MIDC