

STAMP OF APPROVAL OF PLAN

OFFICE OF THE KALYAN DOMBIVLI MUNICIPAL CORPORATION, KALYAN.

Building Permit No. : KDMC/TPD/BP/KD/2023-24/03.

Date :- 11/04/2023.

SANCTIONED



Signature of Assistant Director for Town Planning, Kalyan Dombivli Municipal Corporation.

BUILT UP AREA CALCULATION

8TH TO 9TH FLOOR							
A	25.68	X	40.85 X 1 NO	=	1049.03	SQ.MT.	
TOTAL ADDITION					=	1049.03	SQ.MT. X

DEDUCTIONS

1	5.30	X	1.75 X 1 NO	=	9.28	SQ.MT.	
2	3.55	X	1.20 X 1 NO	=	4.26	SQ.MT.	
3	13.83	X	1.75 X 1 NO	=	24.20	SQ.MT.	
4	10.38	X	4.55 X 1 NO	=	47.23	SQ.MT.	
5	1.65	X	4.55 X 1 NO	=	8.42	SQ.MT.	
6	0.30	X	1.85 X 1 NO	=	0.59	SQ.MT.	
7	1.90	X	5.23 X 1 NO	=	6.83	SQ.MT.	
8	1.70	X	3.95 X 1 NO	=	6.72	SQ.MT.	
9	2.05	X	2.50 X 1 NO	=	5.13	SQ.MT.	
10	8.83	X	1.95 X 1 NO	=	17.22	SQ.MT.	
11	9.83	X	0.65 X 1 NO	=	6.38	SQ.MT.	
12	11.53	X	1.90 X 1 NO	=	21.91	SQ.MT.	
13	11.05	X	3.40 X 1 NO	=	37.57	SQ.MT.	
14	11.85	X	1.90 X 1 NO	=	22.52	SQ.MT.	
15	8.85	X	1.95 X 1 NO	=	17.26	SQ.MT.	
16	10.30	X	0.50 X 1 NO	=	5.15	SQ.MT.	
17	8.85	X	3.05 X 1 NO	=	26.99	SQ.MT.	
18	0.70	X	3.00 X 1 NO	=	2.10	SQ.MT.	
19	1.90	X	2.85 X 1 NO	=	5.64	SQ.MT.	
20	2.43	X	5.10 X 1 NO	=	12.39	SQ.MT.	
21	2.20	X	3.05 X 2 NOS	=	13.42	SQ.MT.	
22	1.13	X	4.40 X 1 NO	=	4.97	SQ.MT.	
23	0.80	X	4.40 X 1 NO	=	3.52	SQ.MT.	
24	1.00	X	5.20 X 1 NO	=	5.20	SQ.MT.	
25	2.00	X	2.90 X 1 NO	=	5.00	SQ.MT.	
26	1.90	X	1.35 X 1 NO	=	2.57	SQ.MT.	
27	0.60	X	2.40 X 1 NO	=	1.44	SQ.MT.	
28	7.88	X	2.15 X 1 NO	=	16.51	SQ.MT.	
29	2.45	X	3.05 X 1 NO	=	7.47	SQ.MT.	
30	7.10	X	1.85 X 1 NO	=	13.14	SQ.MT.	
31	0.90	X	3.80 X 1 NO	=	1.90	SQ.MT.	
32	2.00	X	2.80 X 1 NO	=	5.60	SQ.MT.	
33	2.50	X	2.00 X 1 NO	=	5.00	SQ.MT.	
34	2.50	X	0.85 X 1 NO	=	2.13	SQ.MT.	
35	11.08	X	2.55 X 1 NO	=	28.25	SQ.MT.	
36	10.25	X	1.00 X 1 NO	=	10.25	SQ.MT.	
37	7.50	X	2.20 X 1 NO	=	16.50	SQ.MT.	
38	6.75	X	3.85 X 1 NO	=	24.64	SQ.MT.	
39	4.05	X	2.30 X 1 NO	=	9.32	SQ.MT.	
40	2.30	X	3.05 X 1 NO	=	7.02	SQ.MT.	
41	3.58	X	1.00 X 1 NO	=	3.58	SQ.MT.	
42	0.83	X	2.20 X 1 NO	=	1.83	SQ.MT.	
43	0.08	X	3.65 X 1 NO	=	0.29	SQ.MT.	
44	1/2	X	1.37 X 0.85 X 1 NO	=	0.47	SQ.MT.	
TOTAL DEDUCTION					=	477.92	SQ.MT. Y1
TOTAL BUILT UP AREA [X-Y]					=	571.21	SQ.MT. X1

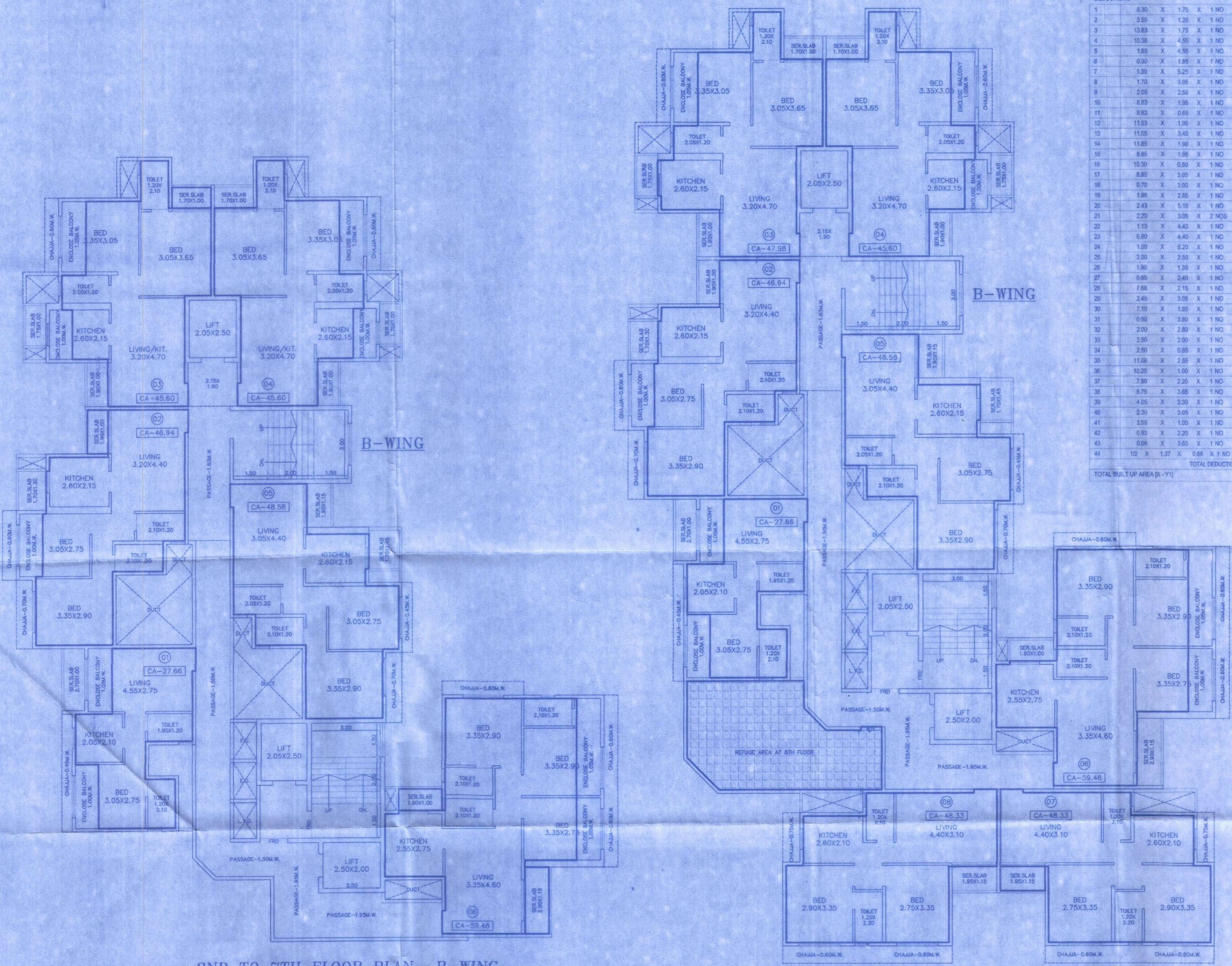

2ND TO 7TH FLOOR PLAN B-WING SCALE-1:100

8TH TO 9TH FLOOR PLAN B-WING SCALE-1:100

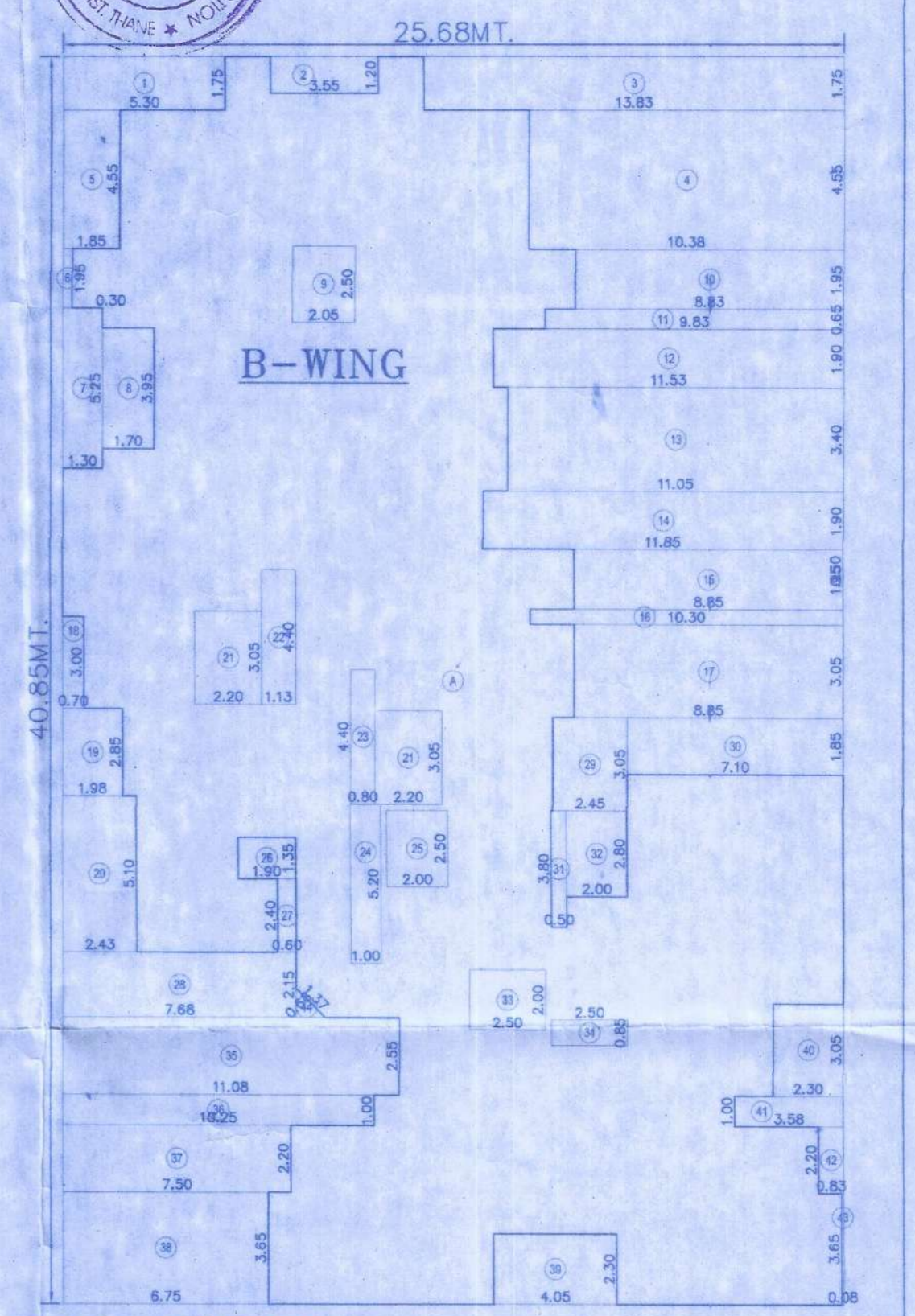

AREA DIAGRAM 8TH TO 9TH FLOOR SCALE-1:200

ARCHITECT:	ANIL R. NIRGUDE.	SIGNATURE OF OWNERS:	
911 04 DRG. NO.	PROPOSED REDEVELOPMENT BUILDING PLAN ON PLOT BEARING S.No.21 H.No.1A,10B &10C AT CHIKANGHAR, TAL. KALYAN, DIST. THANE		
AS SHOWN SCALE	FOR SECRETARY - NEW SAI PARK CO-OP HSG. SOC LTD & SAI SATCURU CO-OP HSG. SOC LTD		
10/03/2023 DATE	C.A. HOLDER : M/s. SAI SATYAM REALTY LLP FIRM THROUGH ITS PARTNERS RAVINDRA R. PATIL & OTHERS		
ANIL CHD. BY.	VITAN CONSULTANTS ARCHITECTS & ENGINEERS		
SUBHASH CAD/DRN	B-101, Bindu Tower, 1st Floor, Opp Lourdes English School, Santoshi Mata Road, Kalyan - 421301		

