

Approved Subject to the condition  
Mentioned in this office permission  
Letter No. SRA/ENCL/REP/2023/1475  
D-2-7-MAR-2023  
Executive Engineer  
Slum Rehabilitation Authority

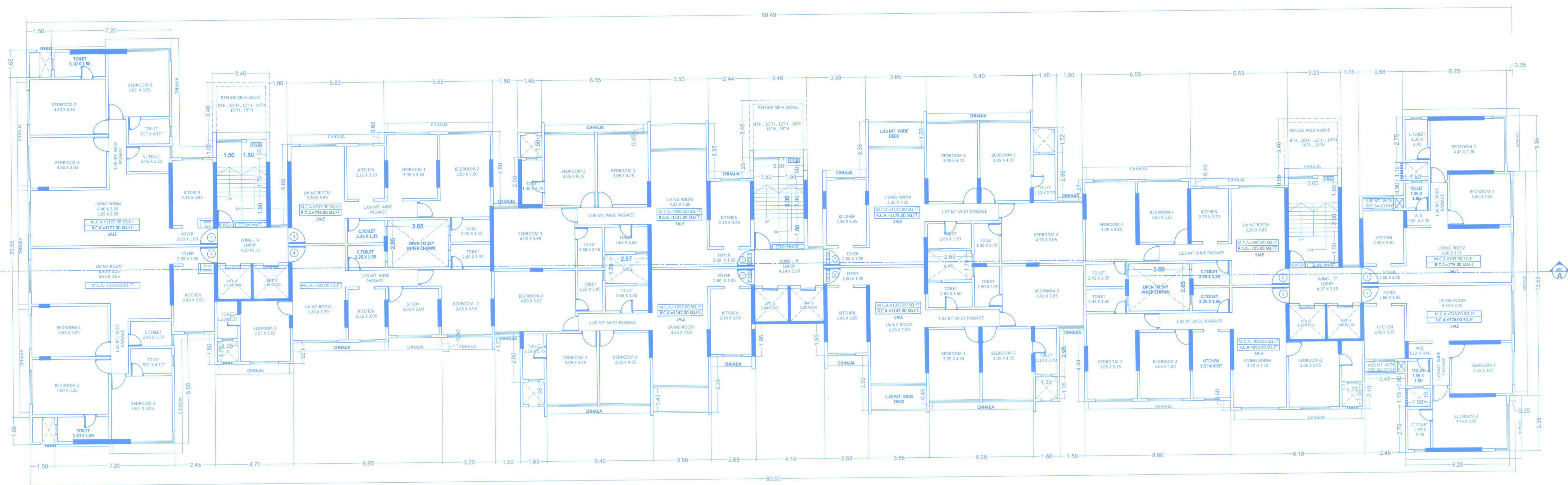

12TH FLOOR ( WING - A , B & C )  
SCALE = 1:100

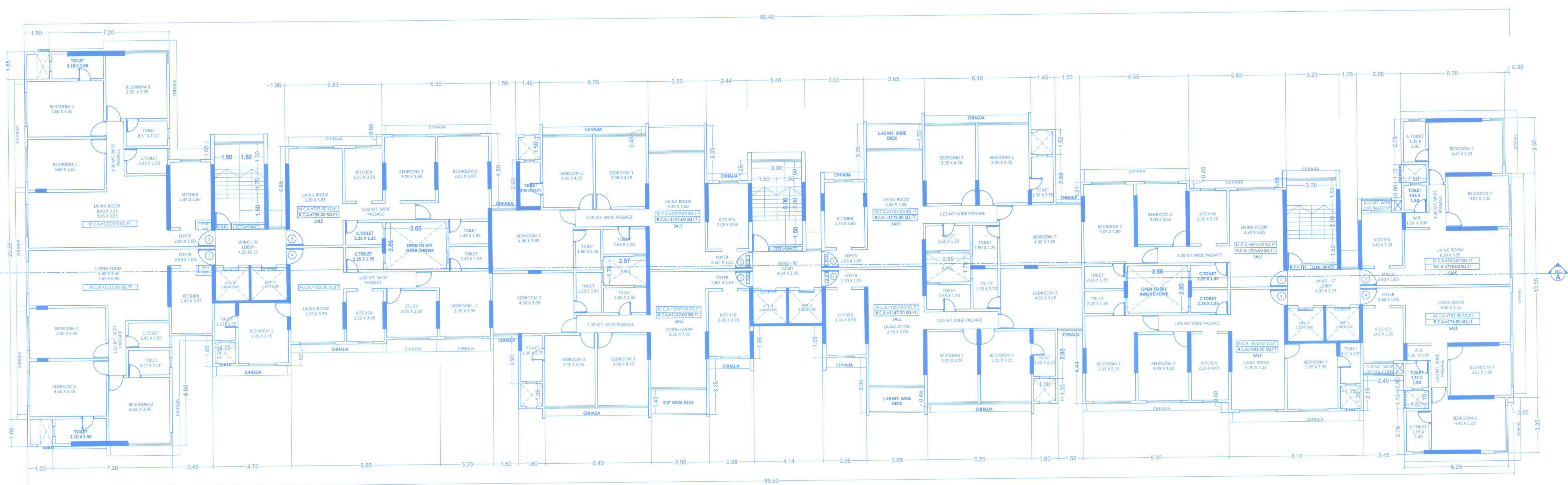

11TH FLOOR ( WING - A , B & C )  
SCALE = 1:100

<b>PROFORMA 'B'</b>	
<b>CONTENT OF SHEET</b>	
11TH & 12TH FLOOR PLAN,	
<b>STAMP OF APPROVAL OF PLANS.</b>	<b>STAMP OF DATE OF RECEIPT OF PLANS.</b>
<b>DESCRIPTION OF PROPOSAL &amp; PROPERTY</b>	
PROPOSED SRA SCHEME UNDER REG. 33(1) ON PLOT BEARING F.P. NO. 19/1 CTS NO. 5957 & F.P. NO. 20/1 CTS NO. 5958) TPS III OF VILLAGE GHATKOPAR KIROL.	
GHATKOPAR (EAST) - MUMBAI. 400077	
NAME OF SOCIETY : SHANKAR CHHAYA CHS.LTD. : KAILASH KIRAN CHS.LTD.	
NAME OF DEVELOPER	
FOR : M/S SHREE SAI REALTORS.	
<b>NAME, ADDRESS &amp; SIGNATURE OF ARCHITECT</b>	
<b>Architectural CONCEPT</b> 802, Skyline Wealth Space, C-2, Wing, Premier Road, Vidyavihar (West), Mumbai - 400 086. Tel.: 2510 0465, 2510 3561 Email : archconcept07@yahoo.co.in	
 <b>ROHIT PATIL</b> LIC. SURVEYOR	
<b>HORTH LINE</b>	<b>REMARK</b>
<b>JOB NO. :</b>	<b>SCALE :</b>
<b>DRAWN BY :</b>	<b>CHECK BY :</b>
<b>DATE :</b>	<b>CHKD BY :</b>