



VASTUKALA
Unlocking Excellence

www.vastukala.co.in

MSME Reg No: UDYAM-MH-18-0083617
An ISO 9001 : 2015 Certified Company
CIN: U74120MH2010PTC207869

Vastukala Consultants (I) Pvt. Ltd.

Vastu/Mumbai/09/2024/11227/2308234
19/08-240- SSPPY
Date: 19.09.2024

TO WHOMSOEVER IT MAY CONCERN

This is to certify that we have carried out actual site measurements on request of our Client **Mrs. Yashda Gondal** for Flat No. 602, 6th Floor, Ameet tower, Sindhi Immigrants Society, Near Wasan Motors, Chembur, Mumbai – 400 071, State - Maharashtra, Country – India and found that the **Total Carpet Area – 66.52 Sq. M. i.e., 716.02 Sq. Ft.**

For Vastukala Consultants (I) Pvt. Ltd.



Manoj B. Chalikwar
Registered Valuer
Chartered Engineer (India)
Reg. No. CAT-I-F-1763

Our Pan India Presence at :

- | | | | |
|------------|--------|-----------|-----------|
| Nanded | Thane | Ahmedabad | Delhi NCR |
| Mumbai | Nashik | Rajkot | Raipur |
| Aurangabad | Pune | Indore | Jaipur |

Regd. Office

BI-001, U/B Floor, BOOMERANG, Chandivali Farm Road, Powai, Andheri East, **Mumbai**: 400072, (M.S), India

+91 2247495919

mumbai@vastukala.co.in

www.vastukala.co.in



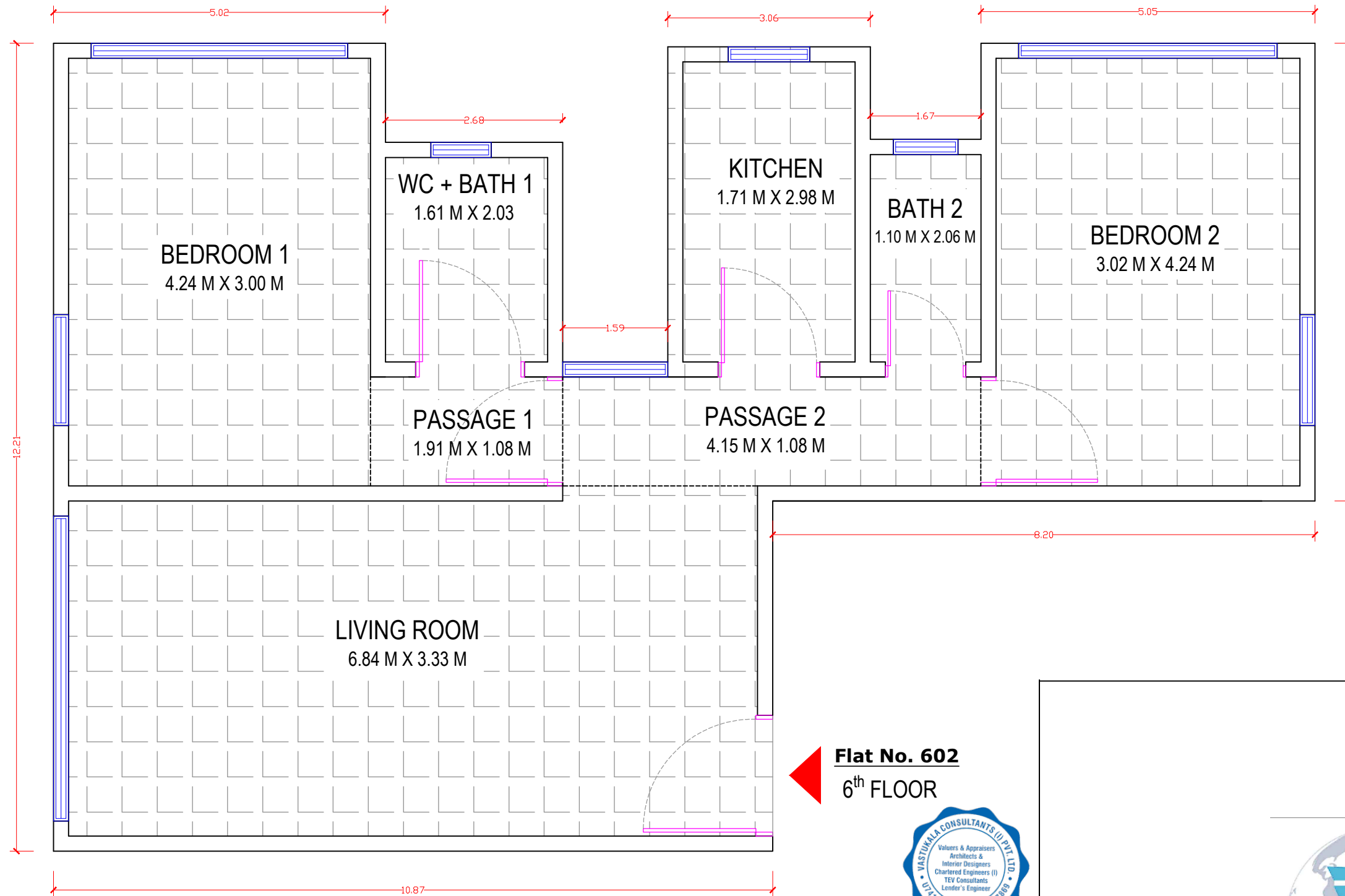

SITE MEASUREMENT AREA

P-Line Area :-
Carpet Area = 716.02 Sq. Ft.
i.e 66.52 Sq. Mtr.
 (Including Door Jamb)

Flat No. 602
6th FLOOR



Name Of Client: Dr. Yashda Gondal.

Address: 602, Ameet Tower, Sindhi Immigrants Society,
 Chembur, Near Wasan Motors, Mumbai - 400071, State -
 Maharashtra, Country - India.

Signed By: Er. Manoj Chalikwar

Checked By : Er. Prayush Parekh

Drawing By : Er. Saiprasad Patil

Visit By : Er. Saiprasad Patil

Date : 18/09/2024

REGD. OFFICE:

Mumbai : Vastukala Consultants (I) Pvt. Ltd., Unit No. B1-001, Upper
 Basement Floor, Boomrang, Chandivali Farm Road, Powai, Andheri
 (East) Mumbai - 400 072 , State - Maharashtra, Country - INDIA.
 Tel:- +91 2247495919