

TERRACE FLOOR PLAN

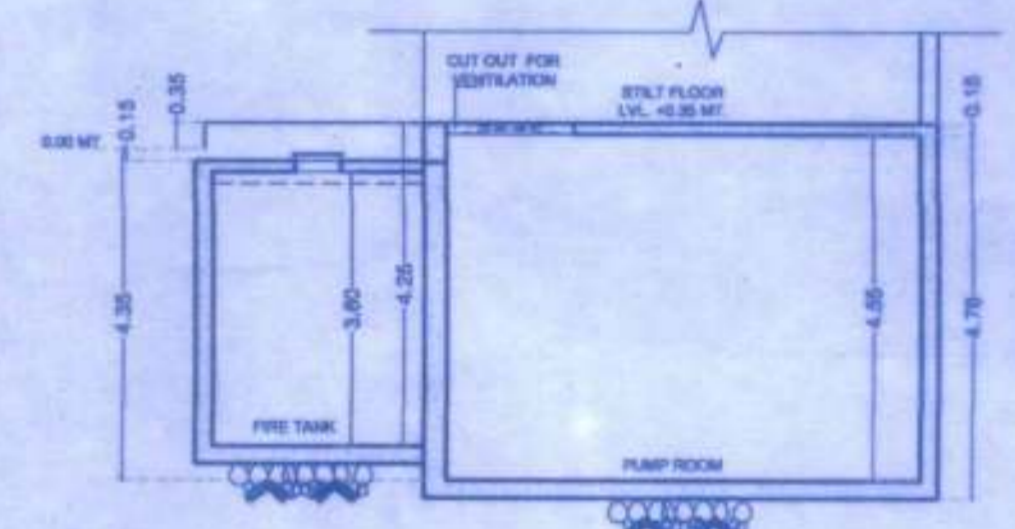

SECTION C-C'

- NOTE :-
1. - ALL DIMENSIONS AREA IN METER
 2. - SCALE USE
A). - FLOOR PLAN = 1:100
B). - BLOCK PLAN = 1:500
C). - LOCATION PLAN = 1: 4000
 3. - THE PLANS AREA PROPOSED AS PER PROVISION OF DCPR 2034 AND AS PER PREVIOUS REGULATION AND CIRCULAR ISSUED BY MCGM AND MHADA TIME TO TIME.
 4. - GUIDELINES ISSUED IN EODB FOLLOWS.
 5. - THE ARITHMETICAL CALCULATION CHECK BY ME AND FOUND CORRECT

PROFORMA -- B	
CONTENTS OF SHEET ->	SECTION A-A', SECTION C-C', TERRACE FLOOR PLAN,
NOTES -> BOUNDARY OF PLOT SHOWN BOUNDED BLACK, PROPOSED BUILDING SHOWN PINK, BUILDING TO BE DEMOLISHED SHOWN YELLOW DOTTED.	
DESCRIPTION -> PROPOSED REDEVELOPMENT OF EXISTING OM SAI SADAN CHS, PROPERTY BEARING M.H.A.D.A. LAYOUT PLOT NO.117 AT GORAI 2, BORIVALI (WEST) MUMBAI-400092.	
NAME OF DEVELOPER -> AKASH REALTY	
NAME OF OWNER -> OM SAI SADAN C.H.S.	
SIGNATURE OF OWNER	SIGNATURE OF LICENSED ARCHITECT
For Om Sai Sadan C.H.S. Ltd.	<i>[Signature]</i>
Chairman / Secretary / Treasurer	<i>[Signature]</i>
FILE NO. ->	VILAS DINGHT (REGD. ARCHT) 07/367/LS
JOB NO. -> ARCH / SAISON / 234	HODS, DINGHT (REGISTERED) 07/367/LS
DRG. NO. ->	317, 6-SQUARE, SUBHASH ROAD, ABOVE STATE BANK OF INDIA, VILE PARLE-EAST, MUMBAI 400 057. TEL. -#1 22 28120634
DRAWN BY -> MANALI	
CHK BY ->	
DATE ->	
SCALE -> 1: 100	
SUB. ENGINEER	
Approved subject to conditions mentioned in this office Letter No. Mhada Date: 04 MAR 2021	
ASSISTANCE ENGINEER	Ex. Eng. <i>[Signature]</i> Maharashtra Housing & Area Development Authority
EXECUTIVE ENGINEER	