

## Valuation Report of the Immovable Property



### Details of the property under consideration:

Name of Owner: **M/s. Savita Oils Technologies Ltd.**

Industrial Land & Building on Plot No. 17 & 17A, TTC Industrial Area, M.I.D.C., Thane – Belapur Road, Turbhe, Village – Pawane, Taluka & Dist. Thane - 400703, State - Maharashtra, Country – India

Longitude Latitude: 19°05'02.5"N 73°01'03.3"E

Think.Innovate.Create

### Valuation Done for:

**State Bank of India**

**Commercial Branch (Fort)**

AMT-I, 2nd Floor, Commercial Branch, N. G. N. Vaidya Marg, Horniman Circle, Fort, Mumbai - 400 001, State - Maharashtra, Country - India



#### Our Pan India Presence at :

Mumbai Aurangabad Pune Rajkot  
Thane Nanded Indore Raipur  
Delhi NCR Nashik Ahmedabad Jaipur

**Regd. Office :** B1-001, U/B Floor, Boomerang, Chandivali Farm Road, Andheri (East), Mumbai - 400 072, (M.S.), INDIA  
TeleFax : +91 22 28371325/24  
mumbai@vastukala.org

## INDEX

| Particulars  | Page No. |
|--|----------|
| 1. VALUATION OPINION REPORT .....                                | 3        |
| 2. VALUATION REPORT (IN RESPECT OF LAND AND BUILDING).....       | 4        |
| 3. TOTAL ABSTRACT OF THE ENTIRE PROPERTY.....                    | 13       |
| 4. ACTUAL SITE PHOTOGRAPHS .....                                 | 14       |
| 5. ROUTE MAP OF THE PROPERTY.....                                | 19       |
| 6. M.I.D.C. LAYOUT MAP .....                                     | 20       |
| 7. Plot Map .....  | 21       |
| 8. M.I.D.C. CIRCLE RATE FOR LAND .....                           | 22       |
| 9. PRICE INDICATORS.....   | 23       |
| 10. JUSTIFICATION FOR PRICE /RATE.....                           | 25       |
| 11. DECLARATION-CUM-UNDERTAKING .....                            | 27       |
| 12. ASSUMPTIONS, DISCLAIMERS, LIMITATIONS & QUALIFICATIONS ..... | 30       |
| 13. ASSUMPTIONS, CAVEATS, LIMITATION AND DISCLAIMERS.....        | 33       |
| 14. MODEL CODE OF CONDUCT FOR VALUERS .....                      | 34       |
| 15. DEFINITION OF VALUE FOR THIS SPECIFIC PURPOSE.....           | 37       |

Think.Innovate.Create



## 1. VALUATION OPINION REPORT

This is to certify that the property bearing Industrial Land & Building on Plot No. 17 & 17A, TTC Industrial Area, M.I.D.C., Thane – Belapur Road, Turbhe, Village – Pawane, Taluka & Dist. Thane - 400703, State - Maharashtra, Country – India belongs to **M/s. Savita Oils Technologies Ltd.**

Boundaries of the property.

|       |   |                                  |
|-------|---|----------------------------------|
| North | : | Savita Chemical Road & Open area |
| South | : | Under Construction Building      |
| East  | : | Asian Paints                     |
| West  | : | Thane Belapur Road               |

Considering various parameters recorded, existing economic scenario, and the information that is available with reference to the development of neighborhood and method selected for valuation, we are of the opinion that, the property premises can be assessed and Fair Market Value for this particular purpose at

| Particulars       | Fair Market Value In<br>(₹) | Realizable Value In<br>(₹) | Distress Sale Value<br>In (₹) | Insurable Value In<br>(₹) |
|-------------------|-----------------------------|----------------------------|-------------------------------|---------------------------|
| Land and Building | ₹ 126,32,09,129/-           | ₹ 113,68,88,216/-          | ₹ 101,05,67,303/-             | ₹ 8,14,50,093/-           |

The valuation of the property is based on the documents produced by the concern. Legal aspects have not been taken into considerations while preparing this valuation report.

Hence certified

For **VASTUKALA CONSULTANTS (I) PVT. LTD.**

**Sharadkumar  
B. Chalikwar**

**Director**

**Sharadkumar B. Chalikwar**

Govt. Reg. Valuer

Chartered Engineer (India)

Reg. No. (N) CCIT/1-14/52/2008-09

SBI Empanelment No.: SME/TCC/2021-22/85/13

Digitally signed by Sharadkumar B. Chalikwar  
DN: cn=Sharadkumar B. Chalikwar,  
o=Vastukala Consultants (I) Pvt. Ltd.,  
ou=CMD, email=cmd@vastukala.org, c=IN  
Date: 2023.08.03 11:26:45 +05'30'

Auth. Sign.



### Our Pan India Presence at :

|           |            |           |        |
|-----------|------------|-----------|--------|
| Mumbai    | Aurangabad | Pune      | Rajkot |
| Thane     | Nanded     | Indore    | Raipur |
| Delhi NCR | Nashik     | Ahmedabad | Jaipur |

**Regd. Office** : B1-001, UJEB Floor, Boomerang,  
Chandivali Farm Road, Andheri (East),  
Mumbai - 400 072, (M.S.), INDIA  
TeleFax : +91 22 28371325/24  
mumbai@vastukala.org



**Vastukala Consultants (I) Pvt. Ltd.**B1-001, U/B Floor, **Boomerang**, Chandivali Farm Road, Powai, Andheri (East), Mumbai – 400 072

To,

**The Branch Manager,****State Bank of India****Commercial Branch (Fort)**

AMT-V, 2nd Floor, Commercial Branch,

N. G. N. Vaidya Marg, Horniman Circle,

Fort, Mumbai - 400 001,

State - Maharashtra, Country - India

**2. VALUATION REPORT (IN RESPECT OF LAND AND BUILDING)**

| <b>I General</b> |  |
|------------------|--|
| 1.               | Purpose for which the valuation is made : As per the request from State Bank of India, Commercial Fort Branch to assess Fair market value of the property for banking purpose.   |
| 2.               | a) Date of inspection : 13.04.2023<br>b) Date on which the valuation is made : 03.08.2023  |
| 3.               | Copy of List of documents produced for perusal<br>1. Copy of Lease Agreement dated 03.11.1978 between MIDC (Lessor) and M/s. Savita Chemicals Private Limited (Lessee).<br>2. Copy of Approved Plan vide No. PLN / THN / 347 /2013 / CPP / 106 / Thane dated 10.04.2014 issued by Industrial Safety & Fields, MIDC.<br>3. Copy of Approved Plan subject to Letter vide No. TTC / 17 / 17A / 6758 dated 21.08.1998 issued by Executive Engineer, MIDC Division No. II, Thane.<br>4. Copy of Approved Plan subject to Letter vide No. TTC / 17 / 17A / 6757 dated 21.08.1998 issued by Executive Engineer, MIDC Division No. II, Thane<br>5. Copy of Approved Plan subject to Letter vide No. DE / MHP (C) I / Plot / 17 / 17A / 2104 dated 04.08.2009 issued by Dy. Engineer, Special Planning Authority, MIDC , Mahape I.<br>6. Copy of Digital Approved Plan dated 26.02.2022 issued by MIDC.<br>7. Copy of Sanction of Building Permit vide No. DE / SPA / 17 & 17A / C – 61765 / 2014 dated 06.09.2014 issued by Office of the Dy. Engineer & Special Planning Authority, MIDC Sub – Dn.1 (Civil) Mahape for approval to expansion for factory shed.<br>8. Copy of Water Bill dated 05.05.2023 in the name of M/s. Savita Oils Technologies Ltd.<br>9. Copy of Electricity Bill dated 08.05.2023 in the name of M/s. Savita Oils Technologies Ltd.<br>10. Copy of Property Tax Bill vide No. PT-D-MP-1157 dated 01.04.2023 for the period of 01.04.2023 to 30.09.2023 in the name of M/s. Savita Oils Technologies Ltd. |
| 4.               | Name of the owner(s) and his / their address (es) with Phone no. (details of share of each owner in case of joint ownership) : <b>M/s. Savita Oils Technologies Ltd.</b><br><br><u>Address:</u> Industrial Land & Building on Plot No. 17 & 17A, TTC Industrial Area, M.I.D.C., Thane – Belapur Road, Turbhe, Village – Pawane, Taluka & Dist. Thane - 400703, State - Maharashtra, Country – India<br><br><u>Contact Person –</u><br>Mr. Pravin Gangurde (HR & Admin)   |

|  | Contact No. 91 98679 03660  |                |                        |                                     |          |     |           |              |                  |           |             |                       |   |              |   |             |   |              |                                     |             |                                  |           |                        |                |                        |                                     |                                 |        |      |       |       |                      |        |      |       |       |                                  |  |  |  |  |              |        |      |       |       |           |        |      |       |       |           |        |      |       |       |                     |        |      |       |       |                       |      |      |       |       |             |        |      |       |       |                                     |       |      |       |       |                                   |        |      |       |       |                     |        |      |       |       |                     |       |      |       |       |                    |       |      |       |       |                            |        |      |       |       |
|--|---|----------------|------------------------|-------------------------------------|----------|-----|-----------|--------------|------------------|-----------|-------------|-----------------------|---|--------------|---|-------------|---|--------------|-------------------------------------|-------------|----------------------------------|-----------|------------------------|----------------|------------------------|-------------------------------------|---------------------------------|--------|------|-------|-------|----------------------|--------|------|-------|-------|----------------------------------|--|--|--|--|--------------|--------|------|-------|-------|-----------|--------|------|-------|-------|-----------|--------|------|-------|-------|---------------------|--------|------|-------|-------|-----------------------|------|------|-------|-------|-------------|--------|------|-------|-------|-------------------------------------|-------|------|-------|-------|-----------------------------------|--------|------|-------|-------|---------------------|--------|------|-------|-------|---------------------|-------|------|-------|-------|--------------------|-------|------|-------|-------|----------------------------|--------|------|-------|-------|
|  | Limited Company Ownership   |                |                        |                                     |          |     |           |              |                  |           |             |                       |   |              |   |             |   |              |                                     |             |                                  |           |                        |                |                        |                                     |                                 |        |      |       |       |                      |        |      |       |       |                                  |  |  |  |  |              |        |      |       |       |           |        |      |       |       |           |        |      |       |       |                     |        |      |       |       |                       |      |      |       |       |             |        |      |       |       |                                     |       |      |       |       |                                   |        |      |       |       |                     |        |      |       |       |                     |       |      |       |       |                    |       |      |       |       |                            |        |      |       |       |
| 5.   | Brief description of the property (Including Leasehold / freehold etc.)   |                |                        |                                     |          |     |           |              |                  |           |             |                       |   |              |   |             |   |              |                                     |             |                                  |           |                        |                |                        |                                     |                                 |        |      |       |       |                      |        |      |       |       |                                  |  |  |  |  |              |        |      |       |       |           |        |      |       |       |           |        |      |       |       |                     |        |      |       |       |                       |      |      |       |       |             |        |      |       |       |                                     |       |      |       |       |                                   |        |      |       |       |                     |        |      |       |       |                     |       |      |       |       |                    |       |      |       |       |                            |        |      |       |       |
| <p><b>Property:</b><br/>The said property is located on Plot No. 17 &amp; 17A, TTC Industrial Area, Turbhe. It is at 1.8 Km. distance from Turbhe Railway station. The surrounding locality is Industrial.</p> <p><b>Plot :</b><br/>The plot is leasehold for 95 years commencing from 01.01.1967. Balance year of lease is 39 years.</p> <p><b>As per Lease Deed, the plot area as under and considered for valuation.</b></p> <table border="1"> <thead> <tr> <th>Plot No.</th> <th>Plot area (Sq. M.)</th> </tr> </thead> <tbody> <tr> <td>17</td> <td>8,773.00</td> </tr> <tr> <td>17A</td> <td>21,297.00</td> </tr> <tr> <td><b>Total</b></td> <td><b>30,070.00</b></td> </tr> </tbody> </table> <p><b>Structure:</b><br/>The composition of the structure is:</p> <table border="1"> <thead> <tr> <th>Structure</th> <th>Description</th> </tr> </thead> <tbody> <tr> <td><b>Admin Building</b></td> <td><b>Ground + 2 upper floors RCC framed structure</b></td> </tr> <tr> <td>Ground floor</td> <td>Reception, Weigh bridge Cabin, Dispatch Cabin, Worker's Canteen, Staff Canteen, Senior Production Manager's Cabin, Quality Control Room, Kitchen, Toilet Block.</td> </tr> <tr> <td>First Floor</td> <td>Director's Cabin + Pantry + Working area + Admin + Executive V. P., M.P. cabin, Manager's Cabin + V. P. + G, M's Cabin + 2 Cabins + Meeting Room + Conference Room + R &amp; D Department</td> </tr> <tr> <td>Second Floor</td> <td>Accounts + Marketing + Toilet Block</td> </tr> <tr> <td>Third Floor</td> <td>Seminar + Canteen + Toilet Block</td> </tr> </tbody> </table> <p><b>As per Approved Plan area are as under and considered for valuation:</b></p> <table border="1"> <thead> <tr> <th>Structure</th> <th>Built Up Area (Sq. M.)</th> <th>Year Of Const.</th> <th>Age Of Build, In Years</th> <th>Balance Life of Structures in Years</th> </tr> </thead> <tbody> <tr> <td><b>Finished Goods Store (A)</b></td> <td>981.67</td> <td>1985</td> <td>38.00</td> <td>12.00</td> </tr> <tr> <td><b>Tank Form (B)</b></td> <td>823.54</td> <td>1985</td> <td>38.00</td> <td>12.00</td> </tr> <tr> <td><b>Admin &amp; Lab Build (C)</b></td> <td></td> <td></td> <td></td> <td></td> </tr> <tr> <td>Ground Floor</td> <td>504.43</td> <td>1985</td> <td>38.00</td> <td>22.00</td> </tr> <tr> <td>1st Floor</td> <td>542.04</td> <td>1985</td> <td>38.00</td> <td>22.00</td> </tr> <tr> <td>2nd Floor</td> <td>542.02</td> <td>1985</td> <td>38.00</td> <td>22.00</td> </tr> <tr> <td><b>Boiler House</b></td> <td>119.25</td> <td>1985</td> <td>38.00</td> <td>12.00</td> </tr> <tr> <td><b>Watchmen Cabin</b></td> <td>7.50</td> <td>1985</td> <td>38.00</td> <td>12.00</td> </tr> <tr> <td><b>Shed</b></td> <td>506.91</td> <td>1985</td> <td>38.00</td> <td>12.00</td> </tr> <tr> <td><b>Weigh Bridges &amp; Security</b></td> <td>37.40</td> <td>1985</td> <td>38.00</td> <td>12.00</td> </tr> <tr> <td><b>Research &amp; Develop Lab</b></td> <td>442.49</td> <td>1985</td> <td>38.00</td> <td>12.00</td> </tr> <tr> <td><b>Drum Storage</b></td> <td>833.10</td> <td>1985</td> <td>38.00</td> <td>12.00</td> </tr> <tr> <td><b>Boiler House</b></td> <td>33.25</td> <td>1985</td> <td>38.00</td> <td>22.00</td> </tr> <tr> <td><b>Switch Room</b></td> <td>33.00</td> <td>1985</td> <td>38.00</td> <td>12.00</td> </tr> <tr> <td><b>Tanker Filling Shed</b></td> <td>160.24</td> <td>1990</td> <td>33.00</td> <td>17.00</td> </tr> </tbody> </table> |   | Plot No.       | Plot area (Sq. M.)     | 17                                  | 8,773.00 | 17A | 21,297.00 | <b>Total</b> | <b>30,070.00</b> | Structure | Description | <b>Admin Building</b> | <b>Ground + 2 upper floors RCC framed structure</b> | Ground floor | Reception, Weigh bridge Cabin, Dispatch Cabin, Worker's Canteen, Staff Canteen, Senior Production Manager's Cabin, Quality Control Room, Kitchen, Toilet Block. | First Floor | Director's Cabin + Pantry + Working area + Admin + Executive V. P., M.P. cabin, Manager's Cabin + V. P. + G, M's Cabin + 2 Cabins + Meeting Room + Conference Room + R & D Department | Second Floor | Accounts + Marketing + Toilet Block | Third Floor | Seminar + Canteen + Toilet Block | Structure | Built Up Area (Sq. M.) | Year Of Const. | Age Of Build, In Years | Balance Life of Structures in Years | <b>Finished Goods Store (A)</b> | 981.67 | 1985 | 38.00 | 12.00 | <b>Tank Form (B)</b> | 823.54 | 1985 | 38.00 | 12.00 | <b>Admin &amp; Lab Build (C)</b> |  |  |  |  | Ground Floor | 504.43 | 1985 | 38.00 | 22.00 | 1st Floor | 542.04 | 1985 | 38.00 | 22.00 | 2nd Floor | 542.02 | 1985 | 38.00 | 22.00 | <b>Boiler House</b> | 119.25 | 1985 | 38.00 | 12.00 | <b>Watchmen Cabin</b> | 7.50 | 1985 | 38.00 | 12.00 | <b>Shed</b> | 506.91 | 1985 | 38.00 | 12.00 | <b>Weigh Bridges &amp; Security</b> | 37.40 | 1985 | 38.00 | 12.00 | <b>Research &amp; Develop Lab</b> | 442.49 | 1985 | 38.00 | 12.00 | <b>Drum Storage</b> | 833.10 | 1985 | 38.00 | 12.00 | <b>Boiler House</b> | 33.25 | 1985 | 38.00 | 22.00 | <b>Switch Room</b> | 33.00 | 1985 | 38.00 | 12.00 | <b>Tanker Filling Shed</b> | 160.24 | 1990 | 33.00 | 17.00 |
| Plot No.   | Plot area (Sq. M.)  |                |                        |                                     |          |     |           |              |                  |           |             |                       |   |              |   |             |   |              |                                     |             |                                  |           |                        |                |                        |                                     |                                 |        |      |       |       |                      |        |      |       |       |                                  |  |  |  |  |              |        |      |       |       |           |        |      |       |       |           |        |      |       |       |                     |        |      |       |       |                       |      |      |       |       |             |        |      |       |       |                                     |       |      |       |       |                                   |        |      |       |       |                     |        |      |       |       |                     |       |      |       |       |                    |       |      |       |       |                            |        |      |       |       |
| 17   | 8,773.00  |                |                        |                                     |          |     |           |              |                  |           |             |                       |   |              |   |             |   |              |                                     |             |                                  |           |                        |                |                        |                                     |                                 |        |      |       |       |                      |        |      |       |       |                                  |  |  |  |  |              |        |      |       |       |           |        |      |       |       |           |        |      |       |       |                     |        |      |       |       |                       |      |      |       |       |             |        |      |       |       |                                     |       |      |       |       |                                   |        |      |       |       |                     |        |      |       |       |                     |       |      |       |       |                    |       |      |       |       |                            |        |      |       |       |
| 17A  | 21,297.00   |                |                        |                                     |          |     |           |              |                  |           |             |                       |   |              |   |             |   |              |                                     |             |                                  |           |                        |                |                        |                                     |                                 |        |      |       |       |                      |        |      |       |       |                                  |  |  |  |  |              |        |      |       |       |           |        |      |       |       |           |        |      |       |       |                     |        |      |       |       |                       |      |      |       |       |             |        |      |       |       |                                     |       |      |       |       |                                   |        |      |       |       |                     |        |      |       |       |                     |       |      |       |       |                    |       |      |       |       |                            |        |      |       |       |
| <b>Total</b>   | <b>30,070.00</b>  |                |                        |                                     |          |     |           |              |                  |           |             |                       |   |              |   |             |   |              |                                     |             |                                  |           |                        |                |                        |                                     |                                 |        |      |       |       |                      |        |      |       |       |                                  |  |  |  |  |              |        |      |       |       |           |        |      |       |       |           |        |      |       |       |                     |        |      |       |       |                       |      |      |       |       |             |        |      |       |       |                                     |       |      |       |       |                                   |        |      |       |       |                     |        |      |       |       |                     |       |      |       |       |                    |       |      |       |       |                            |        |      |       |       |
| Structure  | Description   |                |                        |                                     |          |     |           |              |                  |           |             |                       |   |              |   |             |   |              |                                     |             |                                  |           |                        |                |                        |                                     |                                 |        |      |       |       |                      |        |      |       |       |                                  |  |  |  |  |              |        |      |       |       |           |        |      |       |       |           |        |      |       |       |                     |        |      |       |       |                       |      |      |       |       |             |        |      |       |       |                                     |       |      |       |       |                                   |        |      |       |       |                     |        |      |       |       |                     |       |      |       |       |                    |       |      |       |       |                            |        |      |       |       |
| <b>Admin Building</b>  | <b>Ground + 2 upper floors RCC framed structure</b>   |                |                        |                                     |          |     |           |              |                  |           |             |                       |   |              |   |             |   |              |                                     |             |                                  |           |                        |                |                        |                                     |                                 |        |      |       |       |                      |        |      |       |       |                                  |  |  |  |  |              |        |      |       |       |           |        |      |       |       |           |        |      |       |       |                     |        |      |       |       |                       |      |      |       |       |             |        |      |       |       |                                     |       |      |       |       |                                   |        |      |       |       |                     |        |      |       |       |                     |       |      |       |       |                    |       |      |       |       |                            |        |      |       |       |
| Ground floor   | Reception, Weigh bridge Cabin, Dispatch Cabin, Worker's Canteen, Staff Canteen, Senior Production Manager's Cabin, Quality Control Room, Kitchen, Toilet Block.                       |                |                        |                                     |          |     |           |              |                  |           |             |                       |   |              |   |             |   |              |                                     |             |                                  |           |                        |                |                        |                                     |                                 |        |      |       |       |                      |        |      |       |       |                                  |  |  |  |  |              |        |      |       |       |           |        |      |       |       |           |        |      |       |       |                     |        |      |       |       |                       |      |      |       |       |             |        |      |       |       |                                     |       |      |       |       |                                   |        |      |       |       |                     |        |      |       |       |                     |       |      |       |       |                    |       |      |       |       |                            |        |      |       |       |
| First Floor  | Director's Cabin + Pantry + Working area + Admin + Executive V. P., M.P. cabin, Manager's Cabin + V. P. + G, M's Cabin + 2 Cabins + Meeting Room + Conference Room + R & D Department |                |                        |                                     |          |     |           |              |                  |           |             |                       |   |              |   |             |   |              |                                     |             |                                  |           |                        |                |                        |                                     |                                 |        |      |       |       |                      |        |      |       |       |                                  |  |  |  |  |              |        |      |       |       |           |        |      |       |       |           |        |      |       |       |                     |        |      |       |       |                       |      |      |       |       |             |        |      |       |       |                                     |       |      |       |       |                                   |        |      |       |       |                     |        |      |       |       |                     |       |      |       |       |                    |       |      |       |       |                            |        |      |       |       |
| Second Floor   | Accounts + Marketing + Toilet Block   |                |                        |                                     |          |     |           |              |                  |           |             |                       |   |              |   |             |   |              |                                     |             |                                  |           |                        |                |                        |                                     |                                 |        |      |       |       |                      |        |      |       |       |                                  |  |  |  |  |              |        |      |       |       |           |        |      |       |       |           |        |      |       |       |                     |        |      |       |       |                       |      |      |       |       |             |        |      |       |       |                                     |       |      |       |       |                                   |        |      |       |       |                     |        |      |       |       |                     |       |      |       |       |                    |       |      |       |       |                            |        |      |       |       |
| Third Floor  | Seminar + Canteen + Toilet Block  |                |                        |                                     |          |     |           |              |                  |           |             |                       |   |              |   |             |   |              |                                     |             |                                  |           |                        |                |                        |                                     |                                 |        |      |       |       |                      |        |      |       |       |                                  |  |  |  |  |              |        |      |       |       |           |        |      |       |       |           |        |      |       |       |                     |        |      |       |       |                       |      |      |       |       |             |        |      |       |       |                                     |       |      |       |       |                                   |        |      |       |       |                     |        |      |       |       |                     |       |      |       |       |                    |       |      |       |       |                            |        |      |       |       |
| Structure  | Built Up Area (Sq. M.)  | Year Of Const. | Age Of Build, In Years | Balance Life of Structures in Years |          |     |           |              |                  |           |             |                       |   |              |   |             |   |              |                                     |             |                                  |           |                        |                |                        |                                     |                                 |        |      |       |       |                      |        |      |       |       |                                  |  |  |  |  |              |        |      |       |       |           |        |      |       |       |           |        |      |       |       |                     |        |      |       |       |                       |      |      |       |       |             |        |      |       |       |                                     |       |      |       |       |                                   |        |      |       |       |                     |        |      |       |       |                     |       |      |       |       |                    |       |      |       |       |                            |        |      |       |       |
| <b>Finished Goods Store (A)</b>  | 981.67  | 1985           | 38.00                  | 12.00                               |          |     |           |              |                  |           |             |                       |   |              |   |             |   |              |                                     |             |                                  |           |                        |                |                        |                                     |                                 |        |      |       |       |                      |        |      |       |       |                                  |  |  |  |  |              |        |      |       |       |           |        |      |       |       |           |        |      |       |       |                     |        |      |       |       |                       |      |      |       |       |             |        |      |       |       |                                     |       |      |       |       |                                   |        |      |       |       |                     |        |      |       |       |                     |       |      |       |       |                    |       |      |       |       |                            |        |      |       |       |
| <b>Tank Form (B)</b>   | 823.54  | 1985           | 38.00                  | 12.00                               |          |     |           |              |                  |           |             |                       |   |              |   |             |   |              |                                     |             |                                  |           |                        |                |                        |                                     |                                 |        |      |       |       |                      |        |      |       |       |                                  |  |  |  |  |              |        |      |       |       |           |        |      |       |       |           |        |      |       |       |                     |        |      |       |       |                       |      |      |       |       |             |        |      |       |       |                                     |       |      |       |       |                                   |        |      |       |       |                     |        |      |       |       |                     |       |      |       |       |                    |       |      |       |       |                            |        |      |       |       |
| <b>Admin &amp; Lab Build (C)</b>   |   |                |                        |                                     |          |     |           |              |                  |           |             |                       |   |              |   |             |   |              |                                     |             |                                  |           |                        |                |                        |                                     |                                 |        |      |       |       |                      |        |      |       |       |                                  |  |  |  |  |              |        |      |       |       |           |        |      |       |       |           |        |      |       |       |                     |        |      |       |       |                       |      |      |       |       |             |        |      |       |       |                                     |       |      |       |       |                                   |        |      |       |       |                     |        |      |       |       |                     |       |      |       |       |                    |       |      |       |       |                            |        |      |       |       |
| Ground Floor   | 504.43  | 1985           | 38.00                  | 22.00                               |          |     |           |              |                  |           |             |                       |   |              |   |             |   |              |                                     |             |                                  |           |                        |                |                        |                                     |                                 |        |      |       |       |                      |        |      |       |       |                                  |  |  |  |  |              |        |      |       |       |           |        |      |       |       |           |        |      |       |       |                     |        |      |       |       |                       |      |      |       |       |             |        |      |       |       |                                     |       |      |       |       |                                   |        |      |       |       |                     |        |      |       |       |                     |       |      |       |       |                    |       |      |       |       |                            |        |      |       |       |
| 1st Floor  | 542.04  | 1985           | 38.00                  | 22.00                               |          |     |           |              |                  |           |             |                       |   |              |   |             |   |              |                                     |             |                                  |           |                        |                |                        |                                     |                                 |        |      |       |       |                      |        |      |       |       |                                  |  |  |  |  |              |        |      |       |       |           |        |      |       |       |           |        |      |       |       |                     |        |      |       |       |                       |      |      |       |       |             |        |      |       |       |                                     |       |      |       |       |                                   |        |      |       |       |                     |        |      |       |       |                     |       |      |       |       |                    |       |      |       |       |                            |        |      |       |       |
| 2nd Floor  | 542.02  | 1985           | 38.00                  | 22.00                               |          |     |           |              |                  |           |             |                       |   |              |   |             |   |              |                                     |             |                                  |           |                        |                |                        |                                     |                                 |        |      |       |       |                      |        |      |       |       |                                  |  |  |  |  |              |        |      |       |       |           |        |      |       |       |           |        |      |       |       |                     |        |      |       |       |                       |      |      |       |       |             |        |      |       |       |                                     |       |      |       |       |                                   |        |      |       |       |                     |        |      |       |       |                     |       |      |       |       |                    |       |      |       |       |                            |        |      |       |       |
| <b>Boiler House</b>  | 119.25  | 1985           | 38.00                  | 12.00                               |          |     |           |              |                  |           |             |                       |   |              |   |             |   |              |                                     |             |                                  |           |                        |                |                        |                                     |                                 |        |      |       |       |                      |        |      |       |       |                                  |  |  |  |  |              |        |      |       |       |           |        |      |       |       |           |        |      |       |       |                     |        |      |       |       |                       |      |      |       |       |             |        |      |       |       |                                     |       |      |       |       |                                   |        |      |       |       |                     |        |      |       |       |                     |       |      |       |       |                    |       |      |       |       |                            |        |      |       |       |
| <b>Watchmen Cabin</b>  | 7.50  | 1985           | 38.00                  | 12.00                               |          |     |           |              |                  |           |             |                       |   |              |   |             |   |              |                                     |             |                                  |           |                        |                |                        |                                     |                                 |        |      |       |       |                      |        |      |       |       |                                  |  |  |  |  |              |        |      |       |       |           |        |      |       |       |           |        |      |       |       |                     |        |      |       |       |                       |      |      |       |       |             |        |      |       |       |                                     |       |      |       |       |                                   |        |      |       |       |                     |        |      |       |       |                     |       |      |       |       |                    |       |      |       |       |                            |        |      |       |       |
| <b>Shed</b>  | 506.91  | 1985           | 38.00                  | 12.00                               |          |     |           |              |                  |           |             |                       |   |              |   |             |   |              |                                     |             |                                  |           |                        |                |                        |                                     |                                 |        |      |       |       |                      |        |      |       |       |                                  |  |  |  |  |              |        |      |       |       |           |        |      |       |       |           |        |      |       |       |                     |        |      |       |       |                       |      |      |       |       |             |        |      |       |       |                                     |       |      |       |       |                                   |        |      |       |       |                     |        |      |       |       |                     |       |      |       |       |                    |       |      |       |       |                            |        |      |       |       |
| <b>Weigh Bridges &amp; Security</b>  | 37.40   | 1985           | 38.00                  | 12.00                               |          |     |           |              |                  |           |             |                       |   |              |   |             |   |              |                                     |             |                                  |           |                        |                |                        |                                     |                                 |        |      |       |       |                      |        |      |       |       |                                  |  |  |  |  |              |        |      |       |       |           |        |      |       |       |           |        |      |       |       |                     |        |      |       |       |                       |      |      |       |       |             |        |      |       |       |                                     |       |      |       |       |                                   |        |      |       |       |                     |        |      |       |       |                     |       |      |       |       |                    |       |      |       |       |                            |        |      |       |       |
| <b>Research &amp; Develop Lab</b>  | 442.49  | 1985           | 38.00                  | 12.00                               |          |     |           |              |                  |           |             |                       |   |              |   |             |   |              |                                     |             |                                  |           |                        |                |                        |                                     |                                 |        |      |       |       |                      |        |      |       |       |                                  |  |  |  |  |              |        |      |       |       |           |        |      |       |       |           |        |      |       |       |                     |        |      |       |       |                       |      |      |       |       |             |        |      |       |       |                                     |       |      |       |       |                                   |        |      |       |       |                     |        |      |       |       |                     |       |      |       |       |                    |       |      |       |       |                            |        |      |       |       |
| <b>Drum Storage</b>  | 833.10  | 1985           | 38.00                  | 12.00                               |          |     |           |              |                  |           |             |                       |   |              |   |             |   |              |                                     |             |                                  |           |                        |                |                        |                                     |                                 |        |      |       |       |                      |        |      |       |       |                                  |  |  |  |  |              |        |      |       |       |           |        |      |       |       |           |        |      |       |       |                     |        |      |       |       |                       |      |      |       |       |             |        |      |       |       |                                     |       |      |       |       |                                   |        |      |       |       |                     |        |      |       |       |                     |       |      |       |       |                    |       |      |       |       |                            |        |      |       |       |
| <b>Boiler House</b>  | 33.25   | 1985           | 38.00                  | 22.00                               |          |     |           |              |                  |           |             |                       |   |              |   |             |   |              |                                     |             |                                  |           |                        |                |                        |                                     |                                 |        |      |       |       |                      |        |      |       |       |                                  |  |  |  |  |              |        |      |       |       |           |        |      |       |       |           |        |      |       |       |                     |        |      |       |       |                       |      |      |       |       |             |        |      |       |       |                                     |       |      |       |       |                                   |        |      |       |       |                     |        |      |       |       |                     |       |      |       |       |                    |       |      |       |       |                            |        |      |       |       |
| <b>Switch Room</b>   | 33.00   | 1985           | 38.00                  | 12.00                               |          |     |           |              |                  |           |             |                       |   |              |   |             |   |              |                                     |             |                                  |           |                        |                |                        |                                     |                                 |        |      |       |       |                      |        |      |       |       |                                  |  |  |  |  |              |        |      |       |       |           |        |      |       |       |           |        |      |       |       |                     |        |      |       |       |                       |      |      |       |       |             |        |      |       |       |                                     |       |      |       |       |                                   |        |      |       |       |                     |        |      |       |       |                     |       |      |       |       |                    |       |      |       |       |                            |        |      |       |       |
| <b>Tanker Filling Shed</b>   | 160.24  | 1990           | 33.00                  | 17.00                               |          |     |           |              |                  |           |             |                       |   |              |   |             |   |              |                                     |             |                                  |           |                        |                |                        |                                     |                                 |        |      |       |       |                      |        |      |       |       |                                  |  |  |  |  |              |        |      |       |       |           |        |      |       |       |           |        |      |       |       |                     |        |      |       |       |                       |      |      |       |       |             |        |      |       |       |                                     |       |      |       |       |                                   |        |      |       |       |                     |        |      |       |       |                     |       |      |       |       |                    |       |      |       |       |                            |        |      |       |       |



|                                       |          |   |       |       |
|---------------------------------------|----------|---|-------|-------|
| Extension To Watchman Cabin           | 19.86    | 2000  | 23.00 | 27.00 |
| Rear Tank Form                        | 503.16   | 2000  | 23.00 | 27.00 |
| Unloading Shed                        | 262.36   | 2000  | 23.00 | 27.00 |
| ETP / MCC                             | 205.95   | 2000  | 23.00 | 27.00 |
| Toilet                                | 35.38    | 2000  | 23.00 | 37.00 |
| Under Ground Solvent Tank             | 67.57    | 2000  | 23.00 | 37.00 |
| Tanks In Sodium Shed                  | 446.71   | 2000  | 23.00 | 27.00 |
| Tanks Near Explosive Tank Form        | 793.08   | 2000  | 23.00 | 27.00 |
| Tank Farm                             | 280.48   | 2000  | 23.00 | 27.00 |
| Shed Near Drum Store                  | 196.56   | 2000  | 23.00 | 27.00 |
| Shed Near Finished Goods Store        | 349.45   | 2000  | 23.00 | 27.00 |
| Pipe Rack                             | 634.13   | 2000  | 23.00 | 27.00 |
| Storage Oil Tank                      | 57.69    | 2014  | 9.00  | 41.00 |
| Process Oil Tank                      | 47.75    | 2014  | 9.00  | 41.00 |
| <b>Godown</b>                         |          |   |       |       |
| Ground Floor                          | 1,112.40 | 2014  | 9.00  | 41.00 |
| Mezzanine Floor                       | 324.00   | 2014  | 9.00  | 41.00 |
| New Tank Farm                         | 88.50    | 2014  | 9.00  | 41.00 |
| Tank Farm                             | 188.60   | 2014  | 9.00  | 41.00 |
| Tank                                  | 21.49    | 2014  | 9.00  | 41.00 |
| New Ware House                        | 1,168.72 | 2014  | 9.00  | 41.00 |
| S.P.D.U                               | 117.00   | 2014  | 9.00  | 51.00 |
| New Filter Bed                        | 57.29    | 2014  | 9.00  | 51.00 |
| Tanks                                 | 127.17   | 2014  | 9.00  | 41.00 |
| Container Platform                    | 28.79    | 2014  | 9.00  | 41.00 |
| New Godown                            | 1,053.00 | 2014  | 9.00  | 41.00 |
| Tank                                  | 25.12    | 2014  | 9.00  | 41.00 |
| Shed                                  | 253.50   | 2014  | 9.00  | 41.00 |
| GF BUILDING S1                        | 183.80   | 2022  | 1.00  | 49.00 |
| S4 Shed                               | 48.00    | 2022  | 1.00  | 49.00 |
| GF BUILDING A1                        | 200.78   | 2022  | 1.00  | 49.00 |
| S5, S6 & S7 Shed (Type of Building B) | 529.27   | 2022  | 1.00  | 49.00 |
| 6. Location of property               | :        |   |       |       |
| a) Plot No. / Survey No.              | :        | Plot No. 17 & 17A   |       |       |
| b) Door No.                           | :        | Not applicable  |       |       |
| c) C.T.S. No. / Village               | :        | Village Pawane  |       |       |
| d) Ward / Taluka                      | :        | Taluka Thane  |       |       |
| e) Mandal / District                  | :        | District Thane  |       |       |
| 7. Postal address of the property     | :        | Industrial Land & Building on Plot No. 17 & 17A, TTC Industrial Area, M.I.D.C., Thane – Belapur Road, Turbhe, Village – Pawane, Taluka & Dist. Thane - 400703, State - Maharashtra, Country – India |       |       |
| 8. City / Town                        | :        | Semi – Urban  |       |       |
| Residential area                      | :        | No  |       |       |
| Commercial area                       | :        | No  |       |       |
| Industrial area                       | :        | Yes   |       |       |
| 9. Classification of the area         | :        |   |       |       |
| i) High / Middle / Poor               | :        | Middle Class  |       |       |
| ii) Urban / Semi Urban / Rural        | :        | Rural   |       |       |



|                                       |   |                                  |   |                           |
|---------------------------------------|---|----------------------------------|---|---------------------------|
| 10.                                   | Coming under Corporation limit / Village Panchayat / Municipality   | :                                | Maharashtra Industrial Development Corporation (M.I.D.C.) |                           |
| 11.                                   | Whether covered under any State / Central Govt. enactments (e.g., Urban Land Ceiling Act) or notified under agency area/ scheduled area / cantonment area | :                                | No  |                           |
| 12.                                   | In Case it is Agricultural land, any conversion to house site plots is contemplated   | :                                | N.A.  |                           |
| 13.                                   | Boundaries of the property  |                                  |   |                           |
|                                       | <b>Particulars</b>  | <b>North</b>                     | <b>South</b>  |                           |
|                                       |   | <b>East</b>                      | <b>West</b>   |                           |
|                                       | <b>As per document</b>  |                                  |   |                           |
|                                       | Plot No. 17   | MIDC Land                        | MIDC Land   | Plot No. 17A              |
|                                       | Plot No. 17A  | MIDC Land                        | MIDC Land   | MIDC Land                 |
|                                       | <b>As per Site Visit</b>  |                                  |   |                           |
|                                       | Plot No. N- 17 & 17A  | Savita Chemical Road & Open area | Under Construction Building                               | Asian Paints              |
|                                       |   |                                  |   | Thane Belapur Road        |
| 14.1                                  | Dimensions of the site  | :                                |   |                           |
|                                       |   |                                  | A<br>As per the Deed                                      | B<br>Actuals              |
|                                       | North   | :                                | <b>Plot No.</b>   | <b>Plot area (Sq. M.)</b> |
|                                       | South   | :                                | 17  | 8,773.00                  |
|                                       | East  | :                                | 17A   | 21,297.00                 |
|                                       | West  | :                                | <b>Total</b>  | <b>30,070.00</b>          |
| 14.2                                  | Latitude, Longitude & Co-ordinates of property  | :                                | 19°05'02.5"N 73°01'03.3"E                                 |                           |
| 14.                                   | Extent of the site  | :                                | <b>Area as per Lease Deed:</b>                            |                           |
|                                       |   |                                  | <b>Plot No.</b>   | <b>Plot area (Sq. M.)</b> |
|                                       |   |                                  | 17  | 8,773.00                  |
|                                       |   |                                  | 17A   | 21,297.00                 |
|                                       |   |                                  | <b>Total</b>  | <b>30,070.00</b>          |
| 15.                                   | Extent of the site considered for Valuation (least of 14A& 14B)   |                                  | <b>Structure area = As per Approved Plan</b>              |                           |
| 16                                    | Whether occupied by the owner / tenant? If occupied by tenant since how long? Rent received per month.  | :                                | Owner Occupied  |                           |
| <b>II CHARACTERISTICS OF THE SITE</b> |   |                                  |   |                           |
| 1.                                    | Classification of locality  | :                                | Middle class  |                           |
| 2.                                    | Development of surrounding areas  | :                                | Normal  |                           |
| 3.                                    | Possibility of frequent flooding/ submerging  | :                                | No  |                           |
| 4.                                    | Feasibility to the Civic amenities like School, Hospital, Bus Stop, Market etc.   | :                                | All available near by                                     |                           |
| 5.                                    | Level of land with topographical conditions   | :                                | Plain   |                           |
| 6.                                    | Shape of land   | :                                | Irregular   |                           |

| 7.                                      | Type of use to which it can be put   | : | For industrial purpose   |          |                    |    |          |     |           |              |                  |
|---|--|---|--|----------|--------------------|----|----------|-----|-----------|--------------|------------------|
| 8.                                      | Any usage restriction  | : | Industrial   |          |                    |    |          |     |           |              |                  |
| 9.                                      | Is plot in town planning approved layout?  | : | N.A.   |          |                    |    |          |     |           |              |                  |
| 10.                                     | Corner plot or intermittent plot?  | : | Intermittent   |          |                    |    |          |     |           |              |                  |
| 11.                                     | Road facilities  | : | Yes  |          |                    |    |          |     |           |              |                  |
| 12.                                     | Type of road available at present  | : | B.T. Road  |          |                    |    |          |     |           |              |                  |
| 13.                                     | Width of road – is it below 20 ft. or more than 20 ft.   | : | 20.00 M. wide B.T. Road  |          |                    |    |          |     |           |              |                  |
| 14.                                     | Is it a Land – Locked land?  | : | No   |          |                    |    |          |     |           |              |                  |
| 15.                                     | Water potentiality   | : | M.I.D.C. Water Supply  |          |                    |    |          |     |           |              |                  |
| 16.                                     | Underground sewerage system  | : | Underground Sewerage connected to M.I.D.C. drain lines   |          |                    |    |          |     |           |              |                  |
| 17.                                     | Is Power supply is available in the site   | : | Yes  |          |                    |    |          |     |           |              |                  |
| 18.                                     | Advantages of the site   | : | Located in developed industrial Area   |          |                    |    |          |     |           |              |                  |
| 19.                                     | <b>Special remarks, if any like threat of acquisition of land for public service purposes, road widening or applicability of CRZ provisions etc. (Distance from sea-cost / tidal level must be incorporated)</b> | : | No   |          |                    |    |          |     |           |              |                  |
| <b>Part – A (Valuation of land)</b>     |  |   |  |          |                    |    |          |     |           |              |                  |
| 1                                       | Size of plot   | : | <table border="1"> <thead> <tr> <th>Plot No.</th> <th>Plot area (Sq. M.)</th> </tr> </thead> <tbody> <tr> <td>17</td> <td>8,773.00</td> </tr> <tr> <td>17A</td> <td>21,297.00</td> </tr> <tr> <td><b>Total</b></td> <td><b>30,070.00</b></td> </tr> </tbody> </table>  | Plot No. | Plot area (Sq. M.) | 17 | 8,773.00 | 17A | 21,297.00 | <b>Total</b> | <b>30,070.00</b> |
| Plot No.                                | Plot area (Sq. M.)   |   |  |          |                    |    |          |     |           |              |                  |
| 17                                      | 8,773.00   |   |  |          |                    |    |          |     |           |              |                  |
| 17A                                     | 21,297.00  |   |  |          |                    |    |          |     |           |              |                  |
| <b>Total</b>                            | <b>30,070.00</b>   |   |  |          |                    |    |          |     |           |              |                  |
|   | North & South  | : | -  |          |                    |    |          |     |           |              |                  |
|   | East & West  | : | -  |          |                    |    |          |     |           |              |                  |
| 2                                       | Total extent of the plot   | : | <table border="1"> <thead> <tr> <th>Plot No.</th> <th>Plot area (Sq. M.)</th> </tr> </thead> <tbody> <tr> <td>17</td> <td>8,773.00</td> </tr> <tr> <td>17A</td> <td>21,297.00</td> </tr> <tr> <td><b>Total</b></td> <td><b>30,070.00</b></td> </tr> </tbody> </table>  | Plot No. | Plot area (Sq. M.) | 17 | 8,773.00 | 17A | 21,297.00 | <b>Total</b> | <b>30,070.00</b> |
| Plot No.                                | Plot area (Sq. M.)   |   |  |          |                    |    |          |     |           |              |                  |
| 17                                      | 8,773.00   |   |  |          |                    |    |          |     |           |              |                  |
| 17A                                     | 21,297.00  |   |  |          |                    |    |          |     |           |              |                  |
| <b>Total</b>                            | <b>30,070.00</b>   |   |  |          |                    |    |          |     |           |              |                  |
| 3                                       | Prevailing market rate (Along with details / reference of at least two latest deals / transactions with respect to adjacent properties in the areas)   | : | ₹ 35,000/- to ₹ 40,000/- per Sq. M.<br>Details of online listings are attached with the report.  |          |                    |    |          |     |           |              |                  |
| 4                                       | M.I.D.C. Land Allotment Price from Government Portal   | : | ₹ 25,108/- per Sq. M.  |          |                    |    |          |     |           |              |                  |
|   | In case of variation of 20% or more in the valuation proposed by the valuer and the Guideline value provided in the State Govt. notification or Income Tax Gazette justification on variation has to be given.   | : | It is a foregone conclusion that market value is always more than RR prices. As the RR rates are fixed by respective state governments for computing stamp duty / regn. Fees. Thus, the rates differ from place to place and location. Amenities per se as evident from the fact that even RR rates decided by Govt. differ. |          |                    |    |          |     |           |              |                  |
| 5                                       | Assessed / adopted rate of valuation   | : | ₹ 38,000/- per Sq. M.  |          |                    |    |          |     |           |              |                  |
| 6                                       | <b>Estimated value of land</b>   | : | <b>₹ 114,26,60,000/-</b>   |          |                    |    |          |     |           |              |                  |
| <b>Part – B (Valuation of Building)</b> |  |   |  |          |                    |    |          |     |           |              |                  |
| 1                                       | Technical details of the building  | : |  |          |                    |    |          |     |           |              |                  |



|   |   |   |
|---|---|---|
| a) Type of Building (Residential / Commercial / Industrial)                   | : | Industrial  |
| b) Type of construction (Load bearing / RCC / Steel Framed)                   | : | As per Brief Description  |
| c) Year of construction   | : | As per Brief Description  |
| d) Number of floors and height of each floor including basement, if any       | : | As per Brief Description  |
| e) Plinth area floor-wise   | : | As per Brief Description  |
| f) Condition of the building  | : |   |
| i) Exterior – Excellent, Good, Normal, Poor                                   | : | Normal  |
| ii) Interior – Excellent, Good, Normal, Poor                                  | : | Normal  |
| g) Date of issue and validity of layout of approved map                       | : | 1. Copy of Approved Plan vide No. PLN / THN / 347 /2013 / CPP / 106 / Thane dated 10.04.2014 issued by Industrial Safety & Fields, MIDC.<br>2. Copy of Approved Plan subject to Letter vide No. TTC / 17 / 17A / 6758 dated 21.08.1998 issued by Executive Engineer, MIDC Division No. II, Thane.<br>3. Copy of Approved Plan subject to Letter vide No. TTC / 17 / 17A / 6757 dated 21.08.1998 issued by Executive Engineer, MIDC Division No. II, Thane<br>4. Copy of Approved Plan subject to Letter vide No. DE / MHP (C) I / Plot / 17 / 17A / 2104 dated 04.08.2009 issued by Dy. Engineer, Special Planning Authority, MIDC , Mahape I.<br>5. Copy of Digital Approved Plan dated 26.02.2022 issued by MIDC.<br>6. Copy of Sanction of Building Permit vide No. DE / SPA / 17 & 17A / C – 61765 / 2014 dated 06.09.2014 issued by Office of the Dy. Engineer & Special Planning Authority, MIDC Sub – Dn.1 (Civil) Mahape for approval to expansion for factory shed |
| h) Approved map / plan issuing authority                                      | : |   |
| i) Whether genuineness or authenticity of approved map / plan is verified     | : | Yes   |
| j) Any other comments by our empanelled valuers on authentic of approved plan | : | No  |

**Specifications of construction (floor-wise) in respect of**

| Sr. No.   | Description   |   |
|-----------|---|---|
| 1.        | Foundation  | : R.C.C. Foundation   |
| 2.        | Basement  | : No  |
| 3.        | Superstructure  | : As per Brief Description  |
| 4.        | Joinery / Doors & Windows (Please furnish details about size of frames, shutters, glazing, fitting etc. and specify the species of timber | : M.S. Rolling Shutter, Wooden frame flushed doors & Aluminium frame sliding windows. |
| 5.        | RCC Works   | : As per Brief Description  |
| 6.        | Plastering  | : Cement plaster  |
| 7.        | Flooring, Skirting, dado  | : Vitrified / IPS Flooring  |
| 8.        | Special finish as marble, granite, wooden paneling, grills etc.   | : No  |
| 9.        | Roofing including weatherproof course   | : Partly R.C.C. and partly A.C. Sheet roofing   |
| 10.       | Drainage  | : Underground Sewerage connected to M.I.D.C. drain lines                              |
| <b>2.</b> | <b>Compound Wall</b>  | :   |
|           | Height  | :   |
|           | Length  | : 5'.6" High, R.C.C. columns with B. B. Masonry wall.                                 |
|           | Type of construction  | :   |
| <b>3.</b> | <b>Electrical installation</b>  | :   |
|           | Type of wiring  | : Partly Concealed & Partly Industrial open wiring.                                   |
|           | Class of fittings (superior / ordinary / poor)  | : Ordinary  |
|           | Number of light points  | : Provided as per requirement   |
|           | Fan points  | : Provided as per requirement   |
|           | Spare plug points   | : Provided as per requirement   |
|           | Any other item  | : -   |
| <b>4.</b> | <b>Plumbing installation</b>  | :   |
| a)        | No. of water closets and their type   | : Provided as per requirement   |
| b)        | No. of wash basins  | : Provided as per requirement   |
| c)        | No. of urinals  | : Provided as per requirement   |
| d)        | No. of bathtubs   | : Provided as per requirement   |
| e)        | Water meters, taps etc.   | : Provided as per requirement   |
| f)        | Any other fixtures  | : Provided as per requirement   |

**Structure**

| Structure                             | Built Up Area<br>(Sq. M.) | Estimated<br>Replacement Rate<br>(₹) | Depreciated Rate to<br>be considered<br>(₹) | Depreciated Value to<br>be considered<br>(₹) |
|---------------------------------------|---------------------------|--------------------------------------|---|--|
| <b>Finished Goods Store (A)</b>       | 981.67                    | 12,000.00                            | 3,792.00                                    | 37,22,493.00                                 |
| <b>Tank Form (B)</b>                  | 823.54                    | 5,000.00                             | 1,580.00                                    | 13,01,193.00                                 |
| <b>Admin &amp; Lab Build (C)</b>      |                           |                                      |   |  |
| Ground Floor                          | 504.43                    | 22,000.00                            | 9,460.00                                    | 47,71,908.00                                 |
| 1st Floor                             | 542.04                    | 22,000.00                            | 9,460.00                                    | 51,27,698.00                                 |
| 2nd Floor                             | 542.02                    | 22,000.00                            | 9,460.00                                    | 51,27,509.00                                 |
| <b>Boiler House</b>                   | 119.25                    | 18,000.00                            | 5,688.00                                    | 6,78,294.00                                  |
| <b>Watchmen Cabin</b>                 | 7.50                      | 15,000.00                            | 4,740.00                                    | 35,550.00                                    |
| <b>Shed</b>                           | 506.91                    | 12,000.00                            | 3,792.00                                    | 19,22,203.00                                 |
| <b>Weigh Bridges &amp; Security</b>   | 37.40                     | 15,000.00                            | 4,740.00                                    | 1,77,276.00                                  |
| <b>Research &amp; Develop Lab</b>     | 442.49                    | 15,000.00                            | 4,740.00                                    | 20,97,403.00                                 |
| <b>Drum Storage</b>                   | 833.10                    | 12,000.00                            | 3,792.00                                    | 31,59,115.00                                 |
| <b>Boiler House</b>                   | 33.25                     | 18,000.00                            | 7,740.00                                    | 2,57,355.00                                  |
| <b>Switch Room</b>                    | 33.00                     | 15,000.00                            | 4,740.00                                    | 1,56,420.00                                  |
| Tanker Filling Shed                   | 160.24                    | 10,000.00                            | 4,060.00                                    | 6,50,574.00                                  |
| Extension To Watchman Cabin           | 19.86                     | 15,000.00                            | 8,790.00                                    | 1,74,569.00                                  |
| Rear Tank Form                        | 503.16                    | 5,000.00                             | 2,930.00                                    | 14,74,259.00                                 |
| Unloading Shed                        | 262.36                    | 10,000.00                            | 5,860.00                                    | 15,37,430.00                                 |
| ETP / MCC                             | 205.95                    | 15,000.00                            | 8,790.00                                    | 18,10,301.00                                 |
| Toilet                                | 35.38                     | 15,000.00                            | 9,825.00                                    | 3,47,609.00                                  |
| Under Ground Solvent Tank             | 67.57                     | 15,000.00                            | 9,825.00                                    | 6,63,875.00                                  |
| Tanks In Sodium Shed                  | 446.71                    | 5,000.00                             | 2,930.00                                    | 13,08,860.00                                 |
| Tanks Near Explosive Tank Form        | 793.08                    | 5,000.00                             | 2,930.00                                    | 23,23,724.00                                 |
| Tank Farm                             | 280.48                    | 7,500.00                             | 4,395.00                                    | 12,32,701.00                                 |
| Shed Near Drum Store                  | 196.56                    | 10,000.00                            | 5,860.00                                    | 11,51,842.00                                 |
| Shed Near Finished Goods Store        | 349.45                    | 10,000.00                            | 5,860.00                                    | 20,47,777.00                                 |
| Pipe Rack                             | 634.13                    | 10,000.00                            | 5,860.00                                    | 37,16,002.00                                 |
| Storage Oil Tank                      | 57.69                     | 5,000.00                             | 4,190.00                                    | 2,41,721.00                                  |
| Process Oil Tank                      | 47.75                     | 5,000.00                             | 4,190.00                                    | 2,00,073.00                                  |
| <b>Godown</b>                         |                           |                                      |   |  |
| Ground Floor                          | 1,112.40                  | 15,000.00                            | 12,570.00                                   | 40,72,680.00                                 |
| Mezzanine Floor                       | 324.00                    | 7,500.00                             | 6,285.00                                    | 5,56,223.00                                  |
| New Tank Farm                         | 88.50                     | 5,000.00                             | 4,190.00                                    | 3,70,815.00                                  |
| Tank Farm                             | 188.60                    | 5,000.00                             | 4,190.00                                    | 7,90,234.00                                  |
| Tank                                  | 21.49                     | 5,000.00                             | 4,190.00                                    | 90,043.00                                    |
| New Ware House                        | 1,168.72                  | 15,000.00                            | 12,570.00                                   | 1,46,90,810.00                               |
| S.P.D.U                               | 117.00                    | 15,000.00                            | 12,975.00                                   | 15,18,075.00                                 |
| New Filter Bed                        | 57.29                     | 12,000.00                            | 10,380.00                                   | 5,94,670.00                                  |
| Tanks                                 | 127.17                    | 5,000.00                             | 4,190.00                                    | 5,32,842.00                                  |
| Container Platform                    | 28.79                     | 5,000.00                             | 4,190.00                                    | 1,20,630.00                                  |
| New Godown                            | 1,053.00                  | 15,000.00                            | 12,570.00                                   | 1,32,36,210.00                               |
| Tank                                  | 25.12                     | 5,000.00                             | 4,190.00                                    | 1,05,253.00                                  |
| Shed                                  | 253.50                    | 15,000.00                            | 12,570.00                                   | 31,86,495.00                                 |
| GF BUILDING S1                        | 183.80                    | 12,000.00                            | 12,000.00                                   | 22,05,600.00                                 |
| S4 Shed                               | 48.00                     | 7,500.00                             | 7,500.00                                    | 3,60,000.00                                  |
| GF BUILDING A1                        | 200.78                    | 10,000.00                            | 10,000.00                                   | 20,07,800.00                                 |
| S5, S6 & S7 Shed (Type of Building B) | 529.27                    | 7,500.00                             | 7,500.00                                    | 39,69,525.00                                 |
|                                       |                           |                                      | <b>TOTAL</b>                                | <b>9,58,23,639.00</b>                        |





| Part – C (Extra Items) |                                      | Amount in ₹                          |
|------------------------|--------------------------------------|--------------------------------------|
| 1.                     | Portico                              | Included in the Cost of Construction |
| 2.                     | Ornamental front door                |                                      |
| 3.                     | Sit out / Verandah with steel grills |                                      |
| 4.                     | Overhead water tank                  |                                      |
| 5.                     | Extra steel / collapsible gates      |                                      |
|                        | Total                                |                                      |

| Part – D (Amenities) |                                 | Amount in ₹                          |
|----------------------|---------------------------------|--------------------------------------|
| 1.                   | Wardrobes                       | Included in the Cost of Construction |
| 2.                   | Glazed tiles                    |                                      |
| 3.                   | Extra sinks and bathtub         |                                      |
| 4.                   | Marble / ceramic tiles flooring |                                      |
| 5.                   | Interior decorations            |                                      |
| 6.                   | Architectural elevation works   |                                      |
| 7.                   | Paneling works                  |                                      |
| 8.                   | Aluminum works                  |                                      |
| 9.                   | Aluminum handrails              |                                      |
| 10.                  | False ceiling                   |                                      |
|                      | Total                           |                                      |

| Part – E (Miscellaneous) |                            | Amount in ₹                          |
|--------------------------|----------------------------|--------------------------------------|
| 1.                       | Separate toilet room       | Included in the Cost of Construction |
| 2.                       | Separate lumber room       |                                      |
| 3.                       | Separate water tank / sump |                                      |
| 4.                       | Trees, gardening           |                                      |
|                          | Total                      |                                      |

| Part – F (Services) |                              | Amount in ₹                      |
|---------------------|------------------------------|----------------------------------|
| 1.                  | Water supply arrangements    | Included in the Land Development |
| 2.                  | Drainage arrangements        |                                  |
| 3.                  | Compound wall                |                                  |
| 4.                  | C.B. deposits, fittings etc. |                                  |
| 5.                  | Pavement                     |                                  |
|                     | Total                        |                                  |

### Land Development

Land development such as plot levelling, filling, compound wall, M.S. gate and other miscellaneous items.

| Particulars | Sq. M.          |
|-------------|-----------------|
| Plot area   | 16,483.66       |
| Rate        | 1,500/-         |
| Value       | ₹ 2,47,25,490/- |

### Government Value

| Particulars  | Area in Sq. M.         | Rate in ₹ | Value in ₹            |
|--------------|------------------------|-----------|-----------------------|
| Land         | 30,070.00              | 25,108/-  | 75,49,97,560/-        |
| Structure    | As per valuation table |           | 9,58,23,639/-         |
| <b>Total</b> |                        |           | <b>85,08,21,199/-</b> |

### 3. TOTAL ABSTRACT OF THE ENTIRE PROPERTY

|          |  |                          |
|----------|--|--------------------------|
| Part - A | Land   | ₹ 114,26,60,000/-        |
|          | Land Development   | ₹ 2,47,25,490/-          |
| Part - B | Buildings  | ₹ 9,58,23,639/-          |
| Part - C | Compound Wall  | -                        |
| Part - D | Amenities  | -                        |
| Part - E | Pavement   | -                        |
| Part - F | Services   | -                        |
|          | <b>Fair Market Value In (₹)</b>  | <b>₹ 126,32,09,129/-</b> |
|          | <b>Realizable Value In (₹)</b>   | <b>₹ 113,68,88,216/-</b> |
|          | <b>Distress Sale Value In (₹)</b>  | <b>₹ 101,05,67,303/-</b> |
|          | <b>Insurable Value In (₹)</b>  | <b>₹ 8,14,50,093/-</b>   |
| Remarks  | <b><u>For the purpose of valuation, we have considered the land area as per Lease agreement and structure area as per Approved Plan.</u></b> |                          |

- The cost approach is a Real Property Valuation method which considers the value of a property as the cost of the land plus the replacement cost of the building (construction costs) minus the physical and functional depreciation.
- This approach is most commonly used for real estate properties that are not easily sold like schools, hospitals, government buildings and above type of property.
- Land cost can be estimated using the Sales Comparison Approach by studying recent sales of land close to the subject property, and these sales should be comparable in size and location with subject property.
- There are different ways to estimate replacement costs, the most common being finding out the cost to build a square foot of comparable properties multiplied by the total square footage of the building. The cost approach is commonly used for Residential Bungalow, Industrial Building and properties mentioned above.
- As the property is an industrial land and building thereof, we have adopted Cost approach / Land and Building Method for the purpose of valuation. The Price for similar type of property in the nearby vicinity is in the range of ₹ 35,000/- to ₹ 40,000/- per Sq. M. for land Considering the rate with attached report, current market conditions, demand and supply position, Land size, location, sustained demand for industrial building / Plot, all round development of commercial and industrial application in the locality etc. We estimate ₹ 38,000/- per Sq. M. for Land with appropriate cost of construction for valuation.

The saleability of the property is: Normal

Likely rental values in future in: N.A.

Any likely income it may generate: N.A.



### 4. ACTUAL SITE PHOTOGRAPHS





### ACTUAL SITE PHOTOGRAPHS



Think.Innovate.Create

Vastukala Consultants (I) Pvt. Ltd.

An ISO 9001:2015 Certified Company

[www.vastukala.org](http://www.vastukala.org)





### ACTUAL SITE PHOTOGRAPHS

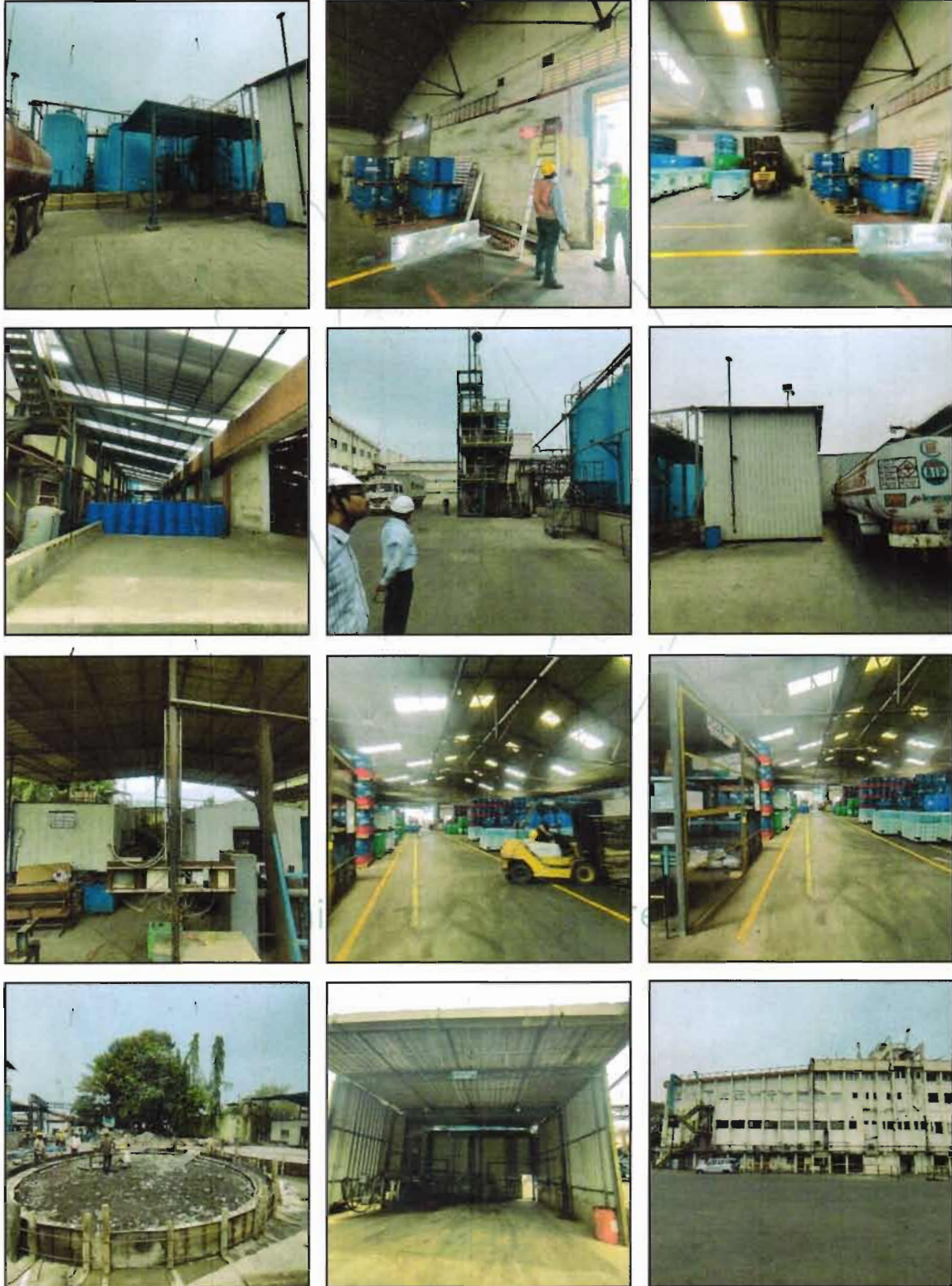



### ACTUAL SITE PHOTOGRAPHS

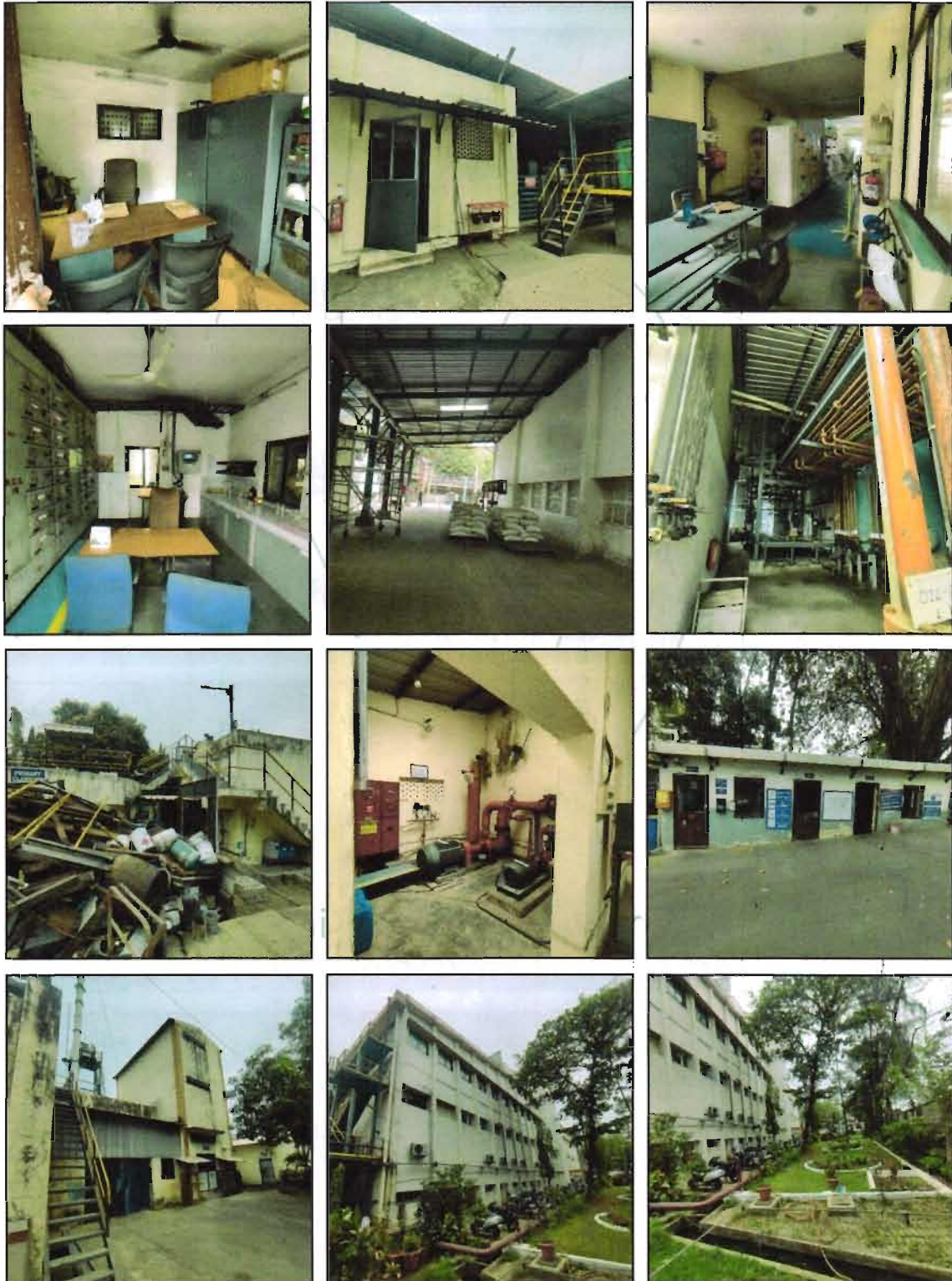



### ACTUAL SITE PHOTOGRAPHS

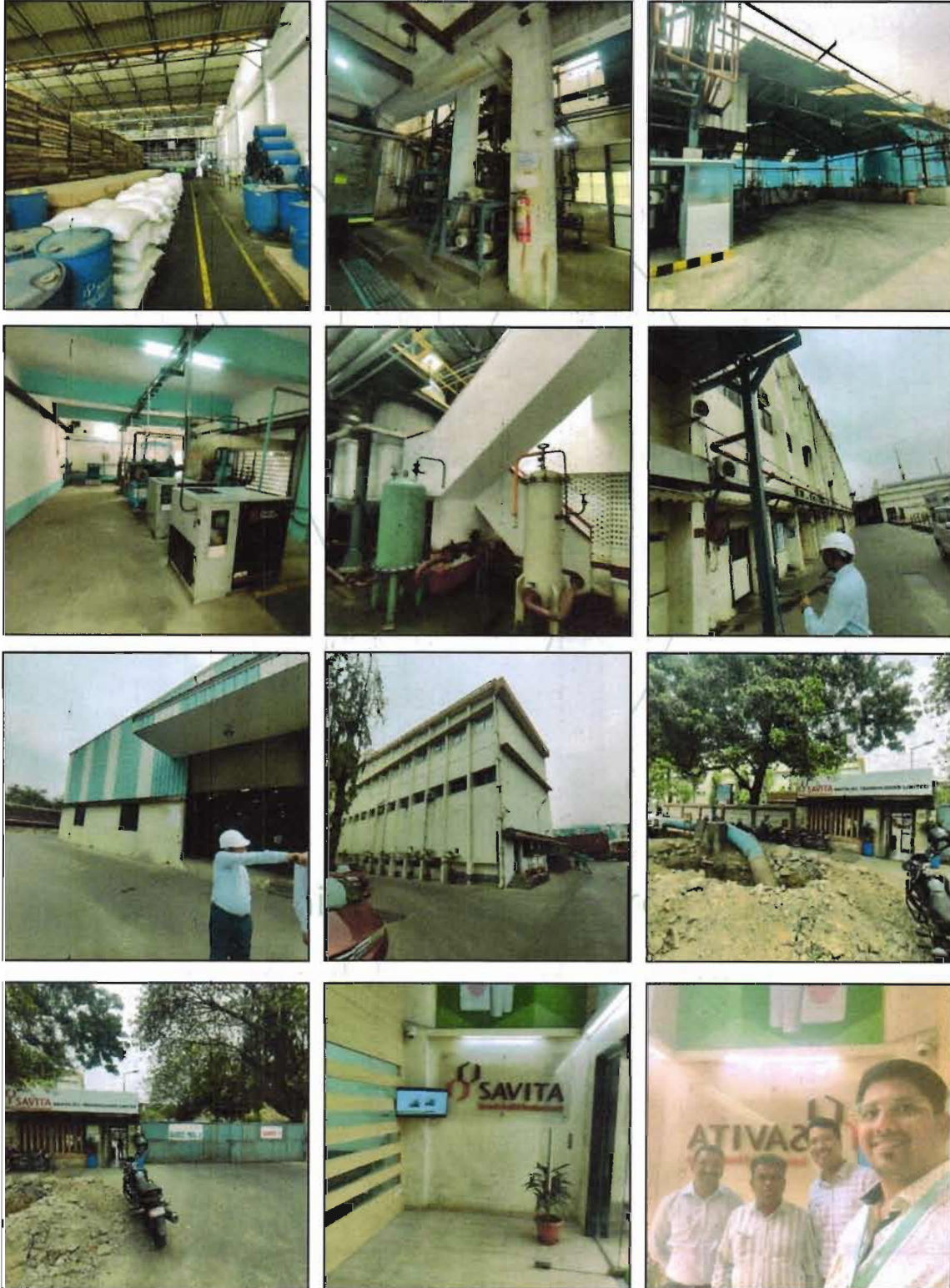

Think.Innovate.Create

Vastukala Consultants (I) Pvt. Ltd.

An ISO 9001:2015 Certified Company

[www.vastukala.org](http://www.vastukala.org)



## 5. ROUTE MAP OF THE PROPERTY

Site u/r

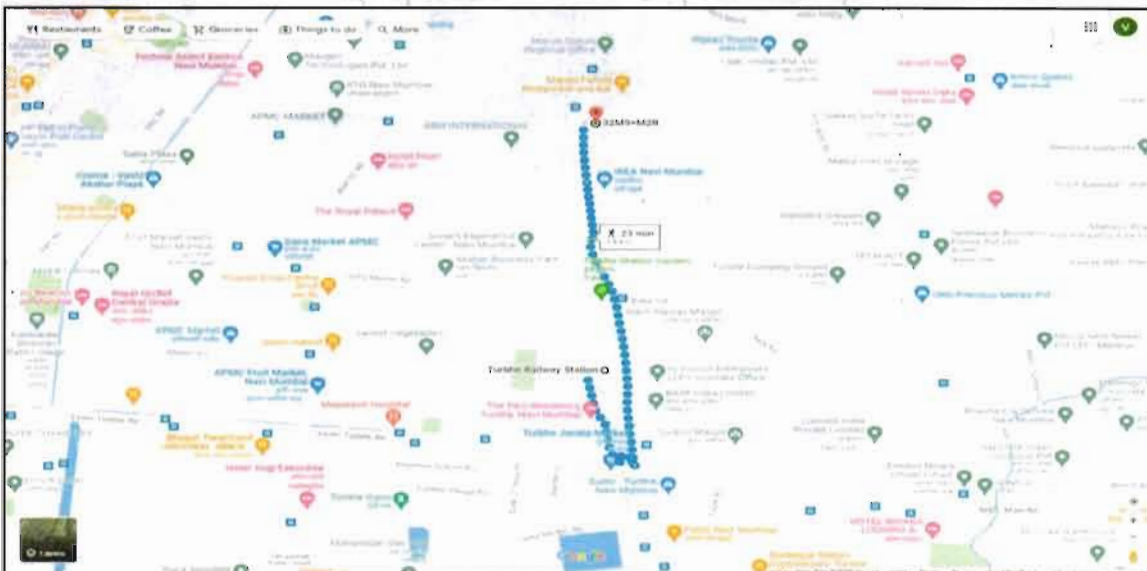

Longitude Latitude: 19°05'02.5"N 73°01'03.3"E

**Note:** The Blue line shows the route to site from nearest railway station (Turbhe – 1.8 KM.)





## 7. Plot Map

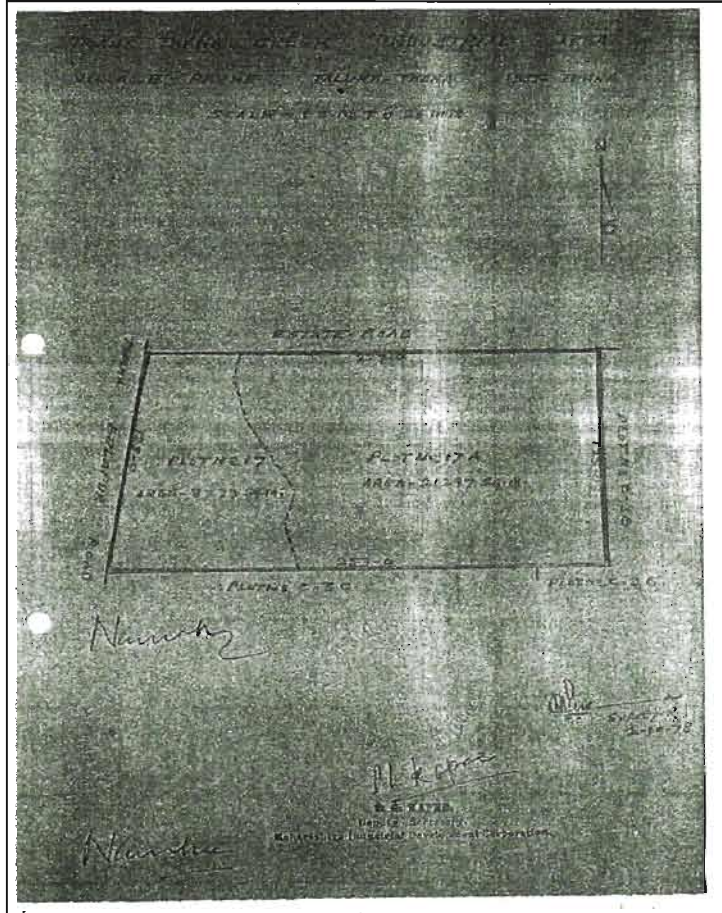

Think.Innovate.Create



Think.Innovate.Create

Vastukala Consultants (I) Pvt. Ltd.

An ISO 9001:2015 Certified Company

www.vastukala.org





## 8. M.I.D.C. CIRCLE RATE FOR LAND

|  |                                     |                                       |  |                                       |                                   |                                  |                                  |                            |                               |                                |                                       |                                 |
|--|-------------------------------------|---------------------------------------|--|---------------------------------------|-----------------------------------|----------------------------------|----------------------------------|----------------------------|-------------------------------|--------------------------------|---------------------------------------|---------------------------------|
| Regional Office  | <input type="text" value="Mahape"/> | Industrial Area                       | <input type="text" value="TTC INDL AREA"/> | <input type="button" value="Search"/> |                                   |                                  |                                  |                            |                               |                                |                                       |                                 |
| <b>TTC INDL. AREA</b>  |                                     |                                       |  |                                       |                                   |                                  |                                  |                            |                               |                                |                                       |                                 |
| <table style="width: 100%; border: none;"> <tr> <td style="width: 25%;"><a href="#">Basic Information</a></td> <td style="width: 25%;"><a href="#">City Information</a></td> <td style="width: 25%;"><a href="#">Location Details</a></td> <td style="width: 25%;"><a href="#">Contact Us</a></td> </tr> <tr> <td><a href="#">Clients</a></td> <td><a href="#">Infrastructure</a></td> <td><a href="#">Plots/Sheds Available</a></td> <td><a href="#">Industrial Maps</a></td> </tr> </table>  |                                     |                                       |  |                                       | <a href="#">Basic Information</a> | <a href="#">City Information</a> | <a href="#">Location Details</a> | <a href="#">Contact Us</a> | <a href="#">Clients</a>       | <a href="#">Infrastructure</a> | <a href="#">Plots/Sheds Available</a> | <a href="#">Industrial Maps</a> |
| <a href="#">Basic Information</a>  | <a href="#">City Information</a>    | <a href="#">Location Details</a>      | <a href="#">Contact Us</a>                 |                                       |                                   |                                  |                                  |                            |                               |                                |                                       |                                 |
| <a href="#">Clients</a>  | <a href="#">Infrastructure</a>      | <a href="#">Plots/Sheds Available</a> | <a href="#">Industrial Maps</a>            |                                       |                                   |                                  |                                  |                            |                               |                                |                                       |                                 |
| <b>Objective : To Promote Industrial Growth.</b>   |                                     |                                       |  |                                       |                                   |                                  |                                  |                            |                               |                                |                                       |                                 |
| <b>Industry Category : Major industrial area</b>   |                                     |                                       |  |                                       |                                   |                                  |                                  |                            |                               |                                |                                       |                                 |
| <p>TTC Industrial Area developed in the year 1965, admeasures about 2333 Hect. with around 4997 nos. of plots and various industrial units like Engineering, Chemical, Pharmaceutical, Petroleum, Electronics and Information Technology are established. The total area notified is 1929.79 Hect. (private land) and 539.25 Hect. (Govt. land) out of which the MIDC acquired private land admeasuring 1887.76 Hect. and Govt. land admeasuring 454.51 Hect. and total land under possession is 2333 Hect. The various Industrial, Commercial, Residential, Built-up Sheds, PAP/Stall plots allotted in TTC Industrial Area are above 5000. The roads including storm water drains &amp; streetlights in the area, except water supply &amp; drainage collection system are handed over to NMMC in the year 2004.</p> |                                     |                                       |  |                                       |                                   |                                  |                                  |                            |                               |                                |                                       |                                 |
| <b>Land Rates</b>  |                                     |                                       |  |                                       |                                   |                                  |                                  |                            |                               |                                |                                       |                                 |
| <table style="width: 100%; border: none;"> <tr> <td style="width: 70%;">Industrial Plots per sq. mtr</td> <td style="width: 30%;">: 25108</td> </tr> <tr> <td>Commercial Plots per sq. mtr</td> <td>: 75323</td> </tr> <tr> <td>Residential Plots per sq. mtr</td> <td>: NA</td> </tr> </table>  |                                     |                                       |  |                                       | Industrial Plots per sq. mtr      | : 25108                          | Commercial Plots per sq. mtr     | : 75323                    | Residential Plots per sq. mtr | : NA                           |                                       |                                 |
| Industrial Plots per sq. mtr   | : 25108                             |                                       |  |                                       |                                   |                                  |                                  |                            |                               |                                |                                       |                                 |
| Commercial Plots per sq. mtr   | : 75323                             |                                       |  |                                       |                                   |                                  |                                  |                            |                               |                                |                                       |                                 |
| Residential Plots per sq. mtr  | : NA                                |                                       |  |                                       |                                   |                                  |                                  |                            |                               |                                |                                       |                                 |
| <b>NOTE :</b>  |                                     |                                       |  |                                       |                                   |                                  |                                  |                            |                               |                                |                                       |                                 |
| <ul style="list-style-type: none"> <li>• MIDC reserves the right to revise the rates without prior notice.</li> <li>• If the plot is facing State Highway/National Highway or the service road parallel to highways, then 15% additional premium will have to be paid.</li> <li>• If the plot is having the more frontage than the standard size, then additional frontage charges will have to be paid for the excess frontage per running meter decided by the corporation time to time.</li> <li>• If the plot is situated at the junction as stated at             <ul style="list-style-type: none"> <li>◦ 1) above or having the excess frontage as stated at</li> <li>◦ 2) above, in that case the additional premium will have to be recovered which will be on higher side.</li> </ul> </li> </ul>            |                                     |                                       |  |                                       |                                   |                                  |                                  |                            |                               |                                |                                       |                                 |

Think.Innovate.Create

## 9. PRICE INDICATORS

**99acres** Commercial Buy

**₹48 Cr** (₹40,000 per sq.m.)  
 Estimated EMI: ₹18,33,779

**STATUS** NOT AVAILABLE [Website: https://maharashtra.gov.in](https://maharashtra.gov.in)

**Overview** Dealer Details Articles

**Property ID**

**Plot area** 12000 sq.m.

**Price** ₹48 Crore+ Govt Charges & Tax @ 40,000 per sq.m. (Registered) [View Price Details](#)

**Location** Turbhe, Navi Mumbai **Ready to move** Immediate

**Photos** (1/6)

**99acres** Commercial Buy

**₹8 Cr** (₹36,363 per sq.m.)  
 Estimated EMI: ₹3,28,761

**STATUS** NOT AVAILABLE [Website: https://maharashtra.gov.in](https://maharashtra.gov.in)

**Overview** Dealer Details Recommendations Articles

**Property ID**

**Plot area** 2200 sq.m.

**Price** ₹8 Crore+ Govt Charges & Tax @ 36,363 per sq.m. (Registered) [View Price Details](#)

**Location** Turbhe, Navi Mumbai **Ready to move** Immediate

**Photos** (1/3)





## PRICE INDICATORS

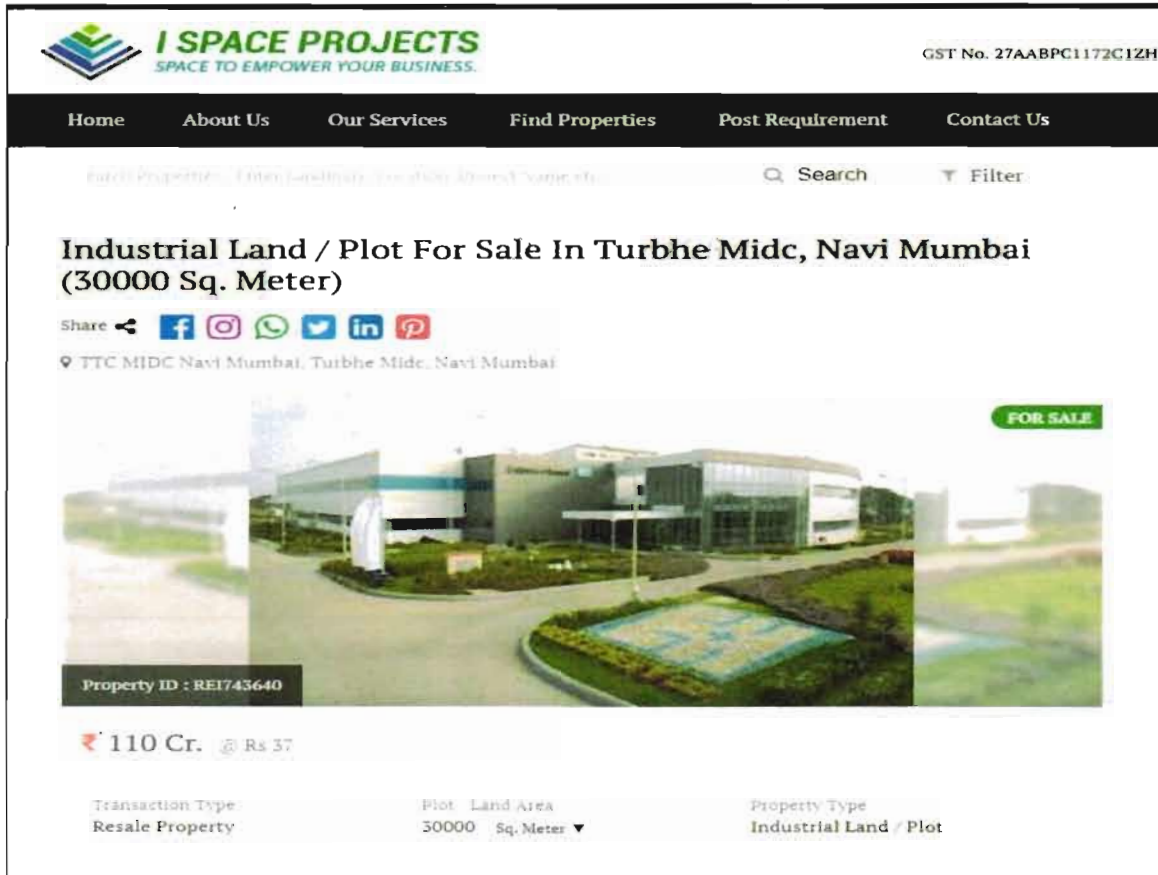

**I SPACE PROJECTS**  
SPACE TO EMPOWER YOUR BUSINESS.

GST No. 27AABPC1172C1ZH

Home About Us Our Services Find Properties Post Requirement Contact Us

Find Properties Filter Location Location Area Variety Search Filter

### Industrial Land / Plot For Sale In Turbhe Midc, Navi Mumbai (30000 Sq. Meter)

Share

📍 TTC MIDC Navi Mumbai, Turbhe Midc, Navi Mumbai

**FOR SALE**

Property ID : REI743640

₹ 110 Cr. @ Rs 37

|                                     |                                     |   |
|-------------------------------------|-------------------------------------|---|
| Transaction Type<br>Resale Property | Plot Land Area<br>30000 Sq. Meter ▼ | Property Type<br>Industrial Land / Plot |
|-------------------------------------|-------------------------------------|---|

Think.Innovate.Create

## 10. JUSTIFICATION FOR PRICE /RATE

The Market Value of the property is based on facts of markets discovered by us during our enquiries, however the government rate value in this case is less than the market value arrived by us. We are of the opinion that the value arrive by us will prove to be correct if an Auction of the subject property is carried out. As far as Market Value in Index II / Property Documents is concerned, it is not possible to comment on same, may be government rates are fixed by sampling during same point of time in part and whereas, Market values change every month. In most of the cases the actual deal amount or Transaction value is not reflected in Index II / Property Documents because of various Market practices. As Valuer, we always try to give a value which is correct reflection of actual transaction value irrespective of any factors in market.

Think.Innovate.Create



**Vastukala Consultants (I) Pvt. Ltd.**  
An ISO 9001:2015 Certified Company [www.vastukala.org](http://www.vastukala.org)





As a result of my appraisal and analysis, it is my considered opinion that the **Fair Market Value** for this particulars above property in the prevailing condition with aforesaid specification is ₹ 126,32,09,129/- (Rupees One Hundred Twenty Six Crore Thirty Two Lakh Nine Thousand One Hundred Twenty Nine Only). The **Realizable Value** of the above property is ₹ 113,68,88,216/- (Rupees One Hundred Thirteen Crore Sixty Eight Lakh Eighty Eight Thousand Two Hundred Sixteen Only). The **book value (premium of land)** of the above property as of 03.11.1978 is ₹ 2,40,600/- (Rupees Two Lakh Forty Thousand Six Hundred Only) and The **Distress Sale Value** is ₹ 101,05,67,303/- (Rupees One Hundred One Crore Five Lakh Sixty Seven Thousand Three Hundred Three Only).

Place: Mumbai

Date: 03.08.2023

For VASTUKALA CONSULTANTS (I) PVT. LTD.

Sharadkumar  
B. Chalikwar  
Director

Digitally signed by Sharadkumar B. Chalikwar  
DN: cn=Sharadkumar B. Chalikwar,  
o=Vastukala Consultants (I) Pvt. Ltd.,  
ou=CMD, email=cmd@vastukala.org, c=IN  
Date: 2023.08.03 18:05:09 +05'30'

Auth. Sign.

**Sharadkumar B. Chalikwar**

Govt. Reg. Valuer

Chartered Engineer (India)

Reg. No. (N) CCIT/1-14/52/2008-09

SBI Empanelment No.: SME/TCC/2021-22/85/13

The undersigned has inspected the property detailed in the Valuation Report dated \_\_\_\_\_

on \_\_\_\_\_. We are satisfied that the fair and reasonable market value of the property is

₹ \_\_\_\_\_ (Rupees \_\_\_\_\_

\_\_\_\_\_ only).

Date

Signature  
(Name & Designation of the Inspecting Official/s)

Countersigned  
(BRANCH MANAGER)

| Enclosures   |          |
|--|----------|
| Declaration-cum-undertaking from the valuer (Annexure- IV) | Attached |
| Model code of conduct for valuer - (Annexure - V)          | Attached |



Vastukala Consultants (I) Pvt. Ltd.

An ISO 9001:2015 Certified Company

www.vastukala.org



## (Annexure-IV)

**11. DECLARATION-CUM-UNDERTAKING**

I, Sharadj Chalikwar son of Shri. Baburao Chalikwar do hereby solemnly affirm and state that:

- a) I am a citizen of India.
- b) I will not undertake valuation of any assets in which I have a direct or indirect interest or become so interested at any time during a period of three years prior to my appointment as valuer or three years after the valuation of assets was conducted by me.
- c) The information furnished in my valuation report dated **03.08.2023** is true and correct to the best of my knowledge and belief and I have made an impartial and true valuation of the property.
- d) I/ my authorized representative has personally inspected the property on **13.04.2023**. The work is not sub - contracted to any other valuer and carried out by myself.
- e) Valuation report is submitted in the format as prescribed by the bank.
- f) I have not been depanelled / delisted by any other bank and in case any such depanelment by other banks during my empanelment with you, I will inform you within 3 days of such depanelment.
- g) I have not been removed / dismissed from service / employment earlier.
- h) I have not been convicted of any offence and sentenced to a term of imprisonment
- i) I have not been found guilty of misconduct in my professional capacity.
- j) I have not been declared to be unsound mind
- k) I am not an undischarged bankrupt or has not applied to be adjudicated as a bankrupt.
- l) I am not an undischarged insolvent.
- m) I have not been levied a penalty under section 271J of Income-tax Act, 1961 (43 of 1961) and time limit for filing appeal before Commissioner of Income-tax (Appeals) or Income-tax Appellate Tribunal, as the case may has expired, or such penalty has been confirmed by Income-tax Appellate Tribunal, and five years have not elapsed after levy of such penalty
- n) I have not been convicted of an offence connected with any proceeding under the Income Tax Act 1961, Wealth Tax Act 1957 or Gift Tax Act 1958 and
- o) My PAN Card number as applicable is AEAPC0117Q
- p) I undertake to keep you informed of any events or happenings which would make me ineligible for empanelment as a valuer.

- q) I have not concealed or suppressed any material information, facts and records and I have made a complete and full disclosure
- r) I have read the Handbook on Policy, Standards and procedure for Real Estate Valuation, 2011 of the IBA and this report is in conformity to the "Standards" enshrined for valuation in the Part - B of the above handbook to the best of my ability.
- s) I have read the International Valuation Standards (IVS) and the report submitted to the Bank for the respective asset class is in conformity to the "Standards" as enshrined for valuation in the IVS in "General Standards" and "Asset Standards" as applicable. The valuation report is submitted in the prescribed format of the bank.
- t) I abide by the Model Code of Conduct for empanelment of valuer in the Bank. (Annexure V - A signed copy of same to be taken and kept along with this declaration)
- u) I am registered under Section 34 AB of the Wealth Tax Act, 1957.
- v) I am valuer registered with Insolvency & Bankruptcy Board of India (IBBI)
- w) My CIBIL Score and credit worthiness is as per Bank's guidelines.
- x) I am Chairman & Managing Director of the company, who is competent to sign this valuation report.
- y) I will undertake the valuation work on receipt of Letter of Engagement generated from the system (i.e., LLMS / LOS) only.
- z) Further, I hereby provide the following information.

Think.Innovate.Create



| Sr. No. | Particulars  | Valuer comment  |
|---------|--|---|
| 1       | Background information of the asset being valued;  | The property (land) is owned by MIDC and it is given on leased to M/s. Savita Oils Technologies Ltd. as per Lease Agreement dated 03.11.1978.   |
| 2       | Purpose of valuation and appointing authority  | As per the request from State Bank of India, Commercial Branch – Fort Branch to assess Fair Market Value of the property for banking purpose.   |
| 3       | Identity of the Valuer and any other experts involved in the valuation;  | Sharad B. Chalikwar – Regd. Valuer & Valuation Engineer<br>Umang Patel – Regd. Valuer<br>Prayush Parekh – Valuation Engineer<br>Vaishali Sarmalkar – Technical Manager  |
| 4       | Disclosure of Valuer interest or conflict, if any;   | We have no interest, either direct or indirect, in the property valued. Further to state that we do not have relation or any connection with property owner / applicant directly or indirectly. Further to state that we are an independent Valuer and in no way related to property owner / applicant.   |
| 5       | Date of appointment, valuation date and date of report;  | Date of Appointment – 13.04.2023<br>Valuation Date – 03.08.2023<br>Date of Report – 03.08.2023  |
| 6       | Inspections and/or investigations undertaken;  | Physical Inspection done on date 13.04.2023   |
| 7       | Nature and sources of the information used or relied upon;   | <ul style="list-style-type: none"> <li>• Market Survey at the time of site visit</li> <li>• Ready Reckoner rates / Circle rates</li> <li>• Online search for Registered Transactions</li> <li>• Online Price Indicators on real estate portals</li> <li>• Enquiries with Real estate consultants</li> <li>• Existing data of Valuation assignments carried out by us</li> </ul> |
| 8       | Procedures adopted in carrying out the valuation and valuation standards followed;   | Cost Approach (For building construction)<br>Comparative Sales Method (For Land component)  |
| 9       | Restrictions on use of the report, if any;   | This valuation is for the use of the party to whom it is addressed and for no other purpose. No responsibility is accepted to any third party who may use or rely on the whole or any part of this valuation. The valuer has no pecuniary interest that would conflict with the proper valuation of the property.   |
| 10      | Major factors that were taken into account during the valuation.   | Current market conditions, demand and supply position, industrial land size, location, sustained demand for industrial land, all round development of commercial and industrial application in the locality etc.  |
| 11      | Caveats, limitations, and disclaimers to the extent they explain or elucidate the limitations faced by valuer, which shall not be for the purpose of limiting his responsibility for the valuation report. | Attached  |

## 12. ASSUMPTIONS, DISCLAIMERS, LIMITATIONS & QUALIFICATIONS

### Value Subject to Change

The subject appraisal exercise is based on prevailing market dynamics as on **03<sup>rd</sup> August 2023** and does not take into account any unforeseeable developments which could impact the same in the future.

### Our Investigations

We are not engaged to carry out all possible investigations in relation to the subject property. Where in our report we identify certain limitations to our investigations, this is to enable the reliant party to instruct further investigations where considered appropriate or where we recommend as necessary prior to reliance. Vastukala Consultants India Pvt. Ltd. (VCIPL) is not liable for any loss occasioned by a decision not to conduct further investigations

### Assumptions

Assumptions are a necessary part of undertaking valuations. VCIPL adopts assumptions for the purpose of providing valuation advice because some matters are not capable of accurate calculations or fall outside the scope of our expertise, or out instructions. The reliant party accepts that the valuation contains certain specific assumptions and acknowledge and accept the risk of that if any of the assumptions adopted in the valuation are incorrect, then this may have an effect on the valuation.

### Information Supplied by Others

The appraisal is based on the information provided by the client. The same has been assumed to be correct and has been used for appraisal exercise. Where it is stated in the report that another party has supplied information to VCIPL, this information is believed to be reliable but VCIPL can accept no responsibility if this should prove not to be so.

### Future Matters

To the extent that the valuation includes any statement as to a future matter, that statement is provided as an estimate and/or opinion based on the information known to VCIPL at the date of this document. VCIPL does not warrant that such statements are accurate or correct.

### Map and Plans

Any sketch, plan or map in this report is included to assist the reader while visualizing the property and assume no responsibility in connection with such matters.

### Site Details

Based on inputs received from Client's representative and site visit conducted, we understand that the subject property is currently a contiguous and M.I.D.C. Leasehold land parcel admeasuring **30,070.00 Sq. M. and structures thereof**. The property is owned by **M/s. Savita Oils Technologies Ltd.** At present, the property is

Owner Occupied. Further, VCIPL has assumed that the subject property is free from any encroachment and is available as on the date of the appraisal.

### **Property Title**

Based on our discussion with the Client, we understand that the property is owned by **M/s. Savita Oils Technologies Ltd.** For the purpose of this appraisal exercise, we have assumed that the subject property has a clear title and is free from any encumbrances, disputes and claims. VCIPL has made no further enquiries with the relevant local authorities in this regard and does not certify the property as having a clear and marketable title. Further, no legal advice regarding the title and ownership of the subject property has been obtained for the purpose of this appraisal exercise. It has been assumed that the title deeds are clear and marketable.

### **Environmental Conditions**

We have assumed that the subject property is not contaminated and is not adversely affected by any existing or proposed environmental law and any processes which are carried out on the property are regulated by environmental legislation and are properly licensed by the appropriate authorities.

### **Town Planning**

The permissible land use, zoning, achievable FSI, area statement adopted for purpose of this valuation is based on the information provided by the Client's representative and the same has been adopted for this valuation purpose. VCIPL has assumed the same to be correct and permissible. VCIPL has not validated the same from any authority.

### **Area**

Based on the documents, we understand that the subject property is contiguous and M.I.D.C. Leasehold land parcel admeasuring **30,070.00 Sq. M. and structures thereof.**

### **Condition & Repair**

In the absence of any information to the contrary, we have assumed that there are no abnormal ground conditions, nor archaeological remains present which might adversely affect the current or future occupation, development or value of the property. The property is free from rat, infestation, structural or latent defect. No currently known deleterious or hazardous materials or suspect techniques will be used in the construction of or subsequent alteration or additions to the property and comments made in the property details do not purport to express an opinion about, or advise upon, the condition of uninspected parts and should not be taken as making an implied representation or statement about such parts

### **Valuation Methodology**

For the purpose of this valuation exercise, the valuation methodology used is Direct Comparison Approach Method and proposed Highest and Best Use model is used for analysing development potential.



The Direct Comparison Approach involves a comparison of the property being valued to similar properties that have actually been sold in arms - length transactions or are offered for sale. This approach demonstrates what buyers have historically been willing to pay (and sellers willing to accept) for similar properties in an open and competitive market and is particularly useful in estimating the value of the land and properties that are typically traded on a unit basis.

In case of inadequate recent transaction activity in the subject micro-market, the appraiser would collate details of older transactions. Subsequently, the appraiser would analyse rental / capital value trends in the subject micro-market in order to calculate the percentage increase / decrease in values since the date of the identified transactions. This percentage would then be adopted to project the current value of the same.

Where reliance has been placed upon external sources of information in applying the valuation methodologies, unless otherwise specifically instructed by Client and/or stated in the valuation, VCIPL has not independently verified that information and VCIPL does not advise nor accept it as reliable. The person or entity to whom the report is addressed acknowledges and accepts the risk that if any of the unverified information in the valuation is incorrect, then this may have an effect on the valuation.

#### **Not a Structural Survey**

We state that this is a valuation report and not a structural survey

#### **Other**

All measurements, areas and ages quoted in our report are approximate

#### **Legal**

We have not made any allowances with respect to any existing or proposed local legislation relating to taxation on realization of the sale value of the subject property. VCIPL is not required to give testimony or to appear in court by reason of this appraisal report, with reference to the property in question, unless arrangement has been made thereof. Further, no legal advice on any aspects has been obtained for the purpose of this appraisal exercise

#### **Property specific assumptions**

Based on inputs received from the client and site visit conducted, we understand that the subject property is currently owner occupied, contiguous and M.I.D.C. Leasehold land parcel admeasuring **30,070.00 Sq. M. and structures thereof.**

### 13. ASSUMPTIONS, CAVEATS, LIMITATION AND DISCLAIMERS

1. We assume no responsibility for matters of legal nature affecting the property appraised or the title thereto, nor do we render our opinion as to the title, which is assumed to be good and marketable.
2. The property is valued as though under responsible ownership.
3. It is assumed that the property is free of liens and encumbrances.
4. It is assumed that there are no hidden or unapparent conditions of the subsoil or structure that would render it more or less valuable. No responsibility is assumed for such conditions or for engineering that might be required to discover such factors.
5. There is no direct/ indirect interest in the property valued.
6. The rates for valuation of the property are in accordance with the Govt. approved rates and prevailing market rates

Think.Innovate.Create



**Vastukala Consultants (I) Pvt. Ltd.**  
An ISO 9001:2015 Certified Company [www.vastukala.org](http://www.vastukala.org)



(Annexure - V)

## 14. MODEL CODE OF CONDUCT FOR VALUERS

### Integrity and Fairness

1. A valuer shall, in the conduct of his/its business, follow high standards of integrity and fairness in all his/its dealings with his/its clients and other valuers.
2. A valuer shall maintain integrity by being honest, straightforward, and forthright in all professional relationships.
3. A valuer shall endeavour to ensure that he/it provides true and adequate information and shall not misrepresent any facts or situations.
4. A valuer shall refrain from being involved in any action that would bring disrepute to the profession.
5. A valuer shall keep public interest foremost while delivering his services.

### Professional Competence and Due Care

6. A valuer shall render at all times high standards of service, exercise due diligence, ensure proper care and exercise independent professional judgment.
7. A valuer shall carry out professional services in accordance with the relevant technical and professional standards that may be specified from time to time.
8. A valuer shall continuously maintain professional knowledge and skill to provide competent professional service based on up-to-date developments in practice, prevailing regulations / guidelines and techniques.
9. In the preparation of a valuation report, the valuer shall not disclaim liability for his/its expertise or deny his/its duty of care, except to the extent that the assumptions are based on statements of fact provided by the company or its auditors or consultants or information available in public domain and not generated by the valuer.
10. A valuer shall not carry out any instruction of the client insofar as they are incompatible with the requirements of integrity, objectivity and independence.
11. A valuer shall clearly state to his client the services that he would be competent to provide and the services for which he would be relying on other valuers or professionals or for which the client can have a separate arrangement with other valuers.

### Independence and Disclosure of Interest

12. A valuer shall act with objectivity in his/its professional dealings by ensuring that his/its decisions are made without the presence of any bias, conflict of interest, coercion, or undue influence of any party, whether directly connected to the valuation assignment or not.
13. A valuer shall not take up an assignment if he/it or any of his/its relatives or associates is not independent in terms of association to the company.



14. A valuer shall maintain complete independence in his/its professional relationships and shall conduct the valuation independent of external influences.
15. A valuer shall wherever necessary disclose to the clients, possible sources of conflicts of duties and interests, while providing unbiased services.
16. A valuer shall not deal in securities of any subject company after any time when he/it first becomes aware of the possibility of his / its association with the valuation, and in accordance with the Securities and Exchange Board of India (Prohibition of Insider Trading) Regulations, 2015 or till the time the valuation report becomes public, whichever is earlier.
17. A valuer shall not indulge in "mandate snatching" or offering "convenience valuations" in order to cater to a company or client's needs.
18. As an independent valuer, the valuer shall not charge success fee.
19. In any fairness opinion or independent expert opinion submitted by a valuer, if there has been a prior engagement in an unconnected transaction, the valuer shall declare the association with the company during the last five years.

#### **Confidentiality**

20. A valuer shall not use or divulge to other clients or any other party any confidential information about the subject company, which has come to his / its knowledge without proper and specific authority or unless there is a legal or professional right or duty to disclose.

#### **Information Management**

21. A valuer shall ensure that he/ it maintains written contemporaneous records for any decision taken, the reasons for taking the decision, and the information and evidence in support of such decision. This shall be maintained so as to sufficiently enable a reasonable person to take a view on the appropriateness of his /its decisions and actions.
22. A valuer shall appear, co-operate and be available for inspections and investigations carried out by the authority, any person authorised by the authority, the registered valuers organisation with which he/it is registered or any other statutory regulatory body.
23. A valuer shall provide all information and records as may be required by the authority, the Tribunal, Appellate Tribunal, the registered valuers organisation with which he/it is registered, or any other statutory regulatory body.
24. A valuer while respecting the confidentiality of information acquired during the course of performing professional services, shall maintain proper working papers for a period of three years or such longer period as required in its contract for a specific valuation, for production before a regulatory authority or for a peer review. In the event of a pending case before the Tribunal or Appellate Tribunal, the record shall be maintained till the disposal of the case.

**Gifts and hospitality:**

25. A valuer or his / its relative shall not accept gifts or hospitality which undermines or affects his independence as a valuer.
26. Explanation: For the purposes of this code the term 'relative' shall have the same meaning as defined in clause (77) of Section 2 of the Companies Act, 2013 (18 of 2013).
27. A valuer shall not offer gifts or hospitality or a financial or any other advantage to a public servant or any other person with a view to obtain or retain work for himself / itself, or to obtain or retain an advantage in the conduct of profession for himself / itself.

**Remuneration and Costs.**

28. A valuer shall provide services for remuneration which is charged in a transparent manner, is a reasonable reflection of the work necessarily and properly undertaken, and is not inconsistent with the applicable rules.
29. A valuer shall not accept any fees or charges other than those which are disclosed in a written contract with the person to whom he would be rendering service.

**Occupation, employability and restrictions.**

30. A valuer shall refrain from accepting too many assignments, if he/it is unlikely to be able to devote adequate time to each of his/ its assignments.
31. A valuer shall not conduct business which in the opinion of the authority or the registered valuer organisation discredits the profession.

**Miscellaneous**

32. A valuer shall refrain from undertaking to review the work of another valuer of the same client except under written orders from the bank or housing finance institutions and with knowledge of the concerned valuer.
33. A valuer shall follow this code as amended or revised from time to time.

## 15. DEFINITION OF VALUE FOR THIS SPECIFIC PURPOSE

This exercise is to assess **Fair Market Value** of the property under reference as on **03<sup>rd</sup> August 2023**.

The term **Fair Market Value** is defined as

*“The most probable price, as of a specified date, in cash, terms equivalent to cash, or in other precisely revealed terms for which the specified property rights would sell after reasonable exposure in a competitive market under all conditions requisite to a fair sale, with the buyer and seller each acting prudently knowledgeably and for self interest assuming that neither is under undue duress”.*

Fundamental assumptions and conditions presumed in this definition are:

1. Buyer and seller are motivated by self-interest.
2. Buyer and seller are well informed and are acting prudently.
3. The property is exposed for a reasonable time on the open market.
4. Payment is made in cash or equivalent or in specified financing terms.

### DECLARATION OF PROFESSIONAL FEES CHARGED

We hereby declare that, our professional fees are not contingent upon the valuation findings. However, if the statute AND/OR clients demands that, the fees should be charged on the percentage of assessed value then, with the full knowledge of the AND/OR end user, it is being charged accordingly.

### VALUATION OF THE PROPERTY PREMISES

Considering various parameters recorded, existing economic scenario, and the information that is available with reference to the development of neighborhood and method selected for valuation, we are of the opinion that, the property premises can be assessed and Fair Market Value for this particular purpose at

| Particulars       | Fair Market Value In<br>(₹) | Realizable Value In<br>(₹) | Distress Sale Value<br>In (₹) | Insurable Value In<br>(₹) |
|-------------------|-----------------------------|----------------------------|-------------------------------|---------------------------|
| Land and Building | ₹ 126,32,09,129/-           | ₹ 113,68,88,216/-          | ₹ 101,05,67,303/-             | ₹ 8,14,50,093/-           |

For VASTUKALA CONSULTANTS (I) PVT. LTD

Sharadkumar  
B. Chalikwar  
Director

Sharadkumar B. Chalikwar

Govt. Reg. Valuer

Chartered Engineer (India)

Reg. No. (N) CCIT/1-14/52/2008-09

SBI Empanelment No.: SME/TCC/2021-22/85/13

Digitally signed by Sharadkumar B.  
Chalikwar  
DN: cn=Sharadkumar B. Chalikwar,  
ou=Vastukala Consultants (I) Pvt. Ltd.,  
ou=CMD, email=cmd@vastukala.org, c=IN  
Date: 2023.08.03 18:05:21 +05'30'

Auth. Sign.



Vastukala Consultants (I) Pvt. Ltd.  
An ISO 9001:2015 Certified Company  
www.vastukala.org

