

**APPROVED**

The Plans amended in..  
As per the conditions Mentioned in  
the accompanying commencement

Certificate No. **B2/BP/53/2019** dated **26/03/2019**

*pu*

Executive Engineer  
TOWN PLANING  
Nashik Municipal Corporation  
Nashik

**AREA STATEMENT**

BEFORE AMALGAMATION		AFTER AMALGAMATION	
PLOT NO	PLOT AREA	PLOT NO	PLOT AREA
58	84.11	58 TO 71	1055.17
59	85.05		
60	85.05		
61	85.05		
62	85.05		
63	42.525		
64	60.75		
65	60.75		
66	42.525		
67	85.05		
68	85.05		
69	85.05		
70	85.05		
71	84.11		
<b>TOTAL</b>	<b>1055.17</b>	<b>58 TO 71</b>	<b>1055.17</b>

**PROPOSED AMALGAMATION OF  
 PLOT NOS.58 TO 71 IN C.T.S. NO.4545/1/1,  
 G.NO 99+100/D/1, OF VILLAGE  
 CHUNCHALE @ NASHIK  
 FOR JADHAV BUILDERS THROUGH  
 SHRI.MADHUKAR BHAGIRATH JADHAV.**

*[Handwritten Signature]*

JADHAV BUILDERS through  
 SHRI MADHUKAR BHAGIRATH JADHAV.  
 OWNER SIGN

*[Handwritten Signature]*

*[Handwritten Signature]*

DR. NO. 1/1004  
 NASHIK, 2008-09

DR. MANOJ H. GUPTA  
 ARCHITECTS PVT. LTD.

**Ar. SURESH GUPTA**  
 B.Arch, G.D.Arch, A.I.A., M.C.A.



**Ar. SATYAPRAKASH GUPTA**  
 B.Arch, G.D.Arch, A.I.A., F.I.I.V.

**Ar. CHITRA TIBREWAL (GUPTA)**  
 B.Arch, A.I.A., M.C.A., M.P.V.A.

**Ar. MANOJ H GUPTA**  
 B.Arch, A.I.A., M.C.A., M.P.V.A.

**GUPTA'S ASSOCIATED ARCHITECTS PVT.LTD.**

Regd. Architects, Interior Designers and Govt. Approved Valuers.

GUPTA HOUSE, Gupta Wadi, Shri. Shyamal Gupta Marg, Near Dr. Kakalkar Hospital,

Opp. Ved Mandir, Off. Trimbak Road, Nashik - 2. Tel. : (0253) 2310200, 2577388

e-mail : ar.suresh@gupta@gmail.com Mobile No. Ar. Suresh. 9822091145, Ar. Manoj. 9822100000

9.00 M. WIDE ROAD

EXISTING ROAD

ADJ. C.T.S.NO.4535

ADJ. C.T.S.NO.4532

ADJ. C.T.S.NO.4531

9.00 M. W. ROAD

ADJ. C.T.S.NO.4528

ADJ. C.T.S.NO.4527

NALA

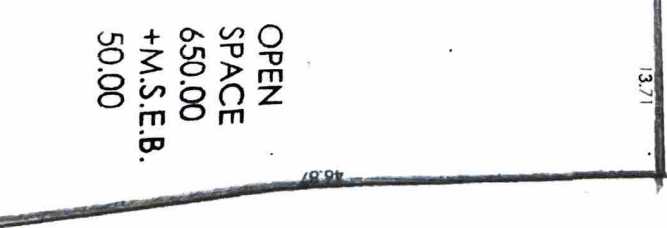
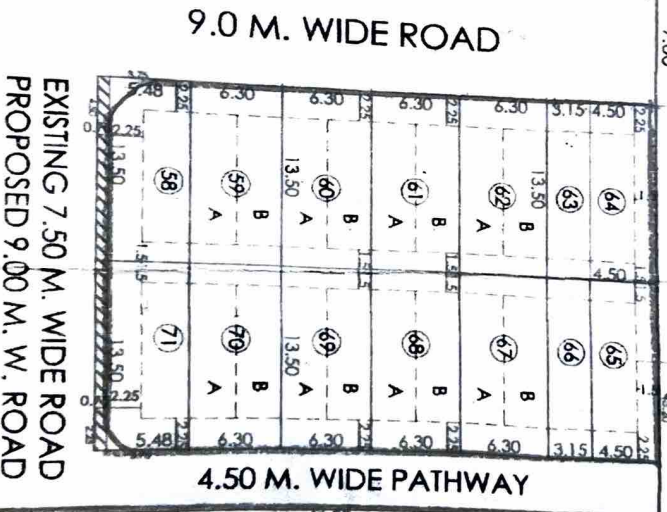
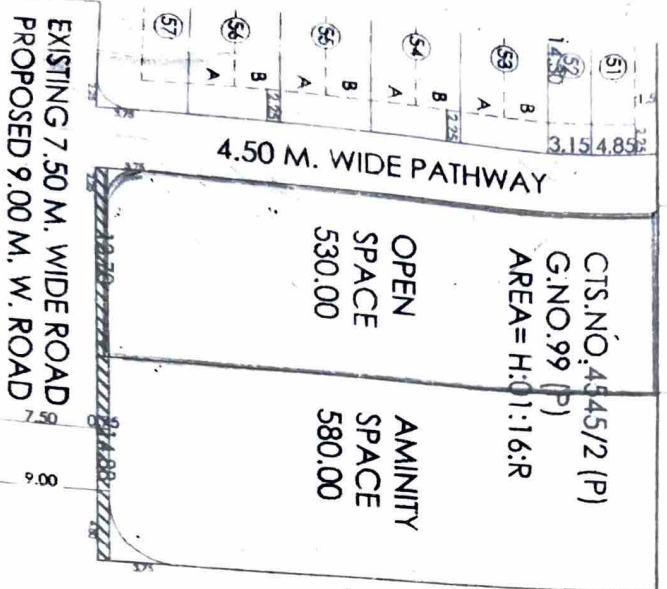

EXISTING 7.50 M. WIDE ROAD  
PROPOSED 9.00 M. W. ROAD

EXISTING 7.50 M. WIDE ROAD  
PROPOSED 9.00 M. W. ROAD

LOTS BEFORE AMALGAMATION

SCALE 1:500



EXISTING ROAD

AREA BEFORE	PLOT NO.
58	58
59	59
60	60
61	61
62	62
63	63
64	64
65	65
66	66
67	67
68	68
69	69
70	70
71	71

9.00 M. WIDE ROAD

ADJ. C.T.S.NO.4535

ADJ. C.T.S.NO.4532

ADJ. C.T.S.NO.4531

9.00 M. W. ROAD

ADJ. C.T.S.NO.4528

ADJ. C.T.S.NO.4527

NALA

EXISTING 7.50 M. WIDE ROAD  
PROPOSED 9.00 M. W. ROAD

- (51)
- (52)
- (53)
- (54)
- (55)
- (56)
- (57)

4.50 M. WIDE PATHWAY

OPEN SPACE  
530.00

CTS.NO.4545/2 (P) G.NO.99  
(P) AREA= H:01:16:R

AMINITY SPACE  
580.00

9.0 M. WIDE ROAD

58 TO 71  
1055.17 SQ.MT.

4.50 M. WIDE PATHWAY

OPEN SPACE  
650.00  
\*N.S.E.B. 50.00

EXISTING 7.50 M. WIDE ROAD  
PROPOSED 9.00 M. W. ROAD

PLOTS AFTER AMALGAMATION  
SCALE 1:500



PROPOSED PLOT NO. 58 TO 71  
G.N.O. 99  
CHUNG  
FOR JAD  
SHRI.MA

JADHAV BUI  
SHRI MADH  
OWNER SIG

At. S	Blank
N.O.	Blank
B. No.	Blank
Rel.	Blank
Gl.	Blank
O	Blank