

B-UP AREA CALCULATION OF TYPICAL FLOOR - 1ST, 3RD, 5TH, 7TH, 9TH, 11TH, 15TH, 17TH, 19TH & 21ST

TOTAL		785.631
DEDUCTION		
1	2.950 X 1.450 X 2	= 8.555
2	3.025 X 0.925 X 2	= 3.176
3	3.625 X 1.450 X 2	= 10.513
4	4.050 X 0.925 X 4	= 10.815
5	0.750 X 4.225 X 2	= 6.338
6	2.525 X 1.800 X 2	= 8.980
7	2.825 X 1.400	= 3.955
8	2.212 X 2.200	= 4.866
9	2.713 X 1.750 X 2	= 9.496
10	1.400 X 1.100 X 2	= 3.080
11	1.750 X 0.925 X 2	= 1.838
12	5.925 X 1.100 X 2	= 6.518
13	2.825 X 1.400	= 3.955
14	2.312 X 2.200	= 5.086
15	3.475 X 1.450 X 2	= 10.078
16	2.650 X 0.925 X 2	= 2.783
17	2.875 X 1.800 X 2	= 8.338
18	1.575 X 1.475 X 2	= 4.646
19	2.975 X 1.375 X 2	= 8.181
20	2.000 X 1.000	= 2.000
21	1.775 X 1.500 X 2	= 5.325
22	0.875 X 1.350 X 2	= 2.363
23	1.200 X 4.375 X 2	= 10.500
24	1.400 X 1.475 X 2	= 4.130
25	8.525 X 0.875 X 2	= 7.459
26	2.250 X 1.550 X 2	= 6.975
TOTAL DEDUCTION (a)		183.226
TOTAL LIFT AREA (c)		15.800
TOTAL (a+b+c)		201.63
TOTAL PROPOSED B&UP AREA OF TYPICAL FLOOR		584.00
B&UP AREA AS PER POLYLINE		584.00

B-UP AREA CALCULATION OF TYPICAL FLOOR - 2ND, 4TH, 6TH, 10TH, 12TH, 14TH, 16TH, 20TH & 22ND

TOTAL		785.631
DEDUCTION		
1	2.950 X 1.450 X 2	= 8.555
2	2.125 X 0.925 X 2	= 3.281
3	3.625 X 1.450 X 2	= 10.513
4	4.050 X 0.925 X 4	= 10.815
5	0.750 X 4.225 X 2	= 6.338
6	2.525 X 1.800 X 2	= 8.980
7	2.825 X 1.400	= 3.955
8	2.312 X 2.200	= 5.086
9	2.713 X 1.750 X 2	= 9.496
10	1.400 X 1.100 X 2	= 3.080
11	1.750 X 0.925 X 2	= 1.838
12	5.925 X 1.100 X 2	= 6.518
13	2.825 X 1.400	= 3.955
14	2.312 X 2.200	= 5.086
15	3.475 X 1.450 X 2	= 10.078
16	2.650 X 0.925 X 2	= 2.783
17	2.875 X 1.800 X 2	= 8.338
18	1.575 X 1.475 X 2	= 4.646
19	2.975 X 1.375 X 2	= 8.181
20	2.000 X 1.000	= 2.000
21	1.775 X 1.500 X 2	= 5.325
22	0.875 X 1.350 X 2	= 2.363
23	1.200 X 4.375 X 2	= 10.500
24	1.400 X 1.475 X 2	= 4.130
25	8.525 X 0.875 X 2	= 7.459
26	2.250 X 1.550 X 2	= 6.975
TOTAL DEDUCTION (a)		183.226
TOTAL LIFT AREA (c)		15.800
TOTAL (a+b+c)		201.63
TOTAL PROPOSED B&UP AREA OF TYPICAL FLOOR		584.00
B&UP AREA AS PER POLYLINE		584.00

B-UP AREA CALCULATION OF GROUND FLOOR - RESIDENTIAL

TOTAL		281.261
DEDUCTION		
1	0.200 X 2.175 X 1	= 0.435
2	0.200 X 2.175 X 1	= 0.435
3	2.312 X 3.800	= 8.786
4	3.225 X 1.600 X 2	= 10.320
5	6.800 X 1.800	= 12.240
6	2.312 X 3.800	= 8.786
7	2.050 X 6.450	= 13.223
8	0.950 X 4.750	= 4.513
9	5.506 X 4.850	= 26.704
10	2.069 X 4.753 X 2	= 19.669
11	5.631 X 4.850 X 2	= 27.310
12	2.875 X 6.450	= 18.544
TOTAL DEDUCTION (a)		152.082
TOTAL LIFT AREA (c)		1.420
TOTAL (a+b+c)		201.63
TOTAL PROPOSED B&UP AREA OF TYPICAL FLOOR		584.00
B&UP AREA AS PER POLYLINE		584.00

B-UP AREA CALCULATION OF GROUND FLOOR - COMMERCIAL

TOTAL		258.71
DEDUCTION		
1	2.250 X 2.925	= 6.581
2	2.700 X 1.375	= 3.713
3	5.275 X 0.100	= 0.528
4	2.800 X 2.075	= 5.810
5	1.950 X 2.975	= 5.801
6	1.775 X 3.675	= 6.523
7	0.875 X 3.325 X 2	= 5.819
8	1.838 X 1.950 X 2	= 7.168
9	1.775 X 3.675	= 6.523
10	1.550 X 2.975	= 4.601
11	2.800 X 2.075	= 5.810
12	2.700 X 1.375	= 3.713
13	1.575 X 2.850	= 4.489
TOTAL DEDUCTION (a)		68.278
TOTAL LIFT AREA (c)		258.71
TOTAL (a+b+c)		258.71
TOTAL PROPOSED B&UP AREA OF TYPICAL FLOOR		584.00
B&UP AREA AS PER POLYLINE		584.00

TOWER - X3 (WING A) - STILT + 1ST TO 22ND FLOORS

TOTAL		193.226
DEDUCTION		
D1	1.050 X 0.300 X 2	= 0.630
D2	0.200 X 1.975 X 2	= 0.790
D3	0.675 X 0.200 X 2	= 0.270
D4	0.600 X 0.200 X 4	= 0.480
D5	1.200 X 1.175 X 2	= 2.820
D6	0.375 X 0.200 X 2	= 0.150
D7	0.350 X 0.200 X 2	= 0.140
TOTAL DEDUCTION (a)		5.280
TOTAL LIFT AREA (c)		15.800
TOTAL (a+b+c)		204.31
TOTAL PROPOSED B&UP AREA OF TYPICAL FLOOR		581.32
B&UP AREA AS PER POLYLINE		581.32

BUILT UP AREA SUMMARY BLDG X-3 (WING A)

FLOOR	BUILT UP AREA (SQ.M)
GR./STILT FLOOR (RES)	111.95
GR./STILT FLOOR (COMM)	258.71
1ST FLOOR	581.32
2ND FLOOR	584.00
3RD FLOOR	581.32
4TH FLOOR	584.00
5TH FLOOR	581.32
6TH FLOOR	584.00
7TH FLOOR	581.32
8TH FLOOR	582.28
9TH FLOOR	581.32
10TH FLOOR	581.32
11TH FLOOR	581.32
12TH FLOOR	584.00
13TH FLOOR	549.54
14TH FLOOR	584.00
15TH FLOOR	581.32
16TH FLOOR	584.00
17TH FLOOR	581.32
18TH FLOOR	552.28
19TH FLOOR	581.32
20TH FLOOR	584.00
21ST FLOOR	581.32
22ND FLOOR	584.00
TOTAL B&UP AREA	13093.90 SQ.M.

RERA CARPET AREA STATEMENT

FLOOR	NO. OF FLOOR	NO. OF SHOP RERA CARPET AREA (IN SQ.M)
1	1	1
2	2	2
3	3	3
4	4	4
5	5	5
6	6	6
7	7	7
8	8	8
9	9	9
10	10	10
11	11	11
12	12	12
13	13	13
14	14	14
15	15	15
16	16	16
17	17	17
18	18	18
19	19	19
20	20	20
21	21	21
22	22	22
TOTAL	23	23

RERA CARPET AREA STATEMENT

FLOOR	NO. OF FLOOR	NO. OF FLAT RERA CARPET AREA (IN SQ.M)
1	1	29
2	2	39
3	3	39
4	4	29
5	5	29
6	6	29
7	7	29
8	8	29
9	9	29
10	10	29
11	11	29
12	12	29
13	13	29
14	14	29
15	15	29
16	16	29
17	17	29
18	18	29
19	19	29
20	20	29
21	21	29
22	22	29
TOTAL	23	657

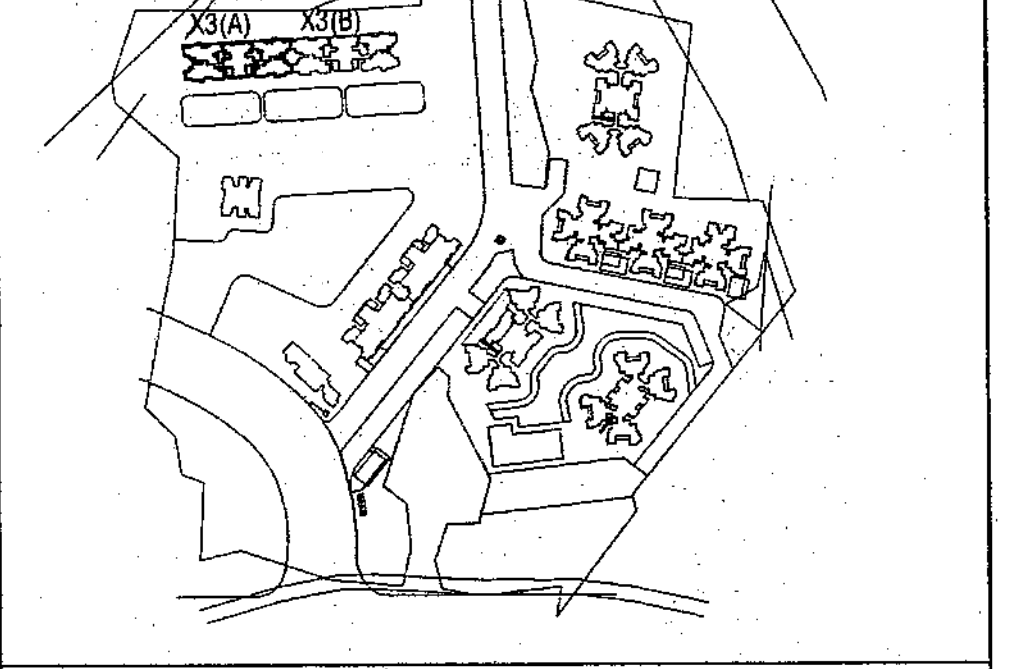

SCHEDULE OF DOORS & WINDOWS

SIZE	TYPE	DESCRIPTION
1.05 X 2.10	D	T.W. FRAMED WITH PANNELED DOOR
0.90 X 2.10	D1	T.W. FRAMED WITH PANNELED DOOR
0.75 X 2.00	D2	T.W. FRAMED WITH PANNELED DOOR
1.85 X 1.50	W	ALUMINIUM SLIDING GLAZED WINDOW
1.50 X 1.50	W1	ALUMINIUM SLIDING GLAZED WINDOW
1.20 X 1.50	W2	ALUMINIUM SLIDING GLAZED WINDOW
1.25 X 1.50	W3	ALUMINIUM SLIDING GLAZED WINDOW
1.10 X 1.50	W4	ALUMINIUM SLIDING GLAZED WINDOW
1.15 X 1.50	W5	ALUMINIUM SLIDING GLAZED WINDOW
1.175 X 1.50	W5	ALUMINIUM SLIDING GLAZED WINDOW
1.05 X 1.50	W7	ALUMINIUM SLIDING GLAZED WINDOW
0.60 X 0.90	V	ALUMINIUM LOUVERS WINDOW
1.20 X 2.10	FRD	FIRE RESISTANT DOOR
1.05 X 2.10	FRD-1	FIRE RESISTANT DOOR
0.90 X 2.10	FRD-2	FIRE RESISTANT DOOR

DESCRIPTION OF PROPOSAL

PROPOSED RESIDENTIAL COMPLEX ON PLOT BEARING S.M.O. 140/1, 140/2, 140/3, 140/4, 141/2A, 141/2B, 142/1, 142/3, 220/1A, 220/1B, 220/1C, 220/1D, 220/1E, 220/2A, 220/2B, 220/5, 232 AT VILLAGE DESAI, TAL. & DIST. THANE

NAME AND ADDRESS OF OWNER/ P.O.A.H.

M/S MARATHON ENER-GEM LLP,
702, MARATHON MAX, MULUND-GEURGAON LINK ROAD,
MULUND (W), MUMBAI - 40

SIGNATURE OF OWNER/ P.O.A.H. **SIGNATURE OF ARCHITECT**

ARCHITECTS

Sankar Architects

2ND FLOOR, NAKSHATRA, A WING,
NEAR TTC, ALMEIDA ROAD,
PANCHPAKHADI, THANE (W), 400 602
PHONE - 2537 6701, TELEFAX - 2536 4700
E-MAIL - saakaraarchitects@yahoo.co.in

DRG. NO.	SCALE	DATE	DRN. BY	CHKD BY
C-493/2022/M/06	1 : 100	31/05/2022	MANALI/TUSHAR	