

## Valuation Report of the Immovable Property



### Details of the property under consideration:

Name of Owner: **Shri. Dadasaheb Kashinath Jagdhane & Sau. Anita Dadasaheb Jagdhane.**

Loan Amount No. **(373515996677 & 37351628680)**

Residential Flat No. 13, Third Floor, " **Archit Odyssey Apartment** ", Survey No. 11/ 1/ 1B, Plot No. 29,30,31,37 to 40, Near Navarachana Vidyalaya, Veer Sawarkar Nagar, Off Gangapur Road, Village - Anandwalli, Taluka & District - Nashik, PIN Code - 422 013, State - Maharashtra, Country - India.

Longitude Latitude: 20°00'56.7"N 73°45'13.0"E

### Intended User:

**State Bank of India  
RACPC Nashik Branch**

1st Floor, Patel Plaza, N.D. Patel Road, Opp. BSNL, Landmark Seawoods Navratna Hotel,  
Nashik - 422001, State – Maharashtra, Country – India.

**Nashik:** 4, 1st Floor, Madhusha Elite, Vrundavan Nagar, Jatra Nandu Naka Link Road, Adgaon, Nashik-422003 (M.S.), INDIA  
Email: nashik@vastukala.co.in | Tel : +91 253 4068262/98903 80564

#### Our Pan India Presence at :

📍 Nanded      📍 Thane      📍 Ahmedabad      📍 Delhi NCR  
📍 Mumbai      📍 Nashik      📍 Rajkot      📍 Raipur  
📍 Aurangabad      📍 Pune      📍 Indore      📍 Jaipur

#### Regd. Office

B1-001, U/B Floor, BOOMERANG, Chandivali Farm Road, Powai, Andheri East, **Mumbai** :400072, (M.S), India

📞 +91 22 47495919

✉️ [mumbai@vastukala.co.in](mailto:mumbai@vastukala.co.in)

🌐 [www.vastukala.co.in](http://www.vastukala.co.in)





**VASTUKALA**  
Unlocking Excellence

www.vastukala.co.in

MSME Reg No: UDYAM-MH-18-0083617

An ISO 9001 : 2015 Certified Company

CIN: U74120MH2010PTC207869

## Vastukala Consultants (I) Pvt. Ltd.

Valuation Report / SBI / RACPC Nashik Branch/ Shri. Dadasaheb Kashinath Jagdhane & Others (009280/2306736) Page 2 of 25

Vastu/Nashik/06/2024/009280/2306736

14/5-180-RYBS

Date: 13.06.2024

### VALUATION OPINION REPORT

This is to certify that the property bearing Residential Flat No. 13, Third Floor, " **Archit Odyssey Apartment** ", Survey No. 11/ 1/ 1B, Plot No. 29,30,31,37 to 40, Near Navarachana Vidyalaya, Veer Sawarkar Nagar, Off Gangapur Road, Village - Anandwalli, Taluka & District - Nashik, PIN Code - 422 013, State - Maharashtra, Country - India. belongs to **Name of Owner: Shri. Dadasaheb Kashinath Jagdhane & Sau. Anita Dadasaheb Jagdhane.**

Boundaries of the property.

Boundaries of the property		Plot
North	:	Building
South	:	Road
East	:	Road
West	:	Building

Considering various parameters recorded, existing economic scenario, and the information that is available with reference to the development of neighbourhood and method selected for valuation, we are of the opinion that, the property premises can be assessed and valued for SARFAESI Securitisation and Reconstruction of Financial Assets and Enforcement of Security Interest Act, 2002 purpose at ₹ **36,97,380.00 (Rupees Thirty Six Lakh Ninety Seven Thousand Three Hundred Eighty Only).**

The valuation of the property is based on the documents produced by the concern. Legal aspects have not been taken into considerations while preparing this valuation report.

Hence certified

For **VASTUKALA CONSULTANTS (I) PVT. LTD.**

**Manoj  
Chalikwar**

**Director**

**Manoj B. Chalikwar**

Registered Valuer

Chartered Engineer (India)

Reg. No. CAT-I-F-1763

SBI Empanelment No.: SME/TCC/2021-22/86/3

Encl: Valuation report.

Digitally signed by Manoj Chalikwar  
DN: cn=Manoj Chalikwar, o=Vastukala  
Consultants (I) Pvt. Ltd., ou=Mumbai,  
email=manoj@vastukala.org, c=IN  
Date: 2024.06.14 13:02:09 +05'30'

Auth. Sign.



**Nashik:** 4, 1st Floor, Madhusa Elite, Vrundavan Nagar, Jatra Nandu Naka Link Road, Adgaon, Nashik-422003 (M.S.), INDIA  
Email: nashik@vastukala.co.in | Tel : +91 253 4068262/98903 80564

Our Pan India Presence at :

Nanded Thane Ahmedabad Delhi NCR  
Mumbai Nashik Rajkot Raipur  
Aurangabad Pune Indore Jaipur

**Regd. Office**

BI-001, U/B Floor, BOOMERANG, Chandivali Farm Road, Powai, Andheri East, Mumbai:400072, (M.S), India

+91 22 47495919

mumbai@vastukala.co.in

www.vastukala.co.in

**Vastukala Consultants (I) Pvt. Ltd.**B1-001, U/B Floor, **Boomerang**, Chandivali Farm Road, Powai, Andheri (East), Mumbai – 400 072.

To,  
**The Branch Manager,**  
**State Bank of India**  
**RACPC Nashik Branch**  
 1st Floor, Patel Plaza, N.D. Patel Road,  
 Opp. BSNL, Landmark Seawoods Navratna Hotel,  
 Nashik - 422001, State – Maharashtra, Country – India.

**VALUATION REPORT (IN RESPECT OF FLAT)**

I		General	
1.	Purpose for which the valuation is made	:	As per the request from State Bank of India, RACPC Nashik Branch to assess fair market value of the property for SARFAESI Securitisation and Reconstruction of Financial Assets and Enforcement of Security Interest Act, 2002 purpose.
2.	a)	Date of inspection	: 13.06.2024
	b)	Date on which the valuation is Made	: 13.06.2024
3.	List of documents produced for perusal: 1) Copy of Deed of Apartment Vide No. 3076/ 2016 Dated.11.04.2016. 2) Copy of Approved Building Plan Accompanying Commencement Certificate No. CD/ 257 Dated. 28.06.2001 issued by Nashik Municipal Corporation, Nashik. 3) Copy of Occupancy Certificate No. NNRV/ 002909 / Satpur Dated. 19.07.2001 issued by Nashik Municipal Corporation, Nashik. 4) Copy of Pervious Valuation Report issued by S.D. Deshpande Dated. 04.12.2017.		
4.	Name of the owner(s) and his / their address (es) with Phone no. (details of share of each owner in case of joint ownership)	:	Name of Owner: <b>Shri. Dadasaheb Kashinath Jagdhane &amp; Sau. Anita Dadasaheb Jagdhane,</b>  <b>Address:</b> Residential Flat No. 13, Third Floor, " <b>Archit Odyssey Apartment</b> ", Survey No. 11/ 1/ 1B, Plot No. 29, 30,31,37 to 40, Near Navarachana Vidyalaya, Veer Sawarkar Nagar, Off Gangapur Road, Village -Anandwalli, Taluka & District - Nashik, PIN Code - 422 013, State - Maharashtra, Country - India.  <b>Contact Person:</b> Internal Site Visit not allowed.
5.	Brief description of the property (Including Leasehold / freehold etc.)	:	At the time of visit physical measurement of the property could not be taken. We have taken the area as per Deed of Apartment & Pervious Valuation. The Composition of Flat as per Approved Building Plan is Living + Kitchen + Bedroom + Toilet + Balcony + Passage. <b>i.e. (1BHK + Adjacent Terrace Area).</b> The property is at 15.0 KM. distance from Nashik Road



Since 1989

**Vastukala Consultants (I) Pvt. Ltd.**

An ISO 9001 : 2015 Certified Company



			Railway Station Nashik. <b>Landmark:</b> Near Navarachana Vidyalaya
6.	Location of property	:	
	a) Plot No. / Survey No.	:	Survey No. 11/ 1/ 1B, Plot No. 29,30,31,37 to 40
	b) Door No.	:	Residential Flat No. 13
	c) C.T.S. No. / Village	:	Village – Nashik
	d) Ward / Taluka	:	Taluka – Nashik
	e) Mandal / District	:	District – Nashik
	f) Date of issue and validity of layout of approved map / plan	:	Copy of Approved Building Plan Accompanying Commencement Certificate No. CD/ 257 Dated. 28.06.2001 issued by Nashik Municipal Corporation, Nashik.
	g) Approved map / plan issuing authority	:	Nashik Municipal Corporation.
	h) Whether genuineness or authenticity of approved map/ plan is verified	:	Yes
	i) Any other comments by our empanelled valuers on authentic of approved plan	:	Yes - Flat is Locked at the time of Site Visit, Only External Visit Done on Site. At the time of visit physical measurement of the property could not be taken. We have taken the area as per Deed of Apartment. & Others as pervious Valuation Report.
7.	Postal address of the property	:	Residential Flat No. 13, Third Floor, " <b>Archit Odyssey Apartment</b> ", Survey No. 11/ 1/ 1B, Plot No. 29,30,31, 37 to 40, Near Navarachana Vidyalaya, Veer Sawarkar Nagar, Off Gangapur Road, Village - Anandwalli, Taluka & District - Nashik, PIN Code - 422 013, State - Maharashtra, Country - India.
8.	City / Town	:	Nashik
	Residential area	:	Yes
	Commercial area	:	No
	Industrial area	:	No
9.	Classification of the area	:	
	i) High / Middle / Poor	:	Middle Class
	ii) Urban / Semi Urban / Rural	:	Urban
10.	Coming under Corporation limit / Village Panchayat / Municipality	:	Village – Nashik Nashik Municipal Corporation
11.	Whether covered under any State / Central Govt. enactments (e.g., Urban Land Ceiling Act) or notified under agency area/ scheduled area / cantonment area	:	No
12.	<b>Boundaries of the property</b>		
	<b>Plot</b>	:	<b>As per actual site</b> <b>As per document</b>
	North	:	Building      S. No. 7
	South	:	Road      7.50 M. Colony Road
	East	:	Road      18.00 M. Road
	West	:	Building      Plot No. 26
	<b>Flat</b>	:	<b>As per actual site</b> <b>As per Plan</b>
	North	:	Flat No. 12

	South	Internal Site Visit not allowed	7.50 M. Colony Road
	East		S. No. 11/ 1/ 4 B
	West		Flat No. 14
13	Dimensions of the site	-	
		<b>A</b> As per site	<b>B</b> As per Document
	North	: -	-
	South	: -	-
	East	: -	-
	West	: -	-
14.	Extent of the site	:	<b>Built Up Area in Sq. Ft. = 691.00</b> <b>Adjacent Terrace Area in Sq. Ft. = 118.00</b> <b>Total Built Up Area in Sq. Ft. = 738.00</b> <b>(Total Built Up Area + 40% Adjacent Terrace Area)</b> <b>(Area as per Deed of Apartment)</b>
14.1	Latitude, Longitude & Co-ordinates of Flat	:	20°00'56.7"N 73°45'13.0"E
15.	Extent of the site considered for Valuation (least of 13A& 13B)	:	<b>Built Up Area in Sq. Ft. = 691.00</b> <b>Adjacent Terrace Area in Sq. Ft. = 118.00</b> <b>Total Built Up Area in Sq. Ft. = 738.00</b> <b>(Total Built Up Area + 40% Adjacent Terrace Area)</b> <b>(Area as per Deed of Apartment)</b>
16	Whether occupied by the owner / tenant? If occupied by tenant since how long? Rent received per month.	:	Residential Flat is Locked at the time of Site Visit, only External Visit Done on Site.
<b>II</b>	<b>APARTMENT BUILDING</b>		
1.	Nature of the Apartment	:	Residential
2.	Location	:	
	C.T.S. Gat No	:	Survey No. 11/ 1/ 1B, Plot No. 29,30,31,37 to 40
	Block No.	:	-
	Ward No.	:	-
	Village / Municipality / Corporation	:	Village – Nashik Nashik Municipal Corporation
	Door No., Street or Road (Pin Code)	:	Residential Flat No. 13, Third Floor, " <b>Archit Odyssey Apartment</b> ", Survey No. 11/ 1/ 1B, Plot No. 29,30,31, 37 to 40, Near Navarachana Vidyalaya, Veer Sawarkar Nagar, Off Gangapur Road, Village - Anandwalli, Taluka & District - Nashik, PIN Code - 422 013, State - Maharashtra, Country - India.
3.	Description of the locality Residential / Commercial / Mixed	:	Residential
4.	Year of Construction	:	2001 (As per occupancy Certificate)
5.	Number of Floors	:	Ground + Stilt + 2nd Upper Floors
6.	Type of Structure	:	R.C.C. Framed Structure
	Number of Dwelling units in the Flat	:	4 Flats on Third Floor
	Quality of Construction	:	Average
	Appearance of the Flat	:	Average

	Maintenance of the Flat	:	Average
	Facilities Available	:	
	Lift	:	NA
	Protected Water Supply	:	Municipal Water supply
	Underground Sewerage	:	Connected to Municipal Sewerage System
	Car parking - Open / Covered	:	Open Car Parking
	Is Compound wall existing?	:	Yes
	Is pavement laid around the building	:	Yes
<b>III</b>	<b>Residential Flat</b>		
1	The floor in which the flat is situated	:	Third Floor
2	Door No. of the Flat	:	Residential Flat No. 13
3	Specifications of the Flat	:	1BHK + Attached Terrace Area
	Roof	:	Internal Site Visit not allowed
	Flooring	:	Internal Site Visit not allowed
	Doors	:	Internal Site Visit not allowed
	Windows	:	Internal Site Visit not allowed
	Fittings	:	Internal Site Visit not allowed
	Finishing	:	Internal Site Visit not allowed
4	House Tax	:	
	Assessment No.	:	Details Not Provided
	Tax paid in the name of:	:	Details Not Provided
	Tax amount:	:	Details Not Provided
5	Electricity Service connection No.:	:	Details Not Provided
	Meter Card is in the name of:	:	Details Not Provided
6	How is the maintenance of the Flat?	:	Average
7	Sale Deed executed in the name of	:	Name of Owner: <b>Shri. Dadasaheb Kashinath Jagdhane &amp; Sau. Anita Dadasaheb Jagdhane.</b>
8	What is the undivided area of land as per Sale Deed?	:	Details not available
9	What is the plinth area of the Flat?	:	<b>Built Up Area in Sq. Ft. = 691.00</b> <b>Adjacent Terrace Area in Sq. Ft. = 118.00</b> <b>Total Built Up Area in Sq. Ft. = 738.00</b> <b>(Total Built Up Area + 40% Adjacent Terrace Area)</b> <b>(Area as per Deed of Apartment)</b>
10	What is the floor space index (app.)	:	As per Nashik Municipal Corporation norms
11	What is the Carpet area of the Flat?	:	Internal Site Visit not allowed
12	Is it Posh / I Class / Medium / Ordinary?	:	Medium Class
13	Is it being used for Residential or Commercial purpose?	:	Residential purpose
14	Is it Owner-occupied or let out?	:	Residential Flat is Locked at the time of Site Visit, only External Visit Done on Site.
15	If rented, what is the monthly rent?	:	₹ 8,000.00 Expected rental income per month
<b>IV</b>	<b>MARKETABILITY</b>	:	
1	How is the marketability?	:	Good

2	What are the factors favoring for an extra Potential Value?	:	Located in developing area
3	Any negative factors are observed which affect the market value in general?	:	No
<b>V</b>	<b>Rate</b>	:	
1	After analyzing the comparable sale instances, what is the composite rate for a similar Flat with same specifications in the adjoining locality? - (Along with details / reference of at least two latest deals / transactions with respect to adjacent properties in the areas)	:	₹ 5,000.00 to ₹ 6,000.00 per Sq. Ft. on Built Up Area
2	Assuming it is a new construction, what is the adopted basic composite rate of the Flat under valuation after comparing with the specifications and other factors with the Flat under comparison (give details).	:	₹ 5,700.00 per Sq. Ft. on Built Up Area
3	Break – up for the rate	:	
	I. Building + Services	:	₹ 2,000.00 per Sq. Ft.
	II. Land + others	:	₹ 3,700.00 per Sq. Ft.
4	Guideline rate obtained from the Registrar's Office	:	₹ 51,500.00 per Sq. M. i.e. ₹ 4,784.00 per Sq. Ft.
	Guideline rate (after depreciation)	:	₹ 47,475.00 per Sq. M. i.e. ₹ 4,411.00 per Sq. Ft.
	In case of variation of 20% or more in the valuation proposed by the Valuer and the Guideline value provided in the State Govt. notification or Income Tax Gazette justification on variation has to be given	:	It is a foregone conclusion that market value is always more than the RR price. As the RR Rates area Fixed by respective State Government for computing Stamp Duty / Rgstn. Fees. Thus the differs from place to place and Location, Amenities per se as evident from the fact than even RR Rates Decided by Government Differs.
<b>VI</b>	<b>COMPOSITE RATE ADOPTED AFTER DEPRECIATION</b>		
<b>a</b>	Depreciated building rate	:	₹ 1,310.00 per Sq. Ft.
	Replacement cost of Flat with Services (v(3)i)	:	₹ 2,000.00 per Sq. Ft.
	Age of the building	:	23 Years
	Life of the building estimated	:	37 Years Subject to proper, preventive periodic maintenance & structural repairs.
	Depreciation percentage assuming the salvage value as 10%	:	34.50%
	Depreciated Ratio of the building	:	-
<b>b</b>	Total composite rate arrived for Valuation	:	
	Depreciated building rate VI (a)	:	₹ 1,310 per Sq. Ft.
	Rate for Land & other V (3) ii	:	₹ 3,700.00 per Sq. Ft.
	<b>Total Composite Rate</b>	:	<b>₹ 5,010.00 per Sq. Ft.</b>
	<b>Remarks:</b> At the time of visit physical measurement of the property could not be taken. We have taken the area as per Deed of Apartment. & Others as pervious Valuation Report.		

**Details of Valuation:**

Sr. No.	Description	Qty.	Rate per unit (₹)	Estimated Value (₹)
1	Present value of the Flat	738.00 Sq. Ft.	5,010.00	36,97,380.00
2	Terrace Area			
3	Open Terrace Area			
4	Car Parking			
5	Showcases			
6	Kitchen arrangements			
7	Superfine finish			
8	Interior Decorations			
9	Electricity deposits / electrical fittings, etc.			
10	Extra collapsible gates / grill works etc.			
11	Potential value, if any			
12	Others			
	<b>Present Market Value of the property</b>			<b>36,97,380.00</b>
	<b>Realizable Value of the property</b>			<b>31,42,773.00</b>
	<b>Distress sale value of the property</b>			<b>25,88,166.00</b>
	<b>Insurable value of the property (738.00Sq. Ft. x 2,000.00)</b>			<b>14,76,000.00</b>
	<b>Guideline value of the property (738.00 Sq. Ft. x 4,411.00)</b>			<b>32,55,318.00</b>

**Justification for price / rate**

The Market Value of the property is based on facts of markets discovered by us during our enquiries, however the government rate value in this case is less than the market value arrived by us. We are of the opinion that the value arrive by us will prove to be correct if an Auction of the subject property is carried out. As far as Market Value in Index II is concerned, it is not possible to comment on same, may be government rates are fixed by sampling during same point of time in part and whereas, Market values change every month.

In most of the cases the actual deal amount or Transaction value is not reflected in Index II because of various Market practices. As Valuer, we always try to give a value which is correct reflection of actual transaction value irrespective of any factors in market.

**Method of Valuation / Approach**

The sales comparison approach uses the market data of sale prices to estimate the value of a real estate property. Property valuation in this method is done by comparing a property to other similar properties that have been recently sold. Comparable properties, also known as comparable, or comps, must share certain features with the property in question. Some of these include physical features such as square footage, number of rooms, condition, and age of the building; however, the most important factor is no doubt the location of the property. Adjustments are usually needed to



Since 1989

**Vastukala Consultants (I) Pvt. Ltd.**

An ISO 9001 : 2015 Certified Company





account for differences as no two properties are exactly the same. To make proper adjustments when comparing properties, real estate appraisers must know the differences between the comparable properties and how to value these differences. The sales comparison approach is commonly used for Residential Flat, where there are typically many comparable available to analyze. As the property is a Residential Flat, we have adopted Sale Comparison Approach Method for the purpose of valuation. The Price for similar type of property in the nearby vicinity is in the range of ₹ 5,000.00 to ₹ 6,000.00 per Sq. Ft. on Built Up Area. Considering the rate with attached report, current market conditions, demand and supply position, Flat size, location, upswing in real estate prices, sustained demand for Residential Flat, all-round development of residential and Commercial application in the locality etc. We estimate ₹ 5,010.00 per Sq. Ft. on Built Up Area for valuation after depreciation.

Impending threat of acquisition by government for road widening / public service purposes, sub merging & applicability of CRZ provisions (Distance from sea-cost / tidal level must be incorporated) and their effect on	
i) Sale ability	Average
ii) Likely rental values in future	₹ 8,000.00 Expected rental income per month
iii) Any likely income it may generate	Rental Income



Since 1989

Vastukala Consultants (I) Pvt. Ltd.

An ISO 9001 : 2015 Certified Company



### Actual site Photographs

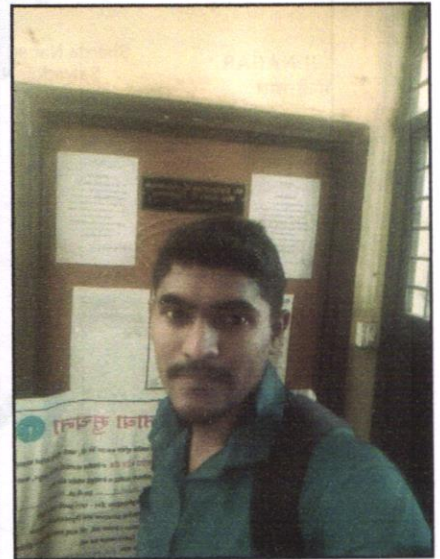
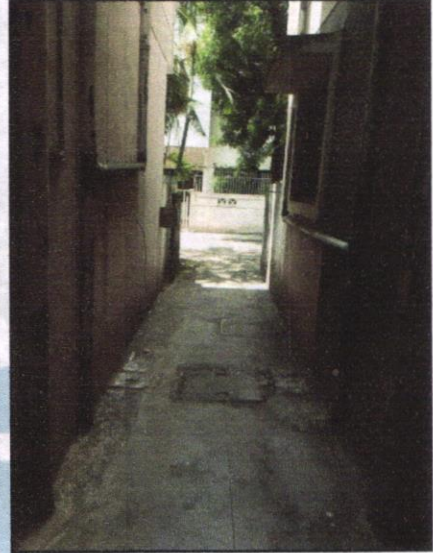

Since 1989

**Vastukala Consultants (I) Pvt. Ltd.**

An ISO 9001 : 2015 Certified Company



## Route Map of the property

Site u/r

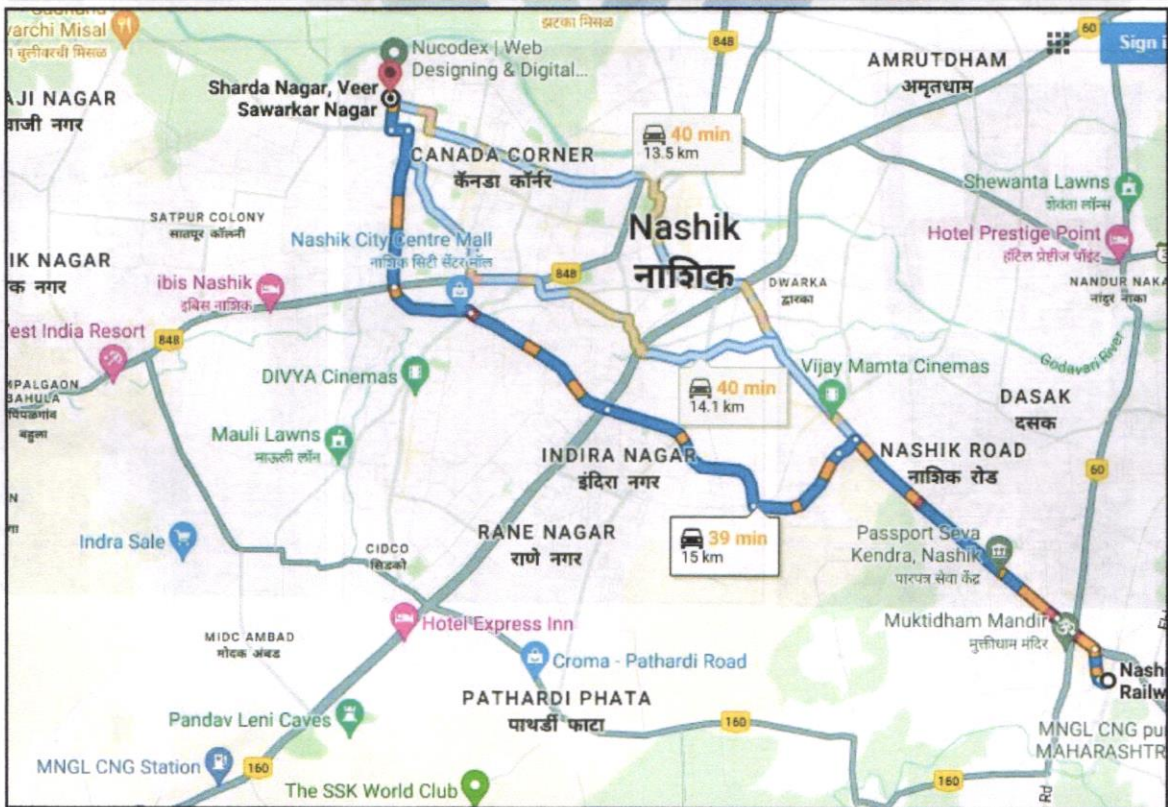
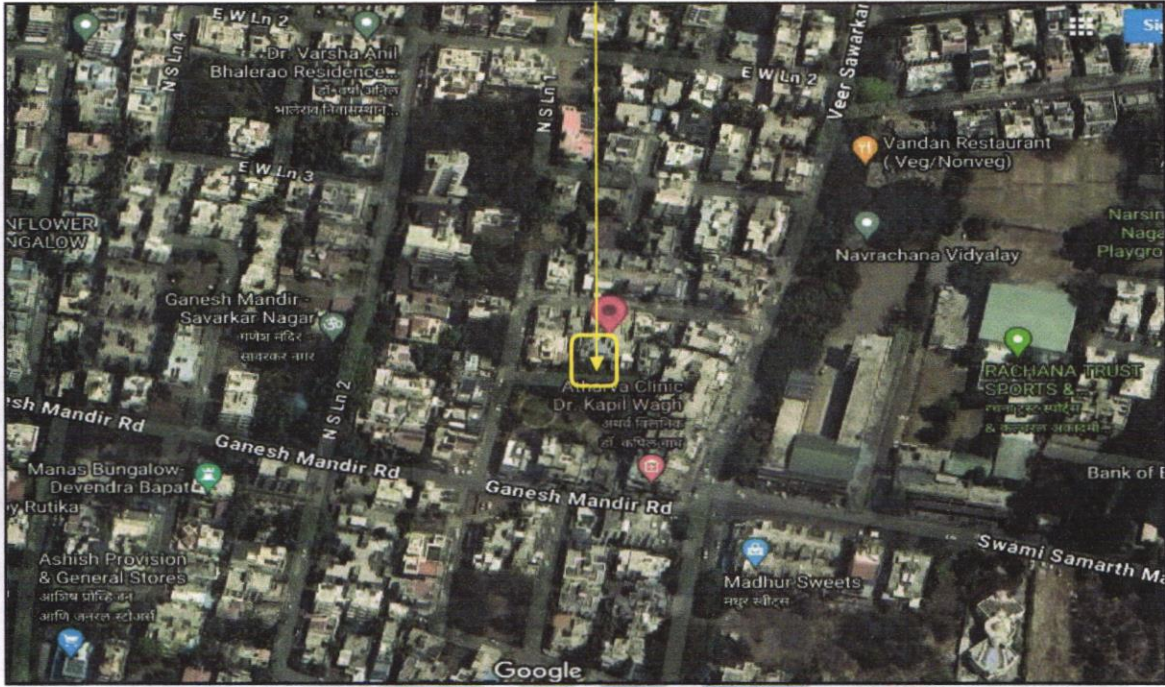

**Longitude Latitude: 20°00'56.7"N 73°45'13.0"E**

**Note: The Blue line shows the route to site from nearest railway Station (Nashik Road- 15.0 Km.)**



Since 1989

**Vastukala Consultants (I) Pvt. Ltd.**

An ISO 9001 : 2015 Certified Company



## Ready Reckoner Rate



Department of Registration and Stamp  
Government of Maharashtra

नोंदणी व मुद्रांक विभाग  
महाराष्ट्र शासन



### Annual Statement of Rates Ver. 2.0 ( बाजारमूल्य दर पत्रक आवृत्ती 2.0 )

[Home](#)
[Valuation Guidelines | User Manual](#)

Year  Language

Selected District

Select Taluka

Select Village

Search By  Survey No.  SubZones

Enter Survey No

उपविभाग	खुली जमीन	निवासी सदनिका	ऑफिस दुकाने	औद्योगिक	एकक (Rs./)	Attribute
5.2-मंगापूर रस्त्यापासुन उत्तरेकडे जाणारा ( आसाराम बापु आश्रमाकडे ) रस्ता.	34000	51500	59220 68100	0	चौ. मीटर	सर्वेक्षण नंबर



## Price Indicators

Home / Nashik / Anandwadi Gaon / Revati Bliss Last updated: Jan 31, 2024

**Revati Bliss** ✓ RERA

By REVATI GROUP **₹34.32 L - 58.35 L** | ₹6.34 K/sq.ft  
EMI starts at ₹18.17 K

Shreerang Nagar, Nashik Price excludes maintenance, floor rise c... [See More](#)

[Become the first to Rate](#) [Contact Seller](#)

**2, 3 BHK Apartments**  
Configurations

**Dec, 2020**  
Possession Starts

**₹6.34 K/sq.ft**  
Avg. Price

**541 sq.ft. - 920 sq.ft.**  
(Carpet Area)  
Sizes

Home / Property in Nashik / Flats in Nashik / Flats in Anandwadi / 3BHK, 2Baths in Anandwadi Posted on Jun 06, 2024 | Ready to move

**₹85 Lac** @ 8,673 per sq.ft. **3BHK 2Baths**

Estimated EMI ₹ 67,890 Flat/Apartment for Sale

in Liberty, Anandwadi, Nashik, Maharashtra [View Details](#)

**RERA STATUS** ● NOT AVAILABLE | Website: <https://maharera.in/maharera.gov.in/>

[Overview](#) [Owner Details](#) [Price Trends](#) [Registry Record](#) [Explore Locality](#) [Recomm](#)

**Area**  
Built Up area: 1400 sq.ft.  
Carpet area: 980 sq.ft.

**Price**  
₹ 85 Lac+ Govt Charges & Tax  
₹ 8,673 per sq.ft. (All inclusive, Negotiable)

**Floor Number**  
5<sup>th</sup> of 7 Floors

**Overlooking**  
Park/Garden, Main Road

**Configuration**  
3 Bedrooms, 2 Bathrooms, 2 Balconies with Study Room, Others

**Address**  
Glory  
Anandwadi, Nashik

**Facing**  
North East

**Property Age**  
1 to 5 Year Old

**Why should you consider this property?**

- North-East Facing
- Close to School
- Close to Market
- Recently Renovated
- 24/7 Water
- Air-Conditioned
- Gated Society
- Overlooking Park/Garden
- Overlooking Main Road
- Vastu Shastra Compliant
- Natural Light
- Ally Rooms
- Spacious Interiors
- Low density Society



Since 1989

**Vastukala Consultants (I) Pvt. Ltd.**

An ISO 9001 : 2015 Certified Company



## Price Indicators

magicbricks
Buy ▾
Rent ▾
Sell ▾
Home Loans ▾

Home » Property for Sale in Nashik » Flats for Sale in Nashik » Flats for Sale in Anandvalli » 3 BHK Flats for Sale in Anandvalli » 1290 Sq-Ft

67.4 Lac

How much loan can I get?

⋮

3 BHK 1290 Sq-ft Flat For Sale **Anandvalli, Nashik**

🛏 3 Beds
🛁 2 Baths
🚗 1 Covered Parking
🏠 Unfurnished

Super Built-Up Area 1290 sqft = 5.222/sqft	Developer <b>Revati Group</b>	Project <b>Revati Anandvan</b>
Transaction Type <b>New Property</b>	Status <b>Under Construction</b>	Lifts <b>2</b>
Furnished Status <b>Unfurnished</b>	Car Parking <b>1 Covered</b>	

Contact Builder

Book Site Visit

👤 Last contact made 4 days ago

HOUSING.COM
Buy in Nashik ▾

Anandvalli Gauri ▾ + Add

Download App
List Property Free
Saved

Home / Nashik / Anandvalli Gauri / Riviera Tower

Riviera Tower

₹75.08 L - 1.65 Cr

5.50 K/sq.ft  
EMI starts at 37.27 K

By SHINDE AND SHINDE  
Near Nawashya Ganpati Temple, Gangapur Road, Nashik

Last updated: Apr 21, 2023
See More

Contact Developer

Project Images

2, 4 BHK Apartments Configurations
Aug. 2024 Possession Starts
5.50 K/sq.ft Avg. Price

Project Images

+ 22 more

Project Images

1365.00 sq.ft. - 2866.00 sq... (Super Builtup Area) Sizes



Since 1989

**Vastukala Consultants (I) Pvt. Ltd.**

An ISO 9001 : 2015 Certified Company



As a result of my appraisal and analysis, it is my considered opinion that of the above property in the prevailing condition with aforesaid specifications is ₹ **36,97,380.00 (Rupees Thirty-Six Lakh Ninety-Seven Thousand Three Hundred Eighty Only)**.

Place: Nashik

Date: 13.06.2024

For **VASTUKALA CONSULTANTS (I) PVT. LTD.**

**Manoj  
Chalikwar**

Digitally signed by Manoj Chalikwar  
DN: cn=Manoj Chalikwar, o=Vastukala  
Consultants (I) Pvt. Ltd., ou=Mumbai,  
email=manoj@vastukala.org, c=IN  
Date: 2024.06.14 13:02:40 +05'30'

  
Auth. Sign.

**Director**

**Manoj B. Chalikwar**

Registered Valuer

Chartered Engineer (India)

Reg. No. CAT-I-F-1763

SBI Empanelment No.: SME/TCC/2021-22/86/3

The undersigned has inspected the property detailed in the Valuation Report dated \_\_\_\_\_

on \_\_\_\_\_. We are satisfied that the fair and reasonable market value of the property is  
₹ \_\_\_\_\_ (Rupees \_\_\_\_\_

\_\_\_\_\_ only).

Date

Signature  
(Name & Designation of the Inspecting Official/s)

Countersigned  
(BRANCH MANAGER)

Enclosures		
	Declaration-cum-undertaking from the valuer (Annexure – I)	Attached
	Model code of conduct for valuer (Annexure – II)	Attached



Since 1989

**Vastukala Consultants (I) Pvt. Ltd.**

An ISO 9001 : 2015 Certified Company





(Annexure – I)

**DECLARATION-CUM-UNDERTAKING**

I, Manoj B. Chalikwar son of Shri. Baburao Chalikwar do hereby solemnly affirm and state that:

- a. I am a citizen of India.
- b. I will not undertake valuation of any assets in which I have a direct or indirect interest or become so interested at any time during a period of three years prior to my appointment as valuer or three years after the valuation of assets was conducted by me.
- c. The information furnished in my valuation report dated 13.06.2024 is true and correct to the best of my knowledge and belief and I have made an impartial and true valuation of the property.
- d. I/ my authorized representative has personally inspected the property on 13.06.2024. The work is not sub - contracted to any other valuer and carried out by myself.
- e. Valuation report is submitted in the format as prescribed by the bank.
- f. I have not been depanelled / delisted by any other bank and in case any such depanelment by other banks during my empanelment with you, I will inform you within 3 days of such depanelment.
- g. I have not been removed / dismissed from service / employment earlier.
- h. I have not been convicted of any offence and sentenced to a term of imprisonment
- i. I have not been found guilty of misconduct in my professional capacity.
- j. I have not been declared to be unsound mind
- k. I am not an undischarged bankrupt, or has not applied to be adjudicated as a bankrupt;
- l. I am not an undischarged insolvent.
- m. I have not been levied a penalty under section 271J of Income-tax Act, 1961 (43 of 1961) and time limit for filing appeal before Commissioner of Income-tax (Appeals) or Income-tax Appellate Tribunal, as the case may be has expired, or such penalty has been confirmed by Income-tax Appellate Tribunal, and five years have not elapsed after levy of such penalty
- n. I have not been convicted of an offence connected with any proceeding under the



Since 1989

**Vastukala Consultants (I) Pvt. Ltd.**

An ISO 9001 : 2015 Certified Company



- o. My PAN Card number as applicable is AYLPM0851A
- p. I undertake to keep you informed of any events or happenings which would make me ineligible for empanelment as a valuer
- q. I have not concealed or suppressed any material information, facts and records and I have made a complete and full disclosure
- r. I have read the Handbook on Policy, Standards and procedure for Real Estate Valuation, 2011 of the IBA and this report is in conformity to the "Standards" enshrined for valuation in the Part - B of the above handbook to the best of my ability.
- s. I have read the International Valuation Standards (IVS) and the report submitted to the Bank for the respective asset class is in conformity to the "Standards" as enshrined for valuation in the IVS in "General Standards" and "Asset Standards" as applicable. The valuation report is submitted in the prescribed format of the bank.
- t. I abide by the Model Code of Conduct for empanelment of valuer in the Bank. (Annexure V - A signed copy of same to be taken and kept along with this declaration)
- u. I am valuer registered with Insolvency & Bankruptcy Board of India (IBBI)
- v. My CIBIL Score and credit worthiness is as per Bank's guidelines.
- w. I am the Director of the company, who is competent to sign this valuation report.
- x. I will undertake the valuation work on receipt of Letter of Engagement generated from the system (i.e. LLMS / LOS) only.
- y. Further, I hereby provide the following information.



Since 1989

**Vastukala Consultants (I) Pvt. Ltd.**

An ISO 9001 : 2015 Certified Company



Sr. No.	Particulars	Valuer comment
1.	background information of the asset being valued;	The property under consideration is purchased by. Shri. Dadasaheb Kashinath Jagdhane & Sau. Anita Dadasaheb Jagdhane & from Shri. Santosh Shankarrao Deshmukh Deed of Apartment Vide No. 3076/ 2016 Dated.11.04.2016.
2.	purpose of valuation and appointing authority	As per the request from State Bank of India, RACPC Nashik Branch to assess fair market value of the property for SARFAESI Securitisation and Reconstruction of Financial Assets and Enforcement of Security Interest Act, 2002 purpose
3.	identity of the valuer and any other experts involved in the valuation;	Manoj B. Chalikwar – Regd. Valuer Sanjay R.Phadol– Reginal Technical Manager Sachin Raundal – Valuation Engineer Binu Surendran – Technical Manager Rishidatt Yadav – Technical Officer
4.	disclosure of valuer interest or conflict, if any;	We have no interest, either direct or indirect, in the property valued. Further to state that we do not have relation or any connection with property owner / applicant directly or indirectly. Further to state that we are an independent Valuer and in no way related to property owner / applicant
5.	date of appointment, valuation date and date of report;	Date of Appointment – 13.06.2024 Valuation Date – 13.06.2024 Date of Report – 14.06.2024
6.	inspections and/or investigations undertaken;	Physical Inspection done on 13.06.2024
7.	nature and sources of the information used or relied upon;	<ul style="list-style-type: none"> <li>• Market Survey at the time of site visit</li> <li>• Ready Reckoner rates / Circle rates</li> <li>• Online Price Indicators on real estate portals</li> <li>• Enquiries with Real estate consultants</li> <li>• Existing data of Valuation assignments carried out by us</li> </ul>
8.	Procedures adopted in carrying out the valuation and valuation standards followed;	Sales Comparison Method
9.	restrictions on use of the report, if any;	This valuation is for the use of the party to whom it is addressed and for no other purpose. No responsibility is accepted to any third party who may use or rely on the whole or any part of this valuation. The valuer has no pecuniary interest that would conflict with the proper valuation of the property.
10.	Major factors that were taken into account during the valuation;	current market conditions, demand and supply position, Residential Flat size, location, upswing in real estate prices, sustained demand for Residential Flat, all round development of commercial and Commercial application in the locality etc.

11.	Major factors that were not taken into account during the valuation;	Nil
12.	Caveats, limitations and disclaimers to the extent they explain or elucidate the limitations faced by valuer, which shall not be for the purpose of limiting his responsibility for the valuation report.	Attached

## **Assumptions, Disclaimers, Limitations & Qualifications**

### **Value Subject to Change**

The subject appraisal exercise is based on prevailing market dynamics as on **14<sup>th</sup> June 2024** and does not take into account any unforeseeable developments which could impact the same in the future.

### **Our Investigations**

We are not engaged to carry out all possible investigations in relation to the subject property. Where in our report we identify certain limitations to our investigations, this is to enable the reliant party to instruct further investigations where considered appropriate or where we recommend as necessary prior to reliance. Vastukala Consultants India Pvt. Ltd. (VCIPL) is not liable for any loss occasioned by a decision not to conduct further investigations

### **Assumptions**

Assumptions are a necessary part of undertaking valuations. VCIPL adopts assumptions for the purpose of providing valuation advice because some matters are not capable of accurate calculations or fall outside the scope of our expertise, or out instructions. The reliant party accepts that the valuation contains certain specific assumptions and acknowledge and accept the risk of that if any of the assumptions adopted in the valuation are incorrect, then this may have an effect on the valuation.

### **Information Supplied by Others**

The appraisal is based on the information provided by the client. The same has been assumed to be correct and has been used for appraisal exercise. Where it is stated in the report that another party has supplied information to VCIPL, this information is believed to be reliable but VCIPL can accept no responsibility if this should prove not to be so.

### **Future Matters**

To the extent that the valuation includes any statement as to a future matter, that statement is provided as an estimate and/or opinion based on the information known to VCIPL at the date of this document. VCIPL does not warrant that such statements are accurate or correct.

### **Map and Plans**

Any sketch, plan or map in this report is included to assist the reader while visualising the property and assume no responsibility in connection with such matters.

### **Site Details**



Since 1989

**Vastukala Consultants (I) Pvt. Ltd.**

An ISO 9001 : 2015 Certified Company



Based on inputs received from Client's representative and site visit conducted, we understand that the subject property is Residential Flat, admeasuring area **Built Up in Sq. Ft. = 738.00** Owned by Name of Owner: **Shri. Dadasaheb Kashinath Jagdhane &Sau. Anita Dadasaheb Jagdhane**. Further, VCIPL has assumed that the subject property is free from any encroachment and is available as on the date of the appraisal.

### Property Title

Based on our discussion with the Client, we understand that the subject property is owned Name of Owner: **Shri. Dadasaheb Kashinath Jagdhane &Sau. Anita Dadasaheb Jagdhane**. For the purpose of this appraisal exercise, we have assumed that the subject property has a clear title and is free from any encumbrances, disputes and claims. VCIPL has made no further enquiries with the relevant local authorities in this regard and does not certify the property as having a clear and marketable title. Further, no legal advice regarding the title and ownership of the subject property has been obtained for the purpose of this appraisal exercise. It has been assumed that the title deeds are clear and marketable.

### Environmental Conditions

We have assumed that the subject property is not contaminated and is not adversely affected by any existing or proposed environmental law and any processes which are carried out on the property are regulated by environmental legislation and are properly licensed by the appropriate authorities.

### Area

Based on the information provided by the Client's representative, we understand that the Residential Flat, admeasuring area **Built Up in Sq. Ft. = 738.00**

### Condition & Repair

In the absence of any information to the contrary, we have assumed that there are no abnormal ground conditions, nor archaeological remains present which might adversely affect the current or future occupation, development or value of the property. The property is free from rat, infestation, structural or latent defect. No currently known deleterious or hazardous materials or suspect techniques will be used in the construction of or subsequent alteration or additions to the property and comments made in the property details do not purport to express an opinion about, or advise upon, the condition of uninspected parts and should not be taken as making an implied representation or statement about such parts

### Valuation Methodology

For the purpose of this valuation exercise, the valuation methodology used is Direct Comparison Approach Method and proposed Current use / Exiting use premise is considered for this assignment.

The Direct Comparison Approach involves a comparison of the property being valued to similar properties that have actually been sold in arms - length transactions or are offered for sale. This approach demonstrates what buyers have historically been willing to pay (and sellers willing to accept) for similar properties in an open and competitive market and is particularly useful in estimating the value of the Flat and properties that are typically traded on a unit basis.

In case of inadequate recent transaction activity in the subject micro-market, the appraiser would collate details of older transactions. Subsequently, the appraiser would analyse rental / capital value trends in the



Since 1989

**Vastukala Consultants (I) Pvt. Ltd.**

An ISO 9001 : 2015 Certified Company



Valuation Report / SBI / RACPC Nashik Branch/ Shri. Dadasaheb Kashinath Jagdhane & Others (009280/2306736) Page 22 of 25  
subject micro-market in order to calculate the percentage increase / decrease in values since the date of the identified transactions. This percentage would then be adopted to project the current value of the same.

Where reliance has been placed upon external sources of information in applying the valuation methodologies, unless otherwise specifically instructed by Client and/or stated in the valuation, VCIPL has not independently verified that information and VCIPL does not advise nor accept it as reliable. The person or entity to whom the report is addressed acknowledges and accepts the risk that if any of the unverified information in the valuation is incorrect, then this may have an effect on the valuation.

### **Not a Structural Survey**

We state that this is a valuation report and not a structural survey

### **Other**

All measurements, areas and ages quoted in our report are approximate

### **Legal**

We have not made any allowances with respect to any existing or proposed local legislation relating to taxation on realization of the sale value of the subject property. VCIPL is not required to give testimony or to appear in court by reason of this appraisal report, with reference to the property in question, unless arrangement has been made thereof. Further, no legal advice on any aspects has been obtained for the purpose of this appraisal exercise

### **Property specific assumptions**

Based on inputs received from the client and site visit conducted, we understand that the subject property is Residential Flat, admeasuring area **Built Up in Sq. Ft. = 738.00**

### **ASSUMPTIONS, CAVEATS, LIMITATION AND DISCLAIMERS**

1. We assume no responsibility for matters of legal nature affecting the property appraised or the title thereto, nor do we render our opinion as to the title, which is assumed to be Average and marketable.
2. The property is valued as though under responsible ownership.
3. It is assumed that the property is free of liens and encumbrances.
4. It is assumed that there are no hidden or unapparent conditions of the subsoil or structure that would render it more or less valuable. No responsibility is assumed for such conditions or for engineering that might be required to discover such factors.
5. There is no direct/ indirect interest in the property valued.
6. The rates for valuation of the property are in accordance with the Govt. approved rates and prevailing market rates.



Since 1989

**Vastukala Consultants (I) Pvt. Ltd.**

An ISO 9001 : 2015 Certified Company



## MODEL CODE OF CONDUCT FOR VALUERS

### Integrity and Fairness

1. A valuer shall, in the conduct of his/its business, follow high standards of integrity and fairness in all his/its dealings with his/its clients and other valuers.
2. A valuer shall maintain integrity by being honest, straightforward, and forthright in all professional relationships.
3. A valuer shall endeavour to ensure that he/it provides true and adequate information and shall not misrepresent any facts or situations.
4. A valuer shall refrain from being involved in any action that would bring disrepute to the profession.
5. A valuer shall keep public interest foremost while delivering his services.

### Professional Competence and Due Care

6. A valuer shall render at all times high standards of service, exercise due diligence, ensure proper care and exercise independent professional judgment.
7. A valuer shall carry out professional services in accordance with the relevant technical and professional standards that may be specified from time to time.
8. A valuer shall continuously maintain professional knowledge and skill to provide competent professional service based on up-to-date developments in practice, prevailing regulations / guidelines and techniques.
9. In the preparation of a valuation report, the valuer shall not disclaim liability for his/its expertise or deny his/its duty of care, except to the extent that the assumptions are based on statements of fact provided by the company or its auditors or consultants or information available in public domain and not generated by the valuer.
10. A valuer shall not carry out any instruction of the client insofar as they are incompatible with the requirements of integrity, objectivity and independence.
11. A valuer shall clearly state to his client the services that he would be competent to provide and the services for which he would be relying on other valuers or professionals or for which the client can have a separate arrangement with other valuers.

### Independence and Disclosure of Interest

12. A valuer shall act with objectivity in his/its professional dealings by ensuring that his/its decisions are made without the presence of any bias, conflict of interest, coercion, or undue influence of any party, whether directly connected to the valuation assignment or not.
13. A valuer shall not take up an assignment if he/it or any of his/its relatives or associates is not independent in terms of association to the company.
14. A valuer shall maintain complete independence in his/its professional relationships and shall conduct the valuation independent of external influences.



Since 1989

Vastukala Consultants (I) Pvt. Ltd.

An ISO 9001 : 2015 Certified Company



15. A valuer shall wherever necessary disclose to the clients, possible sources of conflicts of duties and interests, while providing unbiased services.
16. A valuer shall not deal in securities of any subject company after any time when he/it first becomes aware of the possibility of his / its association with the valuation, and in accordance with the Securities and Exchange Board of India (Prohibition of Insider Trading) Regulations, 2015 or till the time the valuation report becomes public, whichever is earlier.
17. A valuer shall not indulge in "mandate snatching" or offering "convenience valuations" in order to cater to a company or client's needs.
18. As an independent valuer, the valuer shall not charge success fee.
19. In any fairness opinion or independent expert opinion submitted by a valuer, if there has been a prior engagement in an unconnected transaction, the valuer shall declare the association with the company during the last five years.

### Confidentiality

20. A valuer shall not use or divulge to other clients or any other party any confidential information about the subject company, which has come to his / its knowledge without proper and specific authority or unless there is a legal or professional right or duty to disclose.

### Information Management

21. A valuer shall ensure that he/ it maintains written contemporaneous records for any decision taken, the reasons for taking the decision, and the information and evidence in support of such decision. This shall be maintained so as to sufficiently enable a reasonable person to take a view on the appropriateness of his /its decisions and actions.
22. A valuer shall appear, co-operate and be available for inspections and investigations carried out by the authority, any person authorised by the authority, the registered valuers organisation with which he/it is registered or any other statutory regulatory body.
23. A valuer shall provide all information and records as may be required by the authority, the Tribunal, Appellate Tribunal, the registered valuers organisation with which he/it is registered, or any other statutory regulatory body.
24. A valuer while respecting the confidentiality of information acquired during the course of performing professional services, shall maintain proper working papers for a period of three years or such longer period as required in its contract for a specific valuation, for production before a regulatory authority or for a peer review. In the event of a pending case before the Tribunal or Appellate Tribunal, the record shall be maintained till the disposal of the case.

### Gifts and hospitality:

25. A valuer or his / its relative shall not accept gifts or hospitality which undermines or affects his independence as a valuer.

Explanation: For the purposes of this code the term 'relative' shall have the same meaning as defined in clause (77) of Section 2 of the Companies Act, 2013 (18 of 2013).

26. A valuer shall not offer gifts or hospitality or a financial or any other advantage to a public servant or any other person with a view to obtain or retain work for himself / itself, or to obtain or retain an advantage in the conduct of profession for himself / itself.



Since 1989

**Vastukala Consultants (I) Pvt. Ltd.**

An ISO 9001 : 2015 Certified Company





## Remuneration and Costs.

27. A valuer shall provide services for remuneration which is charged in a transparent manner, is a reasonable reflection of the work necessarily and properly undertaken, and is not inconsistent with the applicable rules.
28. A valuer shall not accept any fees or charges other than those which are disclosed in a written contract with the person to whom he would be rendering service.

## Occupation, employability and restrictions.

29. A valuer shall refrain from accepting too many assignments, if he/it is unlikely to be able to devote adequate time to each of his/ its assignments.
30. A valuer shall not conduct business which in the opinion of the authority or the registered valuer organisation discredits the profession.

## Miscellaneous

31. A valuer shall refrain from undertaking to review the work of another valuer of the same client except under written orders from the bank or housing finance institutions and with knowledge of the concerned valuer.
32. A valuer shall follow this code as amended or revised from time to time.

For VASTUKALA CONSULTANTS (I) PVT. LTD.

**Manoj  
Chalikwar**  
Director

Digitally signed by Manoj Chalikwar  
DN: cn=Manoj Chalikwar, o=Vastukala  
Consultants (I) Pvt. Ltd., ou=Mumbai,  
email=manoj@vastukala.org, c=IN  
Date: 2024.06.14 13:02:22 +05'30'

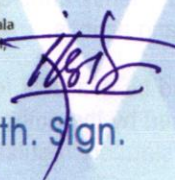
  
Auth. Sign.

**Manoj B. Chalikwar**

Registered Valuer  
Chartered Engineer (India)  
Reg. No. CAT-I-F-1763  
SBI Empanelment No.: SME/TCC/2021-22/86/3



Since 1989

**Vastukala Consultants (I) Pvt. Ltd.**

An ISO 9001 : 2015 Certified Company

