

PLOT AREA CALCULATION FOR CTS NOS 433A, 433B, 433C, 433A, 433B, 433C, 433D, 433E, 433F AND 433G. AMALGAMATION OF THE CTS NOS IN SUB PLOTS MARKED AS SUBPLOT 'A' TO 'E'

Table with columns: SUB PLOT 'A', CTS NOS, AREA (sq. mts), and SALE PRICE. Includes sub-headers for 'SUB PLOT 'A' (EXISTING ROAD)' and 'SUB PLOT 'A' (PROPOSED D.P. ROAD)'.

TOTAL PLOT AREA UNDER SLUM LAND (A+B+C+D+E) 1354.40

Table for SUB PLOT 'B' (EXISTING ROAD) and SUB PLOT 'C' (PROPOSED D.P. ROAD) with columns for CTS NOS, AREA, and SALE PRICE.

TOTAL PLOT AREA UNDER SLUM LAND (B+C) 419.20

Table for SUB PLOT 'D' (NON-BUILDABLE) and SUB PLOT 'E' (NON-BUILDABLE) with columns for CTS NOS, AREA, and SALE PRICE.

TOTAL PLOT AREA UNDER SLUM LAND (D+E) 685.80

PLOT AREA CALCULATION FOR CTS NOS 433A, 433B, 433C, 433A, 433B, 433C, 433D, 433E, 433F AND 433G. AMALGAMATION OF THE CTS NOS IN SUB PLOTS MARKED AS SUBPLOT 'A' TO 'E'

Table with columns: SUB PLOT 'A', CTS NOS, AREA (sq. mts), and SALE PRICE. Includes sub-headers for 'SUB PLOT 'A' (EXISTING ROAD)' and 'SUB PLOT 'A' (PROPOSED D.P. ROAD)'.

TOTAL PLOT AREA UNDER SLUM LAND (A+B+C+D+E) 1354.40

Table for SUB PLOT 'B' (EXISTING ROAD) and SUB PLOT 'C' (PROPOSED D.P. ROAD) with columns for CTS NOS, AREA, and SALE PRICE.

TOTAL PLOT AREA UNDER SLUM LAND (B+C) 419.20

Table for SUB PLOT 'D' (NON-BUILDABLE) and SUB PLOT 'E' (NON-BUILDABLE) with columns for CTS NOS, AREA, and SALE PRICE.

TOTAL PLOT AREA UNDER SLUM LAND (D+E) 685.80

PLOT AREA CALCULATION FOR CTS NOS 433A, 433B, 433C, 433A, 433B, 433C, 433D, 433E, 433F AND 433G. AMALGAMATION OF THE CTS NOS IN SUB PLOTS MARKED AS SUBPLOT 'A' TO 'E'

Table with columns: SUB PLOT 'A', CTS NOS, AREA (sq. mts), and SALE PRICE. Includes sub-headers for 'SUB PLOT 'A' (EXISTING ROAD)' and 'SUB PLOT 'A' (PROPOSED D.P. ROAD)'.

TOTAL PLOT AREA UNDER SLUM LAND (A+B+C+D+E) 1354.40

Table for SUB PLOT 'B' (EXISTING ROAD) and SUB PLOT 'C' (PROPOSED D.P. ROAD) with columns for CTS NOS, AREA, and SALE PRICE.

TOTAL PLOT AREA UNDER SLUM LAND (B+C) 419.20

Table for SUB PLOT 'D' (NON-BUILDABLE) and SUB PLOT 'E' (NON-BUILDABLE) with columns for CTS NOS, AREA, and SALE PRICE.

TOTAL PLOT AREA UNDER SLUM LAND (D+E) 685.80

PLOT AREA CALCULATION FOR CTS NOS 433A, 433B, 433C, 433A, 433B, 433C, 433D, 433E, 433F AND 433G. AMALGAMATION OF THE CTS NOS IN SUB PLOTS MARKED AS SUBPLOT 'A' TO 'E'

Table with columns: SUB PLOT 'A', CTS NOS, AREA (sq. mts), and SALE PRICE. Includes sub-headers for 'SUB PLOT 'A' (EXISTING ROAD)' and 'SUB PLOT 'A' (PROPOSED D.P. ROAD)'.

TOTAL PLOT AREA UNDER SLUM LAND (A+B+C+D+E) 1354.40

Table for SUB PLOT 'B' (EXISTING ROAD) and SUB PLOT 'C' (PROPOSED D.P. ROAD) with columns for CTS NOS, AREA, and SALE PRICE.

TOTAL PLOT AREA UNDER SLUM LAND (B+C) 419.20

Table for SUB PLOT 'D' (NON-BUILDABLE) and SUB PLOT 'E' (NON-BUILDABLE) with columns for CTS NOS, AREA, and SALE PRICE.

TOTAL PLOT AREA UNDER SLUM LAND (D+E) 685.80

PLOT AREA CALCULATION FOR CTS NOS 433A, 433B, 433C, 433A, 433B, 433C, 433D, 433E, 433F AND 433G. AMALGAMATION OF THE CTS NOS IN SUB PLOTS MARKED AS SUBPLOT 'A' TO 'E'

Table with columns: SUB PLOT 'A', CTS NOS, AREA (sq. mts), and SALE PRICE. Includes sub-headers for 'SUB PLOT 'A' (EXISTING ROAD)' and 'SUB PLOT 'A' (PROPOSED D.P. ROAD)'.

TOTAL PLOT AREA UNDER SLUM LAND (A+B+C+D+E) 1354.40

Table for SUB PLOT 'B' (EXISTING ROAD) and SUB PLOT 'C' (PROPOSED D.P. ROAD) with columns for CTS NOS, AREA, and SALE PRICE.

TOTAL PLOT AREA UNDER SLUM LAND (B+C) 419.20

Table for SUB PLOT 'D' (NON-BUILDABLE) and SUB PLOT 'E' (NON-BUILDABLE) with columns for CTS NOS, AREA, and SALE PRICE.

TOTAL PLOT AREA UNDER SLUM LAND (D+E) 685.80

BUILT UP AREA STATEMENT AND TENEMENTS PROPOSED FOR THE SCHEME

Table with columns: BLDG NO, REHAB COMPOSITE, REHAB BUA, FURNISHABLE FOR REHAB, FURNISHABLE FOR SALE, NET SALE BUA, TOTAL BUA, REHAB COMPOSITE, SALE OCCUR, REHAB REGR, PAF 3/F, PAF 1/F, BAL, W.C, SO OFF, SALE RESH, A.R. RETAIL MARKET, TOTAL.

PLOT AREA SUMMARY AND AMALGAMATION OF THE SUB-DIVIDED PLOTS

Table with columns: AMALGAMATED SUB-PLOT, PLOT AREA, PROPOSED BUILDING, PROPOSED BUA AT THIS SATAGE, PROPOSED BUA TOTAL IN THE SUB-PLOT, SETBACK/OP. ROAD ADVANTAGE CLAIMED, NO. ADDITIONAL FSI CLAIMED BY PAYING PREMIUM, TOR CLAIMED, FSI CONSUMED IN SUB PLOT (F=5/2).

PLOT AREA SUMMARY AND AMALGAMATION OF THE SUB-DIVIDED PLOTS

Table with columns: SUB PLOT, PLOT A, PLOT B, PLOT C, PLOT D, PLOT E, TOTAL AREA IN SQ.MTS.

TOTAL PLOT AREA FOR CTS NOS 433A, 433B, 433C, 433A, 433B, 433C, 433D, 433E, 433F AND 433G. AMALGAMATION OF THE CTS NOS IN SUB PLOTS MARKED AS SUBPLOT 'A' TO 'E'

PLOT AREA SUMMARY

Table with columns: SR. NO., CTS NOS, USER, AREA IN SQ.MTS.

TOTAL PLOT AREA 5391.40

PHYSICAL A.O.S. - 1

Table with columns: PHYSICAL A.O.S. - 1, PHYSICAL A.O.S. - 2, PHYSICAL A.O.S. - 3, PHYSICAL A.O.S. - 4, PHYSICAL A.O.S. - 5.

TOTAL PHYSICAL A.O.S. - 1 265.88

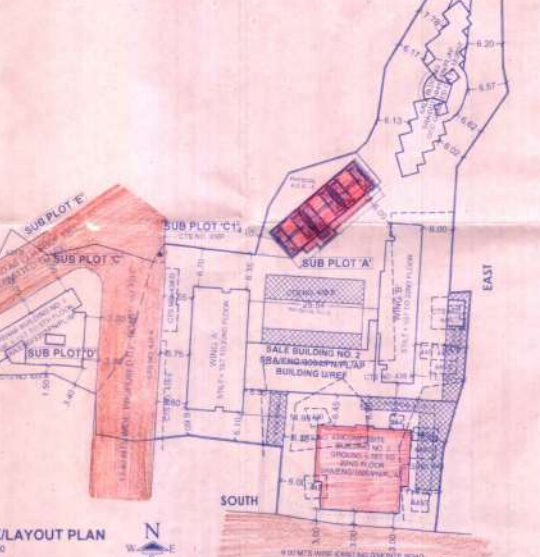
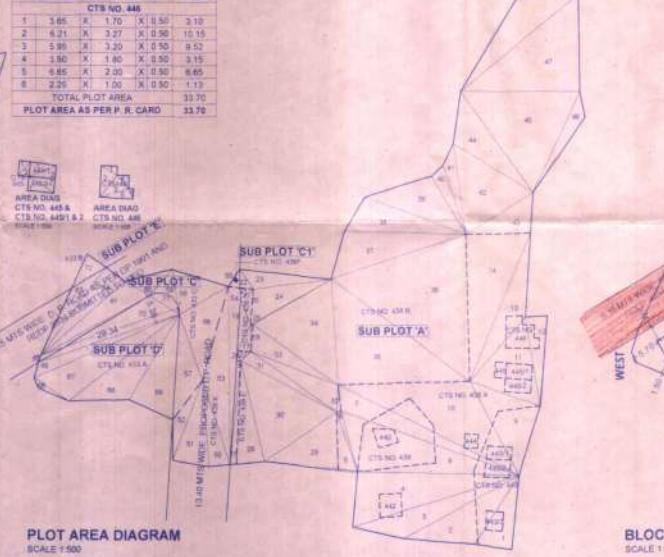
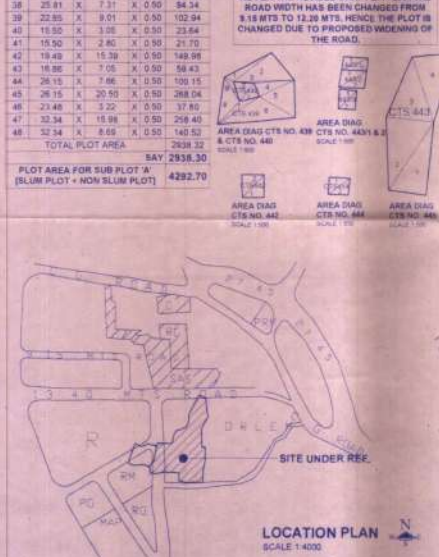

PROFORMA 'A'

Table with columns: AREA STATEMENT, REG. TOTAL, REG. 22, TOTAL.

PROFORMA - B

Table with columns: DESCRIPTION OF PROPERTY, PROPOSED LAYOUT FOR B, R. SCHEME, INDEX REGULATION, BEARING, DISTANCE, etc.

DESCRIPTION OF PROPERTY. PROPOSED LAYOUT FOR B, R. SCHEME (COMPOSITE BUILDING NO. 2) UNDER REGULATION 330(B) REGULATION 33 OF DCMR 2004. PLOT BEARING CTS NOS 433A, 433B, 433C, 433A, 433B, 433C, 433D, 433E, 433F AND 433G.

CERTIFICATE OF AREA. CERTIFIED THAT THE PLOT UNDER REFERENCE WAS SURVEYED BY ME ON 22/01/2007. THE DIMENSIONS OF SIDES ETC. STATED ON PLAN ARE AS MEASURED ON SITE AND THE AREA SO MEASURED IS 5391.40 SQ.MTS. IT TALLIES WITH THE AREA STATED IN PROPERTY REGISTERED CARD.

NAME & ADDRESS OF OWNER/DEVELOPER. SIGN OF OWNER DEVELOPER. SIGNATURE OF ARCHITECT. SIGN OF OWNER DEVELOPER.

NAME & SIGNATURE OF ARCHITECT. SANJAY NEVE & ASSOCIATES. 302, COMKARESHWAR, LINKING ROAD, KANDARPADA, DAHISAR (WEST), MUMBAI.

PHONE: 28803656, 9821022966. EMAIL: arch.neve@gmail.com