

6.0 M SET BACK

"SUNDARVAN NINES"

FOR : F ND H CONSTRUCTION LLP
PROPOSED "RESIDENTIAL & COMMERCIAL BUILDING"
LOCATION : F.P.-118 A, MUNJE, AT PEN, DIST. RAIGAD.

SHEET - 06 of 14
DATE - 31.05.2024

TENTITIVE CONSTRUCTION AREA

9.080 M SET BACK

6.0 M SET BACK

9.080 M SET BACK

3.5 M SET BACK

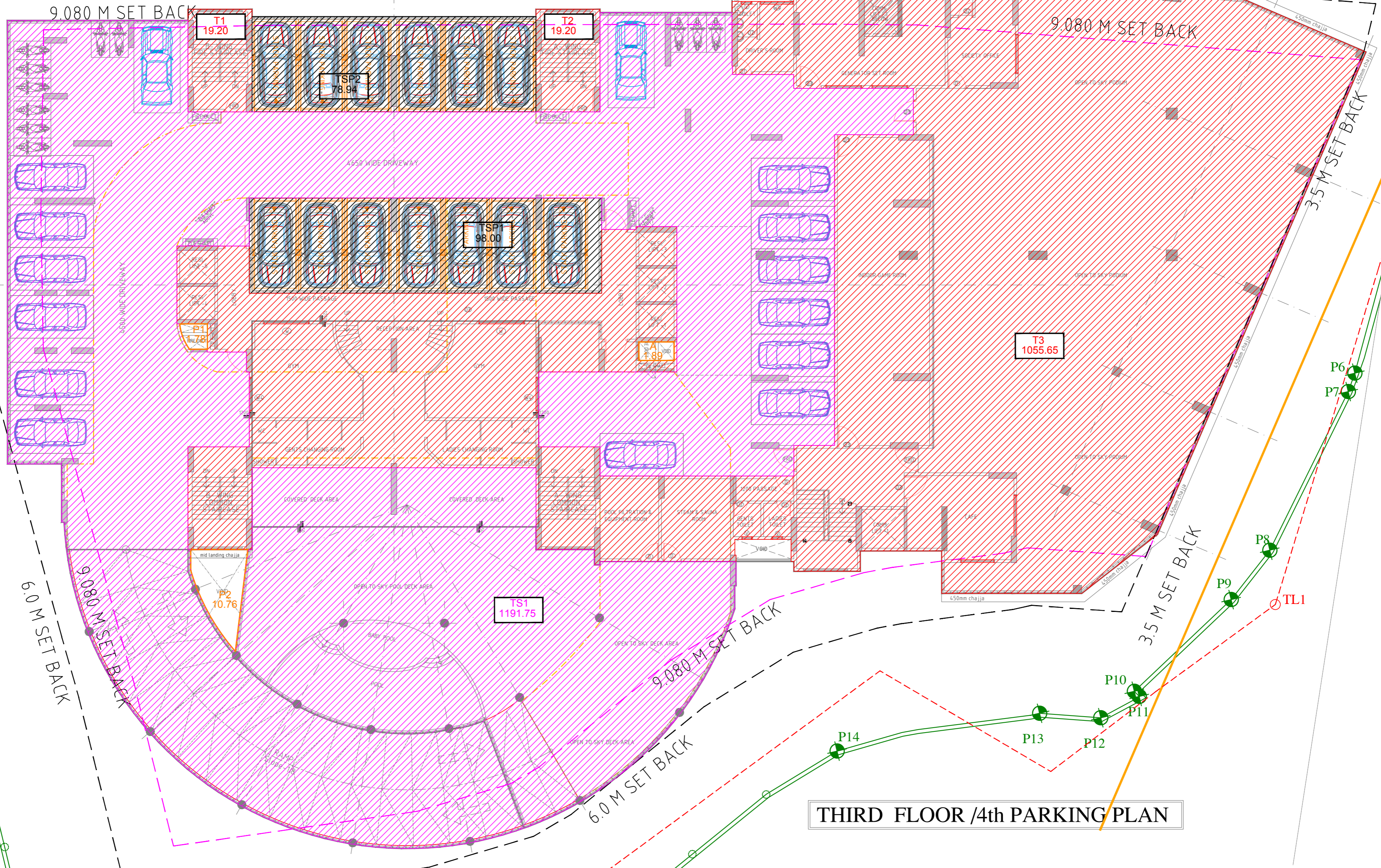

THIRD FLOOR /4th PARKING PLAN

SPACE FOR TRANSFORMER
5M X 5M

	CONSTRUCTION AREA OF THIRD FLOOR (T1+T2+T3-A) = $\{(19.20+19.20+1055.65)-(1.89)\}$ SQ.M = 1092.16 SQ.M = 11756.00 SQ.FT
	THIRD FLOOR AREA (75%) (TSP1+TSP2) = $(78.94+98.00)/75\%$ SQ.M = 176.94 / 75% SQ.M = 132.70 SQ.M = 1428.00 SQ.FT
	THIRD FLOOR AREA (50%) (TS1-P1+P2) = $\{(1191.75) - (1.78+10.76)\}2$ SQ.M = $(1191.75 - 12.54)/2$ SQ.M = 1179.21/2 SQ.M = 589.60 SQ.M = 6346.00 SQ.FT

19530.00 SQ.FT