

HOSUR

SITE PLAN SHOWING THE PREMISES OF "M/S. ION EXCHANGE (INDIA) LTD" AT S.F.NO : 298PT,299PT, PLOT NO: 105,67-B(PART), SIPCOT INDUSTRIAL COMPLEX, PHASE -1, ZUVVADI VILLAGE, HOSUR TALUK, KRISHNAGIRI DISTRICT.

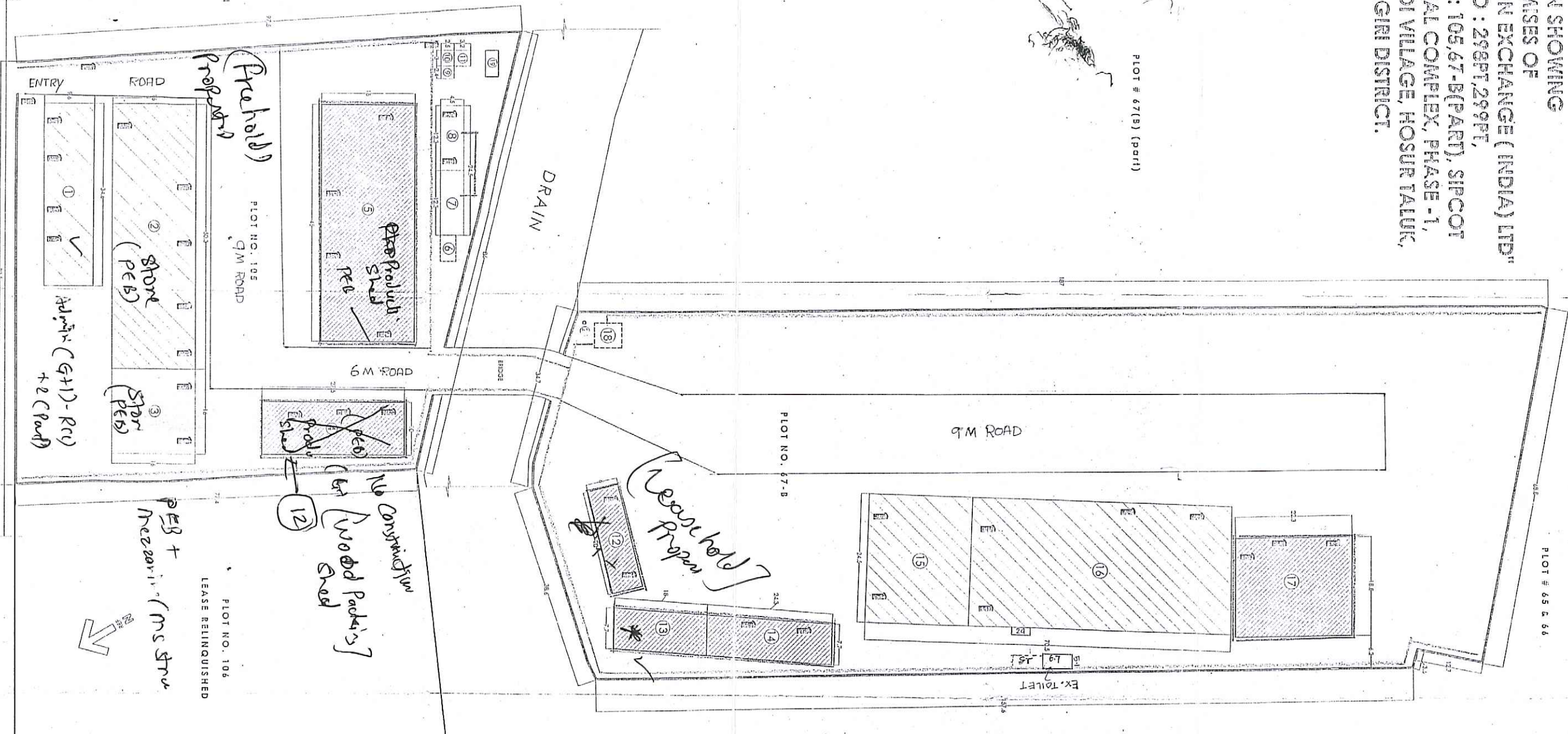

PLOT # 67.A & SIPCOT PUMP ROOM

NOTE
THE EXISTING STRUCTURES AREA ALREADY APPROVED VIDE REF AS BELOW
1. BY DEPUTY CHIEF INSPECTOR OF FACTORIES, HOSUR, VIDE APPROVAL NO.42/5031 / 2010 DATED 18-11-2010
2. BY DEPUTY CHIEF INSPECTOR OF FACTORIES, HOSUR, VIDE APPROVAL NO.52/1024/970/2207 DATED 25-09-2007
HOSUR, VIDE APPROVAL NO.52/1024/970/2207 DATED 25-09-2007

MEASUREMENTS & AREA DETAILS

Sl. No.	DESCRIPTION	AREA-SQ.M
1	EXISTING BUILDINGS	1884-50.11
2	PROPOSED BUILDINGS	37
3	PREMISES	1921.57
4	FIRE AREA	1921.57
5	ROADS	1921.57
6	DRAIN	1921.57
7	OPEN SPACE	1921.57
8	TOTAL	3912.26

PLOT # 67.A & SIPCOT PUMP ROOM

Sl. No.	DESCRIPTION	AREA-SQ.M
1	ADMINISTRATION BUILDING	231.00
2	1 ST FLOOR	216.00
3	2 ND FLOOR	24.00
4	RAW MATERIAL STORAGE BUILDING	989.09
5	PAINT ROOM	450.00
6	STEEL FABRICATION BUILDING	1224.12
7	PACKAGING BUILDING	319.126
8	ELECTRICAL AND INSTRUMENTATION BUILDING	272.00
9	1 ST FLOOR	272.00
10	2 ND FLOOR	272.00
11	PAVING & FAB BUILDING (PRODUCTION)	810.00
12	1 ST FLOOR	170
13	COFFER SLAB BUSTING BUILDING	138.50
14	RUBBER LIVING BUILDING	187.11
15	PIPE FABRICATION BUILDING	419.24
16	PROPOSED WATER TREATMENT PLANT	123
17	TOTAL	2912.26

POWER DETAILS

Sl. No.	DESCRIPTION	APPROVED POWER	EXISTING POWER	TOTAL POWER
1	APPROVED POWER	448 HP	448 HP	448 HP
2	EXISTING POWER	448 HP	448 HP	448 HP
3	TOTAL POWER	448 HP	448 HP	448 HP



ION EXCHANGE LTD.
PLOT NO: 105,67-B(PART), SIPCOT INDUSTRIAL COMPLEX, PHASE -1, ZUVVADI VILLAGE, HOSUR TALUK, KRISHNAGIRI DISTRICT, TAMILNADU.

ION EXCHANGE LTD.
PLOT NO: 105,67-B(PART), SIPCOT INDUSTRIAL COMPLEX, PHASE -1, ZUVVADI VILLAGE, HOSUR TALUK, KRISHNAGIRI DISTRICT, TAMILNADU.

VASTHU DESIGN
ARCHITECTURE STRUCTURES INTERIORS
LANDSCAPING, CEILING LIGHTS
PLOT # 11, THE EDEN GARDEN, THAYY ROAD
HOSUR-535109, T.NADU.