

Vastukala Consultants (I) Pvt. Ltd.

www.vastukala.co.in

Vastu/Mumbai/05/2024/8471/2306172
04/12-32-MRUP
Date: 04.05.2024

TO WHOMSOEVER IT MAY CONCERN

This is to certify that we have carried out actual site measurements on request of our Client **Smt. Varsha Patel** for Flat No. 2303, 23rd Floor, C wing, Ashford Royale, South Samuel Marg, Goregaon Mulund Link Road, Nahur, Bhandup West, Mumbai - 400078, State - Maharashtra, Country – India and found that the

Carpet Area = 999.43 Sq. Ft. i.e., 92.85 Sq. Mt. (Including Door Jamb).

For Vastukala Consultants (I) Pvt. Ltd.



Manoj B. Chalikwar
Registered Valuer
Chartered Engineer (India)
Reg. No. CAT-I-F-1763

Our Pan India Presence at :

- | | | | |
|--|--|---|---|
|  Nanded |  Thane |  Ahmedabad |  Delhi NCR |
|  Mumbai |  Nashik |  Rajkot |  Raipur |
|  Aurangabad |  Pune |  Indore |  Jaipur |

Regd. Office

BI-001, U/B Floor, BOOMERANG, Chandivali Farm Road, Powai, Andheri East, **Mumbai**: 400072, (M.S), India

 +91 2247495919

 mumbai@vastukala.co.in

 www.vastukala.co.in



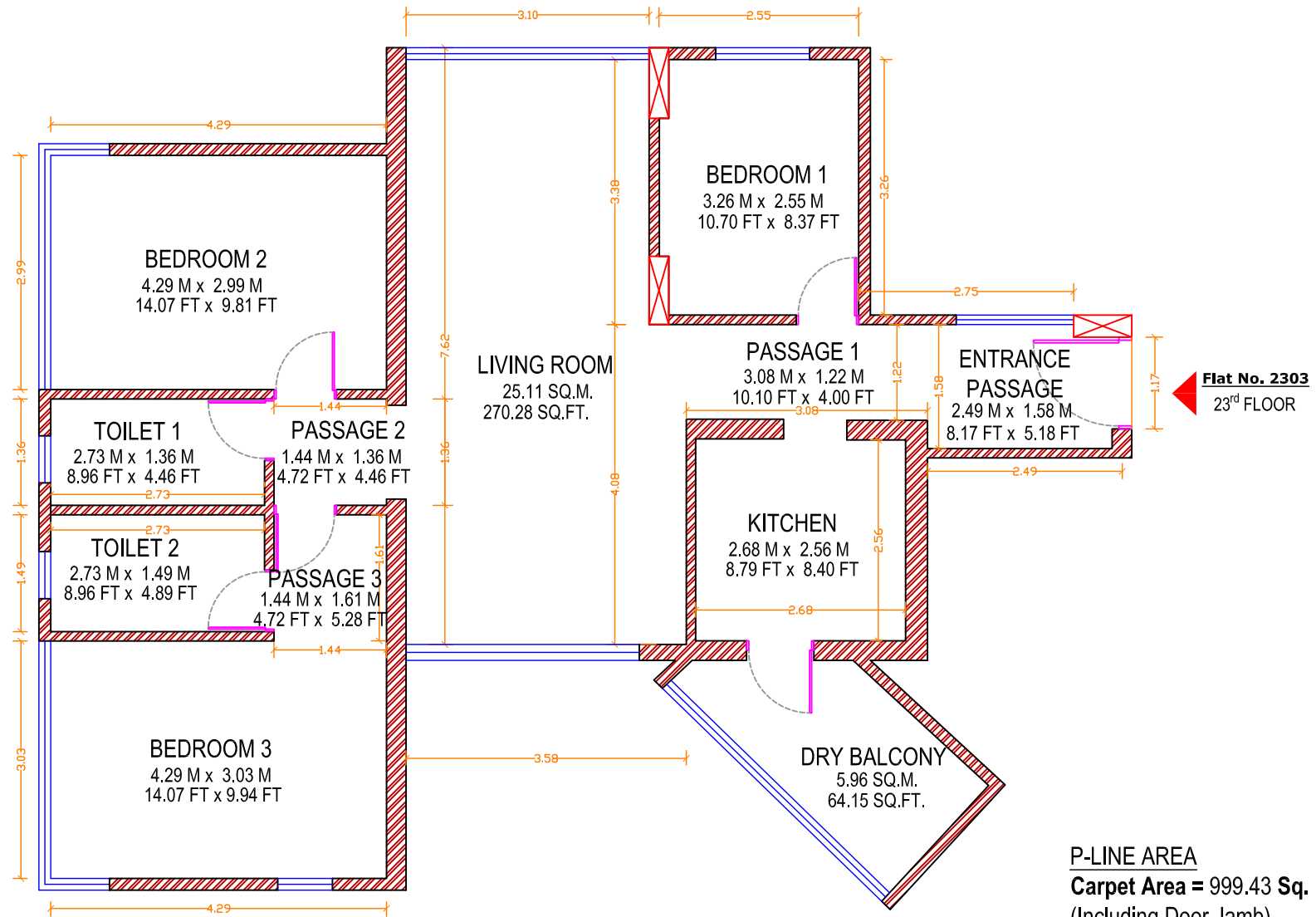

Flat No. 2303
23rd FLOOR



P-LINE AREA
Carpet Area = 999.43 Sq. Ft. i.e., 92.85 Sq. Mt.
(Including Door Jamb)

Name Of Client: Smt. Varsha Patel
Address: Flat No. 2303, 23rd Floor, C wing, Ashford Royale,
South Samuel Marg, Goregaon Mulund Link Road, Nahur,
Bhandup West, Mumbai - 400078,
State - Maharashtra, Country - India.

Signed By: Er. Manoj Chalikwar
Checked By : Er.Umang Patel
Drawing By : Ar. Meetali Rasal
Visit By : Er.Suraj Zore
Date : 04/ 05/ 2024



REGD. OFFICE:
Mumbai : Vastukala Consultants (I) Pvt. Ltd., Unit No. B1-001, Upper Basement Floor, Boomrang, Chandivali Farm Road, Powai, Andheri (East) Mumbai - 400 072 , State - Maharashtra, Country - INDIA.
Tel:- +91 2247495919