

TYPICAL REFUGE FLOOR PLAN (BLDG NO. 2)
 (7th, 9th, 11th, 13th, 15th, 17th, 19th, 21st, 23rd, 25th, 27th, 29th & 31st)
 SCALE :- 1:100

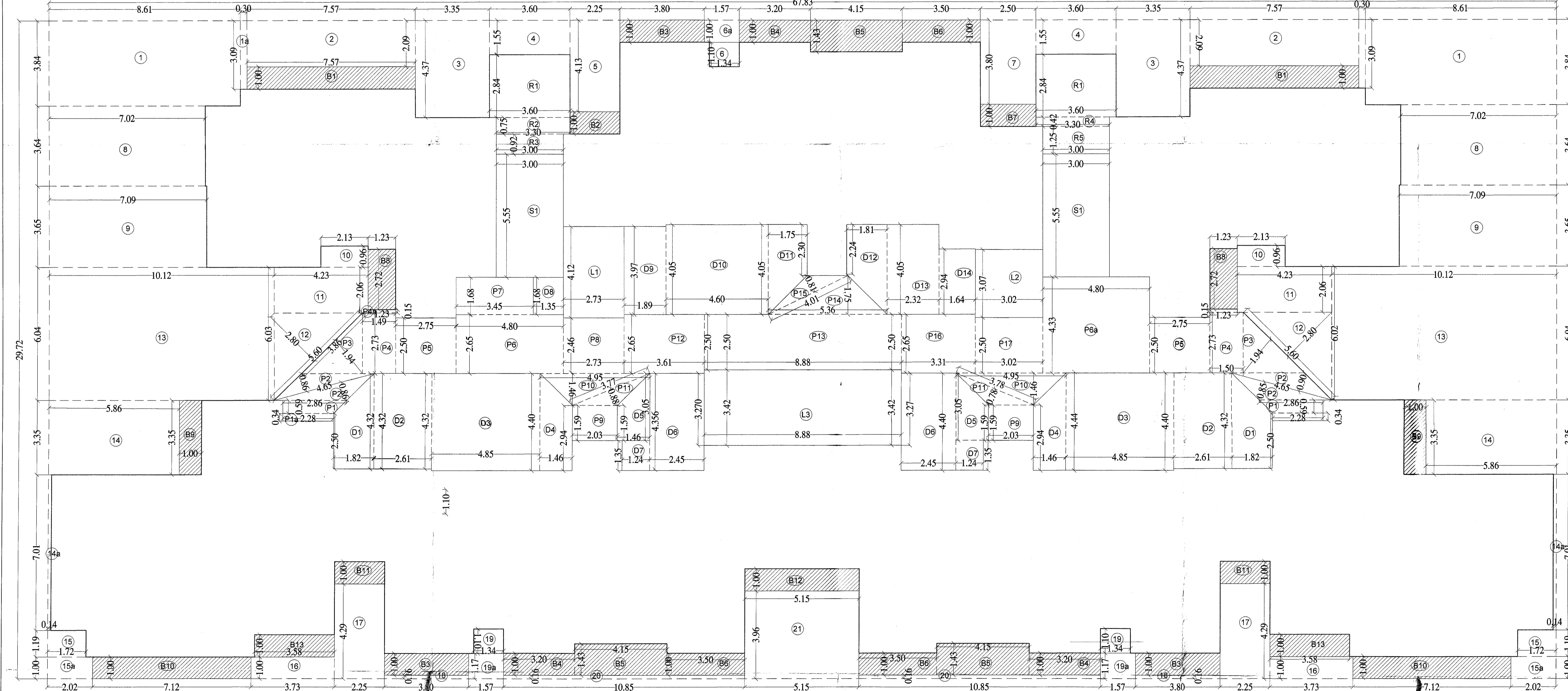

LINE DIAGRAM FOR TYPICAL REFUGE FLOOR PLAN (BLDG NO. 2)
 (7th, 9th, 11th, 13th, 15th, 17th, 19th, 21st, 23rd, 25th, 27th, 29th & 31st)
 SCALE :- 1:100

LIGHT AND VENTILATION STATEMENT (BLDG 2, FLAT NO 1 & 4)

ROOM	AREA OF ROOM (SQM)	AREA OF WIN REQ. (SQM)	AREA OF WIN PROV. (SQM)	TYPE OF WINDOW
LIVING	36.970	6.162	6.230	W1B
BED ROOM	11.680	1.947	3.870	W2
BED ROOM 1	13.970	2.328	3.870	W2
BED ROOM 2	13.540	2.257	3.060	W2A
KITCHEN	10.050	1.675	3.225	W3
TOILET	3.340	0.557	0.720	V
TOILET 1	3.960	0.660	0.720	V
TOILET 2	3.730	0.622	0.720	V

LIGHT AND VENTILATION STATEMENT (BLDG 2, FLAT NO 2 & 3)

ROOM	AREA OF ROOM (SQM)	AREA OF WIN REQ. (SQM)	AREA OF WIN PROV. (SQM)	TYPE OF WINDOW
LIVING	45.970	7.862	8.050	W
BED ROOM	11.590	1.932	3.870	W2
BED ROOM 1	14.460	2.410	3.870	W2
BED ROOM 2	20.230	3.372	3.870	W2
BED ROOM 3	16.580	2.783	3.870	W2
KITCHEN	10.140	1.690	3.225	W3
TOILET	3.670	0.612	0.720	V
TOILET 1	3.960	0.643	0.720	V
TOILET 2	3.730	0.622	0.720	V
TOILET 3	4.190	0.698	0.720	V

LIGHT AND VENTILATION STATEMENT (BLDG 2, FLAT NO 5 & 7)

ROOM	AREA OF ROOM (SQM)	AREA OF WIN REQ. (SQM)	AREA OF WIN PROV. (SQM)	TYPE OF WINDOW
LIVING	26.550	4.425	4.420	W1A
BED ROOM	10.810	1.802	3.870	W2
BED ROOM 1	14.180	2.363	3.870	W2
BED ROOM 2	14.210	2.368	3.060	W2A
KITCHEN	7.470	1.245	3.225	W3
TOILET	3.230	0.538	0.720	V
TOILET 1	4.810	0.802	0.860	V1
TOILET 2	2.490	0.415	0.720	V

LIGHT AND VENTILATION STATEMENT (BLDG 2, FLAT NO 6)

ROOM	AREA OF ROOM (SQM)	AREA OF WIN REQ. (SQM)	AREA OF WIN PROV. (SQM)	TYPE OF WINDOW
LIVING	46.820	7.803	8.060	W
BED ROOM 1	11.880	1.980	3.870	W2
BED ROOM 2	14.460	2.410	3.870	W2
BED ROOM 3	20.230	3.372	3.870	W2
BED ROOM 4	16.480	2.745	3.870	W2
KITCHEN	10.140	1.690	3.225	W3
TOILET	3.640	0.607	0.720	V
TOILET 1	3.960	0.643	0.720	V
TOILET 2	3.750	0.625	0.720	V
TOILET 3	4.170	0.685	0.720	V

REFUGE AREA STATEMENT

REFUGE AREA REQ. AT	TOTAL NO. OF PERSON ABOVE FLOORS
(7th, 9th, 11th, 13th, 15th, 17th, 19th, 21st, 23rd, 25th, 27th, 29th & 31st) (BLDG NO. 2)	
NO OF FLAT X FLOORS	
7.00 X 1.00	7
NO. OF PERSON PER FLAT	14
TOTAL PERSON	98
REQ. 0.3 SQ.MTS. PER PERSON	0.3
TOTAL REQ. REFUGE AREA	21.00
TOTAL PROVIDED REFUGE AREA	30.82

BUILT UP AREA CALCULATION FOR TYPICAL FLOOR PLAN (7TH,9TH,11TH,13TH,15TH,17TH,19TH,21ST,23RD,25TH,27TH,29TH,31ST)

ADDITION (X)	2015-91	SQ.MT.
A	67.83 x 29.72 x 1 x 1 x 1	2015.91
TOTAL		2015.91
STANDARD DEDUCTION (Y1)		
1	8.61 x 3.84	32.96
1a	0.30 x 3.09	0.93
2	7.57 x 2.09	15.81
3	3.35 x 4.37	14.64
4	3.60 x 1.55	5.58
5	2.25 x 4.13	9.29
6	1.34 x 1.10	1.47
6a	1.57 x 1.00	1.57
7	2.50 x 3.80	9.50
8	7.02 x 3.00	21.06
9	7.09 x 3.65	25.88
10	2.13 x 0.96	2.04
11	4.23 x 2.06	8.71
12	5.60 x 2.80	15.68
13	10.12 x 6.04	61.12
14	5.86 x 3.35	19.63
14a	0.14 x 7.01	0.98
15	1.72 x 1.19	2.05
15a	2.02 x 1.00	2.02
16	3.73 x 1.00	3.73
17	2.25 x 4.29	9.65
18	3.80 x 0.16	0.61
19	1.34 x 1.10	1.47
19a	1.57 x 1.00	1.57
20	10.95 x 0.16	1.75
21	5.15 x 3.96	20.41
B1	7.57 x 1.00	7.57
B2	2.25 x 1.00	2.25
B3	3.80 x 1.00	3.80
B4	3.20 x 1.00	3.20
B5	4.15 x 1.43	5.93
B6	3.50 x 1.00	3.50
B7	2.50 x 1.00	2.50
B8	1.23 x 2.72	3.35
B9	1.00 x 3.35	3.35
B10	7.12 x 1.00	7.12
B11	2.25 x 1.00	2.25
B12	5.15 x 1.00	5.15
B13	3.58 x 1.00	3.58
TOTAL		646.06
DUCT DEDUCTION (Y2)		
D1	1.82 x (2.5 + 4.32) x 0.50 x 2	12.41
D2	2.61 x 4.32 x 1 x 2	22.55
D3	4.85 x 4.40 x 1 x 2	42.68
D4	1.46 x (4.4 + 2.94) x 0.50 x 2	10.72
D5	1.46 x (1.59 + 3.05) x 0.50	6.77
D6	2.45 x 4.40 x 1 x 2	21.56
D7	1.24 x 1.35 x 1 x 2	3.35
D8	1.35 x 1.68 x 1 x 1	2.27
D9	1.89 x 3.97 x 1 x 1	7.50
D10	4.60 x 4.05 x 1 x 1	18.63
D11	1.75 x (4.05 + 2.30) x 0.50 x 1	5.56
D12	1.81 x (2.24 + 4.05) x 0.50 x 1	5.69
D13	2.32 x 4.05 x 1 x 1	9.40
D14	1.64 x 2.94 x 1 x 1	4.82
TOTAL		173.91
STAIRCASE, LIFT, LOBBY DEDUCTION (Y3)		
S1	3.00 x 5.55 x 1 x 2	33.30
L1	2.73 x 4.12 x 1 x 1	11.25
L2	3.02 x 3.07 x 1 x 1	9.27
L3	8.88 x 3.42 x 1 x 1	30.37
TOTAL		84.19
PASSAGE DEDUCTION (Y4)		
P1	0.59 x (2.96 + 2.28) x 0.50 x 2	3.03
P1a	2.28 x 0.34 x 1.00 x 2	1.55
P2	4.65 x 0.86 x 0.50 x 4	8.00
P3	3.86 x 1.94 x 0.50 x 2	7.49
P4	1.49 x 2.73 x 1 x 2	8.14
P4a	1.23 x 0.15 x 1 x 2	0.37
P5	2.75 x 2.50 x 1 x 2	13.75
P6	4.80 x 2.65 x 1 x 1	12.72
P6a	4.80 x 4.33 x 1 x 1	20.78
P7	3.45 x 1.68 x 1 x 1	5.80
P8	2.73 x 2.46 x 1 x 1	6.72
P9	2.03 x 1.59 x 1 x 2	6.46
P10	4.95 x 1.46 x 0.50 x 2	7.23
P11	3.78 x 0.78 x 0.50 x 2	2.95
P12	3.61 x 2.65 x 1 x 1	9.57
P13	8.88 x 2.50 x 1 x 1	22.20
P14	5.36 x 1.75 x 0.50 x 1	4.69
P15	4.01 x 0.81 x 0.50 x 1	1.62
P16	3.31 x 2.65 x 1 x 1	8.77
P17	3.02 x 2.50 x 1 x 1	7.55
TOTAL		159.37
REFUGE DEDUCTION (Y5)		
R1	3.60 x 2.84 x 1 x 2	20.45
R2	3.30 x 0.75 x 1.00 x 1	2.48
R3	3.00 x 0.92 x 1.00 x 1	2.76
R4	3.30 x 0.42 x 1 x 1	1.39
R5	3.00 x 1.25 x 1 x 1	3.75
TOTAL		30.82
REQUIRED REFUGE AREA (Y6)		21.00
TOTAL DEDUCTION (Y7) (Y1+Y2+Y3+Y4+Y5)		1094.35
TOTAL BUILT UP AREA (Y8) (X-Y7)		921.56
EXCESS REFUGE AREA (Y9)		9.82
PERM. BALCONY (Y10) (Y8 x 10%)		92.16
TOTAL (Y11)		1013.72
EXCESS BALCONY (Y12) (Y9-Y8)		21.49
NET BUILT UP AREA (Y8+Y9+Y12)		952.86

CONTENTS OF SHEET
 TYPICAL REFUGE FLOOR PLAN & CALCULATION (BLDG NO. 2)

STAMP AND DATE OF APPROVAL OF PLAN
 AMENDED DEVELOPMENT PERMISSION GRANTED
 Subject to the conditions mentioned in this office's letter No. CIP/CON/NA/1/Amended/2018/1284
 Dated 21 FEB 2019
 Associate Planner (NA/NA)

DOOR SCHEDULE

SL NO.	D/D	SIZE	MATERIAL	DESCRIPTION	REMARK
1	FRD	1.5 X 2.30	2.30	FIRE RESISTANT DOOR	STAIRCASE
2	D-1	1.2 X 2.30	2.30	T.W. FRAME WITH W.P. FLUSH DOOR	MAIN DOOR
3	D-2	0.8 X 2.30	2.30	T.W. FRAME WITH W.P. FLUSH DOOR	BED ROOM
4	D-3	0.76 X 2.30	2.30	MARBLE/EGG MARBLE FRAME WITH FIRE DOOR	TOILET

WINDOW SCHEDULE

SL NO.	W/D	SIZE	SHALL	MATERIAL	AREA IN SQ.MT.	DESCRIPTION	REMARK
1	SW-1	2.0 X 2.15	0.15	2.30	4.30	RALING / FIXED GLASS WINDOW	STAIRCASE
2	W	3.75 X 2.15	0.15	2.30	8.06	ALUMINIUM SLIDING WINDOW	LIVING ROOM WING 5, FLAT 2, 3
3	W-1A	2.60 X 1.70	0.60	2.30	4.42	ALUMINIUM SLIDING WINDOW	LIVING ROOM
4	W-1B	2.90 X 2.15	0.15	2.30	6.23	ALUMINIUM SLIDING WINDOW	LIVING ROOM WING 6, FLAT 1 & 4
5	W-2	1.8 X 2.15	0.15	2.30	3.87	ALUMINIUM SLIDING WINDOW	BED ROOM
6	W-2A	1.8 X 1.70	0.60	2.30	3.06	ALUMINIUM SLIDING WINDOW	BED ROOM
7	W-3	1.5 X 2.15	0.15	2.30	3.22	ALUMINIUM SLIDING WINDOW	KITCHEN
8	V	0.75 X 0.95	1.35	2.30	0.71	LOUVERS VENTILATOR	TOILETS & DUCT
9	V1	0.80 X 0.85	1.35	2.30	0.85	LOUVERS VENTILATOR	TOILETS & DUCT
10	V2	0.65 X 0.95	1.35	2.30	0.61	LOUVERS VENTILATOR	TOILETS & DUCT

NOTE :-
 1) HABITABLE ROOM INCLUDES BEDROOM & LIVING ROOM
 2) REFUGE AREAS ARE PROVIDED AT MIDLANDING OF EVERY ALTERNATE FLOOR
 3) ALL DIMENSIONS ARE IN METER.

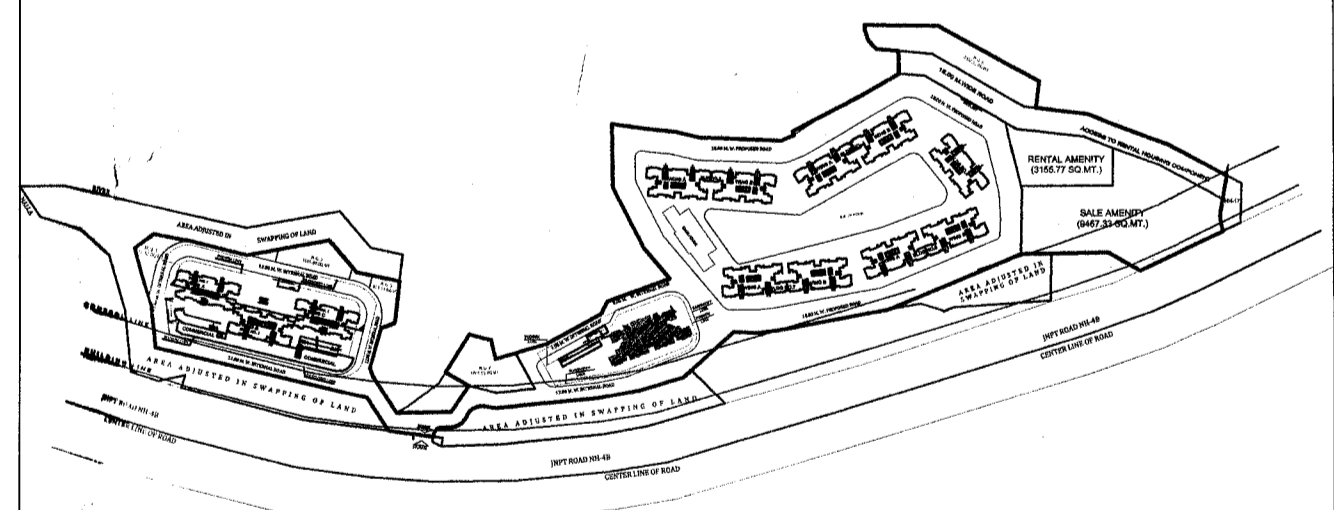

KEY PLAN

DESCRIPTION OF PROPOSAL & PROPERTY

PROPOSED DEVELOPMENT FOR RENTAL HOUSING SCHEME ON LAND BEARING S.NO.95/1(p)/95/2(p)/95/3A (p), 98/1/98/2/98/3/98/4A/98/4/B/1/98/4/B/2, 98/5(p)/98/7/3(p)/98/8/98/9/98/10A/98/10B/99(p).101/3.101/4A/101/4/B, 101/4/C/101/5.101/6.101/7.101/8A/101/8B/101/9.101/10/10A/10/B.102.103/1.103/2(p).103/3.103/4.110/1A(p).110/4.110/5A.110/6A.110/10.110/11 at Village Kolhke, Taluka - Panvel, District Raigad

NORTH	JOB. NO.	DRG. NO.	DRAWN BY
		17/24	
	SCALE	DATE	CHECKED BY
	1:100		

REVISIONS	DESCRIPTION
R/O	

NAME OF THE OWNER _____ SIGNATURE _____

SHRI. ESMAL EBRAHIM DHARIWALA
 (P.O.A.H. of Shri. Adiz Esmal Dhariwala & 9 others)

NAME AND ADDRESS OF ARCHITECT _____ SIGNATURE _____

ARCH. DEVIYANI KHADILKAR
 B-106, Natraj Building,
 Mulund Goregaon Link Road
 Mulund (w), Mumbai - 400 080