

PROPOSED FACTORY PLAN
ON PLOT NO. T-24, TEXTILE
PARK, ADDITIONAL
AMRAVATI INDUSTRIAL
AREA, VILLAGE- NANDGAON
PETH, TAH.- AMRAVATI,
DIST.- AMRAVATI
BELONGS TO
MAHI TERRY COT LLT.

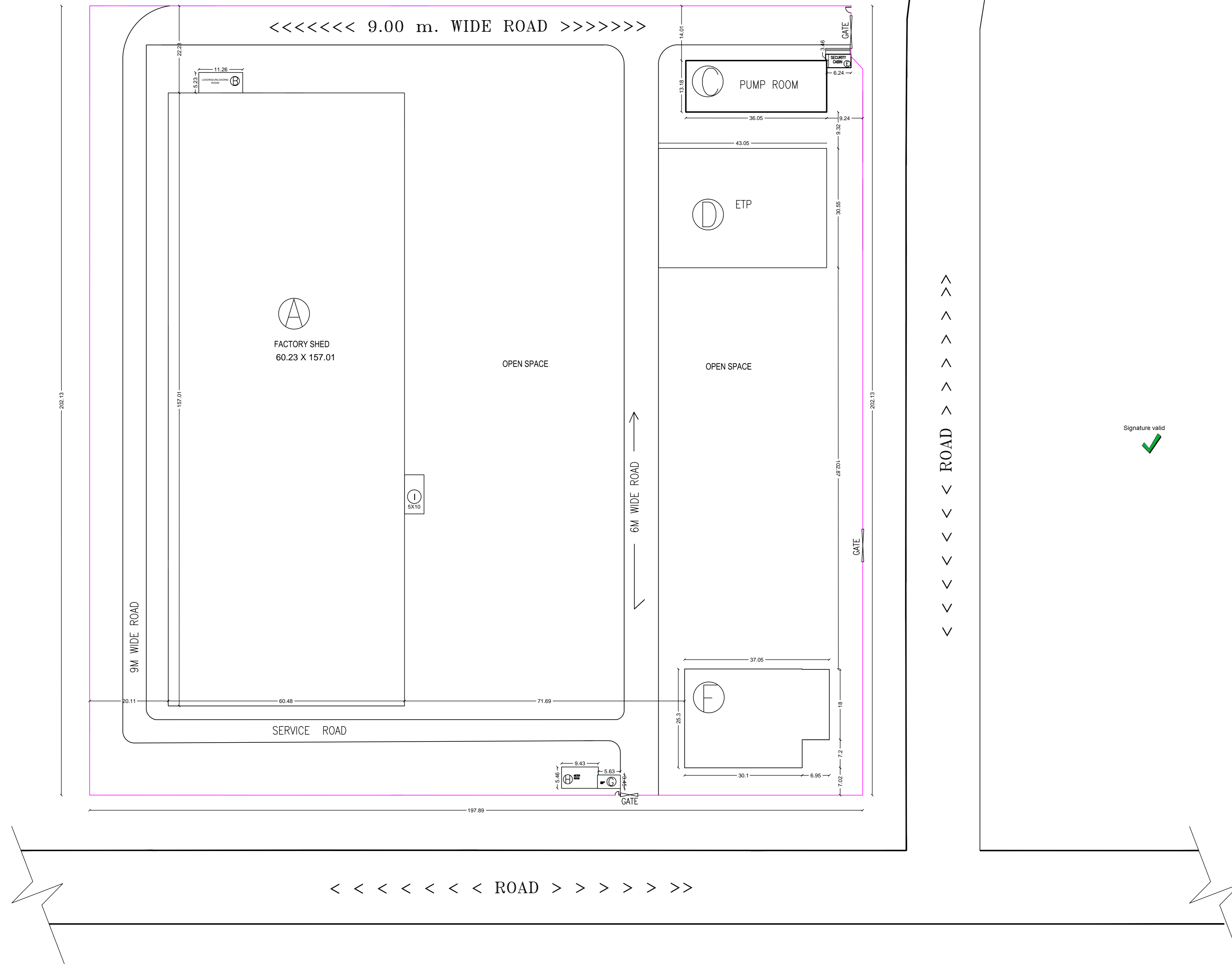

SITE PLAN
SCALE-1:500

Signature valid ✓

AREA STATEMENT

TOTAL PLOT AREA	= 40000.00	SQ.M.
PROPOSED BUILD UP AREA		
A) WORKING SHED	= 60.23 X 157.01 =	9456.7123 SQ.M.
B) LOADING/UNLOADING ROOM	= 11.26 X 5.23 =	58.8898 SQ.M.
C) PUMP ROOM	= 36.05 X 13.18 =	475.1390 SQ.M.
D) ETP ROOM	= 43.05 X 30.55 =	1315.1775 SQ.M.
E) SECURITY CABIN	= 6.24 X 3.46 =	21.5904 SQ.M.
F) BOILER SHED	= 37.05 X 25.3 =	937.3650 SQ.M.
G) SECURITY CABIN	= 5.86 X 3.45 =	20.2170 SQ.M.
H) METERING ROOM	= 9.43 X 5.46 =	51.4878 SQ.M.
I) COLD & HOT UNDERGROUND TANK	= 5.00 X 10.00 =	50.0000 SQ.M.
TOTAL BUILT UP AREA		12386.5788 SQ.M.

OWNERS SIGN.

SORABH AGARWAL

SORABH AGARWAL

ARCHITECT



OPAL ENGINEERS & CONSULTANTS

Architects, Chartered Engineers, Govt. Regd.
Valuers, Arbitrators, Project Consultants.

Plot No. B1/7, NIT Colony, MIG (II), First Floor,
Opposite - Shri. Durga Mandir, Pratap Nagar, Nagpur - 440022
(MS) INDIA.

MO. NO. :- +919561003117, +918208576967.
E-Mail opal.engineers03@gmail.com



SHEET TITLE SITE PLAN

SHEET NO. 05/01