

Vastu/Mumbai/03/2024/7983/2305797
29/07-545- MRUP
Date: 29.03.2024

TO WHOMSOEVER IT MAY CONCERN

This is to certify that we have carried out actual site measurements on request of our Client **Visawa Co-operative housing society**. For Flat No. 604, A- Wing, Visawa Co-operative housing society, Bldg. no. 30, D N Nagar, New Link Road, Andheri West, Mumbai- 400053, State - Maharashtra, Country – India and found that the **Mofa Carpet Area (Usable carpet area) = 511.69 Sq. Ft. i.e., 47.54 Sq. M.**

For Vastukala Consultants (I) Pvt. Ltd.

**Manoj
Chalikwar**

Digitally signed by Manoj Chalikwar
DN: cn=Manoj Chalikwar,
o=Vastukala Consultants (I) Pvt. Ltd.,
ou=Mumbai,
email=manoj@vastukala.org, c=IN
Date: 2024.03.29 13:51:06 +05'30'



Manoj B. Chalikwar

Registered Valuer
Chartered Engineer (India)
Reg. No. CAT-IF-1763

Think.Innovate.Create



Our Pan India Presence at :

Mumbai Aurangabad Pune Rajkot
Thane Nanded Indore Raipur
Delhi NCR Nashik Ahmedabad Jaipur

Regd. Office : B1-001, U/B Floor, Boomerang,
Chandivali Farm Road, Andheri (East),
Mumbai - 400 072, (M.S.), INDIA
TeleFax : +91 22 28371325/24
mumbai@vastukala.org

ANNEXURE

FLAT NO. 604- SITE MEASUREMENTS					
SR.NO.	ROOM	LENGTH IN M	WIDTH IN M	AREA IN SQ.M.	AREA IN SQ.FT.
1	Living room - Part-1	4.73	2.71	12.84	138.24
2	Living room door jamb	0.99	0.24	0.24	2.56
3	Living room Dining	1.546	1.831	2.83	30.47
4	Kitchen - Part-1	2.05	0.86	1.76	18.89
5	Kitchen - Part-2	1.45	1.86	2.70	29.02
6	Kitchen - Part-3	2.06	0.40	0.82	8.83
7	Kitchen door jamb	0.89	0.20	0.17	1.87
8	Bedroom - Part-1	2.71	2.72	7.37	79.37
9	Bedroom door jamb	0.84	0.17	0.14	1.53
10	Common Passage	2.32	0.87	2.02	21.73
11	Common Toilet	2.11	1.15	2.43	26.16
12	Common Toilet door jamb	0.70	0.15	0.10	1.12
13	Master Bedroom Part-1	2.71	3.76	10.19	109.65
14	Passage in Master Bedroom	1.21	0.87	1.05	11.34
15	Master Bedroom door jamb	0.87	0.12	0.10	1.13
16	Master Bedroom Toilet	2.29	1.17	2.66	28.67
17	Master Bedroom Toilet door jamb	0.69	0.15	0.10	1.11
	Total Mofa Carpet Area (Usable area)			47.54	511.69

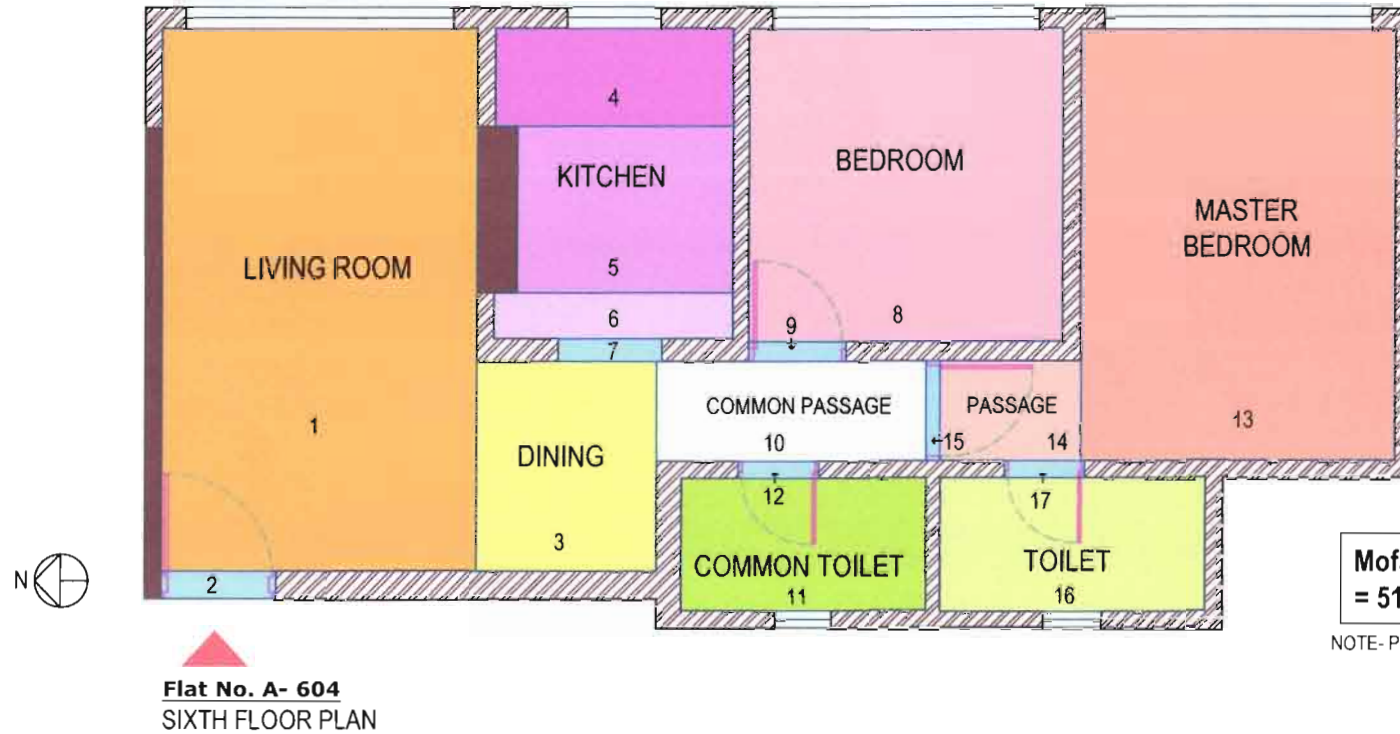

Mofa Carpet Area (Usable carpet area)
= 511.69 Sq. Ft. i.e. 47.54 Sq.M.

NOTE- PLEASE REFER ANNEXURE 604 FOR MEASUREMENTS



Name Of Client: Visawa Co-operative housing society.
Address: Flat No.604, A- Wing, Visawa Co-operative housing society, Bldg. no. 30, D N Nagar, New Link road, Andheri West, Mumbai- 400053, State - Maharashtra, Country - India.
Project name-"Aadhayay".

Signed By: Er. Manoj Chalikwar
Checked By : Er. Umang Patel
Drawing By : Ar. Meetali Rasal
Site inspection and Measurements By :
Ar. Meetali Rasal & Er. Saiprasad Patil
Date : 29/ 03/ 2024

Think, Innovate, Create
VASTUKALA CONSULTANTS (I) PVT. LTD

REGD. OFFICE:
Mumbai : Vastukala Consultants (I) Pvt. Ltd., Unit No. B1-001, Upper Basement Floor, Boomrang, Chandivali Farm Road, Powai, Andheri (East) Mumbai - 400 072 , State - Maharashtra, Country - INDIA.
Tel:- +91 2247495919