

CONTAINS - FLOOR PLAN, AREA DIAGRAM, SECTION, AREA STATEMENT, CARPET AREA STATEMENT, PARKING AREA STATEMENT

APPROVING AUTHORITY

OFFICE OF THE KALYAN DOMBIVLI MUNICIPAL CORPORATION, KALYAN.  
 Building Permit No.: KDMC/TPD/BL/27Village/2018-19/22/283.  
 Date: 07/12/2023.

SANCTIONED

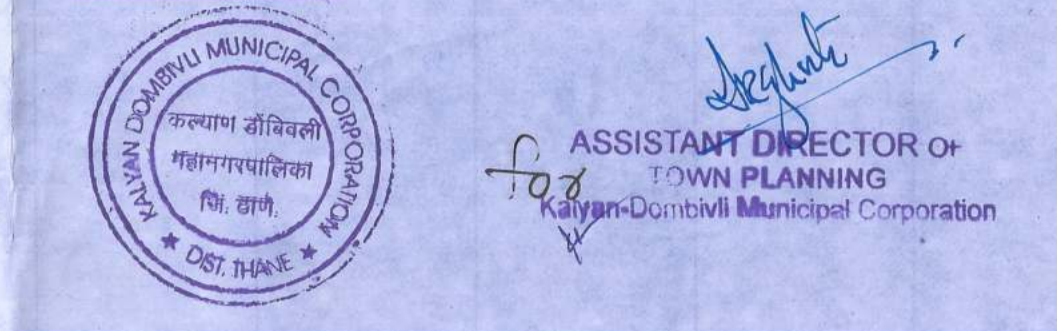

PROPOSED BUILDING

BUILDING NO.	FLOOR NO.	TOTAL BUILT-UP AREA OF FLOOR, AS PER OUTER CONSTRUCTION LINE.
5	3RD + 22ND FLOOR	13308.41 SQ.MT

TENEMENT STATEMENT (PREVIOUS SANCTION)

REQUIRED PERCENTAGE	NO. OF TENEMENT	PERCENTAGE
UP TO 35.00 SQ.MT	08	55 %
35.00 TO 65.00 SQ.MT	05	45 %
ABOVE 65.00 SQ.MT	02	100 %
TOTAL	15	100 %

CARPET AREA STATEMENT (PREVIOUS SANCTION)

BLOCK NO.	CARPET AREA (SQ.MT.)
201	32.32 SQ.MT.
202	44.94 SQ.MT.
203	44.94 SQ.MT.
204	33.00 SQ.MT.
205	33.00 SQ.MT.
206	47.10 SQ.MT.
207	33.00 SQ.MT.
208	33.00 SQ.MT.
209	44.76 SQ.MT.
210	14.16 SQ.MT.
211	33.00 SQ.MT.

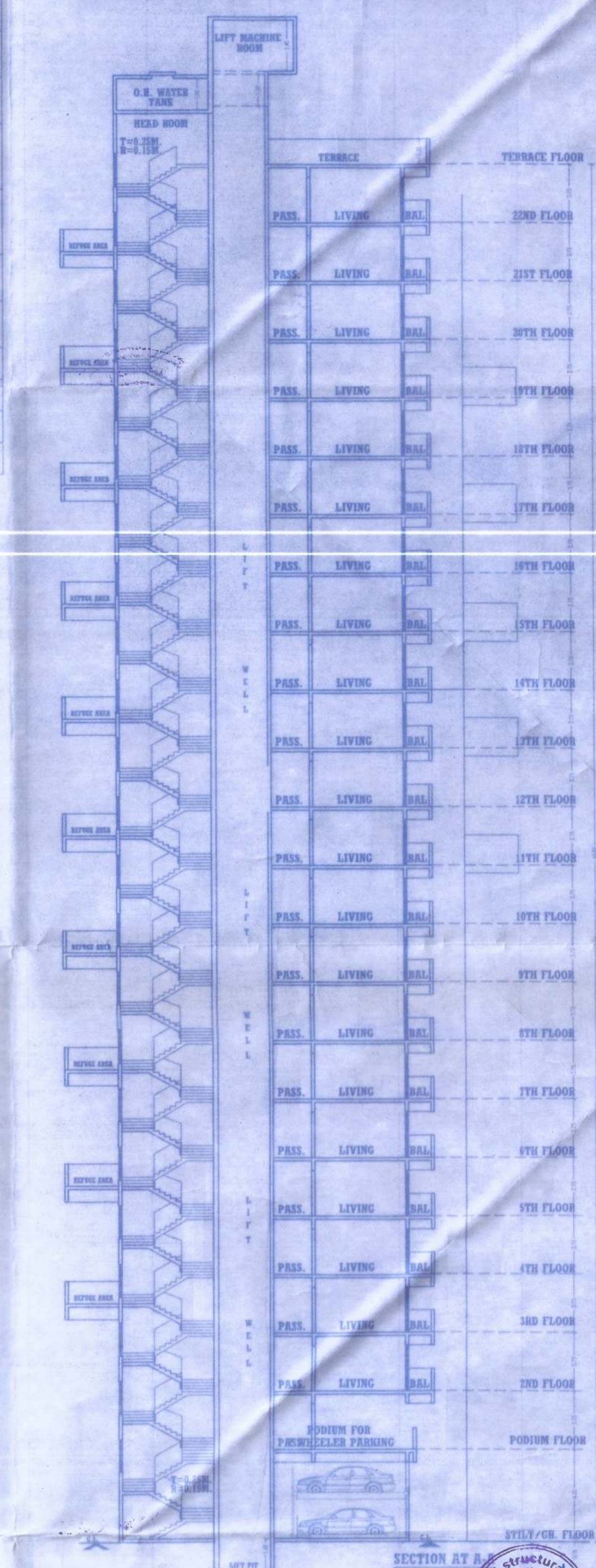

DESCRIPTION OF PROPOSAL & PROPERTY

REVISED AMALGAMATION & BUILDING PROPOSAL ON PLOT BEARING S. NO.-24, H. NO.-1, 2 & 3, AT VILLAGE - DORNALI - DORNALI, TAL. - BARKHEDRA, DIST. - THANE, S.NO.-13 B.L.NO.-11 & S.NO.-34, H. NO.-9, 10, 11, 12, 14, 15 AT VILL.-PIRVALLI, TAL.-KALYAN, DIST.-THANE.

NAME & SIGNATURE OF OWNER: S. SAMARTH SAI BUILDERS & DEV.

SIGNATURE OF ARCHITECT: [Signature]

DATE: 11-11-2023

SCALE: AS SHOWN

ARCHITECTS & CONSULTANTS: [Firm Name]

BUILDING NO. 5 BUILT UP AREA STATEMENT ( PREVIOUS SANCTION & PROPOSED )

FLOOR	BUILT UP AREA	STAIRCASE AREA	PREVIOUS SANCTIONED			TOTAL AREA	P-LINE AREA	
			NET AREA	PERMI. BALC. AREA	EXCESS BAL. AREA			
STILT FLOOR	30.11	13.76	16.35	--	--	16.35	31.41	
PODIUM FLOOR	P	R	R	K	I	N	G	--
SECOND FLOOR	517.42	87.23	430.19	51.74	51.48	--	430.19	--

BUILDING NO. 5 BUILT UP AREA STATEMENT ( PREVIOUS SANCTION & PROPOSED )

FLOOR	BUILT UP AREA	STAIRCASE AREA	PREVIOUS SANCTIONED			TOTAL AREA	P-LINE AREA	
			NET AREA	PERMI. BALC. AREA	EXCESS BAL. AREA			
STILT FLOOR	30.11	13.76	16.35	--	--	16.35	31.41	
PODIUM FLOOR	P	R	R	K	I	N	G	--
SECOND FLOOR	517.42	87.23	430.19	51.74	51.48	--	430.19	--

P-LINE AREA STATEMENT

FLOOR	BUILT UP AREA	STAIRCASE AREA	PREVIOUS SANCTIONED			TOTAL AREA	P-LINE AREA	
			NET AREA	PERMI. BALC. AREA	EXCESS BAL. AREA			
STILT FLOOR	30.11	13.76	16.35	--	--	16.35	31.41	
PODIUM FLOOR	P	R	R	K	I	N	G	--
SECOND FLOOR	517.42	87.23	430.19	51.74	51.48	--	430.19	--
THIRD FLOOR	--	--	--	--	--	--	663.85	--
FOURTH FLOOR	--	--	--	--	--	--	663.85	--
FIFTH FLOOR	--	--	--	--	--	--	663.85	--
SIXTH FLOOR	--	--	--	--	--	--	663.85	--
SEVENTH FLOOR	--	--	--	--	--	--	663.85	--
EIGHTH FLOOR	--	--	--	--	--	--	663.85	--
NINTH FLOOR	--	--	--	--	--	--	663.85	--
TENTH FLOOR	--	--	--	--	--	--	663.85	--
ELEVENTH FLOOR	--	--	--	--	--	--	663.85	--
TWELFTH FLOOR	--	--	--	--	--	--	663.85	--
THIRTEENTH FLOOR	--	--	--	--	--	--	663.85	--
FOURTEENTH FLOOR	--	--	--	--	--	--	663.85	--
FIFTEENTH FLOOR	--	--	--	--	--	--	663.85	--
SIXTEENTH FLOOR	--	--	--	--	--	--	663.85	--
SEVENTEENTH FLOOR	--	--	--	--	--	--	663.85	--
EIGHTEENTH FLOOR	--	--	--	--	--	--	663.85	--
NINETEENTH FLOOR	--	--	--	--	--	--	663.85	--
TWENTIETH FLOOR	--	--	--	--	--	--	663.85	--
TWENTY FIRST FLOOR	--	--	--	--	--	--	663.85	--
TWENTY SECOND FLOOR	--	--	--	--	--	--	663.85	--
TOTAL	547.53	100.95	446.54	51.74	51.48	449.34	13308.41	13254.55

PARKING AREA STATEMENT (Bldg no 5)

ONE PARKING AREA FOR EVERY TENEMENT	No. of FLATS	No. of CAR	No. of SCOOTER
1) FOR EVERY TENEMENT HAVING CARPET AREA OF 100 SQ.M. AND ABOVE	NIL	NIL	NIL
2) FOR EVERY TENEMENT HAVING CARPET AREA EQUAL TO OR ABOVE 50 SQ.M. BUT LESS THAN 100 SQ.M.	100 NOS	50 NOS	100 NOS
3) FOR EVERY TWO TENEMENTS WITH EACH TENEMENT HAVING CARPET AREA EQUAL TO OR ABOVE 40 SQ.M. BUT LESS THAN 50 SQ.M.	100 NOS	50 NOS	100 NOS
4) COMMERCIAL AREA ( FOR 100 SQ.MT. 1 CAR & SCOOTER PARKING )	NIL	3 NOS	NIL
5) ADDITIONAL 04 BEST VISITOR PARKING	NIL	NIL	04 NOS
6) TOTAL REQUIRED PARKING CAR	NIL	53 NOS	104 NOS
7) TOTAL REQUIRED PARKING CAR	NIL	42 NOS	102 NOS
8) CONSIDERATION OF PARKING AS PER 50 RULE 50%	NIL	42 NOS	102 NOS
9) TOTAL REQUIRED PARKING CAR	NIL	42 NOS	102 NOS

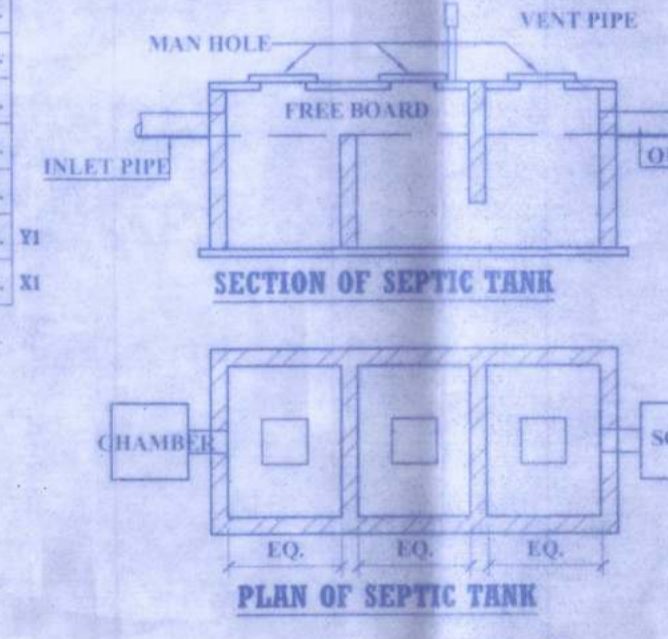

P-LINE AREA CALCULATION

TYPICAL FLOOR ( 3RD TO 22ND FLOOR ) ( BUILDING NO. 5 )

A	46.85 X 18.30 X 1.90	=	1581.69 SQ.MT.
TOTAL ADDITION = 1581.69 SQ.MT.			

REMARKS:

1	1.90 X 17.90 X 1.90	=	13.46 SQ.MT.
2	1.90 X 17.35 X 1.90	=	13.33 SQ.MT.
3	1.90 X 16.80 X 1.90	=	13.20 SQ.MT.
4	1.90 X 16.25 X 1.90	=	13.07 SQ.MT.
5	1.90 X 15.70 X 1.90	=	12.94 SQ.MT.
6	1.90 X 15.15 X 1.90	=	12.81 SQ.MT.
7	1.90 X 14.60 X 1.90	=	12.68 SQ.MT.
8	1.90 X 14.05 X 1.90	=	12.55 SQ.MT.
9	1.90 X 13.50 X 1.90	=	12.42 SQ.MT.
10	1.90 X 12.95 X 1.90	=	12.29 SQ.MT.
11	1.90 X 12.40 X 1.90	=	12.16 SQ.MT.
12	1.90 X 11.85 X 1.90	=	12.03 SQ.MT.
13	1.90 X 11.30 X 1.90	=	11.90 SQ.MT.
14	1.90 X 10.75 X 1.90	=	11.77 SQ.MT.
15	1.90 X 10.20 X 1.90	=	11.64 SQ.MT.
16	1.90 X 9.65 X 1.90	=	11.51 SQ.MT.
17	1.90 X 9.10 X 1.90	=	11.38 SQ.MT.
18	1.90 X 8.55 X 1.90	=	11.25 SQ.MT.
19	1.90 X 8.00 X 1.90	=	11.12 SQ.MT.
20	1.90 X 7.45 X 1.90	=	10.99 SQ.MT.
21	1.90 X 6.90 X 1.90	=	10.86 SQ.MT.
22	1.90 X 6.35 X 1.90	=	10.73 SQ.MT.
23	1.90 X 5.80 X 1.90	=	10.60 SQ.MT.
24	1.90 X 5.25 X 1.90	=	10.47 SQ.MT.
25	1.90 X 4.70 X 1.90	=	10.34 SQ.MT.
26	1.90 X 4.15 X 1.90	=	10.21 SQ.MT.
27	1.90 X 3.60 X 1.90	=	10.08 SQ.MT.
28	1.90 X 3.05 X 1.90	=	9.95 SQ.MT.
29	1.90 X 2.50 X 1.90	=	9.82 SQ.MT.
30	1.90 X 1.95 X 1.90	=	9.69 SQ.MT.
31	1.90 X 1.40 X 1.90	=	9.56 SQ.MT.
32	1.90 X 0.85 X 1.90	=	9.43 SQ.MT.
33	1.90 X 0.30 X 1.90	=	9.30 SQ.MT.
34	1.90 X 0.00 X 1.90	=	9.17 SQ.MT.
35	1.90 X 0.00 X 1.90	=	9.04 SQ.MT.
36	1.90 X 0.00 X 1.90	=	8.91 SQ.MT.
37	1.90 X 0.00 X 1.90	=	8.78 SQ.MT.
38	1.90 X 0.00 X 1.90	=	8.65 SQ.MT.
39	1.90 X 0.00 X 1.90	=	8.52 SQ.MT.
40	1.90 X 0.00 X 1.90	=	8.39 SQ.MT.
41	1.90 X 0.00 X 1.90	=	8.26 SQ.MT.
42	1.90 X 0.00 X 1.90	=	8.13 SQ.MT.
43	1.90 X 0.00 X 1.90	=	8.00 SQ.MT.
44	1.90 X 0.00 X 1.90	=	7.87 SQ.MT.
45	1.90 X 0.00 X 1.90	=	7.74 SQ.MT.
46	1.90 X 0.00 X 1.90	=	7.61 SQ.MT.
47	1.90 X 0.00 X 1.90	=	7.48 SQ.MT.
48	1.90 X 0.00 X 1.90	=	7.35 SQ.MT.
49	1.90 X 0.00 X 1.90	=	7.22 SQ.MT.
50	1.90 X 0.00 X 1.90	=	7.09 SQ.MT.
51	1.90 X 0.00 X 1.90	=	6.96 SQ.MT.
52	1.90 X 0.00 X 1.90	=	6.83 SQ.MT.
53	1.90 X 0.00 X 1.90	=	6.70 SQ.MT.
54	1.90 X 0.00 X 1.90	=	6.57 SQ.MT.
55	1.90 X 0.00 X 1.90	=	6.44 SQ.MT.
56	1.90 X 0.00 X 1.90	=	6.31 SQ.MT.
57	1.90 X 0.00 X 1.90	=	6.18 SQ.MT.
58	1.90 X 0.00 X 1.90	=	6.05 SQ.MT.
59	1.90 X 0.00 X 1.90	=	5.92 SQ.MT.
60	1.90 X 0.00 X 1.90	=	5.79 SQ.MT.
61	1.90 X 0.00 X 1.90	=	5.66 SQ.MT.
62	1.90 X 0.00 X 1.90	=	5.53 SQ.MT.
63	1.90 X 0.00 X 1.90	=	5.40 SQ.MT.
64	1.90 X 0.00 X 1.90	=	5.27 SQ.MT.
65	1.90 X 0.00 X 1.90	=	5.14 SQ.MT.
66	1.90 X 0.00 X 1.90	=	5.01 SQ.MT.
67	1.90 X 0.00 X 1.90	=	4.88 SQ.MT.
68	1.90 X 0.00 X 1.90	=	4.75 SQ.MT.
69	1.90 X 0.00 X 1.90	=	4.62 SQ.MT.
70	1.90 X 0.00 X 1.90	=	4.49 SQ.MT.
71	1.90 X 0.00 X 1.90	=	4.36 SQ.MT.
72	1.90 X 0.00 X 1.90	=	4.23 SQ.MT.
73	1.90 X 0.00 X 1.90	=	4.10 SQ.MT.
74	1.90 X 0.00 X 1.90	=	3.97 SQ.MT.
75	1.90 X 0.00 X 1.90	=	3.84 SQ.MT.
76	1.90 X 0.00 X 1.90	=	3.71 SQ.MT.
77	1.90 X 0.00 X 1.90	=	3.58 SQ.MT.
78	1.90 X 0.00 X 1.90	=	3.45 SQ.MT.
79	1.90 X 0.00 X 1.90	=	3.32 SQ.MT.
80	1.90 X 0.00 X 1.90	=	3.19 SQ.MT.
81	1.90 X 0.00 X 1.90	=	3.06 SQ.MT.
82	1.90 X 0.00 X 1.90	=	2.93 SQ.MT.
83	1.90 X 0.00 X 1.90	=	2.80 SQ.MT.
84	1.90 X 0.00 X 1.90	=	2.67 SQ.MT.
85	1.90 X 0.00 X 1.90	=	2.54 SQ.MT.
86	1.90 X 0.00 X 1.90	=	2.41 SQ.MT.
87	1.90 X 0.00 X 1.90	=	2.28 SQ.MT.
88	1.90 X 0.00 X 1.90	=	2.15 SQ.MT.
89	1.90 X 0.00 X 1.90	=	2.02 SQ.MT.
90	1.90 X 0.00 X 1.90	=	1.89 SQ.MT.
91	1.90 X 0.00 X 1.90	=	1.76 SQ.MT.
92	1.90 X 0.00 X 1.90	=	1.63 SQ.MT.
93	1.90 X 0.00 X 1.90	=	1.50 SQ.MT.
94	1.90 X 0.00 X 1.90	=	1.37 SQ.MT.
95	1.90 X 0.00 X 1.90	=	1.24 SQ.MT.
96	1.90 X 0.00 X 1.90	=	1.11 SQ.MT.
97	1.90 X 0.00 X 1.90	=	0.98 SQ.MT.
98	1.90 X 0.00 X 1.90	=	0.85 SQ.MT.
99	1.90 X 0.00 X 1.90	=	0.72 SQ.MT.
100	1.90 X 0.00 X 1.90	=	0.59 SQ.MT.
101	1.90 X 0.00 X 1.90	=	0.46 SQ.MT.
102	1.90 X 0.00 X 1.90	=	0.33 SQ.MT.
103	1.90 X 0.00 X 1.90	=	0.20 SQ.MT.
104	1.90 X 0.00 X 1.90	=	0.07 SQ.MT.
105	1.90 X 0.00 X 1.90	=	0.00 SQ.MT.
106	1.90 X 0.00 X 1.90	=	0.00 SQ.MT.
107	1.90 X 0.00 X 1.90	=	0.00 SQ.MT.
108	1.90 X 0.00 X 1.90	=	0.00 SQ.MT.
109	1.90 X 0.00 X 1.90	=	0.00 SQ.MT.
110	1.90 X 0.00 X 1.90	=	0.00 SQ.MT.
111	1.90 X 0.00 X 1.90	=	0.00 SQ.MT.
112	1.90 X 0.00 X 1.90	=	0.00 SQ.MT.
113	1.90 X 0.00 X 1.90	=	0.00 SQ.MT.
114	1.90 X 0.00 X 1.90	=	0.00 SQ.MT.
115	1.90 X 0.00 X 1.90	=	0.00 SQ.MT.
116	1.90 X 0.00 X 1.90	=	0.00 SQ.MT.
117	1.90 X 0.00 X 1.90	=	0.00 SQ.MT.
118	1.90 X 0.00 X 1.90	=	0.00 SQ.MT.
119	1.90 X 0.00 X 1.90	=	0.00 SQ.MT.
120	1.90 X 0.00 X 1.90	=	0.00 SQ.MT.
121	1.90 X 0.00 X 1.90	=	0.00 SQ.MT.
122	1.90 X 0.00 X 1.90	=	0.00 SQ.MT.
123	1.90 X 0.00 X 1.90	=	0.00 SQ.MT.
124	1.90 X 0.00 X 1.90	=	0.00 SQ.MT.
125	1.90 X 0.00 X 1.90	=	0.00 SQ.MT.
126	1.90 X 0.00 X 1.90	=	0.00 SQ.MT.
127	1.90 X 0.00 X 1.90	=	0.00 SQ.MT.
128	1.90 X 0.00 X 1.90	=	0.00 SQ.MT.
129	1.90 X 0.00 X 1.90	=	0.00 SQ.MT.
130	1.90 X 0.00 X 1.90	=	0.00 SQ.MT.
131	1.90 X 0.00 X 1.90	=	0.00 SQ.MT.
132	1.90 X 0.00 X 1.90	=	0.00 SQ.MT.
133	1.90 X 0.00 X 1.90	=	0.00 SQ.MT.
134	1.90 X 0.00 X 1.90	=	0.00 SQ.MT.
135	1.90 X 0.00 X 1.90	=	0.00 SQ.MT.
136	1.90 X 0.00 X 1.90	=	0.00 SQ.MT.
137	1.90 X 0.00 X 1.90	=	