

CERTIFIED THAT I HAVE SURVEYED THE PLOT UNDER REFERENCE ON AND THAT THE DIMENSIONS OF THE SIDES ETC. OF THE PLOT STATED OUT IN THIS CERTIFICATE ARE TRUE AND CORRECT AND THE AREA STATED IN THIS CERTIFICATE IS CORRECT AND ACCURATE.

CERTIFICATE OF AREA

MR. ASHIT RAINIKANT SHAH P/A HOLDERS

DEVELOPER SIGN

MR. ASHIT RAINIKANT SHAH P/A HOLDERS

M/S. VPM JAYAL DEVELOPERS

AT VILLAGE TEMGHAR, TALUKA: BHIWANDI, DIST: THANE

HISSA NO. 4/2/4/1/5/1/6

PROPOSED RESIDENTIAL BUILDING LAND BEARING S NO. 4

WING A & B (1) & WING (2)

DESCRIPTION

|     |                        |          |
|-----|------------------------|----------|
| 1   | AREA UNDER REFERENCE   | 12563.87 |
| 2   | EXISTING BUILDING AREA | 12563.87 |
| 3   | PROPOSED BUILDING AREA | 12563.87 |
| 4   | AREA UNDER REFERENCE   | 12563.87 |
| 5   | AREA UNDER REFERENCE   | 12563.87 |
| 6   | AREA UNDER REFERENCE   | 12563.87 |
| 7   | AREA UNDER REFERENCE   | 12563.87 |
| 8   | AREA UNDER REFERENCE   | 12563.87 |
| 9   | AREA UNDER REFERENCE   | 12563.87 |
| 10  | AREA UNDER REFERENCE   | 12563.87 |
| 11  | AREA UNDER REFERENCE   | 12563.87 |
| 12  | AREA UNDER REFERENCE   | 12563.87 |
| 13  | AREA UNDER REFERENCE   | 12563.87 |
| 14  | AREA UNDER REFERENCE   | 12563.87 |
| 15  | AREA UNDER REFERENCE   | 12563.87 |
| 16  | AREA UNDER REFERENCE   | 12563.87 |
| 17  | AREA UNDER REFERENCE   | 12563.87 |
| 18  | AREA UNDER REFERENCE   | 12563.87 |
| 19  | AREA UNDER REFERENCE   | 12563.87 |
| 20  | AREA UNDER REFERENCE   | 12563.87 |
| 21  | AREA UNDER REFERENCE   | 12563.87 |
| 22  | AREA UNDER REFERENCE   | 12563.87 |
| 23  | AREA UNDER REFERENCE   | 12563.87 |
| 24  | AREA UNDER REFERENCE   | 12563.87 |
| 25  | AREA UNDER REFERENCE   | 12563.87 |
| 26  | AREA UNDER REFERENCE   | 12563.87 |
| 27  | AREA UNDER REFERENCE   | 12563.87 |
| 28  | AREA UNDER REFERENCE   | 12563.87 |
| 29  | AREA UNDER REFERENCE   | 12563.87 |
| 30  | AREA UNDER REFERENCE   | 12563.87 |
| 31  | AREA UNDER REFERENCE   | 12563.87 |
| 32  | AREA UNDER REFERENCE   | 12563.87 |
| 33  | AREA UNDER REFERENCE   | 12563.87 |
| 34  | AREA UNDER REFERENCE   | 12563.87 |
| 35  | AREA UNDER REFERENCE   | 12563.87 |
| 36  | AREA UNDER REFERENCE   | 12563.87 |
| 37  | AREA UNDER REFERENCE   | 12563.87 |
| 38  | AREA UNDER REFERENCE   | 12563.87 |
| 39  | AREA UNDER REFERENCE   | 12563.87 |
| 40  | AREA UNDER REFERENCE   | 12563.87 |
| 41  | AREA UNDER REFERENCE   | 12563.87 |
| 42  | AREA UNDER REFERENCE   | 12563.87 |
| 43  | AREA UNDER REFERENCE   | 12563.87 |
| 44  | AREA UNDER REFERENCE   | 12563.87 |
| 45  | AREA UNDER REFERENCE   | 12563.87 |
| 46  | AREA UNDER REFERENCE   | 12563.87 |
| 47  | AREA UNDER REFERENCE   | 12563.87 |
| 48  | AREA UNDER REFERENCE   | 12563.87 |
| 49  | AREA UNDER REFERENCE   | 12563.87 |
| 50  | AREA UNDER REFERENCE   | 12563.87 |
| 51  | AREA UNDER REFERENCE   | 12563.87 |
| 52  | AREA UNDER REFERENCE   | 12563.87 |
| 53  | AREA UNDER REFERENCE   | 12563.87 |
| 54  | AREA UNDER REFERENCE   | 12563.87 |
| 55  | AREA UNDER REFERENCE   | 12563.87 |
| 56  | AREA UNDER REFERENCE   | 12563.87 |
| 57  | AREA UNDER REFERENCE   | 12563.87 |
| 58  | AREA UNDER REFERENCE   | 12563.87 |
| 59  | AREA UNDER REFERENCE   | 12563.87 |
| 60  | AREA UNDER REFERENCE   | 12563.87 |
| 61  | AREA UNDER REFERENCE   | 12563.87 |
| 62  | AREA UNDER REFERENCE   | 12563.87 |
| 63  | AREA UNDER REFERENCE   | 12563.87 |
| 64  | AREA UNDER REFERENCE   | 12563.87 |
| 65  | AREA UNDER REFERENCE   | 12563.87 |
| 66  | AREA UNDER REFERENCE   | 12563.87 |
| 67  | AREA UNDER REFERENCE   | 12563.87 |
| 68  | AREA UNDER REFERENCE   | 12563.87 |
| 69  | AREA UNDER REFERENCE   | 12563.87 |
| 70  | AREA UNDER REFERENCE   | 12563.87 |
| 71  | AREA UNDER REFERENCE   | 12563.87 |
| 72  | AREA UNDER REFERENCE   | 12563.87 |
| 73  | AREA UNDER REFERENCE   | 12563.87 |
| 74  | AREA UNDER REFERENCE   | 12563.87 |
| 75  | AREA UNDER REFERENCE   | 12563.87 |
| 76  | AREA UNDER REFERENCE   | 12563.87 |
| 77  | AREA UNDER REFERENCE   | 12563.87 |
| 78  | AREA UNDER REFERENCE   | 12563.87 |
| 79  | AREA UNDER REFERENCE   | 12563.87 |
| 80  | AREA UNDER REFERENCE   | 12563.87 |
| 81  | AREA UNDER REFERENCE   | 12563.87 |
| 82  | AREA UNDER REFERENCE   | 12563.87 |
| 83  | AREA UNDER REFERENCE   | 12563.87 |
| 84  | AREA UNDER REFERENCE   | 12563.87 |
| 85  | AREA UNDER REFERENCE   | 12563.87 |
| 86  | AREA UNDER REFERENCE   | 12563.87 |
| 87  | AREA UNDER REFERENCE   | 12563.87 |
| 88  | AREA UNDER REFERENCE   | 12563.87 |
| 89  | AREA UNDER REFERENCE   | 12563.87 |
| 90  | AREA UNDER REFERENCE   | 12563.87 |
| 91  | AREA UNDER REFERENCE   | 12563.87 |
| 92  | AREA UNDER REFERENCE   | 12563.87 |
| 93  | AREA UNDER REFERENCE   | 12563.87 |
| 94  | AREA UNDER REFERENCE   | 12563.87 |
| 95  | AREA UNDER REFERENCE   | 12563.87 |
| 96  | AREA UNDER REFERENCE   | 12563.87 |
| 97  | AREA UNDER REFERENCE   | 12563.87 |
| 98  | AREA UNDER REFERENCE   | 12563.87 |
| 99  | AREA UNDER REFERENCE   | 12563.87 |
| 100 | AREA UNDER REFERENCE   | 12563.87 |

SR NO. TITLE

NET PLOT CALCULATION - EXAMPLE

PERFORMA

AREA OF PLOT

AREA UNDER REFERENCE

AREA UNDER REFERENCE

AREA UNDER REFERENCE

AREA UNDER REFERENCE

AREA UNDER REFERENCE

AREA UNDER REFERENCE

AREA UNDER REFERENCE

AREA UNDER REFERENCE

AREA UNDER REFERENCE

AREA UNDER REFERENCE

AREA UNDER REFERENCE

AREA UNDER REFERENCE

AREA UNDER REFERENCE

AREA UNDER REFERENCE

AREA UNDER REFERENCE

AREA UNDER REFERENCE

AREA UNDER REFERENCE

AREA UNDER REFERENCE

AREA UNDER REFERENCE

| S.NO. | BASE  | HEIGHT | AREA (INSQ MTR.) |
|-------|-------|--------|------------------|
| 1     | 5.00  | 0.14   | 0.70             |
| 2     | 6.75  | 0.14   | 0.95             |
| 3     | 11.50 | 0.14   | 1.61             |
| 4     | 12.17 | 0.14   | 1.70             |
| 5     | 19.20 | 0.14   | 2.69             |
| 6     | 35.50 | 0.14   | 5.07             |
| 7     | 35.80 | 0.14   | 5.08             |
| 8     | 36.35 | 0.14   | 5.11             |
| 9     | 37.06 | 0.14   | 5.20             |
| 10    | 39.80 | 0.14   | 5.57             |
| 11    | 41.00 | 0.14   | 5.74             |
| 12    | 43.50 | 0.14   | 6.10             |
| 13    | 45.60 | 0.14   | 6.39             |
| 14    | 49.50 | 0.14   | 6.93             |
| 15    | 49.60 | 0.14   | 6.94             |
| 16    | 50.50 | 0.14   | 7.07             |
| 17    | 50.50 | 0.14   | 7.07             |
| 18    | 50.50 | 0.14   | 7.07             |
| 19    | 50.50 | 0.14   | 7.07             |
| 20    | 50.50 | 0.14   | 7.07             |
| 21    | 50.50 | 0.14   | 7.07             |
| 22    | 50.50 | 0.14   | 7.07             |
| 23    | 50.50 | 0.14   | 7.07             |
| 24    | 50.50 | 0.14   | 7.07             |
| 25    | 50.50 | 0.14   | 7.07             |
| 26    | 50.50 | 0.14   | 7.07             |
| 27    | 50.50 | 0.14   | 7.07             |
| 28    | 50.50 | 0.14   | 7.07             |
| 29    | 50.50 | 0.14   | 7.07             |
| 30    | 50.50 | 0.14   | 7.07             |
| 31    | 50.50 | 0.14   | 7.07             |
| 32    | 50.50 | 0.14   | 7.07             |
| 33    | 50.50 | 0.14   | 7.07             |
| 34    | 50.50 | 0.14   | 7.07             |
| 35    | 50.50 | 0.14   | 7.07             |
| 36    | 50.50 | 0.14   | 7.07             |
| 37    | 50.50 | 0.14   | 7.07             |
| 38    | 50.50 | 0.14   | 7.07             |
| 39    | 50.50 | 0.14   | 7.07             |
| 40    | 50.50 | 0.14   | 7.07             |
| 41    | 50.50 | 0.14   | 7.07             |
| 42    | 50.50 | 0.14   | 7.07             |
| 43    | 50.50 | 0.14   | 7.07             |
| 44    | 50.50 | 0.14   | 7.07             |
| 45    | 50.50 | 0.14   | 7.07             |
| 46    | 50.50 | 0.14   | 7.07             |
| 47    | 50.50 | 0.14   | 7.07             |
| 48    | 50.50 | 0.14   | 7.07             |
| 49    | 50.50 | 0.14   | 7.07             |
| 50    | 50.50 | 0.14   | 7.07             |
| 51    | 50.50 | 0.14   | 7.07             |
| 52    | 50.50 | 0.14   | 7.07             |
| 53    | 50.50 | 0.14   | 7.07             |
| 54    | 50.50 | 0.14   | 7.07             |
| 55    | 50.50 | 0.14   | 7.07             |
| 56    | 50.50 | 0.14   | 7.07             |
| 57    | 50.50 | 0.14   | 7.07             |
| 58    | 50.50 | 0.14   | 7.07             |
| 59    | 50.50 | 0.14   | 7.07             |
| 60    | 50.50 | 0.14   | 7.07             |
| 61    | 50.50 | 0.14   | 7.07             |
| 62    | 50.50 | 0.14   | 7.07             |
| 63    | 50.50 | 0.14   | 7.07             |
| 64    | 50.50 | 0.14   | 7.07             |
| 65    | 50.50 | 0.14   | 7.07             |
| 66    | 50.50 | 0.14   | 7.07             |
| 67    | 50.50 | 0.14   | 7.07             |
| 68    | 50.50 | 0.14   | 7.07             |
| 69    | 50.50 | 0.14   | 7.07             |
| 70    | 50.50 | 0.14   | 7.07             |
| 71    | 50.50 | 0.14   | 7.07             |
| 72    | 50.50 | 0.14   | 7.07             |
| 73    | 50.50 | 0.14   | 7.07             |
| 74    | 50.50 | 0.14   | 7.07             |
| 75    | 50.50 | 0.14   | 7.07             |
| 76    | 50.50 | 0.14   | 7.07             |
| 77    | 50.50 | 0.14   | 7.07             |
| 78    | 50.50 | 0.14   | 7.07             |
| 79    | 50.50 | 0.14   | 7.07             |
| 80    | 50.50 | 0.14   | 7.07             |
| 81    | 50.50 | 0.14   | 7.07             |
| 82    | 50.50 | 0.14   | 7.07             |
| 83    | 50.50 | 0.14   | 7.07             |
| 84    | 50.50 | 0.14   | 7.07             |
| 85    | 50.50 | 0.14   | 7.07             |
| 86    | 50.50 | 0.14   | 7.07             |
| 87    | 50.50 | 0.14   | 7.07             |
| 88    | 50.50 | 0.14   | 7.07             |
| 89    | 50.50 | 0.14   | 7.07             |
| 90    | 50.50 | 0.14   | 7.07             |
| 91    | 50.50 | 0.14   | 7.07             |
| 92    | 50.50 | 0.14   | 7.07             |
| 93    | 50.50 | 0.14   | 7.07             |
| 94    | 50.50 | 0.14   | 7.07             |
| 95    | 50.50 | 0.14   | 7.07             |
| 96    | 50.50 | 0.14   | 7.07             |
| 97    | 50.50 | 0.14   | 7.07             |
| 98    | 50.50 | 0.14   | 7.07             |
| 99    | 50.50 | 0.14   | 7.07             |
| 100   | 50.50 | 0.14   | 7.07             |

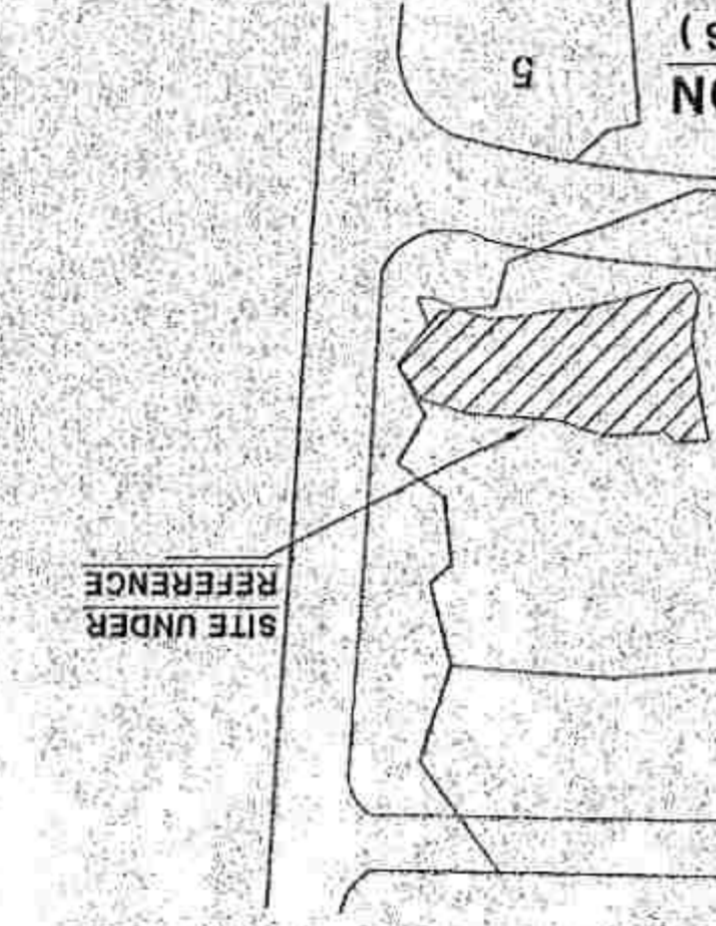

| WING               | AREA             |
|--------------------|------------------|
| WING A & B         | 381.06 SQ.MTR.   |
| BIDG TOTAL BU AREA | 8722.81 SQ.MTR.  |
| TOTAL BU AREA      | 12563.87 SQ.MTR. |

| S.NO. | BASE  | HEIGHT | AREA (INSQ MTR.) |
|-------|-------|--------|------------------|
| 1     | 5.00  | 0.14   | 0.70             |
| 2     | 6.75  | 0.14   | 0.95             |
| 3     | 11.50 | 0.14   | 1.61             |
| 4     | 12.17 | 0.14   | 1.70             |
| 5     | 19.20 | 0.14   | 2.69             |
| 6     | 35.50 | 0.14   | 5.07             |
| 7     | 35.80 | 0.14   | 5.08             |
| 8     | 36.35 | 0.14   | 5.11             |
| 9     | 37.06 | 0.14   | 5.20             |
| 10    | 39.80 | 0.14   | 5.57             |
| 11    | 41.00 | 0.14   | 5.74             |
| 12    | 43.50 | 0.14   | 6.10             |
| 13    | 45.60 | 0.14   | 6.39             |
| 14    | 49.50 | 0.14   | 6.93             |
| 15    | 49.60 | 0.14   | 6.94             |
| 16    | 50.50 | 0.14   | 7.07             |
| 17    | 50.50 | 0.14   | 7.07             |
| 18    | 50.50 | 0.14   | 7.07             |
| 19    | 50.50 | 0.14   | 7.07             |
| 20    | 50.50 | 0.14   | 7.07             |
| 21    | 50.50 | 0.14   | 7.07             |
| 22    | 50.50 | 0.14   | 7.07             |
| 23    | 50.50 | 0.14   | 7.07             |
| 24    | 50.50 | 0.14   | 7.07             |
| 25    | 50.50 | 0.14   | 7.07             |
| 26    | 50.50 | 0.14   | 7.07             |
| 27    | 50.50 | 0.14   | 7.07             |
| 28    | 50.50 | 0.14   | 7.07             |
| 29    | 50.50 | 0.14   | 7.07             |
| 30    | 50.50 | 0.14   | 7.07             |
| 31    | 50.50 | 0.14   | 7.07             |
| 32    | 50.50 | 0.14   | 7.07             |
| 33    | 50.50 | 0.14   | 7.07             |
| 34    | 50.50 | 0.14   | 7.07             |
| 35    | 50.50 | 0.14   | 7.07             |
| 36    | 50.50 | 0.14   | 7.07             |
| 37    | 50.50 | 0.14   | 7.07             |
| 38    | 50.50 | 0.14   | 7.07             |
| 39    | 50.50 | 0.14   | 7.07             |
| 40    | 50.50 | 0.14   | 7.07             |
| 41    | 50.50 | 0.14   | 7.07             |
| 42    | 50.50 | 0.14   | 7.07             |
| 43    | 50.50 | 0.14   | 7.07             |
| 44    | 50.50 | 0.14   | 7.07             |
| 45    | 50.50 | 0.14   | 7.07             |
| 46    | 50.50 | 0.14   | 7.07             |
| 47    | 50.50 | 0.14   | 7.07             |
| 48    | 50.50 | 0.14   | 7.07             |
| 49    | 50.50 | 0.14   | 7.07             |
| 50    | 50.50 | 0.14   | 7.07             |
| 51    | 50.50 | 0.14   | 7.07             |
| 52    | 50.50 | 0.14   | 7.07             |
| 53    | 50.50 | 0.14   | 7.07             |
| 54    | 50.50 | 0.14   | 7.07             |
| 55    | 50.50 | 0.14   | 7.07             |
| 56    | 50.50 | 0.14   | 7.07             |
| 57    | 50.50 | 0.14   | 7.07             |
| 58    | 50.50 | 0.14   | 7.07             |
|       |       |        |                  |