



Vastu/Mumbai/03/2024/7918/2305798
29/8-546 MRUP
Date: 29.03.2024

TO WHOMSOEVER IT MAY CONCERN

This is to certify that we have carried out actual site measurements on request of our Client **Visawa Co-operative housing society**. For Flat No. 602, A- Wing, Visawa Co-operative housing society, Bldg. no. 30, D N Nagar, New Link Road, Andheri West, Mumbai- 400053, State - Maharashtra, Country – India and found that the **Mofa Carpet Area (Usable Carpet Area) = 511.43 Sq. Ft. i.e., 47.51 Sq. M.**

For Vastukala Consultants (I) Pvt. Ltd.

Manoj
Chalikwar

Digitally signed by Manoj Chalikwar
DN: cn=Manoj Chalikwar, o=Vastukala
Consultants (I) Pvt. Ltd., ou=Mumbai,
email=manoj@vastukala.org, c=IN
Date: 2024.03.29 14:06:35 +05'30'



Manoj B. Chalikwar
Registered Valuer
Chartered Engineer (India)
Reg. No. CAT-IF-1763

Think.Innovate.Create



Our Pan India Presence at :

- | | | | |
|-----------|------------|-----------|--------|
| Mumbai | Aurangabad | Pune | Rajkot |
| Thane | Nanded | Indore | Raipur |
| Delhi NCR | Nashik | Ahmedabad | Jaipur |

Regd. Office : B1-001, U/B Floor, Boomerang,
Chandivali Farm Road, Andheri (East),
Mumbai - 400 072, (M.S.), INDIA
TeleFax : +91 22 28371325/24
mumbai@vastukala.org

ANNEXURE

FLAT NO. 602- SITE MEASUREMENTS					
SR.NO.	ROOM	LENGTH IN M	WIDTH IN M	AREA IN SQ.M.	AREA IN SQ.FT.
1	Living room - Part-1	2.70	0.73	1.97	21.19
2	Living room - Part-2	2.65	2.26	6.00	64.63
3	Living room - Part-3	2.70	1.43	3.86	41.60
4	Living room door jamb	1.02	0.33	0.34	3.61
5	Living room Dining	2.21	1.80	3.99	42.94
6	Kitchen - Part-1	1.45	2.47	3.59	38.68
7	Kitchen - Part-2	0.61	2.46	1.50	16.13
8	Kitchen door jamb	0.83	0.16	0.13	1.43
9	Bedroom - Part-1	2.61	2.20	5.73	61.71
10	Bedroom - Part-2	2.68	1.40	3.74	40.25
11	Bedroom door jamb	0.91	0.12	0.11	1.17
12	Common Toilet	1.78	1.14	2.04	21.94
13	Common Toilet door jamb	0.69	0.14	0.10	1.06
14	Master Bedroom Part-1	3.62	3.04	10.97	118.13
15	Master Bedroom Part-2	0.90	0.47	0.42	4.56
16	Mater Bedroom door jamb	0.90	0.12	0.11	1.16
17	Passage in Master Bedroom	0.85	0.73	0.62	6.69
18	Utility in Master Bedroom	0.74	0.45	0.33	3.54
19	Master Bedroom Toilet	1.78	1.04	1.85	19.90
20	Master Bedroom Toilet balance	0.49	0.07	0.03	0.37
21	Master Bedroom Toilet door jamb	0.68	0.10	0.07	0.74
	Total Mofa Carpet Area (Usable area)			47.51	511.43

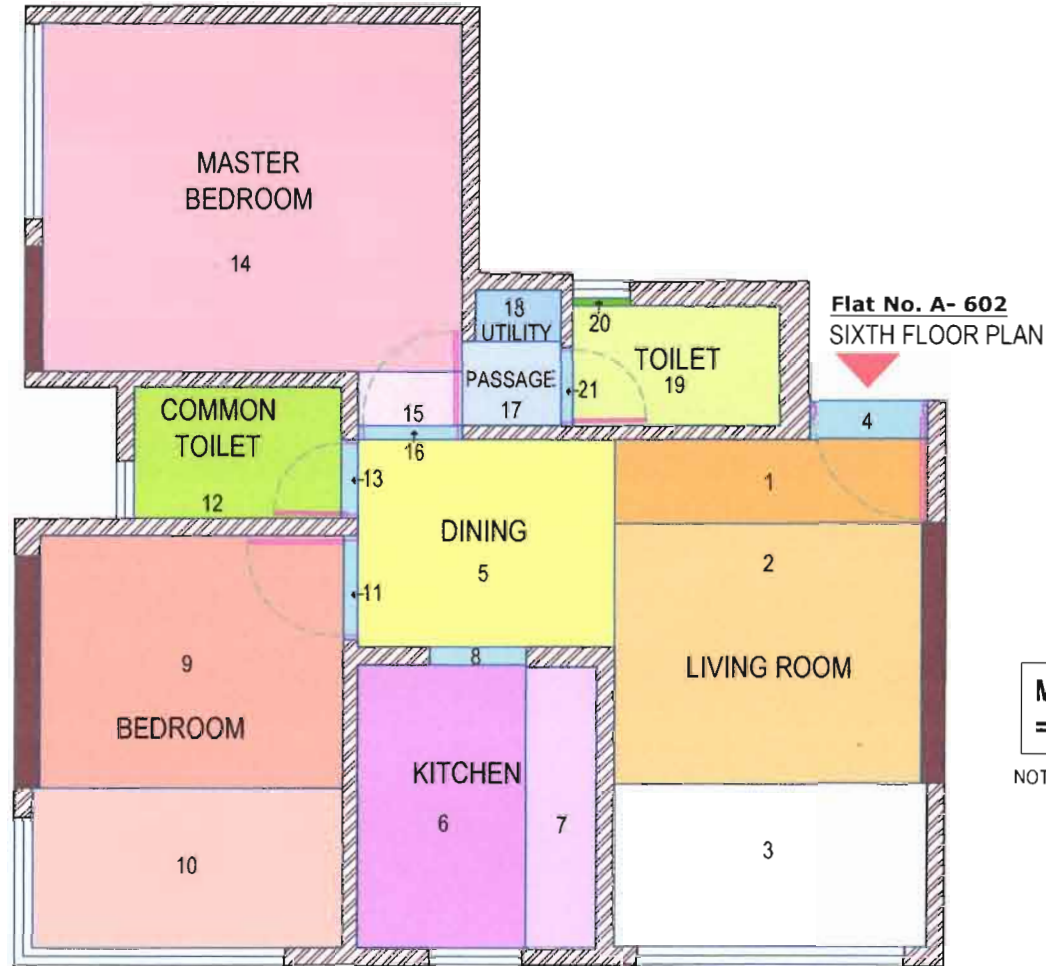

Mofa Carpet Area (Usable carpet area)
= 511.43 Sq. Ft. i.e. 47.51 Sq.M.

NOTE - PLEASE REFER ANNEXURE 602 FOR MEASUREMENTS



Name Of Client: Visawa Co-operative housing society.
Address: Flat No.602, A- Wing, Visawa Co-operative housing society, Bldg. no. 30, D N Nagar, New Link road, Andheri West, Mumbai- 400053, State - Maharashtra, Country - India.
Project name-"Aadhayay".

Signed By: Er. Manoj Chalikwar
Checked By : Er. Umang Patel
Drawing By : Ar. Meetali Rasal
Site inspection and Measurements By :
Ar. Meetali Rasal & Er. Saiprasad Patil
Date : 29/ 03/ 2024

Think.Innovate.Create
VASTUKALA CONSULTANTS (I) PVT. LTD

REGD. OFFICE:
Mumbai : Vastukala Consultants (I) Pvt. Ltd., Unit No. B1-001, Upper Basement Floor, Boomrang, Chandivali Farm Road, Powai, Andheri (East) Mumbai - 400 072 , State - Maharashtra, Country - INDIA.
Tel:- +91 2247495919