

APPROVED
 DEMARCATED FINAL LAYOUT AS AMENDED
 IN THE CASE OF CONDITIONS MENTIONED IN THE
 LETTER NO. AN/MS/CI/25 DT 24/11/2015
 VIEW OF SANCTIONED 7/12 (BY 7/12) OF THE
 MUNICIPAL CORPORATION NASHIK AND TOWN PLANNING
 ACT 1966.

54
 ASSISTANT DIRECTOR OF TOWN PLANNING
 MUNICIPAL CORPORATION
 NASHIK

AREA STATEMENT

| | |
|---|---------------------|
| AREA AS PER 7/12 | = 1,01,000.00 sq.m. |
| AREA UNDER LAYOUT NO.3 | = 40,228.16 sq.m. |
| AREA UNDER D.P. ROAD | = 6,000.00 sq.m. |
| AREA UNDER EXCESS D.P. ROAD WIDENING AS PER ALIGNMENT | = 0,720.90 sq.m. |
| AREA UNDER DEVELOPMENT (LAYOUT NO.3) | = 33,507.26 sq.m. |
| AREA UNDER OPEN SPACE | = 12,500.00 sq.m. |
| AREA UNDER M.S.B. | = 625.00 sq.m. |
| AREA UNDER ROADS | = 7,232.62 sq.m. |
| AREA UNDER PLOTS | = 24,399.14 sq.m. |

NOTES:

- THE REQUIRED OPEN SPACE OF THIS LAYOUT NO.3 IS 3751.00 SQ.M. OF WHICH PARTLY 1250.00 IS KEPT IN THIS LAYOUT.
- THE REQUIRED OPEN SPACE OF TOTAL LAND IS 9428.00 SQ.M. OUT OF THAT PARTLY 8177.50 IS KEPT ON SOUTH SIDE OF THE PROPOSED LAYOUT NO.3 IN ADJ. LAYOUT OF S.NO.148 (PLANNING UNIT) U.E. 1250.00 SQ.M. IS KEPT IN THIS PROPOSED LAYOUT.
- REQUIRED THE M.S.B. AREA OF TOTAL LAYOUT IS KEPT IN THIS LAYOUT NO.3 OF PROPOSED LAYOUT.
- THE AMENITY OF PROPOSED LAYOUT NO.1, 1875.50 SQ.M. IS KEPT ON SOUTH SIDE OF PROPOSED LAYOUT NO.1.

| | | | | | | | | | |
|--|------------------------|-----------------------|-----------------------|---------------------------|---------------------------|---------------------------|----------------------------|----------------------|--------------------------|
| MR. NISHAT V. SHAH | MR. MUKESH J. JENAWANI | MR. DEEPAK S. HOYMANI | MR. BRUNER R. MADWANI | MR. RAJESH M. KHEMANI | MR. ADITYA J. BHATAMBEKAR | MR. SAJENDRA P. SHAH | MR. YUSUF S. SHAH | MR. ANKUR S. KASIWAL | MR. KANAYALAL C. MANWANI |
| MR. HANDESH G. GUJARATHI | MR. KALASH H. PAIL | MR. PREMRAJ M. BOTEHA | MR. SANTOSH H. BOTEHA | MR. DEEPAK S. BHATAMBEKAR | MR. DEEPAK S. BHATAMBEKAR | MR. SANJAY B. BHATAMBEKAR | MR. VIKRANT V. BHATAMBEKAR | MR. SHREK S. SURANA | MR. AVINASH G. KOTHAWADE |
| OWNERS SIGNATURE ARCHITECT'S SIGNATURE | | | | | | | | | |
| OWNER : MR. DINESH K. MANWANI AND OTHERS | | | | | | | | | |
| PROJECT : PROJECT DEMARCATED FINAL LAYOUT IN S. NO. 163 (P) AS PER 7/12 EXTRACT (LAYOUT 3) & 163/1 AS PER TLR MAP, NASHIK SHIVAR, FOR MR. DINESH K. MANWANI & OTHERS | | | | | | | | | |
| TITLE : MUNICIPAL DRAWING | | | | | | | | | |
| CONSULTING ARCHITECT : AVINASH KOTHAWADE | | | | | | | | | |
| 15, SHREELAXI, JAYWADI COLONY, NASHIK | | | | | | | | | |
| PHONE: 223273 | | | | | | | | | |
| STATUS : SUBMISSION DRAWING | | | | | | | | | |
| DATE : 17/10/2015 | | | | | | | | | |
| SCALE : 1:750 | | | | | | | | | |
| DRAWN BY : AGF | | | | | | | | | |
| JOB NO. | | | | | | | | | |
| DRC. NO. | | | | | | | | | |

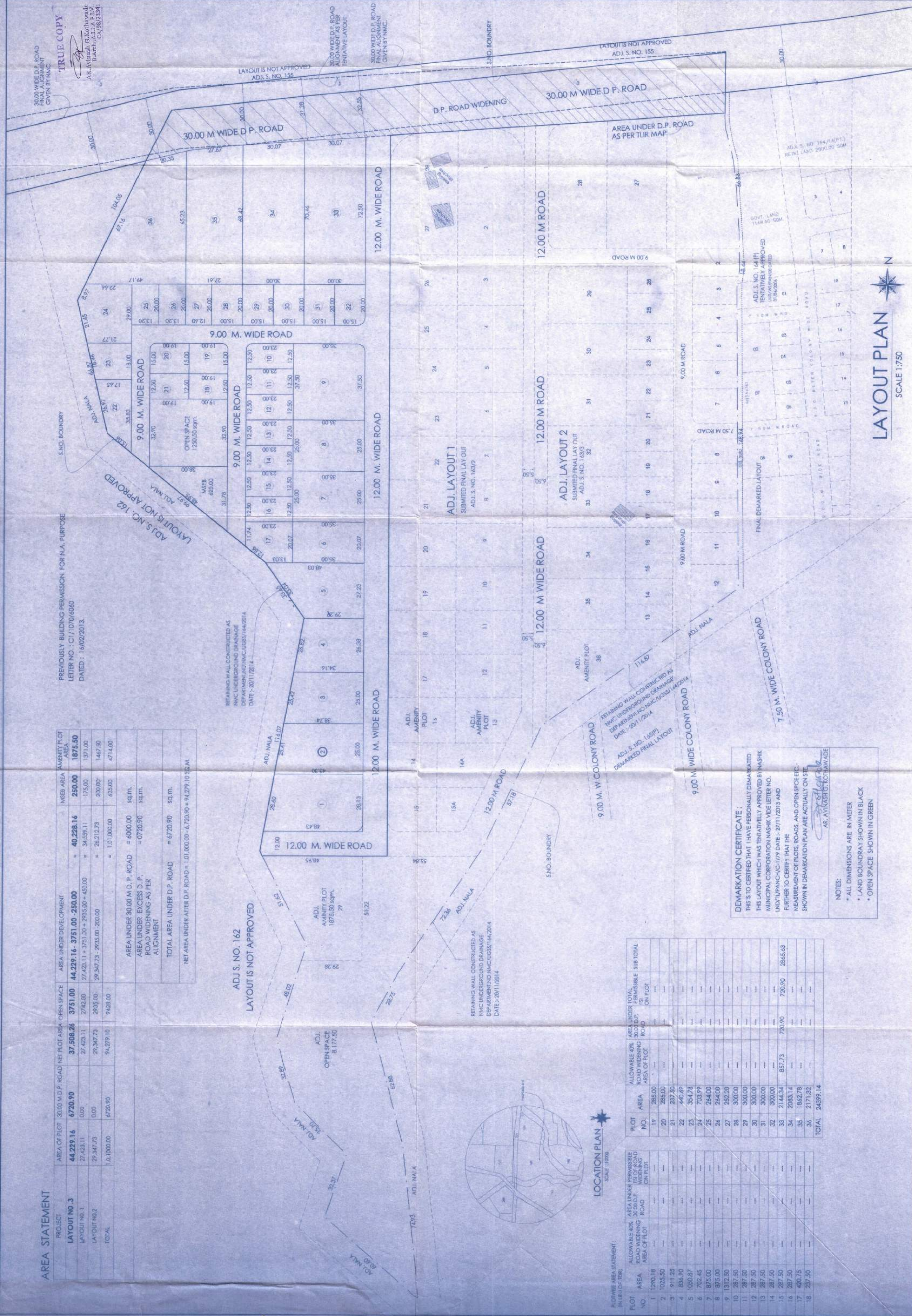

PREVIOUSLY BUILDING PERMISSION FOR N.A. PURPOSE
 LETTER NO. : CI/1070/6600
 DATED : 16/02/2013.

AREA STATEMENT

| PROJECT | AREA OF PLOT | 30.00 M D.P. ROAD | NET PLOT AREA | OPEN SPACE | AREA UNDER DEVELOPMENT | M.S.B. AREA | AMENITY PLOT AREA |
|-------------|--------------|-------------------|---------------|------------|--|-------------|-------------------|
| LAYOUT NO.3 | 44,229.16 | 6,720.90 | 37,508.26 | 3,751.00 | 40,228.16 | 250.00 | 1,875.50 |
| LAYOUT NO.1 | 27,423.11 | 0.00 | 27,423.11 | 2,742.00 | 27,423.11 + 3,751.00 + 2,935.00 + 450.00 | 175.00 | 1,371.00 |
| LAYOUT NO.2 | 29,347.73 | 0.00 | 29,347.73 | 2,935.00 | 29,347.73 + 2,935.00 + 2,000.00 | 200.00 | 1,402.50 |
| TOTAL | 1,01,000.00 | 6,720.90 | 94,279.10 | 9,428.00 | 1,01,000.00 | 625.00 | 4,714.00 |

AREA UNDER 30.00 M D.P. ROAD = 6,000.00 sq.m.
 AREA UNDER EXCESS D.P. ROAD WIDENING AS PER ALIGNMENT = 0,720.90 sq.m.
 TOTAL AREA UNDER D.P. ROAD = 6,720.90 sq.m.
 NET AREA UNDER D.P. ROAD = 1,01,000.00 - 6,720.90 = 94,279.10 SQ.M.

AREA STATEMENT

| PROJECT | ALLOWABLE 4% ROAD WIDENING ROAD AREA OF PLOT | AREA UNDER PERMISSIBLE 30.00 D.P. ROAD WIDENING ROAD | AREA UNDER DEVELOPMENT | NET PLOT AREA | OPEN SPACE | AREA UNDER DEVELOPMENT | M.S.B. AREA | AMENITY PLOT AREA | | | | | | | | | | | | | | | | | | | | | | | | | | |
|---------|--|--|------------------------|---------------|------------|------------------------|-------------|-------------------|---|--------|---|--------|---|--------|---|---------|----|--------|----|--------|----|--------|----|--------|----|--------|----|--------|----|--------|----|--------|----|--------|
| 1 | 1290.18 | 1025.50 | 3 | 911.25 | 4 | 834.90 | 5 | 1050.87 | 6 | 702.45 | 7 | 875.00 | 8 | 875.00 | 9 | 1312.50 | 10 | 287.50 | 11 | 287.50 | 12 | 287.50 | 13 | 287.50 | 14 | 287.50 | 15 | 287.50 | 16 | 287.50 | 17 | 400.75 | 18 | 287.50 |
| TOTAL | | 24997.14 | 28645.63 | 2144.34 | 20833.14 | 18627.8 | 2171.32 | 24997.14 | | | | | | | | | | | | | | | | | | | | | | | | | | |

DEMARCATED FINAL LAYOUT

| PLOT NO. | AREA | ALLOWABLE 4% ROAD WIDENING ROAD AREA OF PLOT | AREA UNDER PERMISSIBLE 30.00 D.P. ROAD WIDENING ROAD | AREA UNDER DEVELOPMENT | NET PLOT AREA | OPEN SPACE | AREA UNDER DEVELOPMENT | M.S.B. AREA | AMENITY PLOT AREA | | | | | | | | | | | | | | | | | | | | | | | | | | |
|----------|--------|--|--|------------------------|---------------|------------|------------------------|-------------|-------------------|----|--------|----|--------|----|--------|----|--------|----|--------|----|--------|----|--------|----|--------|----|--------|----|---------|----|----------|----|---------|----|---------|
| 19 | 285.00 | 20 | 285.00 | 21 | 237.50 | 22 | 440.69 | 23 | 354.78 | 24 | 703.99 | 25 | 284.00 | 26 | 284.00 | 27 | 282.20 | 28 | 300.00 | 29 | 300.00 | 30 | 300.00 | 31 | 300.00 | 32 | 300.00 | 33 | 2144.34 | 34 | 20833.14 | 35 | 18627.8 | 36 | 2171.32 |
| TOTAL | | 24997.14 | 28645.63 | 2144.34 | 20833.14 | 18627.8 | 2171.32 | 24997.14 | | | | | | | | | | | | | | | | | | | | | | | | | | | |

DEMARCATION CERTIFICATE:
 THIS IS TO CERTIFY THAT I HAVE PERSONALLY DEMARCATED THIS LAYOUT WHICH WAS TENTATIVELY APPROVED BY NASHIK MUNICIPAL CORPORATION NASHIK, VIDE LETTER NO. IN/CI/PANC/CI-179 DATE:- 27/11/2015 AND FURTHER TO CERTIFY THAT THE MEASUREMENT OF PLOTS, ROADS, AND OPEN SPACE ETC. SHOWN IN DEMARCATION PLAN ARE ACTUALLY ON SITE.

AVINASH G. KOTHAWADE

NOTES:

- ALL DIMENSIONS ARE IN METER
- LAND BOUNDARY SHOWN IN BLACK
- OPEN SPACE SHOWN IN GREEN



ADJ. LAYOUT 1
 SUBMITTED FINAL LAYOUT
 ADJ. S. NO. 163/2

ADJ. LAYOUT 2
 SUBMITTED FINAL LAYOUT
 ADJ. S. NO. 163/3

RETAINING WALL CONSTRUCTED AS PER NMC UNDERGROUND DRAINAGE DEPARTMENT NO. AN/CI/US/14/2014 DATE:- 20/11/2014

RETAINING WALL CONSTRUCTED AS PER NMC UNDERGROUND DRAINAGE DEPARTMENT NO. AN/CI/US/14/2014 DATE:- 20/11/2014

ADJ. S. NO. 162
 LAYOUT IS NOT APPROVED

ADJ. S. NO. 164 (P)
 TENTATIVELY APPROVED

ADJ. S. NO. 165 (P)
 DEMARCATED FINAL LAYOUT

LAYOUT PLAN
 SCALE 1:750