

BUILT UP AREA CALCULATION FOR TYPICAL FLOOR (TOWER-1) (20TH & 22ND TO 25TH FLOOR)

UNITS	NO. OF UNITS	DIMENSION IN METER	AREA IN SQ. M.
1	2	5.00 X 3.43	34.3
2	1	2.65 X 1.65	4.37
3	1	8.95 X 2.90	25.96
4	2	0.60 X 0.30	0.36
5	1	7.75 X 2.55	19.76
6	2	2.55 X 2.10	10.71
7	1	3.95 X 0.30	1.19
8	2	2.75 X 0.45	2.48
9	2	0.23 X 2.70	1.24
10	1	0.30 X 1.85	0.56
11	1	2.20 X 2.15	4.73
12	1	0.30 X 12.25	3.68
13	4	1.35 X 2.45	13.23
14	2	3.65 X 3.35	24.46
15	2	4.50 X 3.65	32.85
16	1	4.85 X 6.25	30.31
17	1	2.10 X 7.75	16.28
TOTAL			585.70

18	1	2.75 X 0.30	0.83
19	1	2.75 X 3.15	8.66
20	1	0.23 X 2.50	0.58
21	1	1.80 X 15.15	27.27
22	1	0.15 X 3.20	0.48
23	1	0.15 X 2.15	0.32
24	1	4.35 X 11.15	48.50
25	1	2.10 X 8.65	18.17
26	2	1.35 X 3.50	9.45
27	2	1.35 X 2.75	7.43
28	2	3.95 X 3.35	26.47
29	2	4.80 X 3.65	35.04
30	1	6.15 X 6.25	38.44
31	1	8.65 X 2.40	20.76
32	2	2.75 X 1.35	7.43
33	2	3.35 X 3.95	26.47
34	2	3.65 X 4.80	35.04
35	2	3.50 X 1.35	9.45
36	1	6.25 X 6.15	38.44
TOTAL			527.67

BUILT UP AREA CALCULATION FOR REFUGE FLOOR (TOWER-1) (21ST FLOOR)

UNITS	NO. OF UNITS	DIMENSION IN METER	AREA IN SQ. M.
1	2	5.00 X 3.43	34.30
2	1	2.65 X 1.65	4.37
3	1	8.95 X 2.90	25.96
4	2	0.60 X 0.30	0.36
5	1	7.75 X 2.55	19.76
6	2	2.55 X 2.10	10.71
7	1	3.95 X 0.30	1.19
8	2	2.75 X 0.45	2.48
9	2	0.23 X 2.70	1.24
10	1	0.30 X 1.85	0.56
11	1	2.20 X 2.15	4.73
12	1	0.30 X 12.25	3.68
13	4	1.35 X 2.45	13.23
14	2	3.65 X 3.35	24.46
15	2	4.50 X 3.65	32.85
16	1	4.85 X 6.25	30.31
17	1	2.10 X 7.75	16.28
18	1	2.75 X 0.30	0.83
TOTAL			529.48

EXCESS REFUGE AREA TO BE COUNTED IN F.S.I. 1.81 SQ.MT.  
TOTAL ADDITION 529.48 SQ.MT.

REFUGE AREA CALCULATION FOR REFUGE FLOOR (TOWER-1) (21ST FLOOR)

UNITS	NO. OF UNITS	DIMENSION IN METER	AREA IN SQ. M.
A	1	4.85 X 3.05	14.79
B	1	2.10 X 3.80	7.98
C	2	1.35 X 2.45	6.60
D	1	4.50 X 3.65	16.43
E	1	3.65 X 3.35	12.23
TOTAL			58.03

REFUGE AREA REQUIRED (TOWER-1)  $\{585.70 \times 2 = 1171.40 / 12.50 = 93.71 \times 0.30\} \times 2 = 56.22 \text{ SQ.MT.}$   
REFUGE AREA PROPOSED = 58.03 SQ.MT.  
EXCESS REFUGE AREA TO BE COUNTED IN F.S.I.  $\{58.03 - 56.22\} = 1.81 \text{ SQ.MT.}$

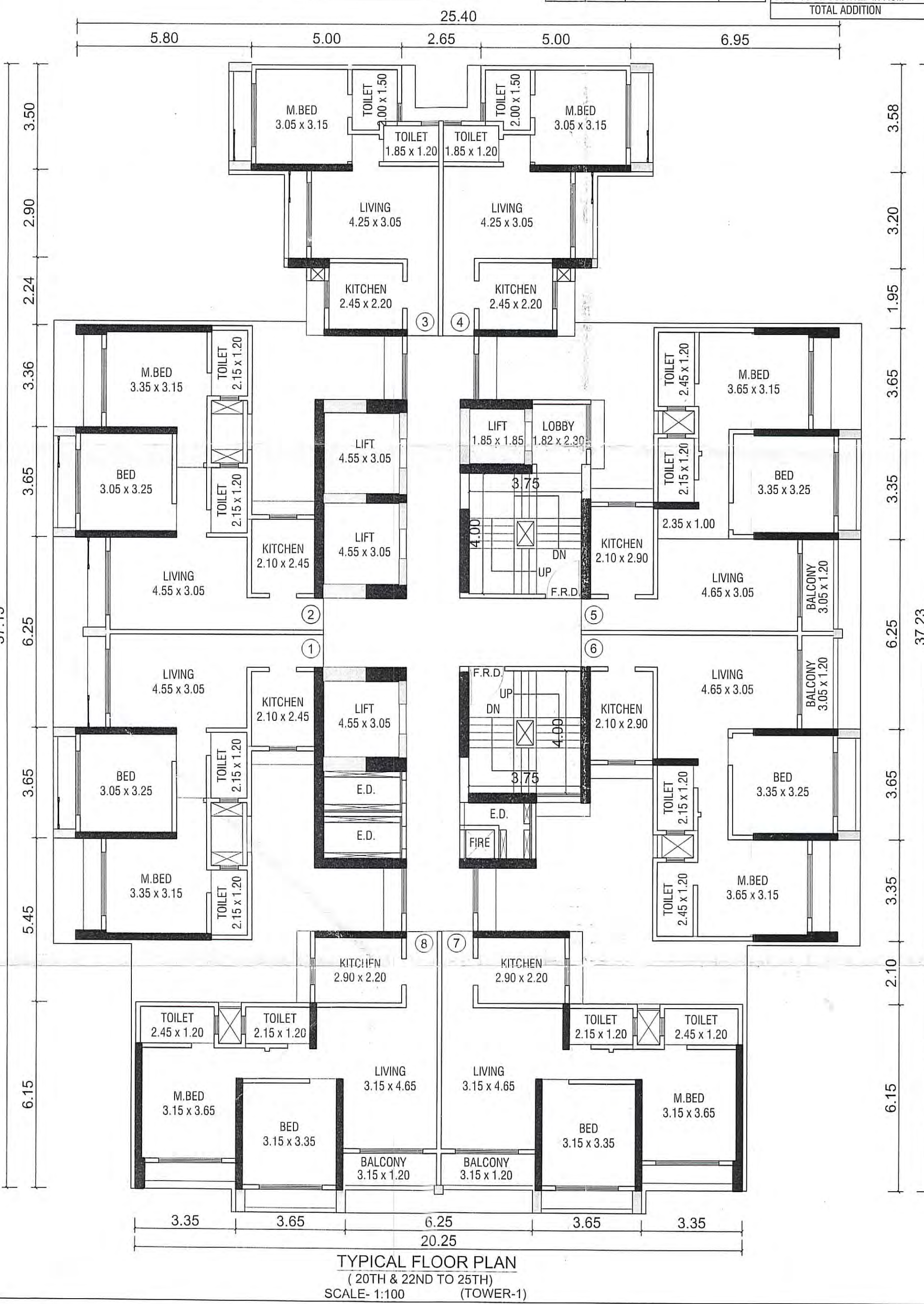

TYPICAL FLOOR PLAN (20TH & 22ND TO 25TH) SCALE: 1:100 (TOWER-1)

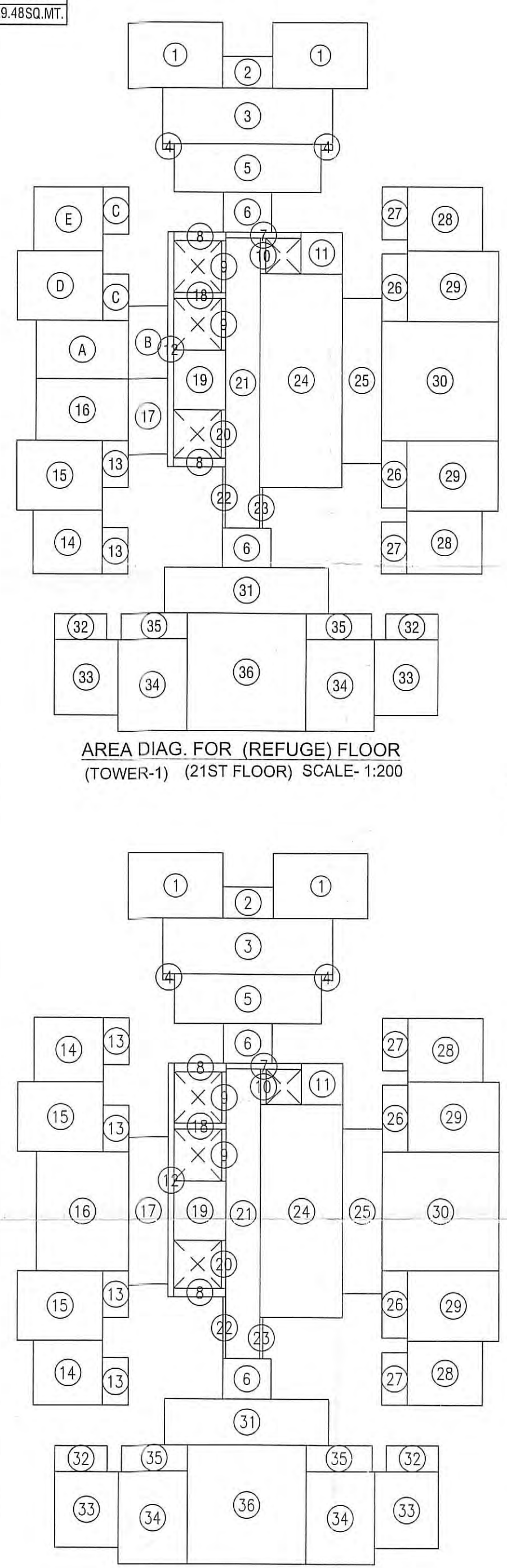

AREA DIAG. FOR (REFUGE) FLOOR (TOWER-1) (21ST FLOOR) SCALE: 1:200

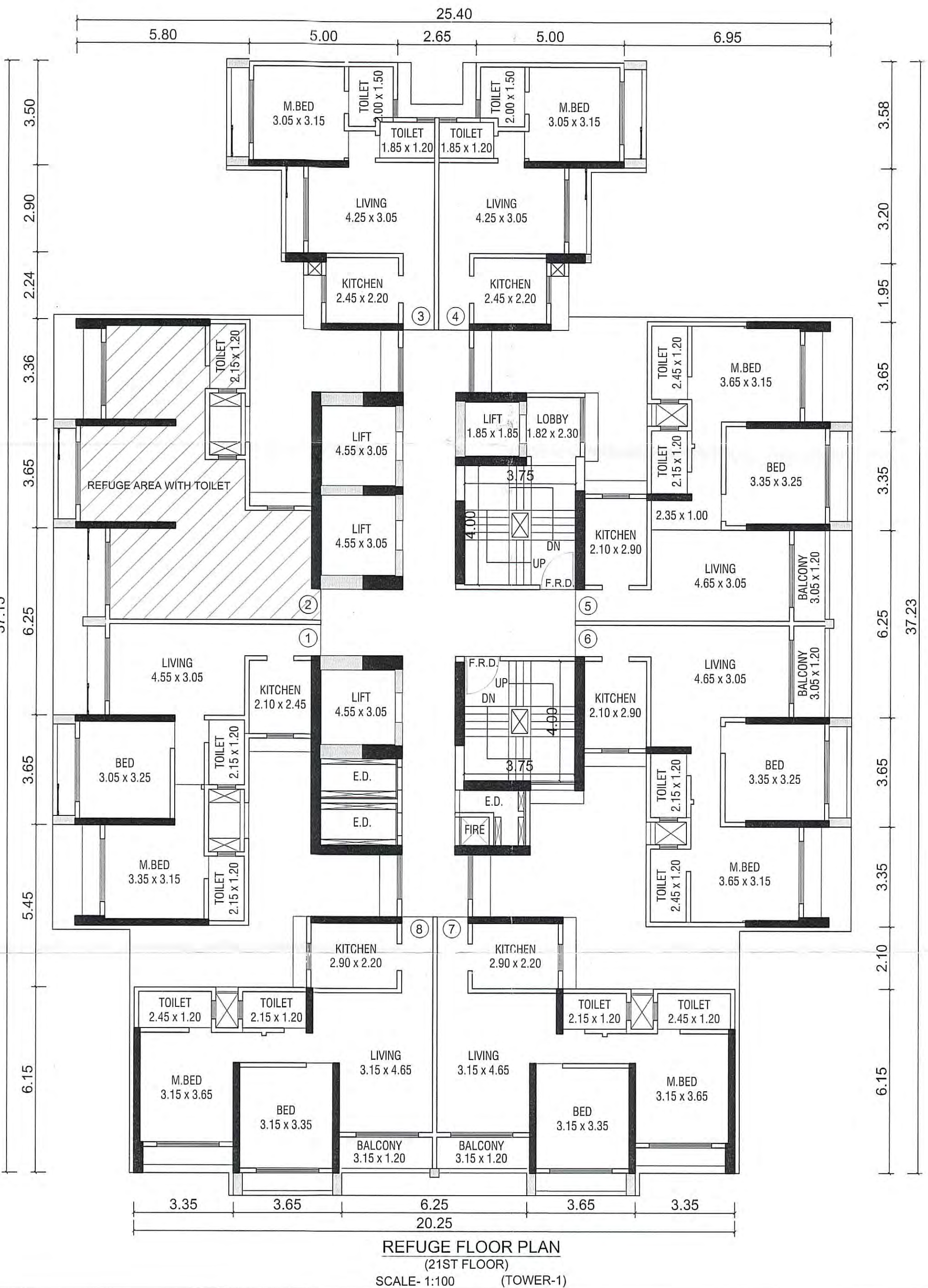

REFUGE FLOOR PLAN (21ST FLOOR) SCALE: 1:100 (TOWER-1)

सोबलचे पत्र क्र. निशामनपा/न/28/EE/2023-24 दि. 09/12/23 ... मधील अटी शर्ती व अटी व शर्ती राहिल मुळ/सुधारित बांधकाम नकाशे (प्रारंभ पत्रासह) मंडळ,

मा. आमुक सो. बांधा मंडळीने

सहाय्यक सार्वजनिक नगरपालिका निवा - भाईराव महानगरपालिका



PERFORMA - B

CERTIFICATE OF AREA  
CERTIFIED THAT I HAVE SURVEYED THE PLOT UNDER REFERENCE ON AND THAT THE DIMENSIONS ON THE SITES ETC. OF THE PLANS ARE AS MEASURED ON THE SITE AND THE AREA SO WORKED OUT IS SQ.METER AND TALLIES WITH AREA STATED IN THE DOCUMENT OF OWNERSHIP / TOWN PLANNING SCHEME RECORD.

DESCRIPTION OF PROPOSAL AND PROPERTY  
PROPOSED LAYOUT ON LAND BEARING (OLD) S.NO 237/2,4,11,12,13, 311/1,2,3A,3B,3C,5,9,24/14, (NEW) S.NO.188/2,4,11,12,13, 34/1,2,3A,3B,5,9,33/14, AT VILLAGE- NAVGHAR TAL. & DIST.-THANE UNDER ACCORDATION RESERVATION POLICY (SITE NO.228-HIGH SCHOOL & PLAY GROUND, SITE NO.229-PRIMARY SCHOOL & PLAY GROUND)

NAME OF LAND OWNER  
SHRI RASESH B. KANAKIA (Promotor)  
M/s PERIWINKLE CONSTRUCTIONS PVT. LTD.

DRAWING NO. 06 SCALE AS SHOWN DATE 16/10/2023 CHECKED BY BASAVARAJ G. ROHIT DRAWN BY REVISION NO. 00

CONSULTING CIVIL ENGINEER  
BASAVARAJ S. GADEKAR (B.E.(CIVIL))

TEJ'S CONSULTANTS  
1008-NANASHASTRA TOWER, BEHIND BALAJI HOSPITAL, GOLDEN WEST CHURCH, MIDA BRAYDAR ROAD, MIDA ROAD (EAST), MIDA - 422105  
TEL : 9820192711