

STAMP OF APPROVAL

DR. TITLE/CS/SDX NO. 250/12/2001/12
DT. /09/2001

APPROVER
Vido No. *Chetan*
Associate Town Planner
TPO, Dabra and Nagar Sevasti,
Silvassa.

SCHEDULE OF OPENING

| PARTICULARS | NO. | SIZE (mm) |
|-----------------|-------|---------------|
| ROLLING SHUTTER | R/S-1 | 2.00 x 3.00 m |
| ROLLING SHUTTER | R/S-2 | 2.50 x 2.44 m |
| DOOR | D1 | 1.00 x 2.13 m |
| DOOR | D2 | 1.22 x 2.13 m |
| DOOR | D3 | 0.75 x 2.13 m |
| WINDOWS | W1 | 2.13 x 1.50 m |
| WINDOWS | W2 | 1.50 x 1.50 m |
| WINDOWS | W3 | 1.50 x 1.22 m |
| VENTILATION | V1 | 2.13 x 0.60 m |
| VENTILATION | V2 | 3.66 x 0.60 m |
| VENTILATION | V3 | 0.60 x 0.60 m |

AREA STATEMENT

PROPOSED GROUND FLOOR
BUILDUP AREA
64.25 x 48.25 m = 3100.06 sqm

NAME OF OWNER

GROUND FLOOR PLAN
OF PROPOSED FACTORY BUILDING
ON SURVEY NO. 250/12/2001/12
AT VILLAGE - DALRA-SILVASSA
FOR
M/S. RAJ RAYON LTD.

SIGN. OWNER

for RAJ RAYON LIMITED
[Signature]
Authorized Signatory

NOTE

CONSULTANT

[Signature]
Harish & Associates
Civil, Architect, Engineer & Survey
101, "Surya" Building, 1st Floor,
101, "Surya" Building, 1st Floor,
101, "Surya" Building, 1st Floor

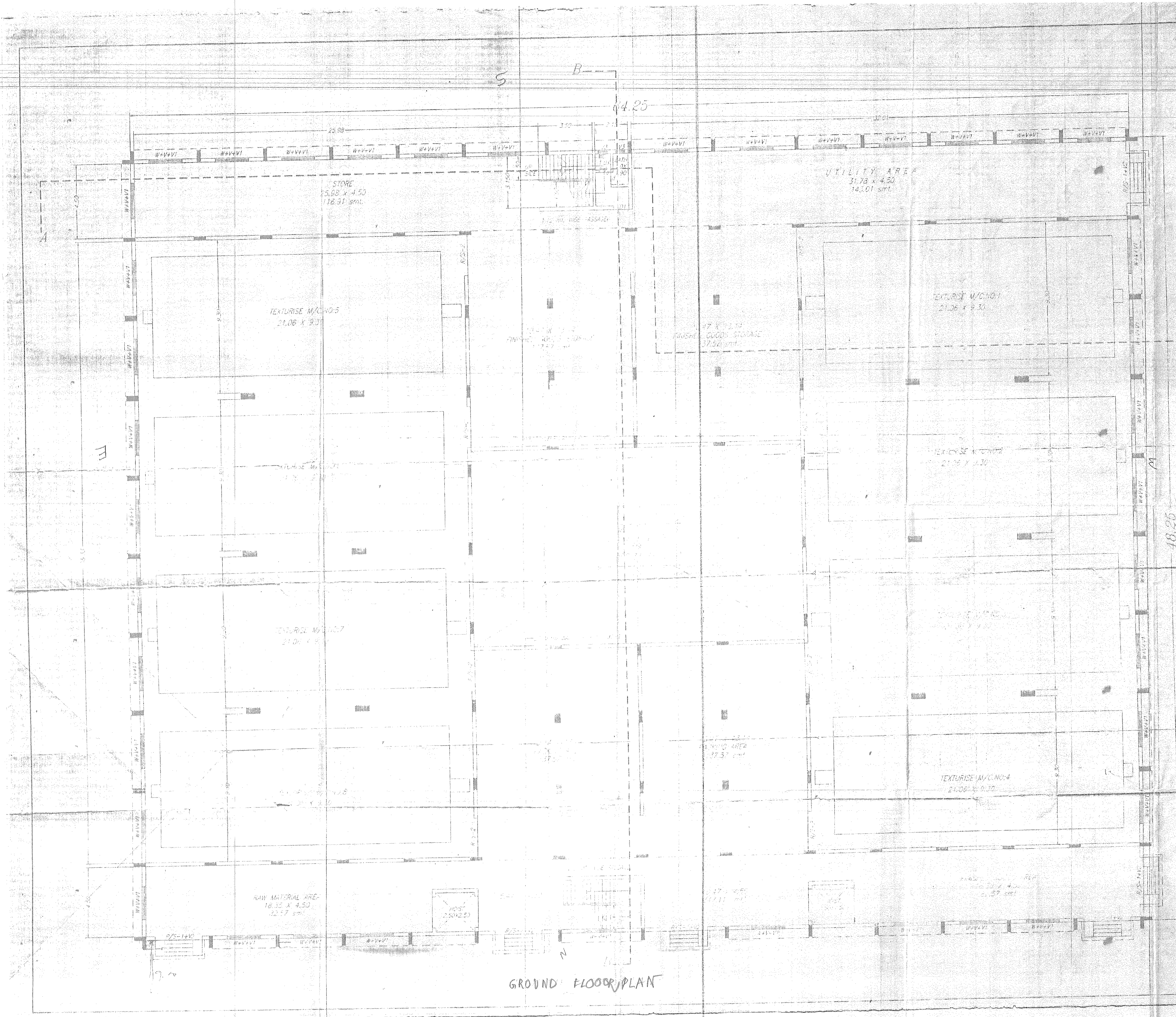

GROUND FLOOR PLAN