

STAMP OF APPROVAL
APPROVED

(Demarcated Final) Layout as per
Conditions. Mentioned in the letter
No. LND V S/49/dt.18/10/2005
View of S. No. 152 (13) and 69
of The Maharashtra Regional and
Town Planning Act 1966

Assistant Director of Town Planning
Nashik Municipal Corporation
Nashik.

PLOT WISE AREA STATEMENT

PLOTS NOs	AREA IN SQ.M	PLOTS NOs	AREA IN SQ.M
1	505.25	12 TO 19	112.00
2 TO 7	115.50	20	674.70
8	119.25	21 TO 28	112.00
9	140.67	29	184.38
10	125.58		
11	110.64	TOTAL	4345.47

::AREA STATEMENT::

AREA OF S. NO. 232/2	= 3200 00 SQM.
AREA OF S. NO. 232/3	= 3100 00 SQM.
AREA UNDER D. P. ROAD	= 588 55 SQM.
AREA UNDER DEVELOPMENT	= 5711 45 SQM.
AREA UNDER M.S.E.B	= 47 25 SQM.
AREA UNDER COLONY ROADS	= 1318 73 SQM.
AREA UNDER PLOTS	= 4345 47 SQM.

::NOTES::

- * LAND BOUNDARY OF PLOT WILL SHOWN IN BLACK
- * ALL DIMENSIONS AREA IN METER

DEMARCATED FINAL LAYOUT

View of ... 152 (13) and 69
of The M ... Regional and
Town Planning Act 1966

[Signature]
Assistant Director of Town Planning
Nashik Municipal Corporation
Nashik.

PLOT WISE AREA STATEMENT

PLOTS NOs	AREA IN SQ.M	PLOTS NOs	AREA IN SQ.M
1	505.25	12 TO 19	112.00
2 TO 7	115.50	20	674.70
8	119.25	21 TO 28	112.00
9	140.67	29	184.38
10	125.58		
11	110.64	TOTAL	4345.47

:::AREA STATEMENT:::

AREA OF S. NO. 232/2	= 3200 00 SQM.
AREA OF S. NO. 232/3	= 3100 00 SQM.
AREA UNDER D. P. ROAD	= 588 55 SQM.
AREA UNDER DEVELOPMENT	= 5711 45 SQM.
AREA UNDER M.S.E.B	= 47 25 SQM.
AREA UNDER COLONY ROADS	= 1318 73 SQM.
AREA UNDER PLOTS	= 4345 47 SQM.

:::NOTES:::

- * LAND BOUNDARY OF PLOT IS SHOWN IN BLACK.
- * ALL DIMENSIONS AREA IN METER.

**DEMARCATED FINAL LAYOUT
PLAN ON S. NO. 232/2+232/3, AT.
MHASRUL, TAL. & DIST. NASHIK.
LAND OWNER OF S. NO. 232/2
SAU. TARABAI GANPAT THETE +1
AND LAND OWNER OF S. NO. 232/3
SHRI. MULIDHAR S. GAIKWAD
G. P. A. H. SHRI. GOVIND Y. SABLE.**

ENGINEER'S SIGN

OWNERS SIGN

PLOT WISE AREA STATEMENT

PLOTS NOS	AREA IN SQ.M	PLOTS NOS	AREA IN SQ.M
1	505.25	12 TO 19	112.00
2 TO 7	115.50	20	674.70
8	113.25	21 TO 28	112.00
9	143.67	29	184.38
10	125.58		
11	110.64	TOTAL	4345.47

AREA STATEMENT

AREA OF S. NO. 232/2	= 3200 00 SQM.
AREA OF S. NO. 232/3	= 3100 00 SQM.
AREA UNDER D. P. ROAD	= 588 55 SQM.
AREA UNDER DEVELOPMENT	= 5711 45 SQM.
AREA UNDER M.S.E.B.	= 47 25 SQM.
AREA UNDER COLONY ROADS	= 1318 73 SQM.
AREA UNDER PLOTS	= 4345 47 SQM.

NOTES:

- LAND BOUNDARY OF PLOT IS SHOWN IN BLACK
- ALL DIMENSIONS AREA IN METER.

DEMARCATED FINAL LAYOUT
 PLAN ON S. NO. 232/2+232/3, AT
 MHASRUL, TAL. & DIST. NASHIK.
 LAND OWNER OF S. NO. 232/2
 SAU. TARABAI GANPAT THETE +1
 AND LAND OWNER OF S. NO. 232/3
 SHRI. MULIDHAR S. GAIKWAD
 G. P. A. H. SHRI. GOVIND Y. SABLE.

ENGINEER'S SIGN

OWNERS SIGN

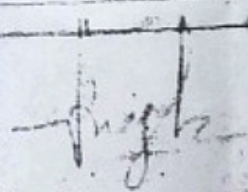
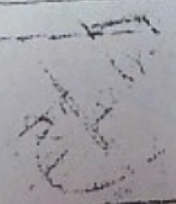
VITTHAL WAGH

G.P.A.H. GOVIND Y. SABLE

SAKAR

PLANNERS & ENGINEERS

7, FIRST FLOOR

ANANT CHAMBERS

ASHOK STAMBH, NASHIK. PH. 2580 199

DATE - 29/08/2005

DRN BY -

SCALE - AS SHOWN

DRN NO. -

15.00 M. WIDE D. P. ROAD

HISSA LINE

ADJ. S. NO. 232/1
LAYOUT NOT APPROVED

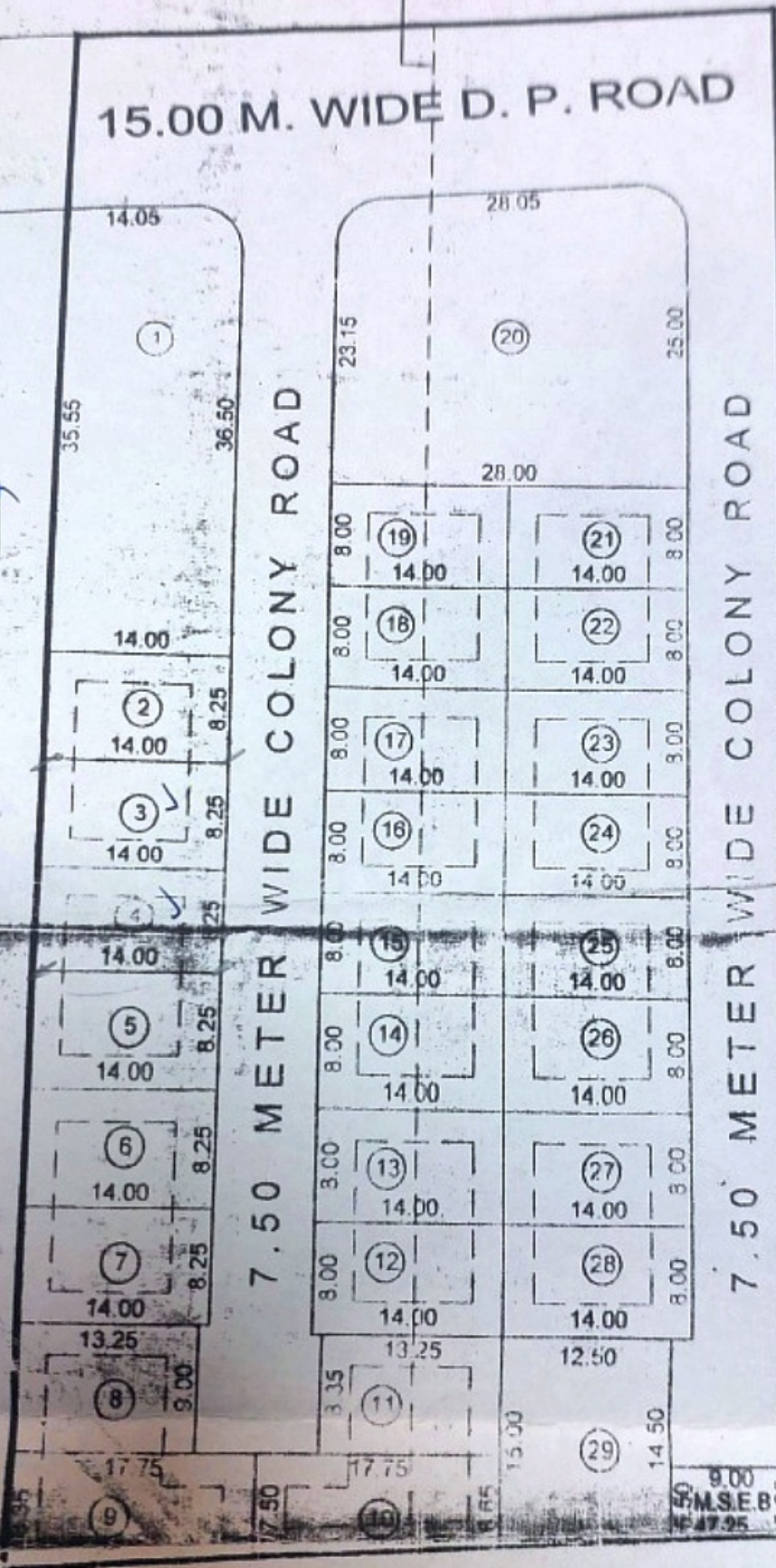

419.70 m

ADJ. S. NO. 232/4
LAYOUT NOT APPROVED

ADJ. S. NO. 233
ADJ. OPEN SPACE
DEMARCATED FINAL LAYOUT
VIDE LETTER NO. LND/WS/07 DT. 19/04/2003

ADJ. S. NO. 232/1
LAYOUT NOT APPROVED



35.55

36.50

1

14.00

2

14.00

8.25

3

14.00

8.25

4

14.00

8.25

5

14.00

8.25

6

14.00

8.25

7

14.00

8.25

13.25

8

9.00

17.75

9

7.50 METER WIDE COLONY ROAD

23.15

20

25.00

28.00

8.00

19

14.00

8.00

21

14.00

8.00

18

14.00

8.00

22

14.00

8.00

17

14.00

8.00

23

14.00

8.00

16

14.00

8.00

24

14.00

8.00

15

14.00

8.00

25

14.00

8.00

14

14.00

8.00

26

14.00

8.00

13

14.00

8.00

27

14.00

8.00

12

14.00

8.00

28

14.00

3.35

11

13.25

12.50

29

15.00

14.50

17.50

17.75

8.75

8.50

15.00 M. WIDE D. P. ROAD

HISSA LINE

ADJ. S. NO. 232/1
LAYOUT NOT APPROVED

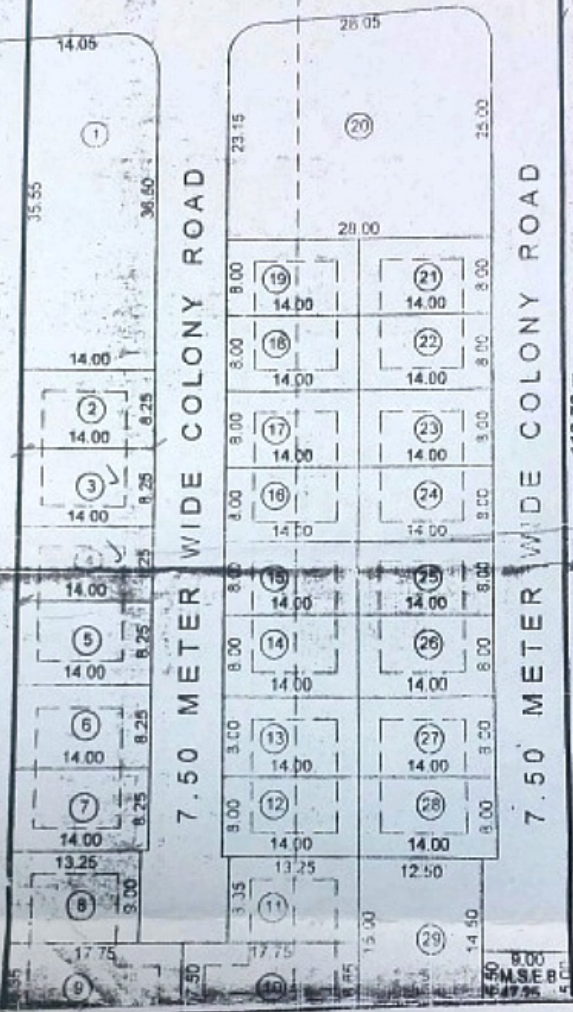

ADJ. S. NO. 232/4
LAYOUT

DEMARICATION CERTIFICATE
THIS IS TO CERTIFY THAT I HAVE PERSON
LAYOUT ON SITE WHICH WAS APPROVED
NASHIK MUNICIPAL CORPORATION NASHIK
DATE: 30/06/2005 AND FURTHER CHECK
OF PLOTS, ROADS AND OPEN SPACE ETC
PLAN ARE ACTUALLY ON SITE.
[Signature]
ENGINEER

ADJ. S. NO. 213
ADJ. OPEN SPACE
DEMARCATED FINAL LAYOUT
VIDE LETTER NO. LND/WS/07 DT. 19/04/2003

LAYOUT PLAN



SCALE 1:500

PROPOSED SITE

7.50 M. W. ROAD

235

LOC

LAYOUT PLAN

LOCATION PLAN

DATE: 28/03/2025
SCALE: AS SHOWN

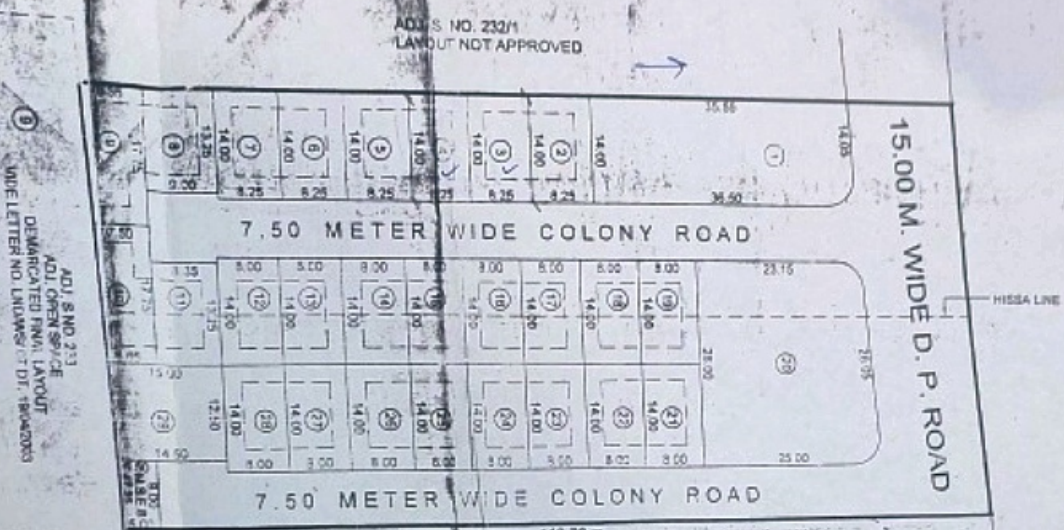

DEMARCATION OF HISSA LINE
THIS IS TO CLARIFY THAT THE ABOVE DEMARCATION OF HISSA LINE IS THE FINAL LAYOUT PLAN AND THE HISSA LINE IS TO BE MAINTAINED AS SUCH. ANY FUTURE CHANGES TO THE HISSA LINE SHALL BE THE RESPONSIBILITY OF THE APPLICANT. THIS DEMARCATION IS SUBJECT TO THE APPROVAL OF THE LOCAL AUTHORITY.

STAMP OF APPROVAL
Demarcated Final Layout as per Conditions mentioned in the letter No. L.D.S. 4/18/2025 of the M. S. Regional and Town Planning Dept. 1986

PLOT WISE AREA STATEMENT

PLOTS NO.	AREA IN SQ.M.	PLOTS NO.	AREA IN SQ.M.
1	605.25	12 TO 19	132.00
2 TO 7	715.50	20	674.70
8	131.28	21 TO 29	712.00
9	143.07	30	186.20
10	355.58		
11	100.64	TOTAL	4385.67

AREA STATEMENT

- AREA OF S. NO. 232/1: 228.00 SQ.M.
- AREA OF S. NO. 232/2: 3100.00 SQ.M.
- AREA UNDER D.P. ROAD: 599.58 SQ.M.
- AREA UNDER HISSA LINE: 5111.45 SQ.M.
- AREA UNDER HISSA LINE: 47.25 SQ.M.
- AREA UNDER COLONY ROADS: 1510.75 SQ.M.
- AREA UNDER PLOTS: 4385.67 SQ.M.

DEMARCATED FINAL LAYOUT PLAN ON S. NO. 232/2+232/3, AT: MHASRU, TAL. & DIST. NASHIK, LAND OWNER OF S. NO. 232/2 SAU. TARAKAL GANPAT THETE +1 AND LAND OWNER OF S. NO. 232/3 SHRI. MULIDHAR S. GAIKWAD G. P. A. H. SHRI GOVIND Y. SABLE

SAKAR
P. ANNEBIA & P. ANNEBIA
2 FIRST FLOOR
MAHATMA CHAWABAZAR
ASRUKOT STREET, NASHIK PIN 232018

VIRTUAL NO. 1
Q.747H (CONNOY) Q.747E