

**PROJECT NAME :**  
Proposed Expansion of factory building on plot no. B6 To B8 MIDC M.J. Growth Center Tah - Mid Dist- Chandrapur  
FOR M/s. Rajat Steel And Alloys Pvt. Ltd.

**DRAWING TITLE :**  
Site Plan

**APPROVAL**

**AREA CALCULATION SUMMARY**

Sl. No.	Category	Area in Sq. Meter
1	AREA STATEMENT	132704.00
2	EXISTING BUILT UP AREA	14937.99
3	PROPOSED BUILT UP AREA	619.62
4	NET BUILT UP AREA	15557.61
5	OPEN SPACE AREA - PARKING	10000.00
6	AMENITY SPACE	5000.00
7	FREE FSI BUA AREA	1182.00
8	TOTAL BUA AREA	27133.61
9	TOTAL GROUND COVERAGE	16682.25

**REVISION**

No.	Description	Date

**LEGEND**

Description	Code	Description	Code

**NOTES**

1. ALL DIMENSIONS ARE IN METERS.  
2. THE PROPOSED BUILT UP AREA IS SUBJECT TO THE APPROVAL OF THE LOCAL AUTHORITY.  
3. THE PROPOSED BUILT UP AREA IS SUBJECT TO THE APPROVAL OF THE LOCAL AUTHORITY.  
4. THE PROPOSED BUILT UP AREA IS SUBJECT TO THE APPROVAL OF THE LOCAL AUTHORITY.

Name/Stamp and sign for Client

Name/Stamp and sign for Architect

Ref. Drg. No. Ref. Linc. Drawng based for

M/S. PRAKASH BHOGE AND ASSOCIATES  
Ar. Prakash Bhoje  
(Architect + Structural Engineer)  
A-210, Shivajinagar, 4th floor, Behind of crystal palace hotel, Ganeshji, 11th path, Nashik, Maharashtra-422002

Job. no. Date 04/07/2019  
Scale As per drg. Dwn. by. Madhuri  
Apr. by. Ar. Prakash CHK. by. Ar. Prakash

Dwg. no. 110201\_Bldg\_040719\_01

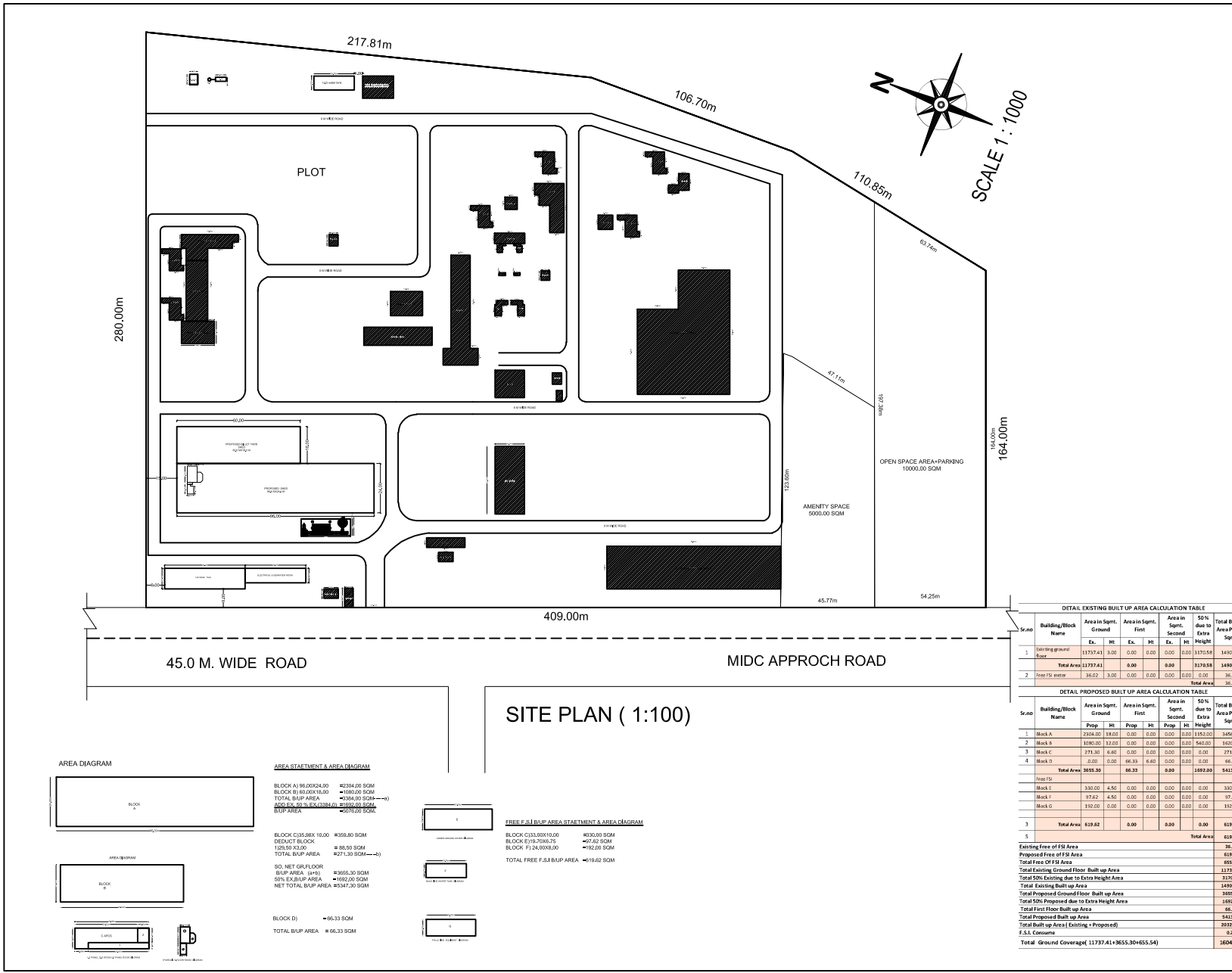

**SITE PLAN ( 1:100 )**

**AREA DIAGRAM**

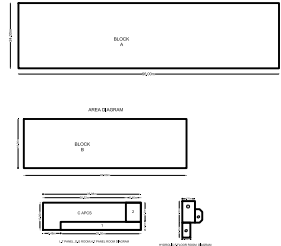

**AREA STATEMENT & AREA DIAGRAM**

BLOCK A) 16.00X40.00	= 640.00 SQM
BLOCK B) 16.00X40.00	= 640.00 SQM
TOTAL BUA AREA	= 1280.00 SQM
ADD. EX. 10% F.S.I. BUA AREA	= 128.00 SQM
BUA AREA	= 1408.00 SQM

BLOCK C) 15.00X10.00	= 150.00 SQM
REDUCT BLOCK	= 08.50 SQM
TOTAL BUA AREA	= 271.30 SQM

BLOCK D)	= 65.33 SQM
TOTAL BUA AREA	= 65.33 SQM

**FREE F.S.I BUA AREA STATEMENT & AREA DIAGRAM**

BLOCK C) 10.00X10.00	= 100.00 SQM
BLOCK E) 10.00X7.50	= 75.00 SQM
BLOCK F) 20.00X10.00	= 200.00 SQM
TOTAL FREE F.S.I BUA AREA	= 375.00 SQM

**DETAIL EXISTING BUILT UP AREA CALCULATION TABLE**

Sl. No.	Building/Block Name	Area in Sqmt.		Area in Sqmt.		50% due to Extra	Total Built up Area/Prop. in Sqmt.
		Ground	First	Ex.	HI		
1	Existing ground floor	11737.41	3.00	0.00	0.00	0.00	11740.41
2	Free FSI interior	36.62	3.00	0.00	0.00	0.00	39.62
<b>Total Area</b>		<b>11774.03</b>	<b>6.00</b>	<b>0.00</b>	<b>0.00</b>	<b>0.00</b>	<b>11780.03</b>

**DETAIL PROPOSED BUILT UP AREA CALCULATION TABLE**

Sl. No.	Building/Block Name	Area in Sqmt.		Area in Sqmt.		50% due to Extra	Total Built up Area/Prop. in Sqmt.
		Prop.	HI	Prop.	HI		
1	Block A	2304.00	18.00	0.00	0.00	0.00	2322.00
2	Block B	1080.00	12.00	0.00	0.00	0.00	1092.00
3	Block C	271.30	8.50	0.00	0.00	0.00	279.80
4	Block D	0.00	0.00	65.33	0.00	0.00	65.33
<b>Total Area</b>		<b>3655.30</b>	<b>38.50</b>	<b>65.33</b>	<b>0.00</b>	<b>0.00</b>	<b>3720.63</b>

**EXISTING FREE OF FSI AREA**

Block E	380.00	4.50	0.00	0.00	0.00	0.00	384.50
Block F	374.25	4.50	0.00	0.00	0.00	0.00	378.75
Block G	192.00	0.00	0.00	0.00	0.00	0.00	192.00
<b>Total Area</b>		<b>946.25</b>	<b>9.00</b>	<b>0.00</b>	<b>0.00</b>	<b>0.00</b>	<b>955.25</b>

**EXISTING FREE OF FSI AREA**

Existing Free of FSI Area	955.25
Proposed Free of FSI Area	619.62
Total Free Of FSI Area	1574.87
Total Existing Ground Floor Built up Area	11740.41
Total 50% Existing due to Extra Height Area	11740.41
Total Existing Built up Area	23480.82
Total Proposed Ground Floor Built up Area	3655.30
Total 50% Proposed due to Extra Height Area	1682.00
Total First Floor Built up Area	5337.30
Total Proposed Built up Area	9342.60
Total Built up Area (Existing + Proposed)	32823.42
F.S.I. Coverage	0.24
Total Ground Coverage (11737.41+3655.30+655.54)	16048.25