

TRACING SCALE.
 1" = 5 JARIB
 † JARIB = 26'0"
 TRACING MAP GRAM RAJODA
 P.N.No. 21 TEHSIL SANWER
 DIST. INDORE YEAR 1934-35

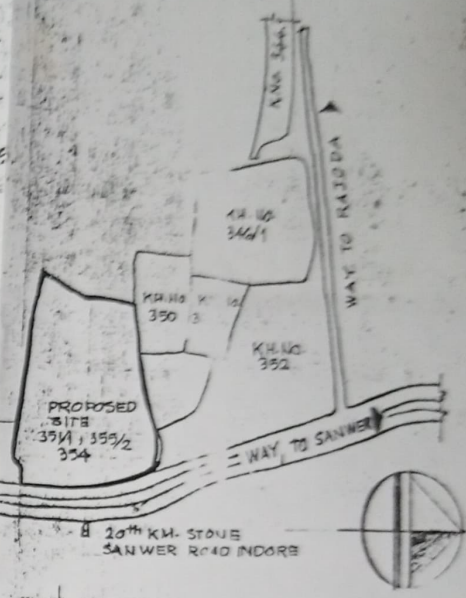

180.00MTR

138.00

10M

ROAD 4.0 M WIDE

MAIN PLANT
103.40 X 33.00

ROAD 6.0 M WIDE

ADMIN. BLDG
15 M X 10 MTR

DIESEL STORAGE
TANK SIZE 6.00 X 3.00 M
PROTECTED AREA 15.00 X 15.00 M

GENERATOR &
CONTROL PANEL ROOM
10 X 10.00 M

TRANSFORMER
YARD 5.00 X 10.00 M

GARDEN

20m

30m

60.00M

45.0 M

10M

WATER TOWER
4.5 X 5.0 MTR

23.0 MTR

162.0 MTR

ROAD 6.0 M WIDE

STAMP
3.00 X 10.00 M

SECURITY
GATE OFFICE
3.00 X 10.00 M

SANITARY

TO INDORE

30MTR WIDE ROAD

Center of Road

Valid up to **5-10-96**

यह मानचित्र एवं आरेखण का कार्य सहायक सचिव के पद पर
कमाला 3825 दिनांक 6/10/95
द्वारा प्रत्यक्ष स्वीकृत किया गया है।

क. क. क. क. क.
मुख्य अभियंता, राजीव
राज्य, विद्या-नगर (प. व.)

सहायक सचिव
वास्ते संयुक्त संचालक
नगर एवं ग्राम विभाग, इंदौर

STATEMENT OF AREA

PLOT AREA	20.6 LE
PROPOSED BUILT UP AREA	301.99
PERCENTAGE BUILT UP AREA	15.19%

BREAK UP BUILT UP

MAIN PLANT	103.40 X 33.00	3412.82 SQM
ADMIN BLDG	15.00 X 10.00	150.00 SQM
WATER TOWER	4.50 X 5.00	22.50 SQM
STAMP	3.00 X 10.00	30.00 SQM
SECURITY GATE OFFICE	3.00 X 10.00	30.00 SQM
TRANSFORMER YARD	5.00 X 10.00	50.00 SQM
DIESEL STORAGE	6.00 X 3.00	18.00 SQM
GARDEN	15.00 X 15.00	225.00 SQM
ROAD		138.00 SQM
TOTAL		3905.95 SQM

ESSENTIAL STAFF HOUSING

15 X 4 = 60.00 M	
STATE HOUSE 12 X 30 X 3 = 108.00 M	
TOTAL	3905.95 SQM

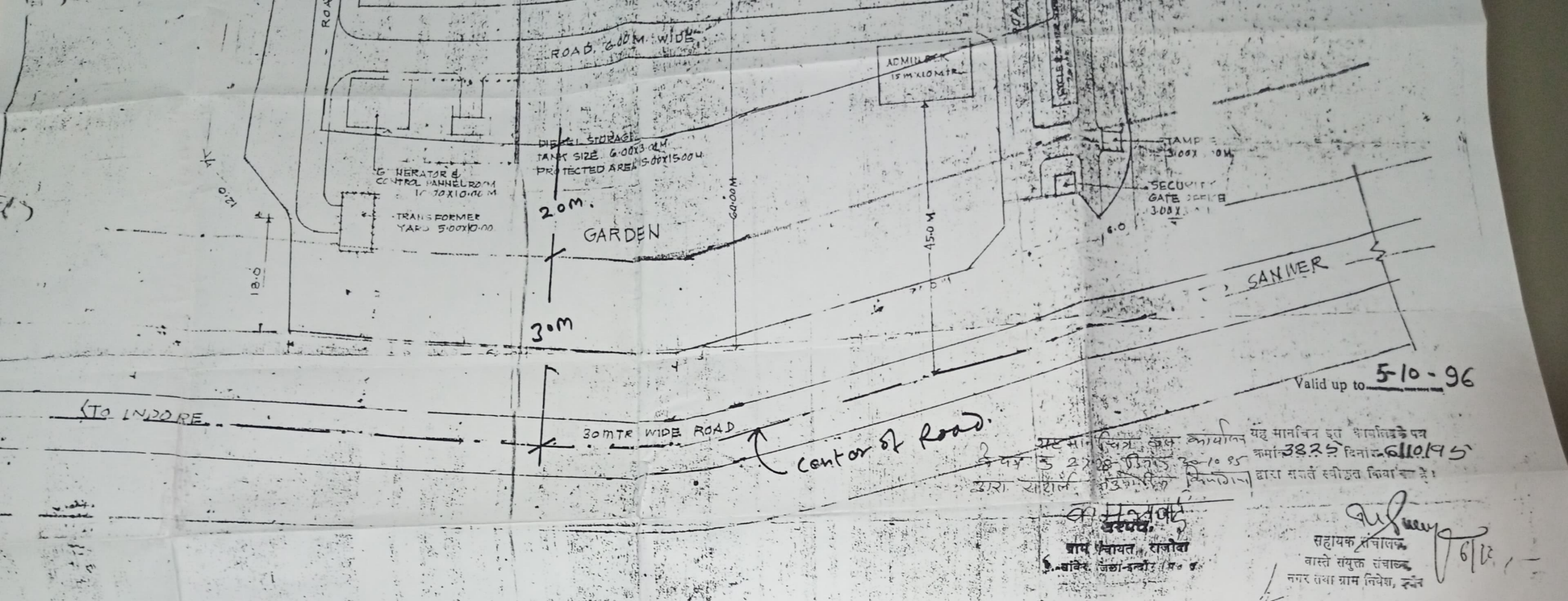

Valid up to 5-10-96

यह मानचित्र इत कालिदास पर
 क्रमांक 3825 दिनांक 6/10/95
 द्वारा सर्वे स्वीकृत किया है।

श. श. श. श.
 सहायक संचालक
 वास्ते संयुक्त संचालक
 नगर तथा ग्राम निवेश, इत

STATEMENT OF AREA

PLOT AREA	20.00 x 30.00 = 600.00 SQM	BREAK UP BUILT UP	
PROPOSED BUILT UP AREA	380.19 SQM	MAIN PLANT	10.51 x 3.52 = 36.78 SQM
PERMISSIBLE BUILT UP AREA	151.19%	ADMIL BLOCK	15.00 x 10.00 = 150.00 SQM
OPEN AREA	84.51%	GENERATOR & CONTROL ROOM	10.70 x 10.00 = 107.00 SQM
		TRANSFORMER YARD	5.00 x 10.00 = 50.00 SQM
		DIESEL STORAGE TANK	6.00 x 3.00 = 18.00 SQM
		SECURITY GATE	3.00 x 10.00 = 30.00 SQM
		STAMP	3.00 x 10.00 = 30.00 SQM
		TOTAL	380.19 SQM

SIGN. OF ARCHITECT 	OWNER'S SIGN For Swastik Spintex Limited 	PROJECT TITLE: SWASTIK SPINTEX LTD.	
		KHASRA NO. 351/1, 352/2, 354. SANWER ROAD INDORE	
DRAWING TITLE: SITE-LOCATION PLAN		DATE: 3/07/95	SCALE: 1:500
DRAWN BY: M. SHARMA		DESIGNED BY: D. VIPAT	DRAW. NO. SSL/50/95/03

REG. NO: 06034
 CONSULTANT ARCHITECTURE

Handwritten notes at the top right corner.

ग्राम प्रधान, राजीव
बाकि, जहा-दवा, (पं. ९)

20.6.95
80.9%
15.19%
84.51%

BREAK UP BUILT UP
1 MAIN PLANT 105.4X 33.2 13478.2 sqm
2 ADMIN BLOCK 15.00 - 11
3 GEN Rm. & CONTROL ROOM 130 sqm

4 ESSENTIAL STAFF
5 STATE HOUSE & T

Swastik Spintex Limited
Mg. Director

DEEPAK VIPAT & ASSOCIATES
ARCHITECTS ENGINEERS & INT. DESIGNERS
53/4, VALLABH NAGAR INDORE TEL. 534334
DRAWN BY. M. SHARMA. DESIGNED BY. D. VIPAT

PROJECT TITLE SWASTIK
KHASRA NO. 35/1, 35
DRAWING TITLE SITE LOC
DATE: 3/07/95
SCALE:

TO INDORE

30 MTR WIDE ROAD

STATEMENT OF AREA

PLOT AREA	2006.46
PROPOSED BUILT UP AREA	1805.95
PERCENTAGE BUILT UP AREA	15.19%
OPEN AREA	84.51%

BREAK UP BUILT UP
 MAIN PLANT 105.4X
 ZADEN BLOCK 13.11
 30 EN RM. ETC

SIGN. OF ARCHITECT

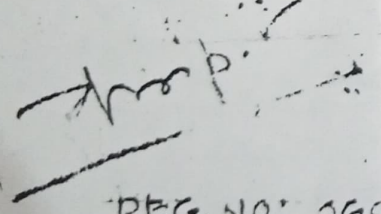

REG. NO: 06034
 CON. OF ARCHITECTURE

OWNER'S SIGN

For Swastik Spintex Limited

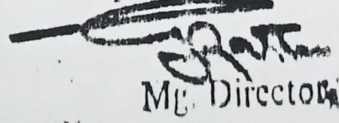

Mg. Director

DEEPAK VIPAT & ASSOC
 ARCHITECTS ENGINEERS & INT
 53/4, VALLABH NAGAR INDORE

DRAWN BY: M. SHARMA DESIGNED

STATEMENT OF AREA

PLOT AREA	2006.00	BREAK UP BUILT UP AREA	151.19%
PROPOSED BUILT UP AREA	300.90	FINAL PLANK	
PERMISSIBLE BUILT UP AREA	151.19%	LOADING BLOCK	
OPEN AREA	84.51%	OPEN Rm. etc.	

SIGN. OF ARCHITECT

[Handwritten Signature]

REG. NO: 06034
CON. OF ARCHITECTURE

OWNER'S SIGN

For Swastik Spintex Limited

[Handwritten Signature]
Mg. Director

DEEPAK VIPAT &

ARCHITECTS & ENGINEERS

53/4, VALLABH NAGAR

DRAWN BY: M. SHARMA

का. म. २४०५
उत्पत्ति.

श्री. वि. रायत राजोदा
स. गांवेर, जिला-इन्दौर (म. प्र.)

सहायक संचालक
वास्ते संयुक्त संचालक
नगर तथा ग्राम निवेश, इन्दौर

4 ESSENTIAL STAFF
STATE HOUSE & T

HOUSE NO. 15 x 4 = 60 SQM
PLE 12 x 3.0 x 3.2 = 18 SQM
TOTAL 3805.95 SQM

DATES
DESIGNERS
L. 534334
D. VIPAT

PROJECT TITLE	SWASTIK SPINTEX LTD.		
	KHASRA NO. 351/1, 355/2, 354. SANWER ROAD INDC		
DRAWING TITLE	SITE LOCATION PLAN		
DATE	3/07/95	SCALE	1:500
		DRAW. NO.	SSL/50/95/03

SECURITY
GATE OFFICE
300X300

SANWER

Valid up to **5-10-96**

चित्र कक्ष कार्यालय
28 डिग्री 30-10-85
विभागीय

यह मानचित्र इत कार्यालय के पत्र
क्रमांक **3825** दिनांक **6/10/95**
द्वारा सफल स्वीकृत किया है।

मुख्य
न्याय, राजीव
जहा-द्वारा (प. 8)

[Signature]
6/10

सहायक संचालक
वास्ते संयुक्त संचालक
नगर तथा ग्राम निवेश, स्वर

HOTAL STAFF
HOUSE & T

HOUSING: 15 x 4 = 60 SQM
PLE: 12 x 3.0 x 3.2 = 18 SQM
TOTAL: **3805.955**

180.0 MTR

138.00

10M

162.0 MTR

10M

ROAD 4.0 M WIDE

MAIN PLANT
103.40 X 33.00

ROAD 6.00 M WIDE

ROAD 6.00 M WIDE

ADMIN BLDG
15M X 10MTR

DIESEL STORAGE
TANK SIZE 6.00 X 3.00 M
PROTECTED AREA 5.00 X 15.00 M

GENERATOR &
CONTROL HALL ROOM
10.00 X 10.00 M

TRANSFORMER
YARD 5.00 X 10.00 M

GARDEN

STAMPE
3.00 X 3.00 M

SECURITY
GATE 3.00 X 3.00 M

TO INDORE

30MTR WIDE ROAD

Center of Road

Valid up to 5-10-96

यह मानचित्र इलेक्ट्रिकल डिपार्टमेंट के पास
 क्रमांक 3225 दिनांक 01/10/95
 दिनांक 22/08/85
 2 मंजूर

138 00

180.0 MTR

10M

ROAD 4.0M WIDE

3.00

MAIN PLANT
105.40 X 33.00

ROAD 6.00 M WIDE

ROAD 6.00 M WIDE

ADMIN BLDG
15 M X 10 MTR

DIESEL STORAGE
TANK SIZE 6.00 X 3.00 M
PROTECTED AREA 5.00 X 15.00 M

GENERATOR &
CONTROL PANEL ROOM
10.00 X 10.00 M

TRANSFORMER
YARD 5.00 X 10.00

20m

GARDEN

60.00 M

45.0 M

30m

30MTR WIDE ROAD

Center of Road

DORE

TRACING SCALE.
1" = 5 JARIB
↑ JARIB = 66' 0"
TRACING MAP GRAM RAJODA
P.N.No. 21 TEHSIL SANWER
DIST. INDORE YEAR 1994-95.

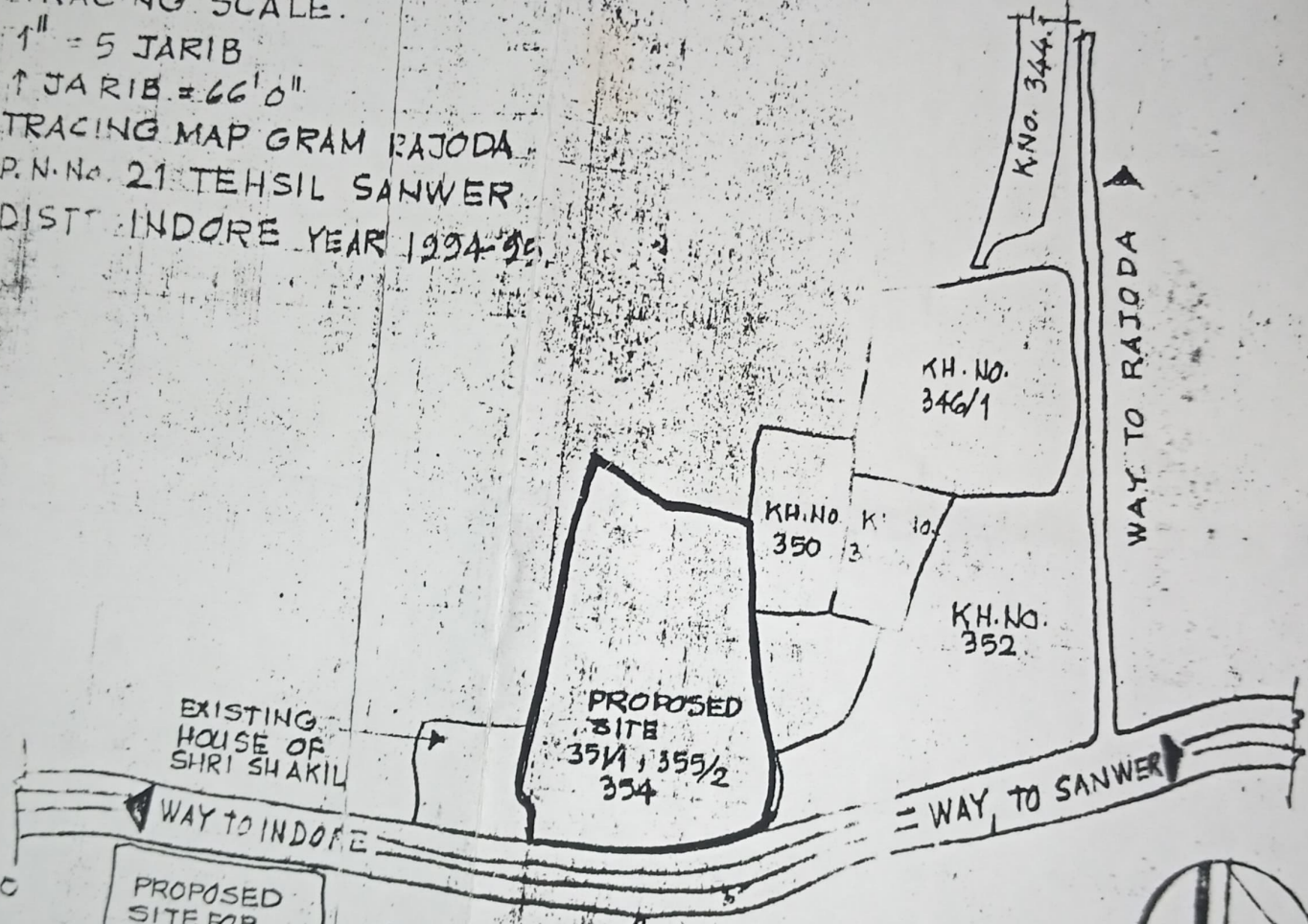

67.0
PROPOSED SITE FOR RAMA PHOSPATE
1.

20th KM. STONE
SANWER ROAD INDORE

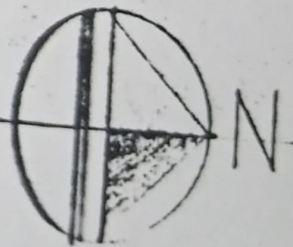

SITE LOCATION PLAN

TRACING SCALE.
 1" = 5 JARIB
 † JARIB = 66'0"
 TRACING MAP GRAM RAJODA
 P.N. No 21 TEHSIL SANWER
 DIST. INDORE YEAR 1994-95

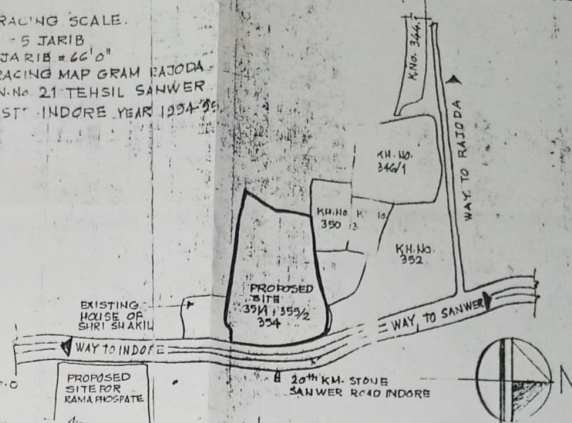

↑ SITE LOCATION PLAN

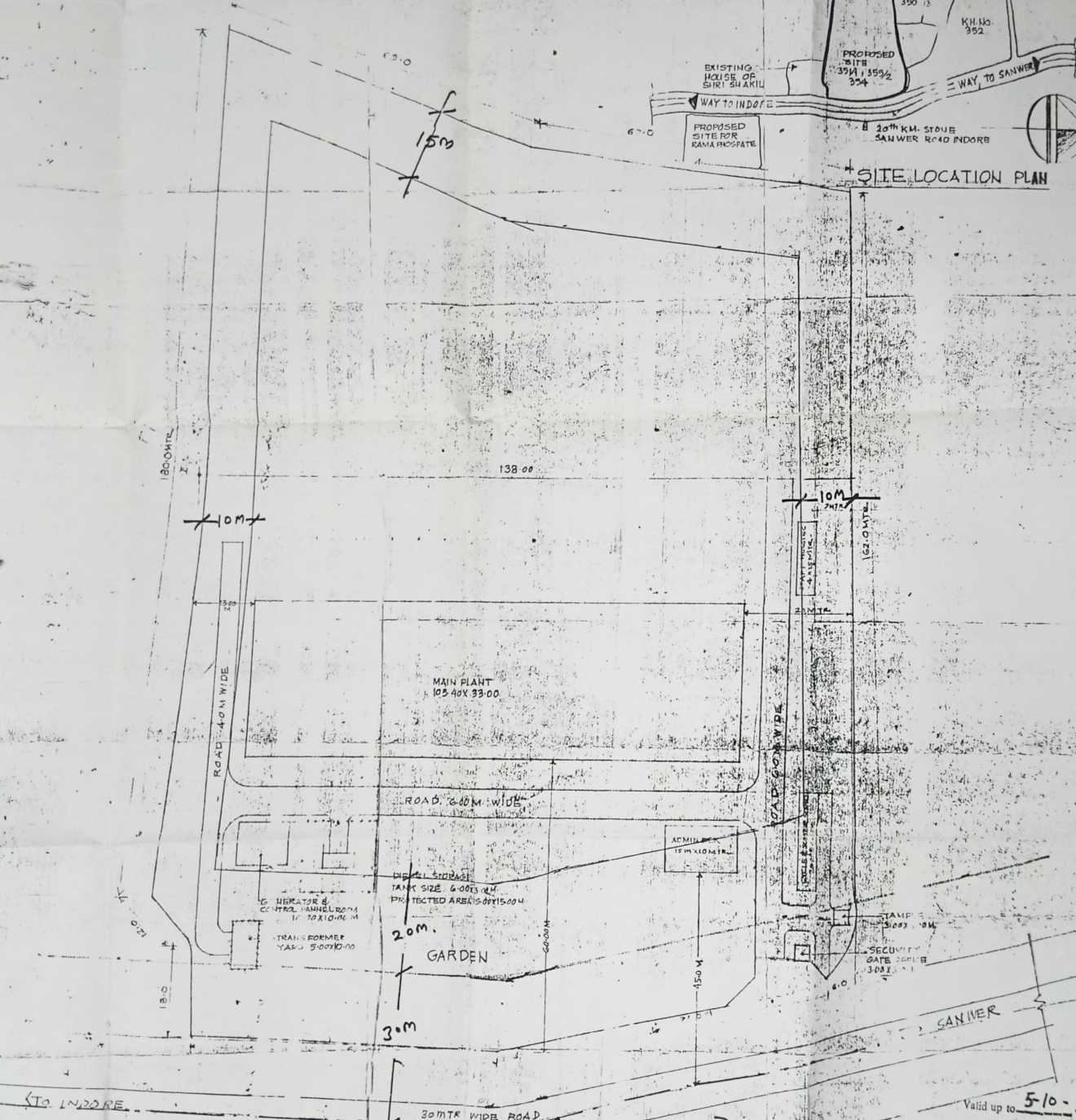

Valid up to 5-10-96

मैंने मानचित्र, किल, कागजान्त यह मानचित्र द्वारा सत्यापित करके
 5/2/95 दिनांक 20-10-95 कर्मा 28232 दिनांक 6/10/95
 द्वारा खोजी, उपरोक्त स्थितियों द्वारा मूल स्थिति का विवरण है।

STATEMENT OF AREA

AREA OF BUILT UP AREA	280.95
AREA OF OPEN SPACE	84.57

BREAK UP BUILT UP
 PLANNING BLOCK 103.40x93.00
 TANK BLOCK 4000L
 GARDEN 20.00x30.00

ESSENTIAL STAFF HOUSING
 15x4x3.15m
 TOTAL 285.95

OWNER'S SIGN For Swastik Spintex Limited M.C. Director	DEEPAK VIPAT & ASSOCIATES ARCHITECTS ENGINEERS & INT. DESIGNERS 23/4 VALLABH NAGAR INDORE TEL. 534334	PROJECT TITLE SWASTIK SPINTEX LTD. KHASRA NO. 351/1, 352/2, 354 SANWER ROAD INDORE	DRAWING TITLE SITE LOCATION PLAN	DATE 3/07/95	SCALE 1:500	DRAW. NO. 531/50/95/03
--	---	---	----------------------------------	--------------	-------------	------------------------