

Approved Plan (4).pdf

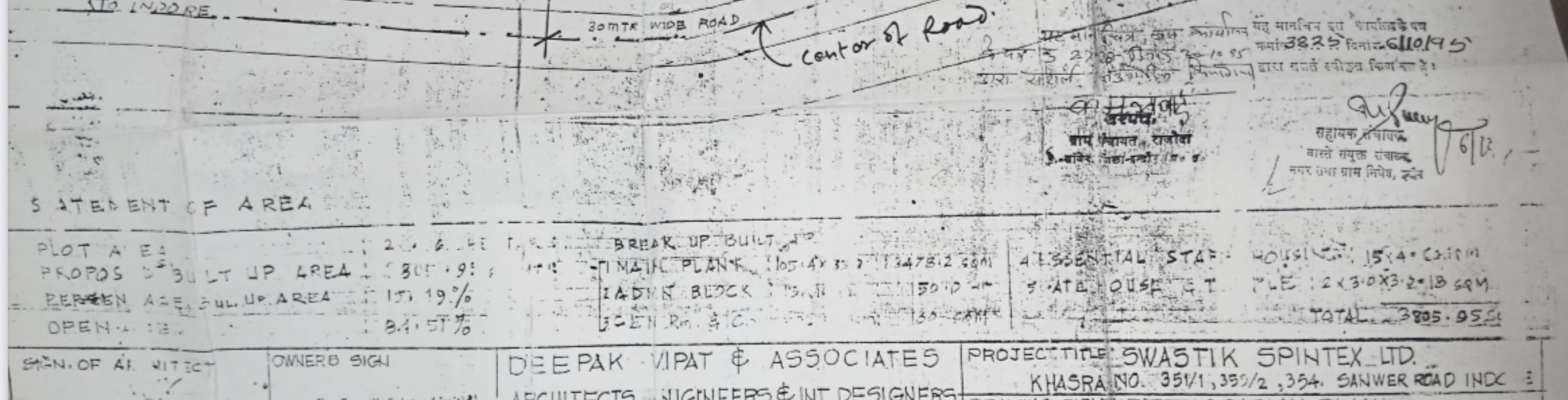

SEAL OF ARCHITECT	OWNER'S SIGN	DEEPAK VIPAT & ASSOCIATES	PROJECT TITLE: SWASTIK SPINTEX LTD.
	For Swastik Spintex Limited	ARCHITECTS ENGINEERS & INT. DESIGNERS	KHASRA NO. 351/1, 352/2, 354. SANWER ROAD INDORE
	Mg. Director	53/4, VALLABH NAGAR INDORE TEL. 534334	DRAWING TITLE: SITE LOCATION PLAN
REG. NO: 36004		DRAWN BY: M. SHARMA	DATE: 3/07/95
CON. ARCHITECTURE		DESIGNED BY: D. VIPAT	SCALE: 1:500
			DRAW. NO. SSL/50/95/03

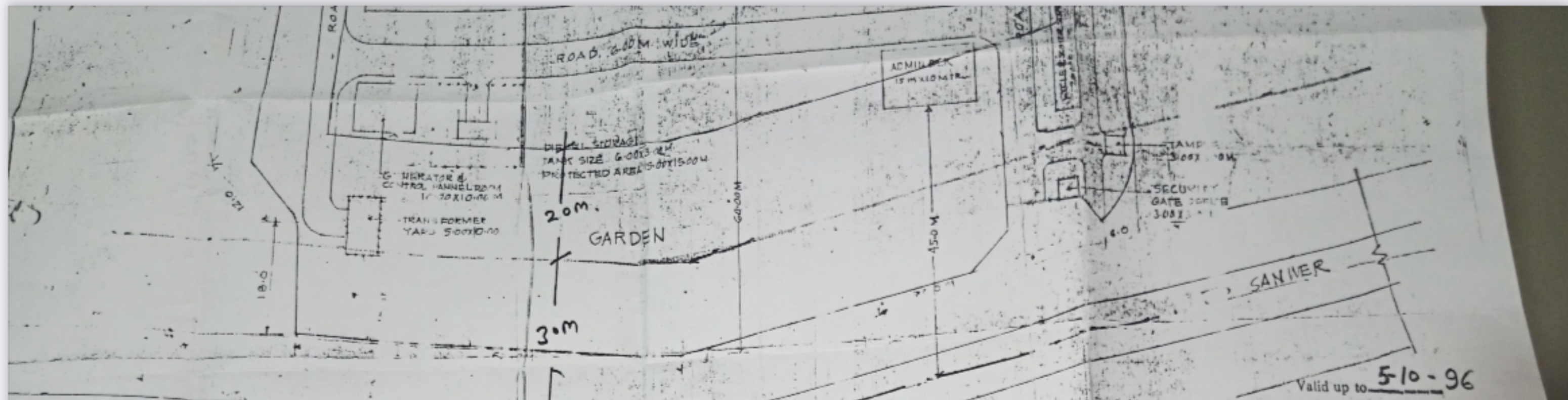
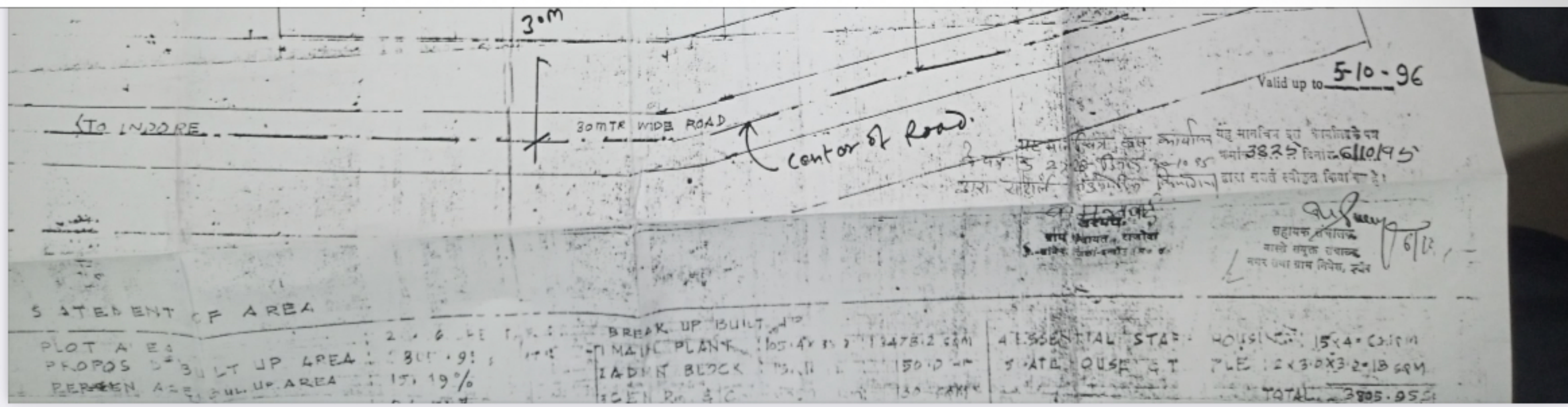
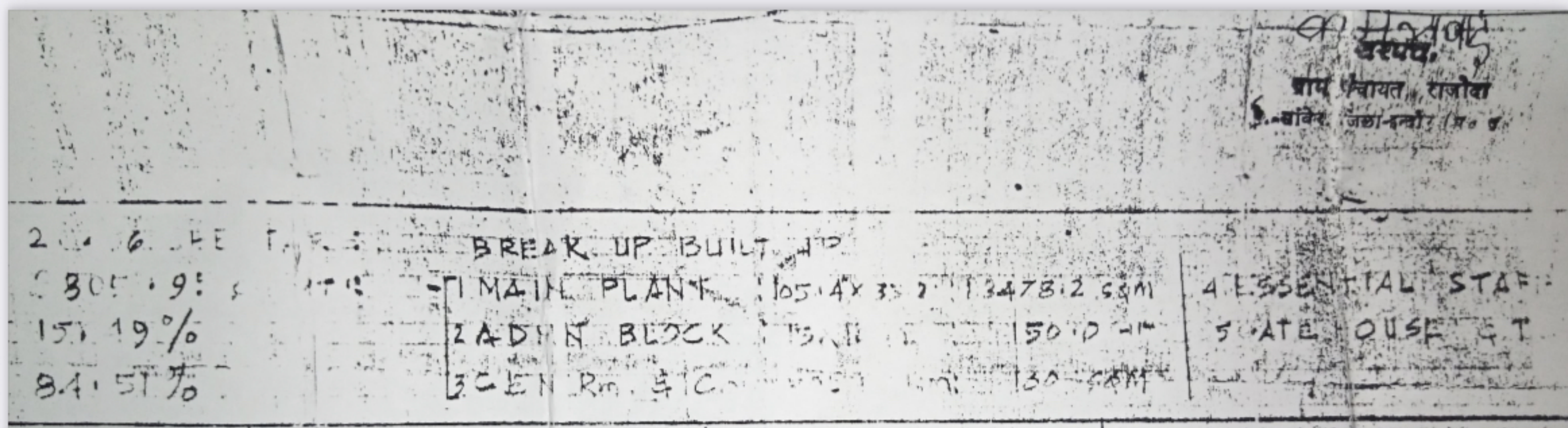

SEAL OF ARCHITECT	OWNER'S SIGN	DEEPAK VIPAT & ASSOCIATES	PROJECT TITLE: SWASTIK
	For Swastik Spintex Limited	ARCHITECTS ENGINEERS & INT. DESIGNERS	KHASRA NO. 351/1, 352/2, 354. SANWER ROAD INDORE
	Mg. Director	53/4, VALLABH NAGAR INDORE TEL. 534334	DRAWING TITLE: SITE LOC
REG. NO: 36004		DRAWN BY: M. SHARMA	DATE: 3/07/95
CON. ARCHITECTURE		DESIGNED BY: D. VIPAT	SCALE: 1:500
			DRAW. NO. SSL/50/95/03

