

**Case Type - H.No. 317 (Shop)**

Vastukala Consultants India Pvt. Ltd. - Property Details Format

Bank Name - SBI

Branch Name - S.A.R.B

Date of Visit - 01/10/23

Site Engineer Name - Somesh

Name of client -

**(Residential Plot, Flat, Shop & Office)**

Flat / Office / Shop No -

Floor -

Wing -

Name of the building -

Composition of flat / office - (1 BHK - 2 BHK - 3 BHK), No. of lift -

Total No. of Wing -

**Boundaries - As per Site**

North	Toilet And other property
South	<del>Toilet And other property</del> other House
East	Owns property
West	Road

Total Nos. of Floor in the building -

No. of flat / units per floor -

ADD. - H.No. 317 (shop)

Plot Size -

Floor of Building - G+1

Area Calculation: -

Broker Name &amp; Number

Unit Value -

Rate in Sq.Ft. - 2000/sq2

**Common Information**

Year of construction -

Landmark -

Property occupied by - Owner/Tennant/vacant Name of Tenant: -

Contact No.

Tenure Period -

Type of Parking on ground floor - Open / Stilt / Podium / Basement

Source of Water Supply -

Type of Sewerage System - Septic Tank / Sewerage Line

Type of Finishing in compound area -

Contact person's name and relationship with property -

Indore ji (Bansal)

Mobile No - 9617635035

Type of road -

Width -

Property - Corner / Intermittent

External photographs / Drop Pin Photo / Internal Photographs / Engineer Selfie with contact person

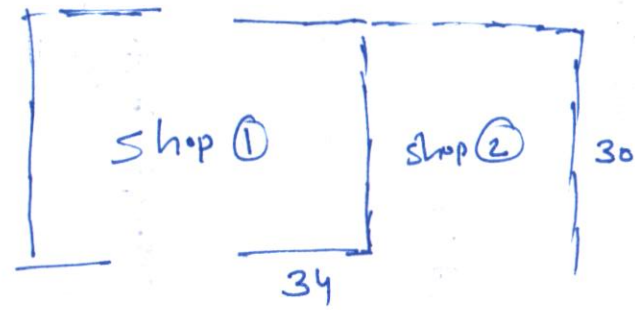

g.t.

1020 Sq<sup>2</sup>

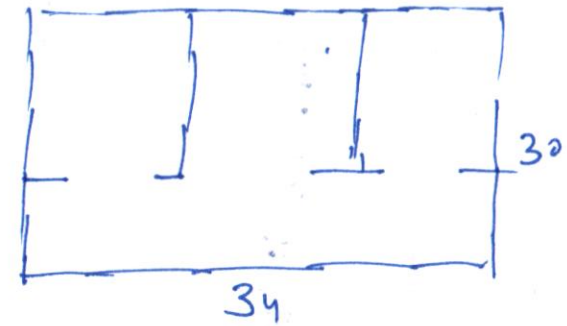

f.f.

10,20 Sq<sup>2</sup>