



**PARKING AREA STATEMENT (COMM.)**

BLDG. NO.	CAR PARKING REQUIRED	CAR PARKING PROVIDED	TWO WHEELER PARKING REQUIRED	TWO WHEELER PARKING PROVIDED
BLDG. NO.1	15	15	58	58
TOTAL	15	15	58	58

**PARKING AREA STATEMENT (RESI.)**

BLDG. NO.	WINGS/FLATS	CAR PARKING REQUIRED	CAR PARKING PROVIDED	TWO WHEELER PARKING REQUIRED	TWO WHEELER PARKING PROVIDED
BLDG. NO.2	10	4	4	8	8
BLDG. NO.3	A 173 B 173 C 118	73 73 49	80 80 49	201 201 175	159 159 175
BLDG. NO.4	55	23	29	81	45
TOTAL	529	222	242	666.00	546

1 CAR = 6 TWO WHEELER  
20 EXTRA CAR PROVIDED = 6 X 50 = 120 TWO WHEELER  
= 546 + 120 = 666 TWO WHEELER

**TENEMENT AREA STATEMENT**

BLDG. NOS.	SHOP NOS.	1RK NOS.	1BHK NOS.	2BHK NOS.	TOTAL FLATS
BLDG. NO.2	-	-	8	4	10
BLDG. NO.3	-	-	128	44	173
BLDG. NO.3	-	-	128	44	173
BLDG. NO.3	-	-	58	60	118
BLDG. NO.4	-	-	27	28	55
TOTAL	-	-	348	180	529

**TOTAL P-LINE AREA STATEMENT (COMM.)**

BLDG. NO.	WING NO.	NO. OF FLRS	TOTAL P-LINE AREA SQMT	REFUGE AREA SQMT	MT. ROOM AREA SQMT	STILT AREA SQMT	CONS. AREA SQMT
BLDG. NO.-1	-	OR + 4(P)	1866.04	-	-	-	1866.04

**TOTAL P-LINE AREA STATEMENT (RESI.)**

BLDG. NO.	WING NO.	NO. OF FLRS	TOTAL P-LINE AREA SQMT	REFUGE AREA SQMT	MT. ROOM AREA SQMT	STILT AREA SQMT	CONS. AREA SQMT
BLDG. NO.-2	ST + 1	-	798.04	-	8.16	490.85	1297.05
BLDG. NO.-3	WING-A ST + 22	-	10211.32	178.01	5.74	366.94	10760.01
BLDG. NO.-3	WING-B ST + 22	-	10125.72	177.51	6.12	314.87	10624.22
BLDG. NO.-3	WING-C ST + 15	-	7509.33	118.34	6.30	350.49	7984.66
TOTAL	-	-	27846.37	471.86	18.36	1032.30	29368.89
TOTAL (BLDG.2+ BLDG.3)	-	-	28644.41	471.86	26.52	1523.15	30665.94
GRAND TOTAL (I+II)	-	-	30510.45	471.86	26.52	1523.15	32531.98

**TOTAL P-LINE AREA STATEMENT (MHADA)**

BLDG. NO.	WING NO.	NO. OF FLRS	TOTAL P-LINE AREA SQMT	REFUGE AREA SQMT	MT. ROOM AREA SQMT	STILT AREA SQMT	CONS. AREA SQMT
BLDG. NO.-4	ST + 14	-	3371.49	58.52	6.86	150.64	3587.51
GRAND TOTAL (I+II+III)	-	-	33881.94	530.38	33.38	1673.79	36119.49

**BUILT-UP AREA STATEMENT (CLUB HOUSE)**

CLUB HOUSE	WING NO.	NO. OF FLRS	BUILT-UP AREA SQMTS	STAIRCASE AREA SQMT	MT. ROOM AREA SQMT	STILT AREA SQMTS	TOTAL CONS. AREA SQMTS
TOTAL	ST + 2(P)	-	122.07	35.84	-	71.58	229.49

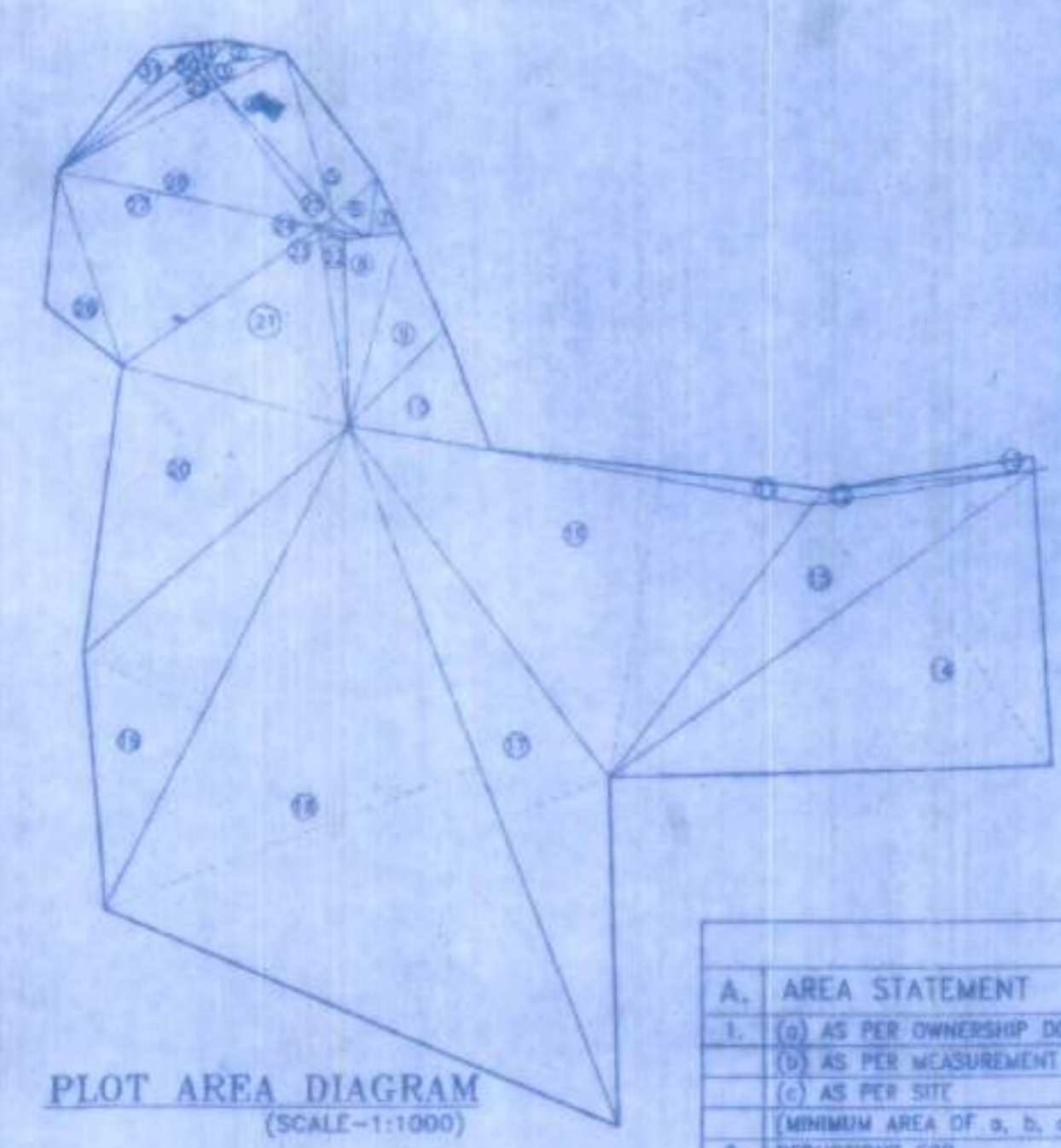

PLOT AREA CALCULATION

**(i) AREA UNDER 9.00 M/W D.P. ROAD**

- 5.39 x 3.03 x 0.50 = 8.17 SQ.M
- 12.48 x 3.30 x 0.50 = 20.59 SQ.M
- 12.48 x 3.38 x 0.50 = 21.09 SQ.M
- 27.01 x 11.28 x 0.50 = 152.34 SQ.M
- 26.35 x 8.13 x 0.50 = 107.11 SQ.M
- 9.00 x 6.14 x 0.50 = 27.63 SQ.M
- 9.39 x 4.74 x 0.50 = 22.28 SQ.M

TOTAL AREA = 359.18 SQ.M

**(ii) AREA UNDER P.G.**

- 31.15 x 8.30 x 0.50 = 129.27 SQ.M
- 31.15 x 10.50 x 0.50 = 163.53 SQ.M
- 22.30 x 17.30 x 0.50 = 192.89 SQ.M
- 52.50 x 2.60 x 0.50 = 68.25 SQ.M
- 34.90 x 2.00 x 0.50 = 34.90 SQ.M
- 32.50 x 2.13 x 0.50 = 34.61 SQ.M

TOTAL AREA = 623.45 SQ.M

**(iii) BALANCE PLOT AREA**

- 81.25 x 38.65 x 0.50 = 1570.15 SQ.M
- 81.25 x 15.80 x 0.50 = 641.87 SQ.M
- 72.90 x 47.00 x 0.50 = 1713.15 SQ.M
- 118.40 x 18.00 x 0.50 = 1047.60 SQ.M
- 118.40 x 62.08 x 0.50 = 3613.05 SQ.M
- 84.00 x 25.45 x 0.50 = 1068.90 SQ.M
- 54.20 x 29.70 x 0.50 = 804.87 SQ.M
- 37.25 x 27.55 x 0.50 = 513.12 SQ.M
- 31.02 x 3.51 x 0.50 = 54.44 SQ.M
- 8.03 x 2.25 x 0.50 = 9.02 SQ.M
- 8.03 x 2.17 x 0.50 = 8.71 SQ.M
- 26.98 x 2.91 x 0.50 = 39.26 SQ.M
- 31.87 x 8.32 x 0.50 = 132.58 SQ.M
- 41.50 x 27.50 x 0.50 = 570.63 SQ.M
- 41.50 x 17.94 x 0.50 = 372.87 SQ.M
- 28.00 x 3.59 x 0.50 = 50.26 SQ.M
- 29.39 x 3.24 x 0.50 = 47.61 SQ.M
- 29.39 x 4.27 x 0.50 = 62.75 SQ.M

TOTAL AREA = 12109.84 SQ.M

TOTAL PLOT AREA (I+II+III) = 13092.27 SQ.M

TOTAL PLOT AREA (7/12) = 12590.00 SQ.M

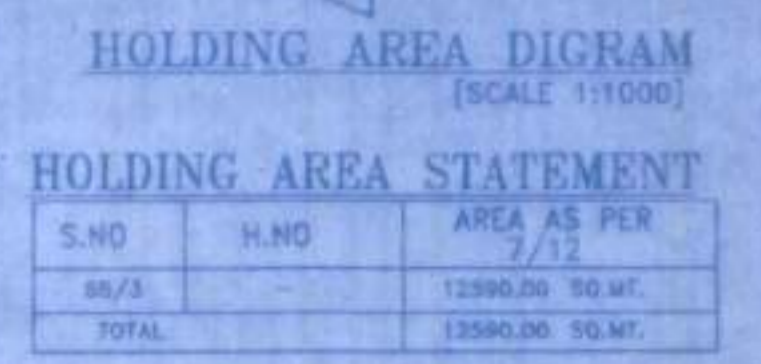

**HOLDING AREA STATEMENT**

S.NO	H.NO	AREA AS PER 7/12
88/3	-	13990.00 SQ.M.
TOTAL	-	13990.00 SQ.M.

**PROFORMA-I**

A. AREA STATEMENT	SQ.MTS.
1. (a) AS PER OWNERSHIP DOCUMENT (7/12)	12590.00
(b) AS PER MEASUREMENT SHEET	13082.27
(c) AS PER SITE	-
(MINIMUM AREA OF a, b, c, TO BE CONSIDERED)	12590.00
2. DEDUCTIONS FOR	-
a. AREA UNDER 9.00 M/W D.P. ROAD	359.18
b. AREA UNDER P.G. RESERVATION	623.45
TOTAL (a+b)	982.63
3. BALANCE AREA OF THE PLOT (1-2)	11607.37
4. AMENITY SPACE (IF APPLICABLE)	-
(a) REQUIRED-	-
(b) ADJUSTMENT OF 2(B) IF ANY-	-
(c) BALANCE PROPOSED-	11607.37
5. NET PLOT AREA (3-4(C))	11607.37
6. RECREATIONAL OPEN SPACE (IF APPLICABLE)	-
(a) REQUIRED-	1160.74
(b) PROPOSED-	1160.74
7. INTERNAL ROAD AREA	-
8. PLATABLE AREA (IF APPLICABLE)	-
9. BUILT UP AREA PERMISSIBLE WITH BASIC F.S.I.	(11607.37x1.10=12768.11)
10. REQUIRED 20% MHADA (B.U.A.)	(12768.11x20%=2553.62)
11. ADDITION OF FSI ON PAYMENT OF PREMIUM	-
(a) MAXIMUM PERMISSIBLE PREMIUM	(12590.00x0.50=6295.00)
(b) PROPOSED B.U.A. ON PAYMENT OF PREMIUM	-
12. IN-SITU FSI/TOR LOADING	-
(a) IN-SITU AREA D.P. ROAD (2.0 X SR.NO.2(G)), IF ANY	-
(b) IN-SITU AREA AGAINST AMENITY SPACE IF HANDED OVER (2.00 O/S/85 X SR.NO.4 (b) AND /OR (c))	-
(c) MAXIMUM TOR B.U.A. AREA PERMISSIBLE	(12590.00x0.65=8183.50)
(d) TOTAL IN-SITU/TOR LOADING PROPOSED	-
13. ADDITIONAL FSI AREA UNDER CHAPTER NO.7	-
14. MAXIMUM ENTITLEMENT OF FSI IN THE PROPOSAL EXCLUDING MHADA(9+11a)+12a	=37246.61
15. TOTAL ENTITLEMENT OF B.U.A. IN THE PROPOSAL EXCLUDING MHADA (9+11a)	19063.11
ANCILLARY AREA	-
16. (A) COMMERCIAL AREA	(1036.69x0.80)
(B) RESIDENTIAL AREA	(18026.42x0.60)
(C) TOTAL ANCILLARY AREA	11645.20
17. TOTAL PERMISSIBLE P-LINE AREA (EXCLUDING MHADA) AT PRESENT	(15+180)
18. TOTAL PROPOSED P-LINE AREA (EXCLUDING MHADA) AT PRESENT	30510.45
(A) PROPOSED COMMERCIAL AREA (AS PER P-LINE)	1866.04
(B) BUILT-UP AREA	(1866.04 / 1.80)
(C) 80% ANCILLARY AREA	(1866.04 - 1036.69)
(A) PROPOSED RESIDENTIAL EXCLUDING MHADA (AS PER P-LINE)	28644.41
(B) BUILT-UP AREA	(28644.41 / 1.80)
(C) 60% ANCILLARY AREA	(28644.41 - 17902.76)
20. (A) PROPOSED RESIDENTIAL EXCLUDING MHADA	28644.41
(B) BUILT-UP AREA	(28644.41 - 17902.76)
(C) 60% ANCILLARY AREA	10741.65
21. TOTAL PROPOSED BUILT-UP AREA EXCLUDING MHADA	(190+200)
22. TOTAL PROPOSED ANCILLARY AREA	11571.80
23. TOTAL MHADA AREA REQUIRED	2553.62
24. TOTAL MHADA AREA PROPOSED	2558.64

**PROFORMA II**

CONTENTS OF SHEET  
GR, IFT & TERRACE PLAN, BUILT UP AREA CALCULATION & DIAGRAM, ELEVATION & SECTION, PARKING STATEMENT, ETC.

**CERTIFICATE OF AREA**  
CERTIFICATE THAT THE PLOT UNDER REFERENCE WAS SURVEYED BY ME ON 30/3/2021, AND THE DIMENSIONS OF THE SIDE ETC. OF THE PLOT STATED ON THE PLANS ARE AS MEASURED ON SITE AND THE AREA SO MEASURED AND CALCULATED WITH THE AREA STATED IN THE DOCUMENTS OF OWNERSHIP.

Digital Signatures of Registered Engineer  
Licensed Surveyor/Engineer/Structural Engineer/Inspector

CERTIFIED THAT THE BUILDING PLANS SUBMITTED FOR APPROVAL SATISFY THE SAFETY REQUIREMENTS FOR STRUCTURES BEING CONSTRUCTED IN SEISMIC ZONE-II IS CORRECT TO THE BEST OF OUR KNOWLEDGE AND UNDERSTANDING.  
IT IS ALSO CERTIFIED THAT THE STRUCTURAL DESIGN INCLUDING SAFETY FROM NATURAL HAZARDS HAS BEEN PREPARED BY A QUALIFIED STRUCTURAL ENGINEER AT LEAST B.E.(DIP) OR EQUIVALENT.

SIGNATURE OF REGISTERED ENGINEER

**STAMP OF DATE OF RECEIPT OF PLANS**  
THIS PLAN SHALL NOT BE CONSIDERED AS PROOF OF OWNERSHIP FOR ANY DISPUTES IN ANY COURT OF LAW.

**STAMP OF APPROVAL OF PLANS**  
Approved as amended in...  
Subject to the conditions mentioned in this office letter No. VVCMC/PT/CO/VV/0152/2021/2022/2023/2024/2025/2026/2027/2028/2029/2030/2031/2032/2033/2034/2035/2036/2037/2038/2039/2040/2041/2042/2043/2044/2045/2046/2047/2048/2049/2050/2051/2052/2053/2054/2055/2056/2057/2058/2059/2060/2061/2062/2063/2064/2065/2066/2067/2068/2069/2070/2071/2072/2073/2074/2075/2076/2077/2078/2079/2080/2081/2082/2083/2084/2085/2086/2087/2088/2089/2090/2091/2092/2093/2094/2095/2096/2097/2098/2099/2100/2101/2102/2103/2104/2105/2106/2107/2108/2109/2110/2111/2112/2113/2114/2115/2116/2117/2118/2119/2120/2121/2122/2123/2124/2125/2126/2127/2128/2129/2130/2131/2132/2133/2134/2135/2136/2137/2138/2139/2140/2141/2142/2143/2144/2145/2146/2147/2148/2149/2150/2151/2152/2153/2154/2155/2156/2157/2158/2159/2160/2161/2162/2163/2164/2165/2166/2167/2168/2169/2170/2171/2172/2173/2174/2175/2176/2177/2178/2179/2180/2181/2182/2183/2184/2185/2186/2187/2188/2189/2190/2191/2192/2193/2194/2195/2196/2197/2198/2199/2200/2201/2202/2203/2204/2205/2206/2207/2208/2209/2210/2211/2212/2213/2214/2215/2216/2217/2218/2219/2220/2221/2222/2223/2224/2225/2226/2227/2228/2229/2230/2231/2232/2233/2234/2235/2236/2237/2238/2239/2240/2241/2242/2243/2244/2245/2246/2247/2248/2249/2250/2251/2252/2253/2254/2255/2256/2257/2258/2259/2260/2261/2262/2263/2264/2265/2266/2267/2268/2269/2270/2271/2272/2273/2274/2275/2276/2277/2278/2279/2280/2281/2282/2283/2284/2285/2286/2287/2288/2289/2290/2291/2292/2293/2294/2295/2296/2297/2298/2299/2300/2301/2302/2303/2304/2305/2306/2307/2308/2309/2310/2311/2312/2313/2314/2315/2316/2317/2318/2319/2320/2321/2322/2323/2324/2325/2326/2327/2328/2329/2330/2331/2332/2333/2334/2335/2336/2337/2338/2339/2340/2341/2342/2343/2344/2345/2346/2347/2348/2349/2350/2351/2352/2353/2354/2355/2356/2357/2358/2359/2360/2361/2362/2363/2364/2365/2366/2367/2368/2369/2370/2371/2372/2373/2374/2375/2376/2377/2378/2379/2380/2381/2382/2383/2384/2385/2386/2387/2388/2389/2390/2391/2392/2393/2394/2395/2396/2397/2398/2399/2400/2401/2402/2403/2404/2405/2406/2407/2408/2409/2410/2411/2412/2413/2414/2415/2416/2417/2418/2419/2420/2421/2422/2423/2424/2425/2426/2427/2428/2429/2430/2431/2432/2433/2434/2435/2436/2437/2438/2439/2440/2441/2442/2443/2444/2445/2446/2447/2448/2449/2450/2451/2452/2453/2454/2455/2456/2457/2458/2459/2460/2461/2462/2463/2464/2465/2466/2467/2468/2469/2470/2471/2472/2473/2474/2475/2476/2477/2478/2479/2480/2481/2482/2483/2484/2485/2486/2487/2488/2489/2490/2491/2492/2493/2494/2495/2496/2497/2498/2499/2500/2501/2502/2503/2504/2505/2506/2507/2508/2509/2510/2511/2512/2513/2514/2515/2516/2517/2518/2519/2520/2521/2522/2523/2524/2525/2526/2527/2528/2529/2530/2531/2532/2533/2534/2535/2536/2537/2538/2539/2540/2541/2542/2543/2544/2545/2546/2547/2548/2549/2550/2551/2552/2553/2554/2555/2556/2557/2558/2559/2560/2561/2562/2563/2564/2565/2566/2567/2568/2569/2570/2571/2572/2573/2574/2575/2576/2577/2578/2579/2580/2581/2582/2583/2584/2585/2586/2587/2588/2589/2590/2591/2592/2593/2594/2595/2596/2597/2598/2599/2600/2601/2602/2603/2604/2605/2606/2607/2608/2609/2610/2611/2612/2613/2614/2615/2616/2617/2618/2619/2620/2621/2622/2623/2624/2625/2626/2627/2628/2629/2630/2631/2632/2633/2634/2635/2636/2637/2638/2639/2640/2641/2642/2643/2644/2645/2646/2647/2648/2649/2650/2651/2652/2653/2654/2655/2656/2657/2658/2659/2660/2661/2662/2663/2664/2665/2666/2667/2668/2669/2670/2671/2672/2673/2674/2675/2676/2677/2678/2679/2680/2681/2682/2683/2684/2685/2686/2687/2688/2689/2690/2691/2692/2693/2694/2695/2696/2697/2698/2699/2700/2701/2702/2703/2704/2705/2706/2707/2708/2709/2710/2711/2712/2713/2714/2715/2716/2717/2718/2719/2720/2721/2722/2723/2724/2725/2726/2727/2728/2729/2730/2731/2732/2733/2734/2735/2736/2737/2738/2739/2740/2741/2742/2743/2744/2745/2746/2747/2748/2749/2750/2751/2752/2753/2754/2755/2756/2757/2758/2759/2760/2761/2762/2763/2764/2765/2766/2767/2768/2769/2770/2771/2772/2773/2774/2775/2776/2777/2778/2779/2780/2781/2782/2783/2784/2785/2786/2787/2788/2789/2790/2791/2792/2793/2794/2795/2796/2797/2798/2799/2800/2801/2802/2803/2804/2805/2806/2807/2808/2809/2810/2811/2812/2813/2814/2815/2816/2817/2818/2819/2820/2821/2822/2823/2824/2825/2826/2827/2828/2829/2830/2831/2832/2833/2834/2835/2836/2837/2838/2839/2840/2841/2842/2843/2844/2845/2846/2847/2848/2849/2850/2851/2852/2853/2854/2855/2856/2857/2858/2859/2860/2861/2862/2863/2864/2865/2866/2867/2868/2869/2870/2871/2872/2873/2874/2875/2876/2877/2878/2879/2880/2881/2882/2883/2884/2885/2886/2887/2888/2889/2890/2891/2892/2893/2894/2895/2896/2897/2898/2899/2900/2901/2902/2903/2904/2905/2906/2907/2908/2909/2910/2911/2912/2913/2914/2915/2916/2917/2918/2919/2920/2921/2922/2923/2924/2925/2926/2927/2928/2929/2930/2931/2932/2933/2934/2935/2936/2937/2938/2939/2940/2941/2942/2943/2944/2945/2946/2947/2948/2949/2950/2951/2952/2953/2954/2955/2956/2957/2958/2959/2960/2961/2962/2963/2964/2965/2966/2967/2968/2969/2970/2971/2972/2973/2974/2975/2976/2977/2978/2979/2980/2981/2982/2983/2984/2985/2986/2987/2988/2989/2990/2991/2992/2993/2994/2995/2996/2997/2998/2999/3000/3001/3002/3003/3004/3005/3006/3007/3008/3009/3010/3011/3012/3013/3014/3015/3016/3017/3018/3019/3020/3021/3022/3023/3024/3025/3026/3027/3028/3029/3030/3031/3032/3033/3034/3035/3036/3037/3038/3039/3040/3041/3042/3043/3044/3045/3046/3047/3048/3049/3050/3051/3052/3053/3054/3055/3056/3057/3058