

Valuation Report of the Immovable Property



Details of the property under consideration:

Name of Owner: **Mr. Milind Vijay Nirgude & Ms. Kirti Jayant Kalaskar**
(After Marriage) **Mrs. Kirti Milind Nirgude**

Residential Flat No. 1202, 12th Floor, A - Wing, " **Shreeji Infinia** ", Survey No. 848 / 1 to 9 / 849 / 1 / 1 & 2,
Plot No. 1 / 2 / 1, Kashmire Mala, Near Metro Mall & Dream Citi, Uttara Nagar, Ramdas Swami Marg, Tapovan
Road, Village – Nashik, Taluka – Nashik, District - Nashik, PIN Code – 422 006,
State – Maharashtra, Country – India.

Latitude Longitude: 19°58'54.0"N 73°48'35.5"E

Valuation Prepared for:

Bank of Baroda
Regional Office Nashik Road Branch
BSNL Building, Datta Mandir Road, Nashik Road,
Nashik -422 101, State - Maharashtra, Country - India.



Nashik : 4, 1st Floor, Madhusa Elite, Vrundavan Nagar, Jatra-Nandur Naka Link Road, Adgaon, Nashik - 422 003, (M.S.)
E-mail : nashik@vastukala.org, Tel. : +91 253 4068262 / 9890380564

Our Pan India Presence at :

Mumbai **Aurangabad** **Pune** **Rajkot**
Thane **Nanded** **Indore** **Raipur**
Delhi NCR **Nashik** **Ahmedabad** **Jaipur**

Regd. Office : B1-001, U/B Floor, Boomerang,
Chandivali Farm Road, Andheri (East),
Mumbai - 400 072, (M.S.), INDIA
TeleFax : +91 22 28371325/24
mumbai@vastukala.org



VALUATION OPINION REPORT

This is to certify that the property bearing Residential Flat No. 1202, 12th Floor, A - Wing, " Shreeji Infinia ", Survey No. 848 / 1 to 9 / 849 / 1 / 1 & 2, Plot No. 1 / 2 / 1, Kashmire Mala, Near Metro Mall & Dream Citi, Uttara Nagar, Ramdas Swami Marg, Tapovan Road, Village – Nashik, Taluka – Nashik, District - Nashik, PIN Code – 422 006, State – Maharashtra, Country – India belongs to **Mr. Milind Vijay Nirgude & Ms. Kirti Jayant Kalaskar (After Marriage) Mrs. Kirti Milind Nirgude.**

Boundaries of the property.

Boundaries	Building	Flat
North	9 M. Colony Road	Marginal Space
South	30 M. DP Road & Survey No. 847	Staircase
East	30 M. DP Road.	Flat No. B-1203
West	Open Space	Marginal Space

Considering various parameters recorded, existing economic scenario, and the information that is available with reference to the development of neighborhood and method selected for valuation, we are of the opinion that, the property premises can be assessed for this particular purpose at **₹ 74,47,900.00 (Rupees Seventy-Four Lakh Forty-Seven Thousand Nine Hundred Only)**. As per Site Inspection **32%** Construction Work is completed

The valuation of the property is based on the documents produced by the concern. Legal aspects have not been taken into considerations while preparing this valuation report.

Hence certified

For **VASTUKALA CONSULTANTS (I) PVT. LTD.**

**MANOJ BABURAO
CHALIKWAR**

Director

Manoj B. Chalikwar

Registered Valuer

Chartered Engineer (India)

Reg. No. CAT-I-F-1763

Reg. No. IBBI/RV/07/2018/10366

BOB Empanelment No.: ZO:MZ:ADV:46:941

Encl: Valuation report.

Digitally signed by MANOJ BABURAO CHALIKWAR
DN: cn=, o=VASTUKALA CONSULTANTS (I) PRIVATE LIMITED,
ou=admin,
2.5.4.20=9822216c4fad35dc03e0cf39e26665913490c3d33c4b3
33115279b17a18b5652, postalCode=400005, st=Maharashtra,
serialNumber=1a56a566abbcc9d6b2a55a8f6cfc851f91b0,
2a394e2b7e29a327b625bfc, cn=MANOJ BABURAO
CHALIKWAR
Date: 2023.11.20 17:00:24 +05'30'

Auth. Sign.



Nashik : 4, 1st Floor, Madhusa Elite, Vrundavan Nagar, Jatra-Nandur Naka Link Road, Adgaon, Nashik - 422 003, (M.S.)
E-mail : nashik@vastukala.org, Tel. : +91 253 4068262 / 9890380564

Our Pan India Presence at :

- Mumbai
- Thane
- Delhi NCR
- Aurangabad
- Nanded
- Nashik
- Pune
- Indore
- Ahmedabad
- Rajkot
- Raipur
- Jaipur

Regd. Office : B1-001, U/B Floor, Boomerang, Chandivali Farm Road, Andheri (East), **Mumbai** - 400 072, (M.S.), INDIA
TeleFax : +91 22 28371325/24
mumbai@vastukala.org

Vastukala Consultants (I) Pvt. Ltd.B1-001, U/B Floor, **Boomerang**, Chandivali Farm Road, Powai, Andheri (East), Mumbai – 400 072.

To,
The Chief Manager,
Bank of Baroda
Regional Office Nashik Road Branch
 BSNL Building, Datta Mandir Road, Nashik Road,
 Nashik -422 101, State - Maharashtra, Country - India.

VALUATION REPORT (IN RESPECT OF FLAT)

I		General	
1.	Purpose for which the valuation is made	:	To assess Fair Market value of the property for Bank Loan Purpose.
2.	a)	Date of inspection	: 20.11.2023
	b)	Date on which the valuation is made	: 20.11.2023
3.	List of documents produced for perusal:		
	i.	Copy of Agreement for Sale Vide No. 13425/ 2023 Dated.30.10.2023	
	ii.	Copy of Approved Building Plan Accompanying Commencement No. A4 / BP / 94 / 2022 dated 30.06.2022 issued by Nashik Municipal Corporation.	
	iii.	Copy of Commencement Certificate No. LND / BP / A4 / 94 / 2022 dated 30.06.2022 issued by Nashik Municipal Corporation.	
	iv.	Copy of RERA Registration Certificate No. P51600031713 Dated.08.11.2021 issued by Maharashtra Real Estate Regulatory Authority	
4.	Name of the owner(s) and his / their address (es) with Phone no. (details of share of each owner in case of joint ownership)	:	Mr. Milind Vijay Nirgude & Ms. Kirti Jayant Kalaskar (After Marriage) Mrs. Kirti Milind Nirgude Address: Residential Flat No. 1202, 12 th Floor, A - Wing, "Shreeji Infinia", Survey No. 848 / 1 to 9 / 849 / 1 / 1 & 2, Plot No. 1 / 2 / 1, Kashmire Mala, Near Metro Mall & Dream Citi, Uttara Nagar, Ramdas Swami Marg, Tapovan Road, Village – Nashik, Taluka – Nashik, District – Nashik, PIN Code – 422 006, State – Maharashtra, Country – India. Contact Person: Mr. Anil Galwad (Site Supervisor) Contact No. 8087054029 Sole Ownership
5.	Brief description of the property (Including Leasehold / freehold etc.)	:	The property is a Residential Flat No. 1202 is located on 12th Floor. As per approved Plan, the property is Living Room + Kitchen + 3 Bedroom + 1 Attached Toilets + 1 Common Toilets + Passage + Balcony (i.e. 3BHK) The property is at 5.5 Km. distance from nearest railway station Nashik Road.



Think.Innovate.Create

Vastukala Consultants (I) Pvt. Ltd.

An ISO 9001:2015 Certified Company

www.vastukala.org



			Landmark: Near Metro Mall & Dream Citi At the time of inspection, the property was under construction, Extent of completion are as under:
Stage of Construction			
If under construction, extent of completion			
	RCC Footing/Foundation	Completed	RCC Plinth
	Full Building RCC	Completed up to 9 th Slab	
		Total	32% work completed
5a.	Total Lease Period & remaining period (if leasehold)	:	N.A. as the property is freehold.
6.	Location of property	:	
a)	Plot No. / Survey No.	:	Survey No. 848 / 1 to 9 / 849 / 1 / 1 & 2, Plot No. 1 / 2 / 1
b)	Door No.	:	Residential Flat No. 1202
c)	T.S. No. / Village	:	Village – Nashik
d)	Ward / Taluka	:	Taluka – Nashik
e)	Mandal / District	:	District – Nashik
f)	Date of issue and validity of layout of approved map / plan	:	Copy of Approved Building Plan Accompanying Commencement No. A4 / BP / 94 / 2022 dated 30.06.2022 issued by Nashik Municipal Corporation.
g)	Approved map / plan issuing authority	:	Nashik Municipal Corporation
h)	Whether genuineness or authenticity of approved map/ plan is verified	:	Yes
i)	Any other comments by our empanelled valuers on authentic of approved plan	:	No
7.	Postal address of the property	:	Residential Flat No. 1202, 12 th Floor, A - Wing, " Shreeji Infinia ", Survey No. 848 / 1 to 9 / 849 / 1 / 1 & 2, Plot No. 1 / 2 / 1, Kashmire Mala, Near Metro Mall & Dream Citi, Uttara Nagar, Ramdas Swami Marg, Tapovan Road, Village – Nashik, Taluka – Nashik, District - Nashik, PIN Code – 422 006, State – Maharashtra, Country – India.
8.	City / Town	:	Nashik
	Residential area	:	Yes
	Commercial area	:	Yes
	Industrial area	:	No
9.	Classification of the area	:	
i)	High / Middle / Poor	:	Middle Class
ii)	Urban / Semi Urban / Rural	:	Urban
10.	Coming under Corporation limit / Village Pan Chhayat / Municipality	:	Village – Nashik Nashik Municipal Corporation
11.	Whether covered under any State / Central Govt. enactments (e.g., Urban Land Ceiling Act) or notified under agency area/ scheduled area / cantonment area	:	No

4.	Year of Construction	:	Building is Under Construction
5.	Number of Floors	:	Basement + Ground + 14 TH Upper Floors
6.	Type of Structure	:	R.C.C. Framed Structure
7.	Number of Dwelling units in the building	:	4 Flats on 12 th Floor
8.	Quality of Construction	:	Building is Under Construction
9.	Appearance of the Building	:	Building is Under Construction
10.	Maintenance of the Building	:	Building is Under Construction
11.	Facilities Available	:	
	Lift	:	Proposed 2 Lifts
	Protected Water Supply	:	Proposed Municipal Water supply
	Underground Sewerage	:	Proposed Connected to Municipal Sewerage System
	Car parking - Open / Covered	:	Basement Car Parking
	Is Compound wall existing?	:	Proposed -Yes
	Is pavement laid around the building	:	Proposed -Yes
III	FLAT		
1	The floor in which the Flat is situated	:	12 th Floor
2	Door No. of the Flat	:	Residential Flat No. 1202
3	Specifications of the Flat	:	
	Roof	:	R.C.C. Slab
	Flooring	:	Proposed Vitrified tile Flooring
	Doors	:	Proposed Teak Wood door framed with flush doors
	Windows	:	Proposed Aluminum sliding window with M.S. Grills
	Fittings	:	Proposed Concealed Plumbing, Concealed Electrical wiring
	Finishing	:	Proposed Cement Plastering
	Paint	:	Proposed Distemper Paint
4	House Tax	:	
	Assessment No.	:	Not Yet Applied
	Tax paid in the name of:	:	Not Yet Applied
	Tax amount:	:	Not Yet Applied
5	Electricity Service connection No.:	:	Not Yet Applied
	Meter Card is in the name of:	:	Not Yet Applied
6	How is the maintenance of the Flat?	:	Building is Under Construction
7	Sale Deed executed in the name of	:	Mr. Milind Vijay Nirgude & Ms. Kirti Jayant Kalaskar (After Marriage) Mrs. Kirti Milind Nirgude.
8	What is the undivided area of land as per Sale Deed?	:	Details not available
9	What is the plinth area of the Flat?	:	Built up Area in Sq. Ft. = 1154.00 (Carpet area as per Agreement for Sale + 10%)
10	What is the floor space index (app.)	:	As per NMC norms
11	What is the Carpet Area of the Flat?	:	Carpet Area in Sq. Ft. = 929.00 Balcony Area in Sq. Ft. = 120.00 Total Carpet Area in Sq. Ft = 1049.00 (Area as per Agreement for Sale)
12	Is it Posh / I Class / Medium / Ordinary?	:	
13	Is it being used for Residential or Commercial purpose?	:	Proposed Residential Cum Commercial purpose
14	Is it Owner-occupied or let out?	:	Building is Under Construction
15	If rented, what is the monthly rent?	:	₹ 15,500.00 Expected rental income per month after building; completion



IV	MARKETABILITY	:	
1	How is the marketability?	:	Good
2	What are the factors favouring for an extra Potential Value?	:	Located in developing area
3	Any negative factors are observed which affect the market value in general?	:	No
V	Rate	:	
1	After analyzing the comparable sale instances, what is the composite rate for a similar Flat with same specifications in the adjoining locality? - (Along with details / reference of at least two latest deals / transactions with respect to adjacent properties in the areas)	:	₹ 6,500.00 to ₹ 7,500.00 per Sq. Ft. on Carpet Area
2	Assuming it is a new construction, what is the adopted basic composite rate of the Flat under valuation after comparing with the specifications and other factors with the Flat under comparison (give details).	:	₹ 7,100.00 per Sq. Ft. on Carpet Area
3	Break – up for the rate	:	
	i) Building + Services	:	₹ 2,000.00 per Sq. Ft.
	ii) Land + others	:	₹ 5,100.00 per Sq. Ft.
4	Guideline rate obtained from the Registrar's office (an evidence thereof to be enclosed)	:	₹ 39,616.00 per Sq. M. ₹ 3,680.00 per Sq. Ft.
	Guideline rate obtained (after Depreciation)	:	Building is Under Construction
5	Registered Value / Draft Agreement (if available)	:	-
VI	COMPOSITE RATE ADOPTED AFTER DEPRECIATION		
a	Depreciated building rate	:	Building is Under Construction
	Replacement cost of Flat with Services (v(3)i)	:	₹ 2,000.00 per Sq. Ft.
	Age of the building	:	Building is Under Construction
	Life of the building estimated	:	60 years after Completion Subject to proper, preventive periodic maintenance & structural repairs.
	Depreciation percentage assuming the salvage value as 10%	:	Building is Under Construction
	Depreciated Ratio of the building	:	Building is Under Construction
b	Total composite rate arrived for Valuation	:	
	Depreciated building rate VI (a)	:	₹ 2,000.00 per Sq. Ft.
	Rate for Land & other V (3) ii	:	₹ 5,100.00 per Sq. Ft.
	Total Composite Rate	:	₹ 7,100.00 per Sq. Ft.

Details of Valuation:

Sr. No.	Description	Qty.	Rate per unit (₹)	Estimated Value (₹)
1	Present value of the Flat	1049.00 Sq. Ft.	7,100.00	74,47,900.00
2	Addition Cost As per Cost Sheet			
3	Wardrobes			
4	Showcases			
5	Kitchen arrangements			

6	Superfine finish			
7	Interior Decorations			
8	Electricity deposits / electrical fittings, etc.			
9	Extra collapsible gates / grill works etc.			
10	Potential value, if any			
11	Others			
12	As per current stage of work completion the value of the Flat (if Flat is under construction)			
13	After 100% completion final value of Flat			
	Total Value of the property			74,47,900.00

Value of Flat

Fair Market Value of the property	74,47,900.00
Realizable value of the property	70,75,505.00
Distress Value of the property	59,58,320.00
Insurable value of the property (1154.00 Sq. Ft. X ₹ 2,000.00)	23,08,000.00
Guideline value of the property (1154.00 Sq. Ft. X ₹ 3,680.00)	42,46,720.00

Justification for price / rate

The Market Value of the property is based on facts of markets discovered by us during our enquiries, however the government rate value in this case is less than the market value arrived by us. We are of the opinion that the value arrive by us will prove to be correct if an Auction of the subject property is carried out. As far as Market Value in Index II is concerned, it is not possible to comment on same, may be government rates are fixed by sampling during same point of time in part and whereas, Market values change every month.

In most of the cases the actual deal amount or Transaction value is not reflected in Index II because of various Market practices. As Valuer, we always try to give a value which is correct reflection of actual transaction value irrespective of any factors in market.

Method of Valuation / Approach

The sales comparison approach uses the market data of sale prices to estimate the value of a real estate property. Property valuation in this method is done by comparing a property to other similar properties that have been recently sold. Comparable properties, also known as comparables, or comps, must share certain features with the property in question. Some of these include physical features such as square footage, number of rooms, condition, and age of the building; however, the most important factor is no doubt the location of the property. Adjustments are usually needed to account for differences as no two properties are exactly the same. To make proper adjustments when comparing properties, real estate appraisers must know the differences between the comparable properties and how to value these differences. The sales comparison approach is commonly used for Residential Flat, where there are typically many comparables available to analyze. As the property is a Residential Flat, we have adopted Sale



Think.Innovate.Create

Vastukala Consultants (I) Pvt. Ltd.

An ISO 9001:2015 Certified Company

www.vastukala.org



Comparison Approach Method for the purpose of valuation. The Price for similar type of property in the nearby vicinity is in the range of ₹ 6,500.00 to ₹ 7,500.00 per Sq. Ft. on Carpet Area. Considering the rate with attached report, current market conditions, demand and supply position, Flat size, location, upswing in real estate prices, sustained demand for Residential Flat, all-round development of commercial and residential application in the locality etc. We estimate ₹ 7,100.00 per Sq. Ft. on Carpet Area for valuation.

Impending threat of acquisition by government for road widening / public service purposes, sub merging & applicability of CRZ provisions (Distance from sea-cost / tidal level must be incorporated) and their effect on	Not applicable.
i) Saleability	Good
ii) Likely rental values in future in and	₹ 15,500.00 Expected rental income per month after building; completion
iii) Any likely income it may generate	Rental Income

Think.Innovate.Create

Actual site photographs



Route Map of the property

Site u/r

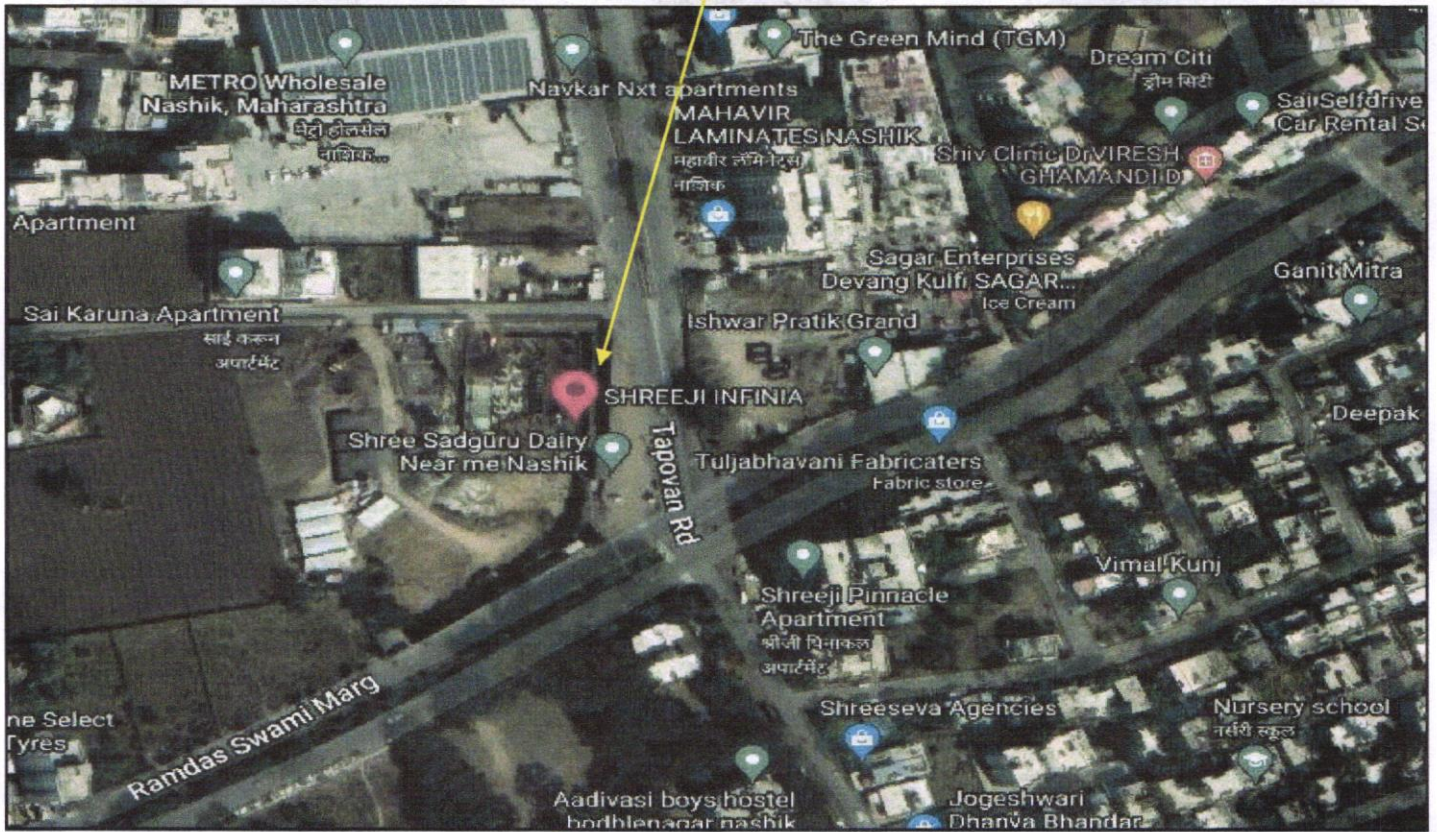

Latitude Longitude: 19°58'54.0"N 73°48'35.5"E

Note: The Blue line shows the route to site from nearest railway station (Nashik Road – 5.5 Km.)



Think.Innovate.Create

Vastukala Consultants (I) Pvt. Ltd.

An ISO 9001:2015 Certified Company

www.vastukala.org



Ready Reckoner Rate



**Department of
Registration & Stamps**
Government Of Maharashtra

**नोंदणी व मुद्रांक
विभाग**
महाराष्ट्र शासन



Valuation
Home
Rate Guidelines
LOGOUT

Location Details

Select Type Development Agreement Tenant Occupied Other

Division Name Nashik Help on Division

District Name	नाशिक	Taluka Name	नाशिक												
Attribute	सर्व्हे नंबर 843	Village/Zone Name	मीने नाशिक - गावठाण , न												
Mahapalika Area	Nashik Muncipal Corj														
<table border="1" style="width: 100%; border-collapse: collapse;"> <thead> <tr> <th style="width: 25%;">Open Land</th> <th style="width: 25%;">Residence</th> <th style="width: 25%;">Office</th> <th style="width: 25%;">Shop</th> <th style="width: 25%;">Industry</th> <th style="width: 25%;">Unit</th> </tr> </thead> <tbody> <tr> <td style="text-align: center;">11900</td> <td style="text-align: center; border: 2px solid red;">34300</td> <td style="text-align: center;">39440</td> <td style="text-align: center;">42870</td> <td style="text-align: center;">0</td> <td style="text-align: center;">Square Meter</td> </tr> </tbody> </table>				Open Land	Residence	Office	Shop	Industry	Unit	11900	34300	39440	42870	0	Square Meter
Open Land	Residence	Office	Shop	Industry	Unit										
11900	34300	39440	42870	0	Square Meter										

Think.Innovate.Create



Price Indicators

60.0 Lac [Get ₹ 18,000 cashback on Home Loan](#)

2 BHK 1028 Sq-ft Flat For Sale In **Bodhale Nagar, Nashik**



2 Beds 2 Baths 2 Balconies Unfurnished

Carpet Area 740 sqft = 8,108/sqft	Floor 12 (Out of 13 Floors)	Transaction Type Resale
Additional Rooms 1 Store Room	Facing East	Furnished Status Unfurnished
Type Of Ownership Freehold	Age Of Construction Under Construction	

+9 Photos

magicbricks Buy Rent Sell Home Loans

Hi, nishidat... [Post Property](#)

Home > Property for sale in Nashik > Flats for Sale in Nashik > Flats for Sale in Divalda-Nashik > 2BHK Flats for Sale in Divalda-Nashik > 972 Sqft

Posted on: Nov 14, 23 Property ID: 66337691

55.3 Lac [EMI - 1.25k](#) [How much loan can I get?](#)

2 BHK 972 Sq-ft Flat For Sale **Dwarka-Nashik, Nashik**



2 Beds 2 Baths 1 Covered Parking Unfurnished

Super Built-Up Area 972 sqft = 9,664/sqft	Developer Jay Developers	Project Sai Court
Transaction Type New Property	Status Under Construction	Lifts 2
Furnished Status Unfurnished	Car Parking 1 Covered	

+7 Photos

[Contact Builder](#) [Get Phone No.](#)

[Download Brochure](#)

Price Indicators

magicbricks
Buy ▾
Rent ▾
Sell ▾
Home Loans ▾

Home > Property for sale in Nashik > Flats for Sale in Nashik > Flats for Sale in Dwarka-Nashik > 2 BHK Flats for Sale in Dwarka-Nashik > 1302 Sq-ft

60.5 Lac [Get ₹18,162 cashback on Home Loan](#)
✔ ZERO BROKERAGE

2 BHK 1302 Sq-ft Flat For Sale [Dwarka Nashik, Nashik](#)

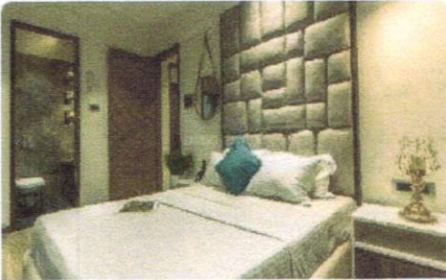

🛏 2 Beds
🚿 2 Baths
🚗 2 Covered Parking
🏠 Unfurnished

Super Built-Up Area
1302 sqft ▾
= 4,600/sqft

Developer
Samnani Group

Project
Ishwar Pratik Grand

Transaction Type
New Property

Status
Under Construction

Lifts
2

Furnished Status
Unfurnished

Car Parking
2 Covered

+47 Photos

magicbricks
Buy ▾
Rent ▾
Sell ▾
Home Loans ▾

Home > Property for sale in Nashik > Flats for Sale in Nashik > Flats for Sale in Dwarka-Nashik > 2 BHK Flats for Sale in Dwarka-Nashik > 1157 Sq-ft

53.8 Lac [Get ₹16,140 cashback on Home Loan](#)
✔ ZERO BROKERAGE

2 BHK 1157 Sq-ft Flat For Sale [Dwarka Nashik, Nashik](#)



🛏 2 Beds
🚿 2 Baths
🚗 2 Covered Parking
🏠 Unfurnished

Super Built-Up Area
1157 sqft ▾
= 4,600/sqft

Developer
Samnani Group

Project
Ishwar Pratik Grand

Transaction Type
New Property

Status
Under Construction

Lifts
2

Furnished Status
Unfurnished

Car Parking
2 Covered

+47 Photos

Approved Plan

<p>Drawing Sheet No. DT/08</p> <p>PROPOSED COMMERCIAL CUM RESIDENTIAL BUILDING PLAN</p> <p>PLOT NO .1/2/1, S.NO - 848/ 1 TO 9 / 849/1/1 TO 2</p> <p>MAUJE - NASHIK</p> <p>FOR : SMT. VITHABAI VEDU KASHMIRE & OTHERS SIX THROUGH G.P.A. HOLDER SHREEJI LIFESPACE</p>
<p>STAMP FOR APPROVAL</p> <p>APPROVED</p> <p>The Plans amended in As per the conditions Mentioned in the accompanying commencement Certificate No. 134/BP dated 20/06/2022 <i>24/12/2022</i></p> <p style="text-align: center;">  Executive Engineer TOWN PLANING Nashik Municipal Corporation Nashik </p>

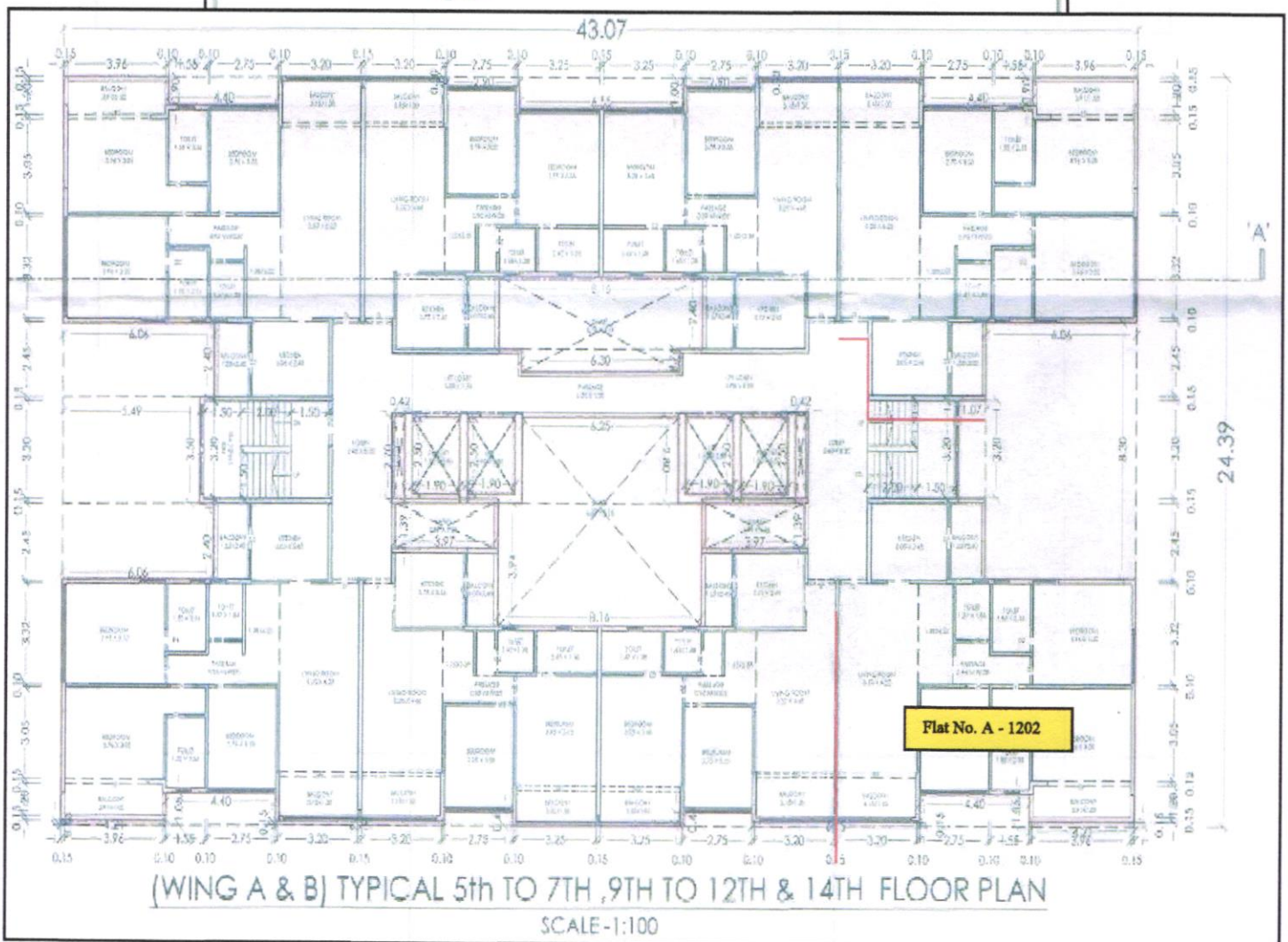

Agreement of Sale

Zone No.	1.3.21
Carpet area	86.28 Sq. Mtrs.
Balcony area	11.14 Sq. Mtrs.
Govt. Valuation Rate	Rs. 34,300/- Per Sq. Mtrs.
Govt. Valuation	Rs. 39,51,330/-
Consideration amount	Rs. 74,90,987/-
Stamp Duty of	Rs. 4,49,500/-
Reg. Fees of	Rs. 30,000/-

AGREEMENT FOR SALE

This Agreement for Sale made and executed on this 30th Day of October in the year, 2023 at Nashik, Tal. and Dist. Nashik.

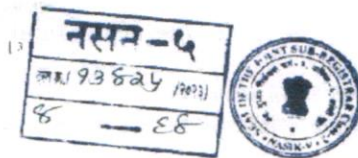

AND

1. MR. MILIND VIJAY NIRGUDE

Age - 42 Years, Occupation - Service
Pan No. **AFZPN9634D**
Aadhar No. **9398 2187 7501**

2. MS. KIRTI JAYANT KALASKAR

After Marriage

MRS. KIRTI MILIND NIRGUDE

Age - 39 Years, Occupation - Service
Pan No. **BCQPK2342L**
Aadhar No. **5680 9836 6473**

Mob. No. **9766714441**

Email Id. - milindnirgude@gmail.com

Both R/o. Dwarka House No. 3620, Kathada Shivaji Chowk, Nashik - 422001.

Hereinafter called "The Purchaser (S) / Allottee (s)" (which expression shall unless it be repugnant to the context or meaning thereof mean and include his / her / their heirs' executors, administrators and assigns)

WHEREAS

01. HISTORY OF LAND -

- 1.1 **Ownership Of Land** - The Land bearing S. No. 848/1to9, 849/1, 849/1/1 and 849/1/2 owned and possessed by the respective owners as shown in table below -

Survey No.	Area	Name of the Owner
S. No. 848/1	1100.00 Sq. Mtrs.	Vithabai Vedu Kashmiri.
S. No. 848/2	2000.00 Sq. Mtrs	Vedu Ghaman Kashmiri.
S. No. 848/3	766.00 Sq. Mtrs	Jayashree Balasaheb Kashmiri.
S. No. 848/4	2000.00 Sq. Mtrs	Jayashree Balasaheb Kashmiri.
S. No. 848/5	2000.00 Sq. Mtrs	Owned jointly by Land Owners No. 1 to 6
S. No. 848/6	766.00 Sq. Mtrs	Dnyaneshwar Piraji Patil.
S. No. 848/7	761.00Sq. Mtrs	Vedu Ghaman Kashmiri.
S. No. 848/8	2300.00 Sq. Mtrs	Balasaheb Vedu Kashmiri.
S. No. 848/9	2300.00Sq. Mtrs	Sadashiv Vedu Kashmiri.
S. No. 849/1	2050.00 Sq. Mtrs.	Owned jointly by Land Owners No. 1 to 6
S.No. 849/1/1	1950.00Sq. Mtrs	Jayashree Balasaheb Kashmiri.
S. No. 849/1/2	1000.00 Sq. Mtrs	Vithabai Vedu Kashmiri.

- 1.2 **N.A. Permission** - The owners converted the use of the land as mentioned above into Non-Agricultural Residential +Commercial

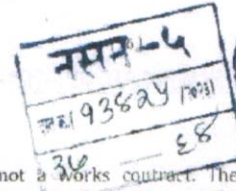

62. This is not a works contract. The Promoters are not a contractor appointed by the Purchaser/Allottee(s).

SCHEDULE-I

OF THE SAID PROPERTY ABOVE REFERRED TO

THE FIRST SCHEDULE ABOVE REFERRED TO:

(Description of the Property)

All that piece and parcel of land lying, being and situate at village - Nashik bearing Plot No. 1/2/1, area adm. 4840.00 Sq. Mtrs., (area adm. 15.00 Sq. Mtrs., acquired by Nashik Municipal Corporation Nashik out of total area adm. 4855.00 Sq. Mtrs., of Plot No. 1/2/1), out of Survey No. 848 / 1 to 9 / 849 / 1 / 1 & 2, and D. P. Road Widening F.S.I area adm. 700.00 Sq. Mtrs., situated at Village - Nashik Within the local limits of the Nashik Municipal Corporation Nashik, and bounded as follows -

On or towards East : 30 Mtrs. DP Road.
On or towards West : Open Space.
On or towards North : 9 Mtrs. Colony Road.
On or towards South : 30 Mtrs DP Road & Survey No. 847.

together with all easement rights etc.

SCHEDULE-II

The Flat in ongoing scheme/project known as "SHREEJI INFANIA" having Flat No. 1202 on the 12th Floor (Twelfth Floor), area admeasuring carpet 86.28 Sq. Mtrs. (928.71 Sq. Ft.) + Balcony area 11.14 Sq. Mtrs., (119.91 Sq. Ft.) Total area adm. 97.42 Sq.mtrs. constructed / to be constructed in Wing "A" of the Project called "SHREEJI INFANIA". The same is bounded as shown below: -

East : Flat No. A - 1203
West : Marginal Space
North : Marginal Space
South : Staircase

Together with right to use, the Lift provided to the building in common and together with right to use common spaces, staircase, terrace etc.

SCHEDULE-III (amenities)

(R.C.C.): -	R.C.C. Frame structured
(Brickworks):	External Brick work 150 mm thick AAC Blocks. Internal Brick Work 100 mm thick AAC Blocks.
(Plaster Work):-	Double coat artificial sand finish plaster to the outer side of exterior walls. Gypsum plaster for internal walls.
(Flooring): -	800 mm * by 800 / 600 /1200 mm size flooring for LIVING, KITCHEN and DINING. 600 mm * 600 mm size flooring for other rooms.

As a result of my appraisal and analysis, it is my considered opinion that the **Fair Market Value** for this particular above property in the prevailing condition with aforesaid specification is **₹ 74,47,900.00 (Rupees Seventy-Four Lakh Forty-Seven Thousand Nine Hundred Only)**. The **Realizable Value** of the above property is **₹ 70,75,505.00 (Rupees Seventy Lakh Seventy-Five Thousand Five Hundred Five Only)** and the **Distress Value** is **₹ 59,58,320.00 (Rupees Fifty-Nine Lakh Fifty-Eight Thousand Three Hundred Twenty Only)**. As per Site Inspection **32% Construction Work** is completed

Place: Nashik

Date: 20.11.2023

For **VASTUKALA CONSULTANTS (I) PVT. LTD.**

**MANOJ BABURAO
CHALIKWAR**

Director

Manoj B. Chalikwar

Registered Valuer

Chartered Engineer (India)

Reg. No. CAT-I-F-1763

Reg. No. IBBI/RV/07/2018/10366

BOB Empanelment No.: ZO:MZ:ADV:46:941

Digitally signed by MANOJ BABURAO CHALIKWAR
DN: cn=MANOJ BABURAO CHALIKWAR, o=VASTUKALA CONSULTANTS (I) PRIVATE LIMITED,
ou=admins, 2.5.4.20=9822b6c4fad35dc03e0c79e26865914590d3495f133311
5279b17a18b5652, postalCode=400069, st=Maharashtra,
serialNumber=41a5a565a6b8c39a82a55a8f6c39e3917a22289,
4a287a29a227b4258fc, cn=MANOJ BABURAO CHALIKWAR
Date: 2023.11.20 17:01:09 +05'30'

Auth. Sign.

Enclosures		
	Declaration from the valuer (Annexure – I)	Attached
	Model code of conduct for valuer (Annexure – II)	Attached

The undersigned has inspected the property detailed in the Valuation Report dated _____

on _____. We are satisfied that the fair and reasonable market value of the property is
₹ _____ (Rupees _____

only).

Date

Signature
(Name Branch Official with seal)

(Annexure – I)

DECLARATION FROM VALUERS

I, Manoj Chalikwar son of Shri. Baburao Chalikwar declare that:

- a. The information furnished in my valuation report dated 20.11.2023 is true and correct to the best of my knowledge and belief and I have made an impartial and true valuation of the property.
- b. I have no direct or indirect interest in the property valued;
- c. I/ my authorized representative have personally inspected the property on 20.11.2023. The work is not sub - contracted to any other valuer and carried out by myself.
- d. I have not been convicted of any offence and sentenced to a term of imprisonment.
- e. I have not been found guilty of misconduct in my professional capacity.
- f. I have read the Handbook on Policy, Standards and procedure for Real Estate Valuation, 2011 of the IBA and this report is in conformity to the "Standards" enshrined for valuation in the Part - B of the above handbook to the best of my ability.
- g. I have read the International Valuation Standards (IVS) and the report submitted to the Bank for the respective asset class is in conformity to the "Standards" as enshrined for valuation in the IVS in "General Standards" and "Asset Standards" as applicable.
- h. I abide by the Model Code of Conduct for empanelment of valuer in the Bank. (Annexure IV - A signed copy of same to be taken and kept along with this declaration)
- i. I am Director of the company, who is competent to sign this valuation report.
- j. Further, I hereby provide the following information.

Sr. No.	Particulars	Valuer comment
1.	background information of the asset being valued;	The property under consideration will be purchased by Mr. Milind Vijay Nirgude & Ms. Kirti Jayant Kalaskar (After Marriage) Mrs. Kirti Milind Nirgude from Mrs. Vithabai Vedu Kashmire & 6 Others Vide Agreement for Sale Vide No. 13425/ 2023 dated 30.10.2023
2.	purpose of valuation and appointing authority	As per client request, to ascertain the present market value of the property for Bank of Baroda, R.O Nashik Road Branch.
3.	identity of the valuer and any other experts involved in the valuation;	Manoj B. Chalikwar – Regd. Valuer Sanjay Phadol- Regional Technical Manager Swapnil Wagh – Site Engineer Binu Surendran – Technical Manager Rushikesh Pingle – Technical Officer
4.	disclosure of valuer interest or conflict, if any;	We have no interest, either direct or indirect, in the property valued. Further to state that we do not have relation or any connection with property owner / applicant directly or indirectly. Further to state that we are an independent Valuer and in no way related to property owner / applicant
5.	date of appointment, valuation date and date of report;	Date of Appointment – 20.11.2023 Valuation Date - 20.11.2023 Date of Report - 20.11.2023
6.	inspections and/or investigations undertaken;	Physical Inspection done on 20.11.2023
7.	nature and sources of the information used or relied upon;	<ul style="list-style-type: none"> • Market Survey at the time of site visit • Ready Reckoner rates / Circle rates • Online search for Registered Transactions • Online Price Indicators on real estate portals • Enquiries with Real estate consultants • Existing data of Valuation assignments carried out by us
8.	procedures adopted in carrying out the valuation and valuation standards followed;	Sales Comparison Method
9.	restrictions on use of the report, if any;	This valuation is for the use of the party to whom it is addressed and for no other purpose. No responsibility is accepted to any third party who may use or rely on the whole or any part of this valuation. The valuer has no pecuniary interest that would conflict with the proper valuation of the property.
10.	major factors that were taken into account during the valuation;	current market conditions, demand and supply position, Residential Flat size, location, upswing in real estate prices, sustained demand for Residential Flat, all-round development of commercial and residential application in the locality etc.
11.	major factors that were not taken into account during the valuation;	Nil
12.	Caveats, limitations and disclaimers to the extent they explain or elucidate the limitations faced by valuer, which shall not be for the purpose of limiting his responsibility for the valuation report.	Attached



Assumptions, Disclaimers, Limitations & Qualifications

Value Subject to Change

The subject appraisal exercise is based on prevailing market dynamics as on **20th November 2023** and does not take into account any unforeseeable developments which could impact the same in the future.

Our Investigations

We are not engaged to carry out all possible investigations in relation to the subject property. Where in our report we identify certain limitations to our investigations, this is to enable the reliant party to instruct further investigations where considered appropriate or where we recommend as necessary prior to reliance. Vastukala Consultants India Pvt. Ltd. (VCIPL) is not liable for any loss occasioned by a decision not to conduct further investigations

Assumptions

Assumptions are a necessary part of undertaking valuations. VCIPL adopts assumptions for the purpose of providing valuation advise because some matters are not capable of accurate calculations or fall outside the scope of our expertise, or out instructions. The reliant party accepts that the valuation contains certain specific assumptions and acknowledge and accept the risk of that if any of the assumptions adopted in the valuation are incorrect, then this may have an effect on the valuation.

Information Supplied by Others

The appraisal is based on the information provided by the client. The same has been assumed to be correct and has been used for appraisal exercise. Where it is stated in the report that another party has supplied information to VCIPL, this information is believed to be reliable but VCIPL can accept no responsibility if this should prove not to be so.

Future Matters

To the extent that the valuation includes any statement as to a future matter, that statement is provided as an estimate and/or opinion based on the information known to VCIPL at the date of this document. VCIPL does not warrant that such statements are accurate or correct.

Map and Plans

Any sketch, plan or map in this report is included to assist the reader while visualising the property and assume no responsibility in connection with such matters.

Site Details

Based on inputs received from Client and site visit conducted, we understand that the subject property is Residential Flat, admeasuring **Total Carpet Area in Sq. Ft = 1049.00**. Owned by **Mr. Milind Vijay Nirgude & Ms. Kirti Jayant Kalaskar (After Marriage) Mrs. Kirti Milind Nirgude**. Further, VCIPL has assumed that the subject property is free from any encroachment and is available as on the date of the appraisal.

Property Title

Based on our discussion with the Client, we understand that the subject property is being owned by **Mr. Milind Vijay Nirgude & Ms. Kirti Jayant Kalaskar (After Marriage) Mrs. Kirti Milind Nirgude**. For the purpose of this appraisal exercise, we have assumed that the subject property has a clear title and is free from any encumbrances, disputes and claims. VCIPL has made no further enquiries with the relevant local authorities in this regard and does not certify the property as having a clear and marketable title. Further, no legal advice regarding the title and ownership of the subject property has been obtained for the purpose of this appraisal exercise. It has been assumed that the title deeds are clear and marketable.

Environmental Conditions

We have assumed that the subject property is not contaminated and is not adversely affected by any existing or proposed environmental law and any processes which are carried out on the property are regulated by environmental legislation and are properly licensed by the appropriate authorities.

Area

Based on the information provided by the Client, we understand that the Residential Flat, admeasuring **Total Carpet Area in Sq. Ft = 1049.00**

Condition & Repair

In the absence of any information to the contrary, we have assumed that there are no abnormal ground conditions, nor archaeological remains present which might adversely affect the current or future occupation, development or value of the property. The property is free from rat, infestation, structural or latent defect. No currently known deleterious or hazardous materials or suspect techniques will be used in the construction of or subsequent alteration or additions to the property and comments made in the property details do not purport to express an opinion about, or advise upon, the condition of uninspected parts and should not be taken as making an implied representation or statement about such parts

Valuation Methodology

For the purpose of this valuation exercise, the valuation methodology used is Direct Comparison Approach Method and proposed Current use / Existing use premise is considered for this assignment.

The Direct Comparison Approach involves a comparison of the property being valued to similar properties that have actually been sold in arms - length transactions or are offered for sale. This approach demonstrates what buyers have historically been willing to pay (and sellers willing to accept) for similar properties in an open and competitive market and is particularly useful in estimating the value of the Flat and properties that are typically traded on a unit basis.

In case of inadequate recent transaction activity in the subject micro-market, the appraiser would collate details of older transactions. Subsequently, the appraiser would analyse rental / capital value trends in the subject micro-market in order to calculate the percentage increase / decrease in values since the date of the identified transactions. This percentage would then be adopted to project the current value of the same.

Where reliance has been placed upon external sources of information in applying the valuation methodologies, unless otherwise specifically instructed by Client and/or stated in the valuation, VCIPL has not independently verified that information and VCIPL does not advise nor accept it as reliable. The person or entity

to whom the report is addressed acknowledges and accepts the risk that if any of the unverified information in the valuation is incorrect, then this may have an effect on the valuation.

Not a Structural Survey

We state that this is a valuation report and not a structural survey

Other

All measurements, areas and ages quoted in our report are approximate

Legal

We have not made any allowances with respect to any existing or proposed local legislation relating to taxation on realization of the sale value of the subject property. VCIPL is not required to give testimony or to appear in court by reason of this appraisal report, with reference to the property in question, unless arrangement has been made thereof. Further, no legal advice on any aspects has been obtained for the purpose of this appraisal exercise

Property specific assumptions

Based on inputs received from the client and site visit conducted, we understand that the subject property is Residential Flat, admeasuring **Total Carpet Area in Sq. Ft = 1049.00**

ASSUMPTIONS, CAVEATS, LIMITATION AND DISCLAIMERS

1. We assume no responsibility for matters of legal nature affecting the property appraised or the title thereto, nor do we render our opinion as to the title, which is assumed to be good and marketable.
2. The property is valued as though under responsible ownership.
3. It is assumed that the property is free of liens and encumbrances.
4. It is assumed that there are no hidden or unapparent conditions of the subsoil or structure that would render it more or less valuable. No responsibility is assumed for such conditions or for engineering that might be required to discover such factors.
5. There is no direct/ indirect interest in the property valued.
6. The rates for valuation of the property are in accordance with the Govt. approved rates and prevailing market rates.



(Annexure – II)

MODEL CODE OF CONDUCT FOR VALUERS

Integrity and Fairness

1. A valuer shall, in the conduct of his/its business, follow high standards of integrity and fairness in all his/its dealings with his/its clients and other valuers.
2. A valuer shall maintain integrity by being honest, straightforward, and forthright in all professional relationships.
3. A valuer shall endeavour to ensure that he/it provides true and adequate information and shall not misrepresent any facts or situations.
4. A valuer shall refrain from being involved in any action that would bring disrepute to the profession.
5. A valuer shall keep public interest foremost while delivering his services.

Professional Competence and Due Care

6. A valuer shall render at all times high standards of service, exercise due diligence, ensure proper care and exercise independent professional judgment.
7. A valuer shall carry out professional services in accordance with the relevant technical and professional standards that may be specified from time to time.
8. A valuer shall continuously maintain professional knowledge and skill to provide competent professional service based on up-to-date developments in practice, prevailing regulations / guidelines and techniques.
9. In the preparation of a valuation report, the valuer shall not disclaim liability for his/its expertise or deny his/its duty of care, except to the extent that the assumptions are based on statements of fact provided by the company or its auditors or consultants or information available in public domain and not generated by the valuer.
10. A valuer shall not carry out any instruction of the client insofar as they are incompatible with the requirements of integrity, objectivity and independence.
11. A valuer shall clearly state to his client the services that he would be competent to provide and the services for which he would be relying on other valuers or professionals or for which the client can have a separate arrangement with other valuers.

Independence and Disclosure of Interest

12. A valuer shall act with objectivity in his/its professional dealings by ensuring that his/its decisions are made without the presence of any bias, conflict of interest, coercion, or undue influence of any party, whether directly connected to the valuation assignment or not.
13. A valuer shall not take up an assignment if he/it or any of his/its relatives or associates is not independent in terms of association to the company.
14. A valuer shall maintain complete independence in his/its professional relationships and shall conduct the valuation independent of external influences.

15. A valuer shall wherever necessary disclose to the clients, possible sources of conflicts of duties and interests, while providing unbiased services.
16. A valuer shall not deal in securities of any subject company after any time when he/it first becomes aware of the possibility of his / its association with the valuation, and in accordance with the Securities and Exchange Board of India (Prohibition of Insider Trading) Regulations, 2015 or till the time the valuation report becomes public, whichever is earlier.
17. A valuer shall not indulge in "mandate snatching" or offering "convenience valuations" in order to cater to a company or client's needs.
18. As an independent valuer, the valuer shall not charge success fee.
19. In any fairness opinion or independent expert opinion submitted by a valuer, if there has been a prior engagement in an unconnected transaction, the valuer shall declare the association with the company during the last five years.

Confidentiality

20. A valuer shall not use or divulge to other clients or any other party any confidential information about the subject company, which has come to his / its knowledge without proper and specific authority or unless there is a legal or professional right or duty to disclose.

Information Management

21. A valuer shall ensure that he/ it maintains written contemporaneous records for any decision taken, the reasons for taking the decision, and the information and evidence in support of such decision. This shall be maintained so as to sufficiently enable a reasonable person to take a view on the appropriateness of his /its decisions and actions.
22. A valuer shall appear, co-operate and be available for inspections and investigations carried out by the authority, any person authorised by the authority, the registered valuers organisation with which he/it is registered or any other statutory regulatory body.
23. A valuer shall provide all information and records as may be required by the authority, the Tribunal, Appellate Tribunal, the registered valuers organisation with which he/it is registered, or any other statutory regulatory body.
24. A valuer while respecting the confidentiality of information acquired during the course of performing professional services, shall maintain proper working papers for a period of three years or such longer period as required in its contract for a specific valuation, for production before a regulatory authority or for a peer review. In the event of a pending case before the Tribunal or Appellate Tribunal, the record shall be maintained till the disposal of the case.

Gifts and hospitality:

25. A valuer or his / its relative shall not accept gifts or hospitality which undermines or affects his independence as a valuer.

Explanation: For the purposes of this code the term 'relative' shall have the same meaning as defined in clause (77) of Section 2 of the Companies Act, 2013 (18 of 2013).

26. A valuer shall not offer gifts or hospitality or a financial or any other advantage to a public servant or any other person with a view to obtain or retain work for himself / itself, or to obtain or retain an advantage in the conduct of profession for himself / itself.

Remuneration and Costs.

27. A valuer shall provide services for remuneration which is charged in a transparent manner, is a reasonable reflection of the work necessarily and properly undertaken, and is not inconsistent with the applicable rules.
28. A valuer shall not accept any fees or charges other than those which are disclosed in a written contract with the person to whom he would be rendering service.

Occupation, employability and restrictions.

29. A valuer shall refrain from accepting too many assignments, if he/it is unlikely to be able to devote adequate time to each of his/ its assignments.
30. A valuer shall not conduct business which in the opinion of the authority or the registered valuer organisation discredits the profession.

Place: Nashik
Date: 20.11.2023

For VASTUKALA CONSULTANTS (I) PVT. LTD.

MANOJ BABURAO
CHALIKWAR

Director

Manoj B. Chalikwar

Registered Valuer

Chartered Engineer (India)

Reg. No. CAT-I-F-1763

Reg. No. IBBI/RV/07/2018/10366

BOB Empanelment No.: ZO:MZ:ADV:46:941

Digitally signed by MANOJ BABURAO CHALIKWAR
DN: cn=(M, o=VASTUKALA CONSULTANTS (I) PRIVATE LIMITED,
ou=admin,
2.5.4.20=9822b6c4fad35dc03e0cf39e26865913490c833d4133
3115279b17a18b5602, postalCode=400009, st=Maharashtra,
serialNumber=41a5a566abfc09d662a55af6c3e38311315d2
e394e28f2e29a327b625bfc, cn=MANOJ BABURAO CHALIKWAR
Date: 2023.11.20 17:01:23 +05'30'

Auth. Sign.

Think.Innovate.Create