

PROPOSED SITE

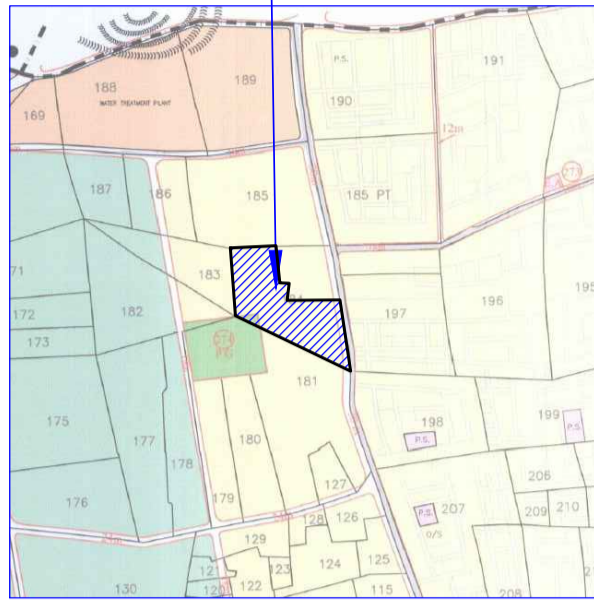

LAND AREA STATEMENT (AS PER 7/12)

G.NO. / H.NO.	TOTAL AREA AS PER 7/12	OWNERSHIP
184/1	10500.00	NERKAR PROPERTIES LLP PARTNER SHIP FIRM THROUGH PARTNER SHRI. VIPUL SHIRISH NERKAR SHRI. ABHAY SHIRISH NERKAR
184/A/1	15350.00	SHRI. SHASHIKANT MANILAL PATEL G.P.A. H. SHRI. ABHAY SHIRISH NERKAR
184/A/2	7640.00	NERKAR PROPERTIES LLP PARTNER SHIP FIRM THROUGH PARTNER SHRI. VIPUL SHIRISH NERKAR SHRI. ABHAY SHIRISH NERKAR
184/A/2	7640.00	SHRI. VISHNU HARI PATIL G.P.A. H. SHRI. ABHAY SHIRISH NERKAR
184/A/3	7640.00	NERKAR PROPERTIES LLP PARTNER SHIP FIRM THROUGH PARTNER SHRI. VIPUL SHIRISH NERKAR SHRI. ABHAY SHIRISH NERKAR
TOTAL	41130.00	

LOCATION PLAN (SCALE 1:10,000)

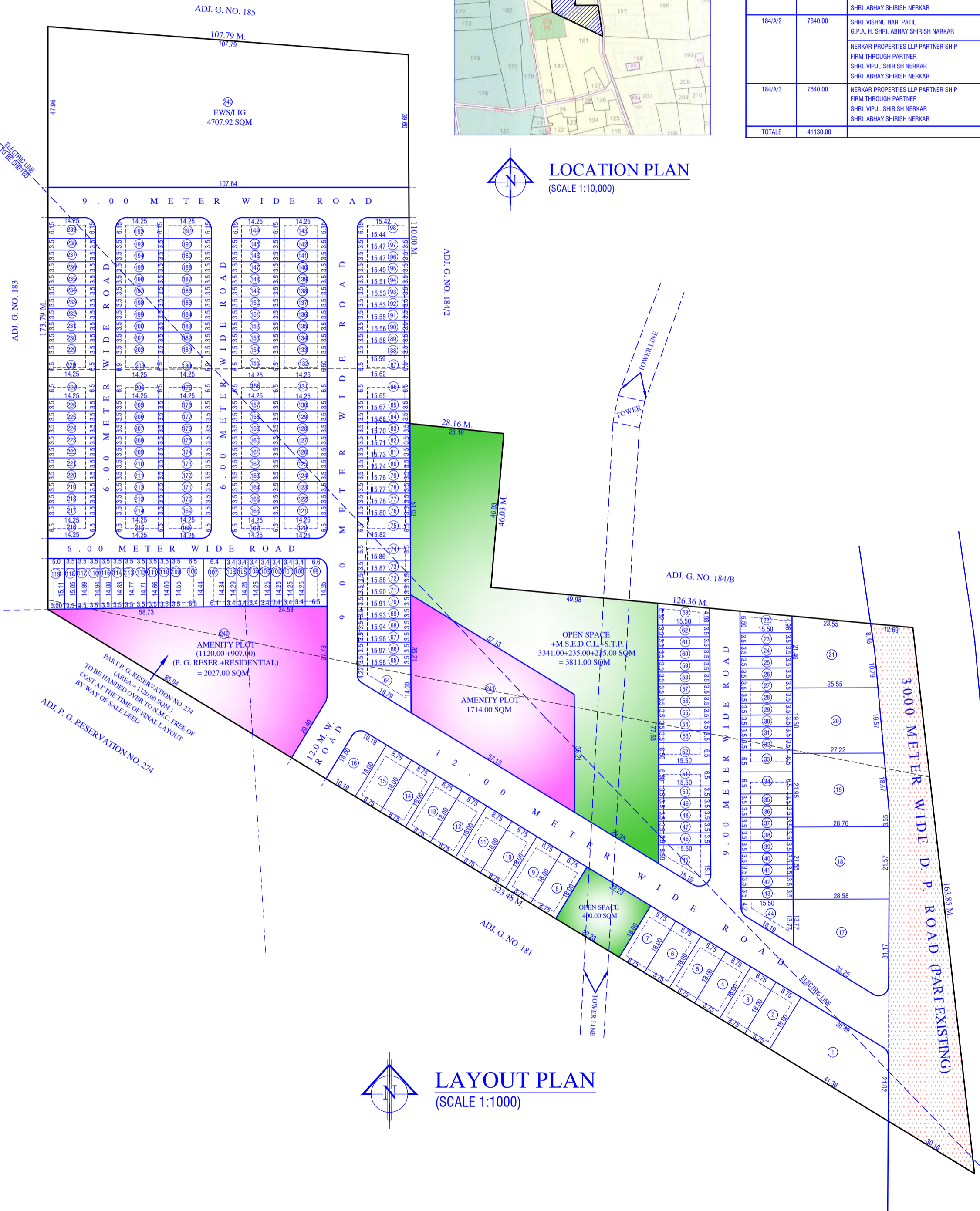

LAYOUT PLAN (SCALE 1:1000)



APPROVAL

- NOTES :-
- ALL DIMENSION ARE IN METER
 - LAND BOUNDARY SHOWN IN BLACK
 - OPEN SPACE SHOWN IN GREEN
 - AMENITY SPACE SHOWN IN PINK

AREA STATEMENT AREA IN SQM.

1) AREA OF LAND (7/12 extract)	41130.00
a) As per Ownership document	41130.00
b) As per measurement sheet	41130.00
c) As per site	41130.00
2) Deductions for	
a) Proposed D.P. road/D.P. road widening area	2600.00
b) Any D. P. Reservation (P. G. NO. 274)	1120.00
c) Natural Water Course	-
Total (a+b+c)	3720.00
3) Gross Area of Plot (1-2)	37410.00
4) Recreational Open Space	
a) Required	3741.00
b) Proposed	3741.00
5) M.S.E.D.C.L. space	
a) Required	235.00
b) Proposed	235.00
6) S.T.P. space	
a) Required	235.00
b) Proposed	235.00
7) Amenity Space-	
a) Required- (10%)	3741.00
b) Proposed (1120.00+2621.00)	3741.00
8) Service Road and Highway widening	-
9) Internal road area	5925.23
10) Net area under Layout plots	23532.77
11) Net area of plots for FSI Calculation=(3-7b)	33669.00
12) Pro-rata FSI factor for layout plots(11/10)	1.430728

PROPOSED RESIDENTIAL TENTATIVE LAYOUT PLAN IN G. No.184/1+184/A/1 +184/A/2+184/A/3 (C.T.S. NO. 1774) OF PIMPALGAON BAHULA SHIWAR IN NASHIK FOR

- 1) NERKAR PROPERTIES LLP PARTNER SHIP FIRM THROUGH PARTNER SHRI. VIPUL SHIRISH NERKAR & SHRI. ABHAY SHIRISH NERKAR
- 2) SHRI. SHASHIKANT MANILAL PATEL THROUGH G. P. A. HOLDER SHRI. ABHAY SHIRISH NERKAR
- 3) SHRI. VISHNU HARI PATIL THROUGH G. P. A. HOLDER SHRI. ABHAY SHIRISH NERKAR

NERKAR PROPERTIES LLP PARTNER SHIP FIRM THROUGH PARTNER SHRI. VIPUL SHIRISH NERKAR SHRI. ABHAY SHIRISH NERKAR

SHASHIKANT MANILAL PATEL THROUGH G. P. A. HOLDER ABHAY SHIRISH NERKAR VISHNU HARI PATIL THROUGH G. P. A. HOLDER ABHAY SHIRISH NERKAR

OWNER SIGN.

AR. G. V. KATALE ARCHITECT SIGN

G. V. KATALE AND ASSOCIATES
 CONSULTING ENGINEERS & ARCHITECTS
 OFFICE - 01, KAMAL RESIDENCY,
 PATIL LANE NO. 4, COLLEGE ROAD, NASHIK-5.
 PH. (0) 2580928, 2579927
 Email : gvkatale@gmail.com.