

LOCATION PLAN
SCALE=1:800

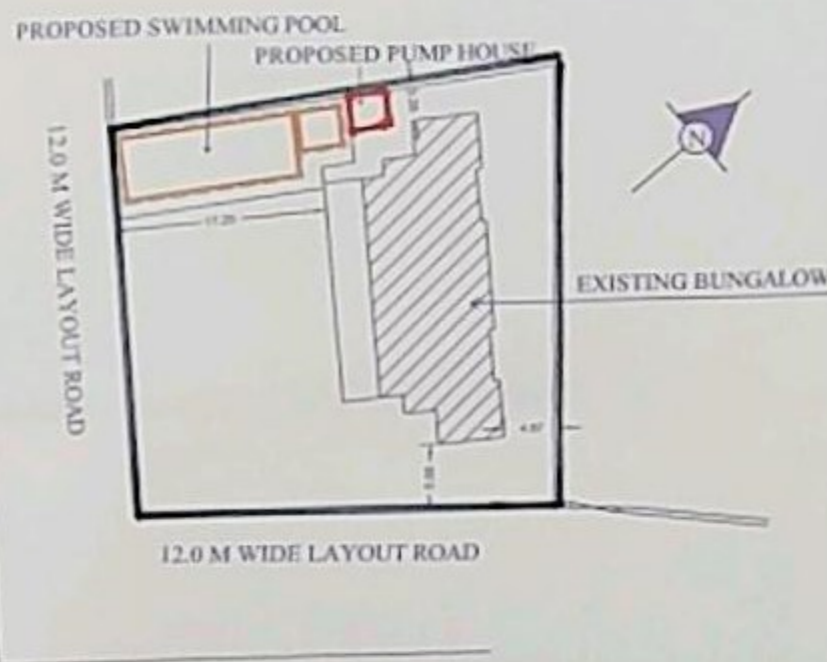

SITE PLAN
SCALE=1:500

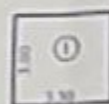

AREA CALCULATION FOR PUMP ROOM		
AREA OF BLOCK 'T'	3.30 X 3.00	9.90 SQ.M.
AREA OF PUMP ROOM		9.90 SQ.M.

BLOCK PLAN
SCALE=1:200

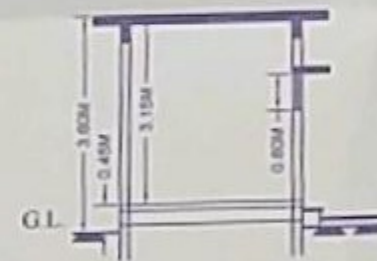

SECTION AT X-X
SCALE=1:100



Plan approved subject to the amended
there in permission granted subject
to the conditions said down in the
of permission vide No.ENG/BP/36/2008-09
Dated: / /20

Assistant Town Planner
Lonavla Municipal Council

CHIEF OFFICER
LONAVLA MUNICIPAL COUNCIL

SCALE

- 1) SWIMMING POOL PLAN 1:100 2) BLOCK PLAN 1:200
3) SITE PLAN 1:500 4) LOCATION PLAN 1:800

AREA STATEMENT

1. AREA OF PLOT AS PER 7/12 ABSTRACT	1233.75 SQ.M.
2. PERMISSIBLE GROUND COVERAGE 25% OF 'T' ABOVE	308.44 SQ.M.
3. EXISTING GROUND COVERAGE	286.34 SQ.M.
4. PERMISSIBLE F.S.I. 50% OF 'T' ABOVE	616.88 SQ.M.
5. EXISTING F.S.I.	528.71 SQ.M.
7. PERMISSIBLE AREA OF PUMP HOUSE (FREE OF F.S.I.)	10.00 SQ.M.
8. PROPOSED AREA OF PUMP HOUSE	9.90 SQ.M.

PLAN FOR
PROPOSED SWIMMING POOL & PUMP HOUSE ON PLOT
NO.76, IN THE LAYOUT OF S. NO. 18/1 TO 18/5, 23/1 TO
23/5, 24/1 TO 24/5, WARD TUNGARLI, AT LONAVLA,
TALUKA:- MAVAL, DIST.:- PUNE.

NOTES

- 1) PLOT BOUNDARY SHOWN THUS
2) PROPOSED PUMP HOUSE SHOWN THUS
3) PROPOSED SWIMMING POOL SHOWN THUS

PREVIOUS PLAN IS APPROVED BY LONAVLA MUNICIPAL COUNCIL VIDE
LETTER OF COMMENCEMENT NO. ENG/BP/36/2008-2009, DATED 8/10/2008
& OCCUPANCY CERTIFICATE ON DATED- 05/12/2009

OWNER
FOR :-

for

for

VASTU
DESIGNERS

PLANNERS
&
STRUCTURAL
DESIGNERS
LONAVLA
410401
CELL NO.
9960833152

JOB NO	DRG. NO.	DATE	DRAWN BY	CHKD. BY
	01	01/10/2020	RISHIKESH	RISHIKESH