

LOCATION PLAN

SCALE: 1:10,000

HISSA WISE LAND AREA STATEMENT

S-NO/ H.NO.	AREA AS PER 7/12	RET'N. LAND AREA	EXCESSLAND AREA	D.P. ROAD AREA
895/2/1	5532.60	2000.00	3532.60	-
895/2/2	5532.60	2000.00	3532.60	-
895/2/3	5532.60	2000.00	3532.60	-
895/2/4	5532.60	2000.00	3532.60	-
895/2/5	5532.60	2000.00	3532.60	-
895/2/6	2937.00	-	-	2937.00
TOTAL	30,600.00	10,000.00	17,663.00	2,937.00

PLOT WISE AREA STATEMENT

PLOT NOS	AREA IN SQM	ADD.F.S.I. LIEU OF D.P. ROAD WINDING
1	631.63	250.00
2, 3, 4	620.00	240.00
5	685.88	270.00
6	632.88	250.00
7	1550.00	387.00
8 TO 14	558.00	130.00
15	597.86	150.00
TOTAL	9863.45 M²	2937.00 SQM

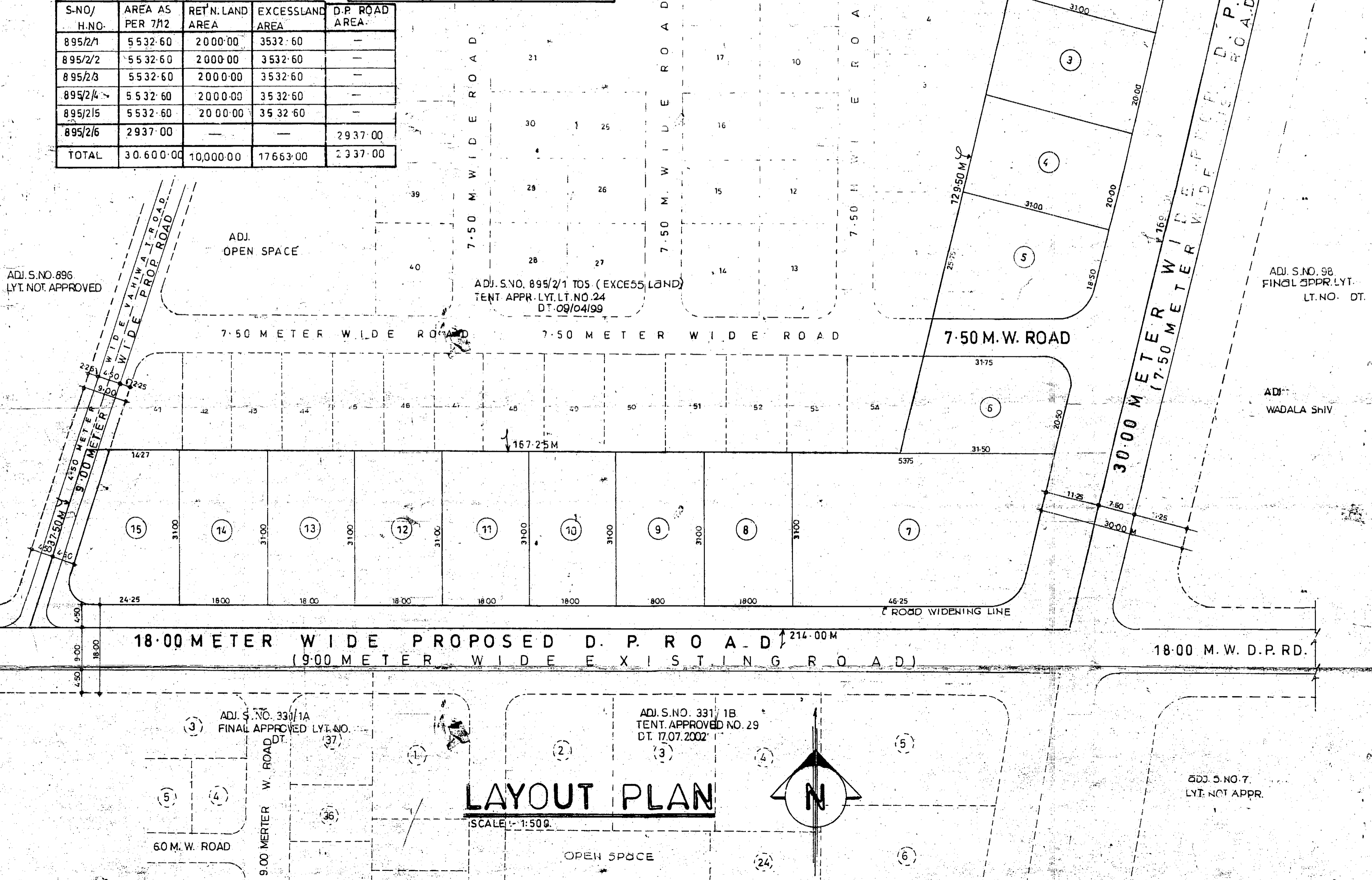

LAYOUT PLAN

SCALE: 1:500

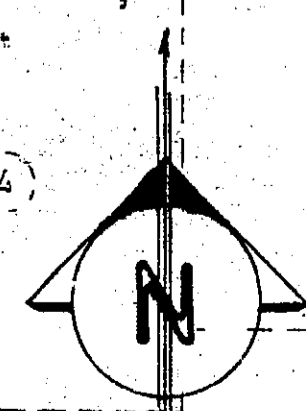

APPROVAL

APPROVED
(DEMARKATED FINAL) LAYOUT AS PER
CONDITIONS MENTIONED IN THE LETTER
NO. LND/WS/118/DT-24/02/2003
VIEW OF SECTION 152(1)(3) OF THE
MAHARASHTRA REGIONAL AND TOWN
PLANNING ACT, 1966.

TRUE COPY

K.G.V.
(KATALE G.V.)
ARCHITECT

SD/LX X X
ASSISTANT DIRECTOR OF TOWN PLANNING
NASHIK MUNICIPAL CORPORATION
NASHIK.

DEMARCATION CERTIFICATE

THIS IS TO CERTIFY THAT I HAVE PERSONALLY DEMARCATED THIS LAYOUT WHICH WAS TENTATIVELY APPROVED BY NASHIK MUNICIPAL CORPORATION NASHIK WIDE LETTER NO. TLA/DT/08/05/2002 AND FURTHER CERTIFY THAT THE APPLICANT HAS PROVIDED THE DEMARCATION PLANS ACTUALLY ON SITE.

AREA STATEMENT

AREA OF THE LAND (AS PER 7/12)	30600.00
AREA UNDER EXCESS LAND	17663.00
AREA UNDER D.P. ROAD	2937.00
AREA UNDER RETENTION LAND	10000.00
AREA UNDER ROADS	138.55
AREA UNDER PLOTS	9863.45

NOTES

- ALL DIMENSIONS ARE IN METER
- LAND BOUNDARY SHOWN IN "BLACK"
- OPEN SPACE & M.S.E.B. OF THIS RETENTION LAND IS PROVIDED IN ADJ. EXCESS LAND LAYOUT.

DEMARCATED FINAL LAYOUT PLAN IN S.NO.895/2/1 TOS (PART) AT-NASHIK, TAL. & DIST-NASHIK. FOR: SHRI. PRAKASH C. KANKARIYA AND OTHERS. G.P.A HOLDER: SHRI. VITHAL B. KHANKARI

K.G.V.
SHRI. G.V. KATALE
ARCHITECT SIGN

V.B.K.
G.P.A. HOLDER: SHRI. V.B. KHANKARI
OWNER SIGN

G. V. KATALE & ASSOCIATES
CONSULTING ENGINEERS & ARCHITECTS
OFF. : 103, 108, 'SHRIRAM SANKUL',
OPP. HOTEL PANCHAVATI, VAKIL-WADI,
NASHIK-1. PH. : (OFF.) 580020, 670027

JOB NO. : DATE - 16 MAR 2002 CKB BY - KATALE G.V.
DRG NO. : SCALE - AS SHOWN DRN BY - BODHAL