

1.42	146.77	9	1.1	161.45
1.42	175.26	9	1.1	192.78
1.42	479.78	12	1.1	527.75
1.42	452.94	12	1.1	498.23
1.42	418.59	12	1.1	460.45
1.42	1039.27	12	1.1	1143.20
1.42	637.62	12	1.1	701.38
1.42	523.01	12	1.1	575.32
1.42	387.11	12	1.1	425.82
1.42	418.49	12	1.1	460.34
1.42	922.77	18	1.1	1015.05
1.42	1282.26	18	1.1	1410.49
1.42	349.04	9	1.1	383.94
1.42	255.60	9	1.1	281.16
1.42	337.68	12	1.1	371.44
1.42	377.89	12	1.1	415.68
1.42	610.60	9	1.1	671.66
1.42	325.76	9	1.1	358.34
1.42	1282.32	18	1.1	1410.55
1.42	1023.31	18	1.1	1125.64
1.42	1221.20	9	1.1	1343.32
1.42	409.64	12	1.1	450.61
1.42	715.91	12	1.1	787.50
1.42	380.65	9	1.1	418.71
1.42	379.75	9	1.1	417.73
1.42	1244.23	18	1.1	1368.66
	82115.92	1674.00	170.50	90327.51

SCALE:
1 : 1000

DATE :
16/08/2022

FRAN CONSULTANTS

LAND SURVEYOR - K. V. FRANCIS
 GOD'S GIFT VILLA, S.NO:13/3A, PLOT.No: 12,
 NEAR KAMAL NAGAR, KAMATWADE,
 NASHIK - 422 008, Ph - 0253 - 2391584
 Mob. No. : +91 9422249274, +91 9921771584
 Email - franconsultants96@gmail.com

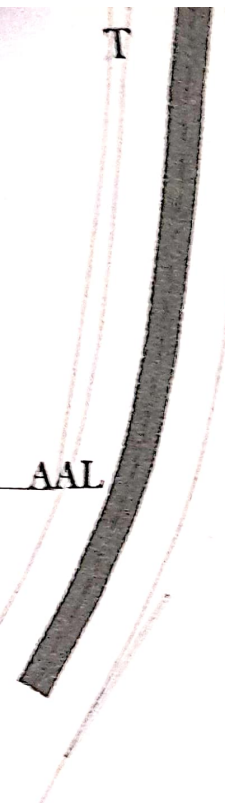

227	1	318.97	318.97	8	337.87	337.87	
228	1	294.78	294.78	0	318.97	318.97	
229, 230	2	365.94	731.88	0	294.78	294.78	
231	1	457.03	457.03	8	731.88	731.88	
232	1	376.32	376.32	8	449.03	449.03	
233	1	272.61	272.61	0	368.32	368.32	
234	1	294.71	294.71	0	272.61	272.61	
235	1	661.84	661.84	0	294.71	294.71	
236	1	912.00	912.00	12	649.84	649.84	
237	1	245.80	245.80	9	903.00	903.00	
238	1	180.00	180.00	0	245.80	245.80	
239	1	245.80	245.80	0	180.00	180.00	
240	1	274.12	274.12	8	237.80	237.80	
241, 242	2	215.00	430.00	8	266.12	266.12	
243	1	229.41	229.41	0	430.00	430.00	
244	1	912.04	912.04	0	229.41	229.41	
245	1	729.64	729.64	9	903.04	903.04	
246 to 249	4	215.00	860.00	9	720.64	720.64	
250	1	296.48	296.48	0	860.00	860.00	
251	1	512.16	512.16	8	288.48	288.48	
252	1	268.06	268.06	8	504.16	504.16	
253	1	267.43	267.43	0	268.06	268.06	
254	1	885.22	885.22	0	267.43	267.43	
				9	876.22	876.22	
T		47297.82	58177.11	349		57828.11	

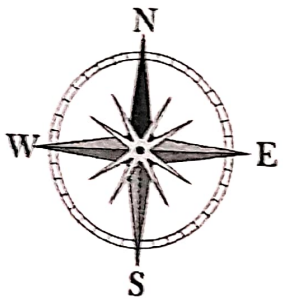

PROPOSED DEMARCATED FINAL LAY-OUT PLAN OF
 S.No : 4, 5, 7 to 10 , 281 & 282 , AT MHASRUL ,
 Taluk - NASHIK , District - NASHIK.
 FOR - M/S : REAL LAND DEVELOPERS AND BUILDERS

PLOT AREA STATEMENT

PLOT NO.		PLOT AREA (SQ. M)		ROUNDING AREA OF ROAD (IF ANY SQ. M)	REMAINING PLOT AREA (B-C)		PRO-RATA FSI FACTOR	BUILT-UP AREA ON PRO-RATA BASIS (d x e) SQ. M	FRONT ROAD WIDTH (M)	BASIC FSI	PERMISSIBLE BUILT-UP AREA ON BASIC FSI (f x h) SQ. M
Nos.	Total Nos.	Each Plot	Total Plot Area	Each Plot	Each Plot	Total Plot Area					
(A)		(B)		(C)	(D)		(E)	(F)	(G)	(H)	(I)
					3302.00	3302.00	1.42	4688.84	30	1.1	5157.72
1	1	3302.00	3302.00	0	1251.00	1251.00	1.42	1776.42	30	1.1	1954.06
2	1	1251.00	1251.00	0	998.73	998.73	1.42	1418.20	30	1.1	1560.02
3	1	1017.73	1017.73	19	253.66	253.66	1.42	360.20	12	1.1	396.22
4	1	259.66	259.66	6	252.00	252.00	1.42	357.84	9	1.1	393.62
5	1	252.00	252.00	0	236.25	236.25	1.42	335.48	9	1.1	369.02
6	1	236.25	236.25	0	244.02	244.02	1.42	346.51	9	1.1	381.16
7	1	244.02	244.02	0	106.60	106.60	1.42	151.37	9	1.1	166.51
8	1	106.60	106.60	0	385.98	385.98	1.42	548.09	9	1.1	602.90
9 to 14	6	64.33	385.98	0	91.90	91.90	1.42	130.50	9	1.1	143.55
15	1	91.90	91.90	0	238.45	238.45	1.42	338.60	12	1.1	372.46
16	1	244.45	244.45	6	244.00	244.00	1.42	346.48	12	1.1	381.13
17	1	250.00	250.00	6	300.00	300.00	1.42	426.00	9	1.1	468.60
18	1	300.00	300.00	0	321.40	321.40	1.42	456.39	9	1.1	502.03
19	1	321.40	321.40	0	397.43	397.43	1.42	564.35	9	1.1	620.79
20	1	397.43	397.43	0	687.38	687.38	1.42	976.08	12	1.1	1073.69
21	1	693.38	693.38	6	1101.44	1101.44	1.42	1564.04	12	1.1	1720.45
22	1	1101.44	1101.44	0	1206.21	1206.21	1.42	1712.82	12	1.1	1884.10
23	1	1206.21	1206.21	0	1207.54	1207.54	1.42	1714.71	12	1.1	1886.18
24	1	1207.54	1207.54	0	1005.50	1005.50	1.42	1427.81	12	1.1	1570.59
25	1	1005.50	1005.50	0	586.71	586.71	1.42	833.13	12	1.1	916.44
26	1	586.71	586.71	0	649.25	649.25	1.42	921.94	12	1.1	1014.13
27	1	657.25	657.25	8	396.36	396.36	1.42	562.83	12	1.1	619.11
28	1	404.36	404.36	8	297.00	297.00	1.42	421.74	12	1.1	463.91
29	1	297.00	297.00	0	831.60	831.60	1.42	1180.87	12	1.1	1298.96
30, 31	2	415.80	831.60	0	704.00	704.00	1.42	999.68	12	1.1	1099.65
32, 33	2	352.00	704.00	0	334.40	334.40	1.42	474.85	12	1.1	522.33
34	1	334.40	334.40	0	341.00	341.00	1.42	484.22	12	1.1	532.64
35	1	341.00	341.00	0	400.78	400.78	1.42	569.11	12	1.1	626.02
36	1	406.78	406.78	6	346.05	346.05	1.42	491.39	12	1.1	540.53
37	1	352.05	352.05	6	89.82	89.82	1.42	127.54	9	1.1	140.30
38	1	89.82	89.82	0	62.72	62.72	1.42	89.06	9	1.1	97.97
39	1	62.72	62.72	0	62.60	62.60	1.42	88.89	9	1.1	97.78
40	1	62.60	62.60	0	62.47	62.47	1.42	88.71	9	1.1	97.58
41	1	62.47	62.47	0	62.35	62.35	1.42	88.54	9	1.1	97.39
42	1	62.35	62.35	0	62.23	62.23	1.42	88.37	9	1.1	97.20
43	1	62.23	62.23	0	62.10	62.10	1.42	88.18	9	1.1	97.00
44	1	62.10	62.10	0	61.98	61.98	1.42	88.01	9	1.1	96.81
45	1	61.98	61.98	0	61.86	61.86	1.42	87.84	9	1.1	96.63
46	1	61.86	61.86	0							96.44

39	1	62.72	62.72	0	62.60	62.60	1.42	88.89	9	1.1	97.97
40	1	62.60	62.60	0	62.47	62.47	1.42	88.71	9	1.1	97.78
41	1	62.47	62.47	0	62.35	62.35	1.42	88.54	9	1.1	97.58
42	1	62.35	62.35	0	62.23	62.23	1.42	88.37	9	1.1	97.39
43	1	62.23	62.23	0	62.10	62.10	1.42	88.18	9	1.1	97.20
44	1	62.10	62.10	0	61.98	61.98	1.42	88.01	9	1.1	97.00
45	1	61.98	61.98	0	61.86	61.86	1.42	87.84	9	1.1	96.81
46	1	61.86	61.86	0	61.74	61.74	1.42	87.67	9	1.1	96.63
47	1	61.74	61.74	0	61.61	61.61	1.42	87.49	9	1.1	96.44
48	1	61.61	61.61	0	100.08	100.08	1.42	142.11	9	1.1	96.23
49	1	100.08	100.08	0	217.22	217.22	1.42	308.45	9	1.1	156.32
50	1	221.22	221.22	4	372.60	372.60	1.42	529.09	9	1.1	339.30
51, 52	2	186.30	372.60	0	185.40	185.40	1.42	263.27	9	1.1	582.00
53, 64	2	92.70	185.40	0	675.00	675.00	1.42	958.50	9	1.1	289.59
54 to 63	10	67.50	675.00	0	669.60	669.60	1.42	950.83	9	1.1	1054.35
65 to 67	3	223.20	669.60	0	378.00	378.00	1.42	536.76	9	1.1	1045.92
68, 69	2	189.00	378.00	0	194.32	194.32	1.42	275.93	9	1.1	590.44
70	1	202.32	202.32	8	232.55	232.55	1.42	330.22	12	1.1	303.53
71	1	240.55	240.55	8	204.00	204.00	1.42	289.68	12	1.1	363.24
72	1	204.00	204.00	0	213.52	213.52	1.42	303.20	9	1.1	318.65
73	1	213.52	213.52	0	943.50	943.50	1.42	1339.77	9	1.1	333.52
74 to 78	5	188.70	943.50	0	197.69	197.69	1.42	280.72	9	1.1	1473.75
79	1	197.69	197.69	0	229.64	229.64	1.42	326.09	9	1.1	308.79
80	1	229.64	229.64	0	232.58	232.58	1.42	330.26	9	1.1	358.70
81	1	232.58	232.58	0	293.61	293.61	1.42	416.93	9	1.1	363.29
82	1	293.61	293.61	0	190.73	190.73	1.42	270.84	9	1.1	458.62
83	1	190.73	190.73	0	510.00	510.00	1.42	724.20	9	1.1	297.92
84 to 86	3	170.00	510.00	0	188.70	188.70	1.42	267.95	9	1.1	796.62
87	1	188.70	188.70	0	178.84	178.84	1.42	253.95	9	1.1	294.75
88	1	178.84	178.84	0	301.58	301.58	1.42	428.24	9	1.1	279.35
89	1	301.58	301.58	0	170.00	170.00	1.42	241.40	9	1.1	471.07
90	1	170.00	170.00	0	201.45	201.45	1.42	274.70	9	1.1	265.54
91	1	201.45	201.45	8	181.28	181.28	1.42	257.42	12	1.1	302.17
92	1	181.28	181.28	0	220.38	220.38	1.42	301.58	9	1.1	283.16
93	1	220.38	220.38	8	212.38	212.38	1.42	301.58	12	1.1	331.74
94	1	288.10	288.10	8	280.10	280.10	1.42	397.74	12	1.1	437.52
95	1	262.12	262.12	0	262.12	262.12	1.42	372.21	12	1.1	409.43
96, 99	2	229.50	459.00	0	459.00	459.00	1.42	651.78	9	1.1	716.96
97	1	262.14	262.14	8	254.14	254.14	1.42	360.88	9	1.1	396.97
98	1	260.44	260.44	8	252.44	252.44	1.42	358.46	12	1.1	394.31
100, 103	2	270.00	540.00	0	540.00	540.00	1.42	766.80	12	1.1	843.48
101	1	303.20	303.20	8	295.20	295.20	1.42	419.18	9	1.1	461.10
102	1	300.80	300.80	8	292.80	292.80	1.42	415.78	12	1.1	457.35
104	1	252.00	252.00	0	252.00	252.00	1.42	357.84	12	1.1	457.35
105	1	258.39	258.39	8	250.39	250.39	1.42	355.55	12	1.1	393.62
106	1	445.14	445.14	0	445.14	445.14	1.42	632.10	12	1.1	391.11
107	1	340.96	340.96	0	488.72	488.72	1.42	693.98	12	1.1	695.31
108	1	496.72	496.72	8	224.00	224.00	1.42	318.08	12	1.1	632.10
109	1	228.00	228.00	4	224.00	224.00	1.42	318.08	12	1.1	484.16
110	1	224.60	224.60	0	224.60	224.60	1.42	318.93	9	1.1	693.98
111	1	208.80	208.80	0	208.80	208.80	1.42	286.67	9	1.1	349.89

91	1	201.45	201.45	0	212.38	212.38	1.42	277.42	9	1.1	283.16
92	1	181.28	181.28	8	212.38	280.10	1.42	301.58	12	1.1	331.74
93	1	220.38	220.38	8	280.10	280.10	1.42	397.74	12	1.1	437.52
94	1	288.10	288.10	8	262.12	262.12	1.42	372.21	9	1.1	409.43
95	1	262.12	262.12	0	459.00	459.00	1.42	651.78	9	1.1	716.96
96, 99	2	229.50	459.00	8	254.14	254.14	1.42	360.88	12	1.1	396.97
97	1	262.14	262.14	8	252.44	252.44	1.42	358.46	12	1.1	394.31
98	1	260.44	260.44	0	540.00	540.00	1.42	766.80	9	1.1	843.48
100, 103	2	270.00	540.00	8	295.20	295.20	1.42	419.18	12	1.1	461.10
101	1	303.20	303.20	8	292.80	292.80	1.42	415.78	12	1.1	457.35
102	1	300.80	300.80	0	252.00	252.00	1.42	357.84	12	1.1	393.62
104	1	252.00	252.00	8	250.39	250.39	1.42	355.55	12	1.1	391.11
105	1	258.39	258.39	8	445.14	445.14	1.42	632.10	12	1.1	695.31
106	1	445.14	445.14	0	340.96	340.96	1.42	484.16	12	1.1	532.58
107	1	340.96	340.96	0	488.72	488.72	1.42	693.98	12	1.1	763.38
108	1	496.72	496.72	8	224.00	224.00	1.42	318.08	9	1.1	349.89
109	1	228.00	228.00	4	224.60	224.60	1.42	318.93	9	1.1	350.83
110	1	224.60	224.60	0	208.89	208.89	1.42	296.62	9	1.1	326.29
111	1	208.89	208.89	0	203.00	203.00	1.42	288.26	9	1.1	317.09
112	1	207.00	207.00	4	815.88	815.88	1.42	1158.55	18	1.1	1274.40
113	1	824.88	824.88	9	1256.82	1256.82	1.42	1784.68	18	1.1	1963.15
114	1	1265.82	1265.82	9	244.58	244.58	1.42	347.30	9	1.1	382.03
115	1	248.58	248.58	4	432.00	432.00	1.42	613.44	9	1.1	674.78
116, 117	2	216.00	432.00	0	244.58	244.58	1.42	347.30	9	1.1	382.03
118	1	248.58	248.58	4	432.00	432.00	1.42	613.44	9	1.1	674.78
119, 120	2	216.00	432.00	0	409.83	409.83	1.42	581.96	12	1.1	640.15
121	1	417.83	417.83	8	358.22	358.22	1.42	508.67	12	1.1	559.54
122	1	358.22	358.22	0	387.33	387.33	1.42	550.01	12	1.1	605.01
123	1	395.33	395.33	8	108.05	108.05	1.42	153.43	9	1.1	168.77
124	1	108.05	108.05	0	73.01	73.01	1.42	103.67	9	1.1	114.04
125	1	73.01	73.01	0	71.70	71.70	1.42	101.81	9	1.1	112.00
126	1	71.70	71.70	0	69.91	69.91	1.42	99.27	9	1.1	109.20
127	1	69.91	69.91	0	68.13	68.13	1.42	96.74	9	1.1	106.42
128	1	68.13	68.13	0	66.34	66.34	1.42	94.20	9	1.1	103.62
129	1	66.34	66.34	0	64.56	64.56	1.42	91.68	9	1.1	100.84
130	1	64.56	64.56	0	63.08	63.08	1.42	89.57	9	1.1	98.53
131	1	63.08	63.08	0	189.00	189.00	1.42	268.38	9	1.1	295.22
132 to 134	3	63.00	189.00	0	180.00	180.00	1.42	255.60	9	1.1	281.16
135, 136	2	90.00	180.00	0	630.00	630.00	1.42	894.60	9	1.1	984.06
137 to 146	10	63.00	630.00	0	148.23	148.23	1.42	210.49	9	1.1	231.54
147	1	148.23	148.23	0	197.10	197.10	1.42	279.88	9	1.1	307.87
148	1	197.10	197.10	0	540.00	540.00	1.42	766.80	9	1.1	843.48
149 to 151	3	180.00	540.00	0	990.00	990.00	1.42	1405.80	9	1.1	1546.38
152 to 156	5	198.00	990.00	0	324.28	324.28	1.42	460.48	12	1.1	506.53
157	1	332.28	332.28	8	320.41	320.41	1.42	454.98	12	1.1	500.48
158	1	328.41	328.41	8	497.88	497.88	1.42	706.99	9	1.1	777.69
159, 160	2	248.94	497.88	0	181.80	181.80	1.42	258.16	9	1.1	283.97
161	1	181.80	181.80	0	299.70	299.70	1.42	425.57	9	1.1	468.13
162 to 164	3	99.90	299.70	0	79.92	79.92	1.42	113.49	9	1.1	124.84
165	1	79.92	79.92	0	169.92	169.92	1.42	241.29	9	1.1	265.42
166, 167	2	84.96	169.92	0	108.00	108.00	1.42	153.36	9	1.1	168.70
168	1	108.00	108.00	0	315.00	315.00	1.42	447.30	9	1.1	492.03
169 to 173	5	63.00	315.00	0	108.99	108.99	1.42	154.77	9	1.1	170.24
174	1	108.99	108.99	0	107.01	107.01	1.42	151.95	9	1.1	167.15
								894.60	9	1.1	984.06

137 to 146	10	630.00	630.00	0	630.00	630.00	1.42	894.60	9	1.1	984.06
147	1	148.23	148.23	0	148.23	148.23	1.42	210.49	9	1.1	231.54
148	1	197.10	197.10	0	197.10	197.10	1.42	279.88	9	1.1	307.87
149 to 151	3	180.00	540.00	0	540.00	540.00	1.42	766.80	9	1.1	843.48
152 to 156	5	198.00	990.00	0	990.00	990.00	1.42	1405.80	9	1.1	1546.38
157	1	332.28	332.28	8	324.28	324.28	1.42	460.48	12	1.1	506.53
158	1	328.41	328.41	8	320.41	320.41	1.42	454.98	12	1.1	500.48
159, 160	2	248.94	497.88	0	497.88	497.88	1.42	706.99	9	1.1	777.69
161	1	181.80	181.80	0	181.80	181.80	1.42	258.16	9	1.1	283.97
162 to 164	3	99.90	299.70	0	299.70	299.70	1.42	425.57	9	1.1	468.13
165	1	79.92	79.92	0	79.92	79.92	1.42	113.49	9	1.1	124.84
166, 167	2	84.96	169.92	0	169.92	169.92	1.42	241.29	9	1.1	265.42
168	1	108.00	108.00	0	108.00	108.00	1.42	153.36	9	1.1	168.70
169 to 173	5	63.00	315.00	0	315.00	315.00	1.42	447.30	9	1.1	492.03
174	1	108.99	108.99	0	108.99	108.99	1.42	154.77	9	1.1	170.24
175	1	107.01	107.01	0	107.01	107.01	1.42	151.95	9	1.1	167.15
176 to 185	10	63.00	630.00	0	630.00	630.00	1.42	894.60	9	1.1	984.06
186, 187	2	90.00	180.00	0	180.00	180.00	1.42	255.60	9	1.1	281.16
188 to 197	10	63.00	630.00	0	630.00	630.00	1.42	894.60	9	1.1	984.06
198	1	94.50	94.50	0	94.50	94.50	1.42	134.19	9	1.1	147.61
199	1	482.22	482.22	8	474.22	474.22	1.42	673.39	12	1.1	740.73
200	1	530.04	530.04	8	522.04	522.04	1.42	741.30	12	1.1	815.43
201	1	89.25	89.25	0	89.25	89.25	1.42	126.74	9	1.1	139.41
202 to 211	10	59.50	595.00	0	595.00	595.00	1.42	844.90	9	1.1	929.39
212	1	85.00	85.00	0	85.00	85.00	1.42	120.70	9	1.1	132.77
213	1	85.00	85.00	0	85.00	85.00	1.42	120.70	9	1.1	132.77
214 to 223	10	59.50	595.00	0	595.00	595.00	1.42	844.90	9	1.1	929.39
224	1	103.36	103.36	0	103.36	103.36	1.42	146.77	9	1.1	161.45
225	1	123.42	123.42	0	123.42	123.42	1.42	175.26	9	1.1	192.78
226	1	345.87	345.87	8	337.87	337.87	1.42	479.78	12	1.1	527.75
227	1	318.97	318.97	0	318.97	318.97	1.42	452.94	12	1.1	498.23
228	1	294.78	294.78	0	294.78	294.78	1.42	418.59	12	1.1	460.45
229, 230	2	365.94	731.88	0	731.88	731.88	1.42	1039.27	12	1.1	1143.20
231	1	457.03	457.03	8	449.03	449.03	1.42	637.62	12	1.1	701.38
232	1	376.32	376.32	8	368.32	368.32	1.42	523.01	12	1.1	575.32
233	1	272.61	272.61	0	272.61	272.61	1.42	387.11	12	1.1	425.82
234	1	294.71	294.71	0	294.71	294.71	1.42	418.49	12	1.1	460.34
235	1	661.84	661.84	12	649.84	649.84	1.42	922.77	18	1.1	1015.05
236	1	912.00	912.00	9	903.00	903.00	1.42	1282.26	18	1.1	1410.49
237	1	245.80	245.80	0	245.80	245.80	1.42	349.04	9	1.1	383.94
238	1	180.00	180.00	0	180.00	180.00	1.42	255.60	9	1.1	281.16
239	1	245.80	245.80	8	237.80	237.80	1.42	337.68	12	1.1	371.44
240	1	274.12	274.12	8	266.12	266.12	1.42	377.89	12	1.1	415.68
241, 242	2	215.00	430.00	0	430.00	430.00	1.42	610.60	9	1.1	671.66
243	1	229.41	229.41	0	229.41	229.41	1.42	325.76	9	1.1	358.34
244	1	912.04	912.04	9	903.04	903.04	1.42	1282.32	18	1.1	1410.55
245	1	729.64	729.64	9	720.64	720.64	1.42	1023.31	18	1.1	1125.64
246 to 249	4	215.00	860.00	0	860.00	860.00	1.42	1221.20	9	1.1	1343.32
250	1	296.48	296.48	8	288.48	288.48	1.42	409.64	12	1.1	450.61
251	1	512.16	512.16	8	504.16	504.16	1.42	715.91	12	1.1	787.50
252	1	268.06	268.06	0	268.06	268.06	1.42	380.65	9	1.1	418.71
253	1	267.43	267.43	0	267.43	267.43	1.42	379.75	9	1.1	417.73
254	1	885.22	885.22	9	876.22	876.22	1.42	1244.23	18	1.1	1368.66
T		47297.82	58177.11	349		57828.11	82115.92	1674.00	170.50	90327.51

FRAN CONSULTANTS
LAND SURVEYOR - K. V. FRANCIS
S NO:13/3A, PLOT.No: 12,

SCALE:

Adj - Existing Nalha

M

CP4

CP3

SS 19

a

AREA STATEMENT

1) TOTAL AREA OF LAND AS PER 7/12	102605.00 Sq m
2) AREA NOT FOR DEVELOPMENT	4000.00 Sq m
3) NET AREA UNDER DEVELOPMENT	98605.00 Sq m
4) AREA UNDER D.P. ROADS	3427.00 Sq m
5) AREA UNDER CHARRI	5400.00 Sq m
6) AREA UNDER OPEN SPACE	7445.30 Sq m
7) AREA UNDER .M. S .E. D. C. L. SPACE	282.00 Sq m
8) AREA UNDER AMENITY SPACE	4489.00 Sq m
9) AREA UNDER PLOTS	57828.11 Sq m
10) AREA UNDER COLONY ROADS	19733.59 Sq m

S.No : 12

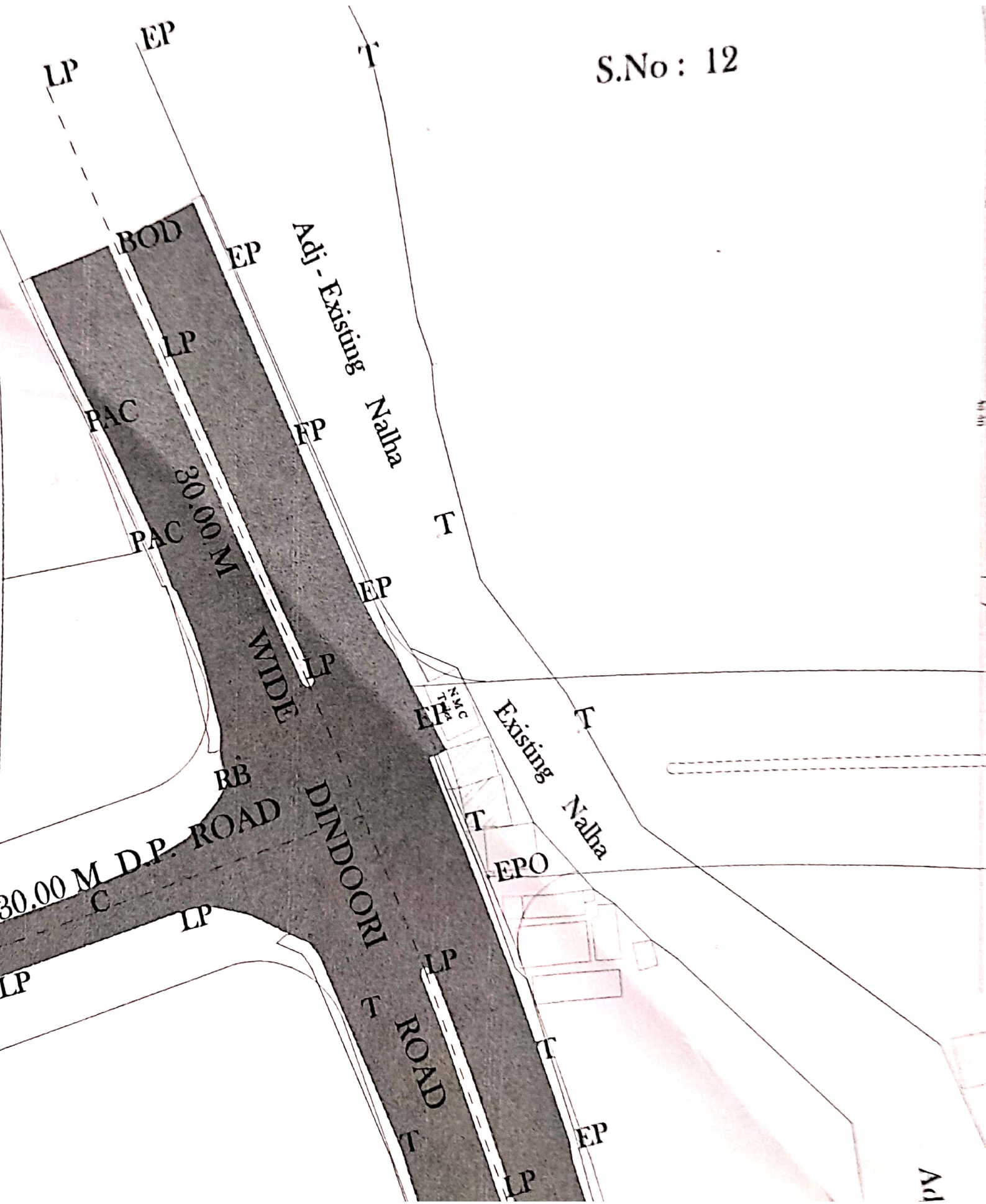

W
CH17

S.No : 11
Area - 4680.00 Sqm
Actual - 4685.00

S.No : 285
Area - 4020.00 Sqm
Actual - 4021.00

9.00 METER WIDE ROAD

AMENITY SPACE

9.00 M. WIDE COLONY ROAD

S.No : 283
Area - 8050.00 Sqm

30.00 M WIDE

D.P. ROAD

S.No : 284
Area - 4980.00 Sqm

W EP
S.No : 286
Area - 10650.00 Sqm

Adj

12.00 METER WIDE COLONY ROAD

9.00 M. WIDE ROAD

CHARTER - Area - 3300.00 Sqm

BOR - EF

W

AC

T

T

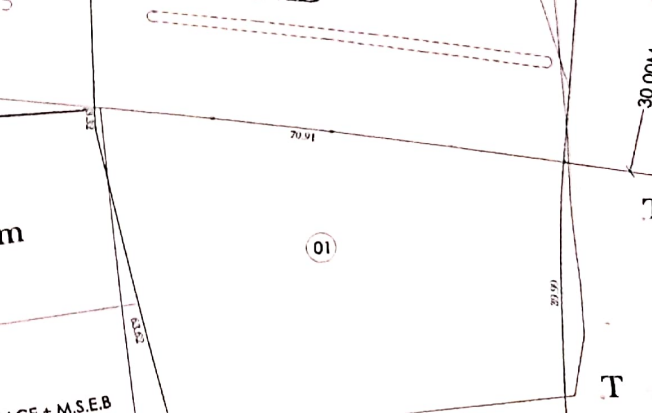
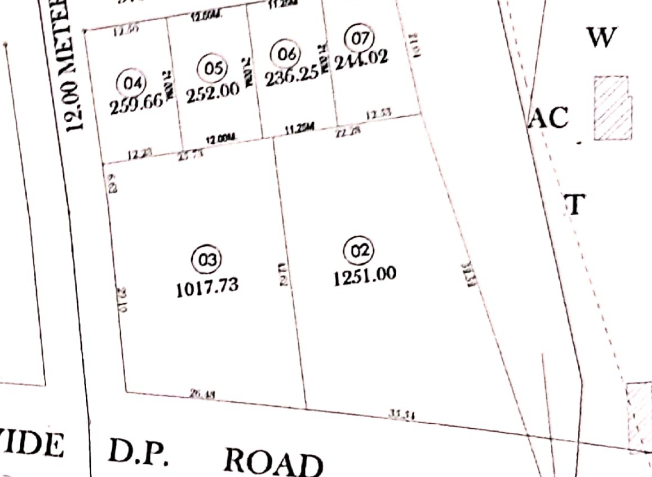
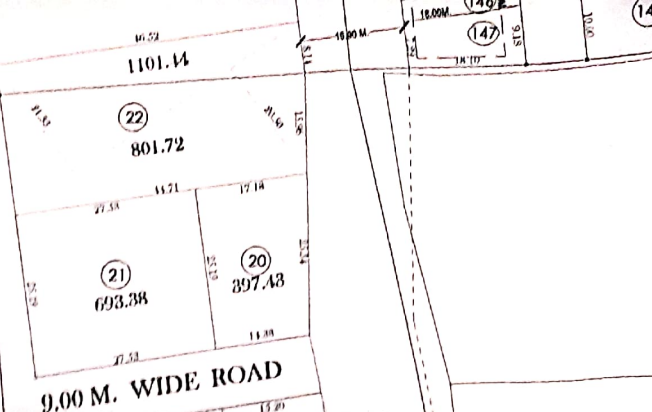
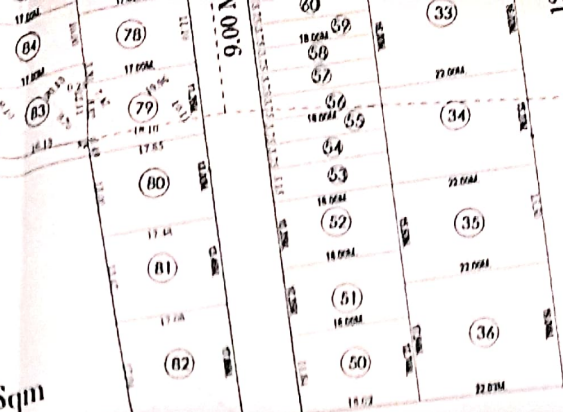

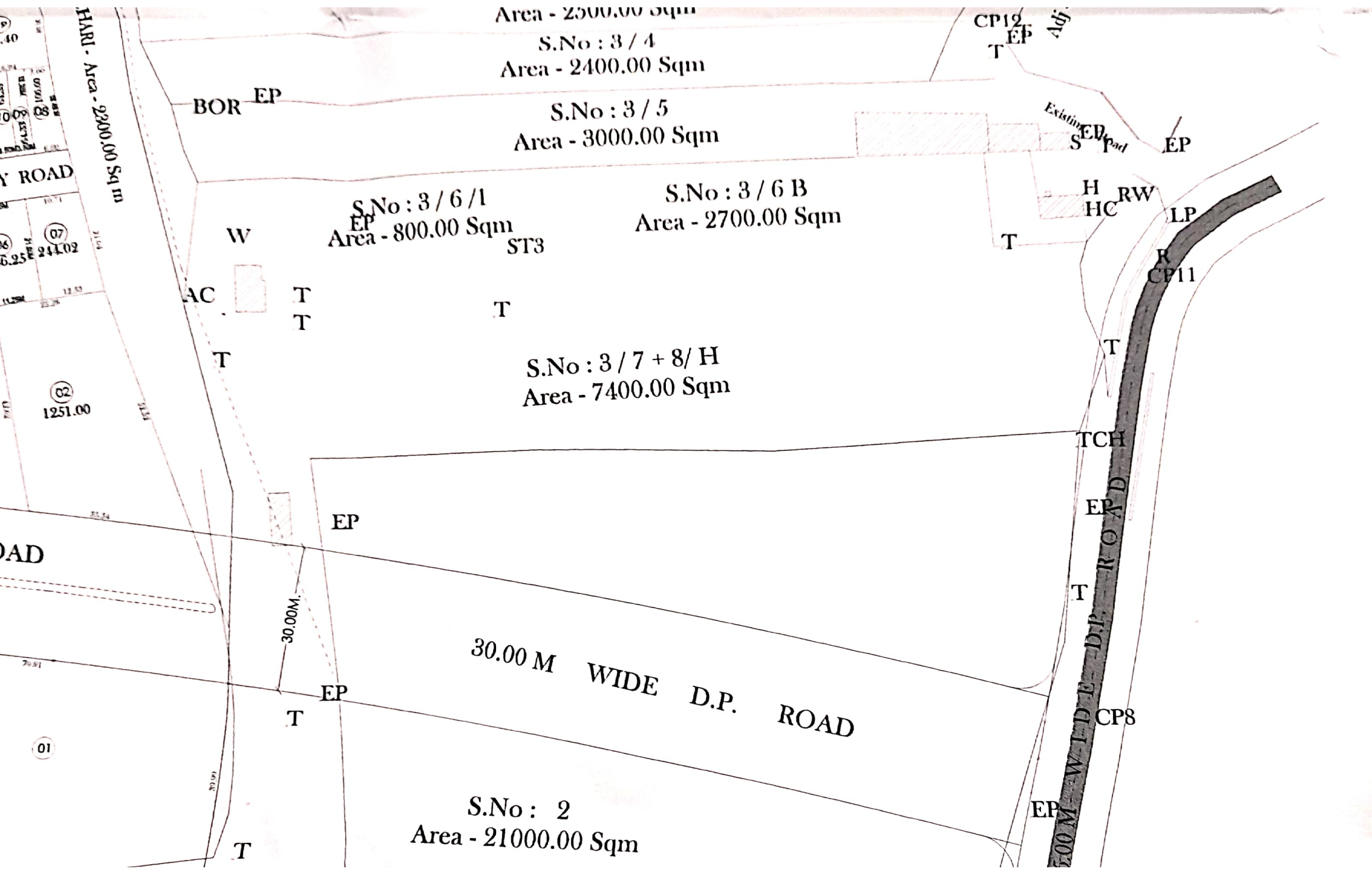

Area - 2500.00 Sqm

S.No : 3 / 4

Area - 2400.00 Sqm

BOR EP

S.No : 3 / 5

Area - 3000.00 Sqm

CP12
EP
T

Existing EP
S pad

EP

S.No : 3 / 6 / 1
EP
Area - 800.00 Sqm
ST3

S.No : 3 / 6 B
Area - 2700.00 Sqm

H
HC
RW

LP

R
CP11

W

AC

T
T

T

T

S.No : 3 / 7 + 8 / H
Area - 7400.00 Sqm

T

TCH

EP

T

EP

30.00 M WIDE D.P. ROAD

CP8

EP

T

EP

S.No : 2
Area - 21000.00 Sqm

T

HARI - Area - 2200.00 Sq m

Y ROAD

DAD

200 M WIDE D.P. ROAD

30.00M.

30.00M.

02
1251.00

07
244.02

01

09
08
07
06
05
04
03
02
01

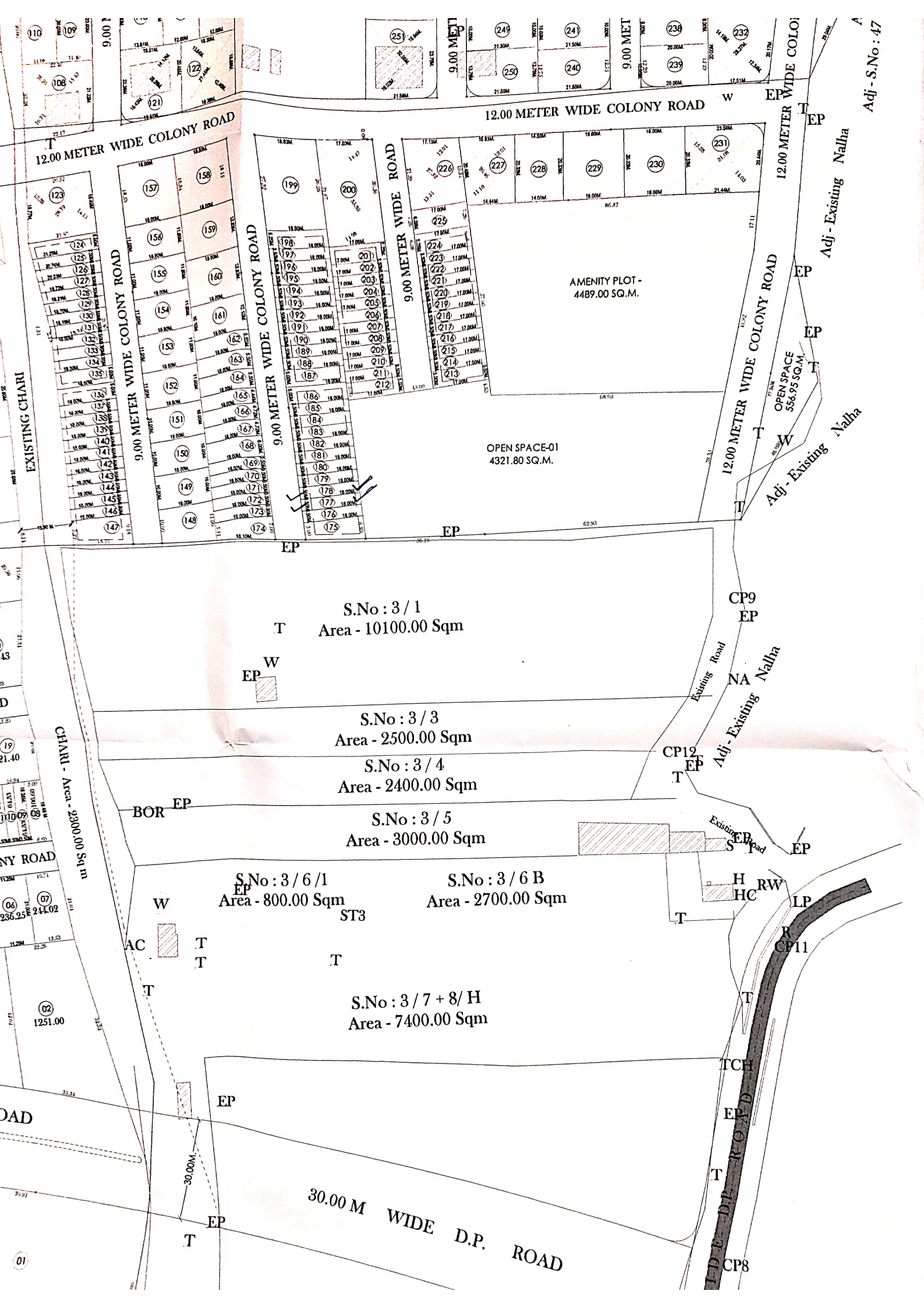

12.00 METER WIDE COLONY ROAD

12.00 METER WIDE COLONY ROAD W

12.00 METER WIDE COLONY ROAD

EXISTING CHARI

9.00 METER WIDE COLONY ROAD

9.00 METER WIDE COLONY ROAD

9.00 METER WIDE ROAD

AMENITY PLOT - 4489.00 SQ.M.

OPEN SPACE-01 4321.80 SQ.M.

OPEN SPACE 556.95 SQ.M.

Adj - Existing Nalha

Adj - Existing Nalha

S.No : 3 / 1
Area - 10100.00 Sqm

S.No : 3 / 3
Area - 2500.00 Sqm

S.No : 3 / 4
Area - 2400.00 Sqm

S.No : 3 / 5
Area - 3000.00 Sqm

S.No : 3 / 6 / 1
Area - 800.00 Sqm

S.No : 3 / 6 B
Area - 2700.00 Sqm

S.No : 3 / 7 + 8 / H
Area - 7400.00 Sqm

CHARI - Area - 2300.00 Sqm

30.00 M WIDE D.P. ROAD

DEEP ROAD

Adj - S.No : 19

Adj - S.No : 19

18.00 M WIDE D.P. ROAD

18.00 M WIDE

S.No : 5 / 2 / (P)
Area - 4000.00 Sq m

NOT FOR DEVELOPMENT
Area - 4000.00

9.0 METER WIDE COLONY ROAD

9.0 METER WIDE COLONY ROAD

9.00 METER WIDE COLONY ROAD

9.00 METER WIDE COLONY ROAD

9.00 METER WIDE COLONY ROAD

12.00 METER WIDE COLONY ROAD

12.00 METER WIDE COLONY ROAD

9.00 METER WIDE COLONY ROAD

12.00 METER WIDE COLONY ROAD

AMENITY PLOT -
4489.00 SQ.M.

OPEN SPACE-01
4321.80 SQ.M.

12.00 METER WIDE COLONY ROAD

OPEN SPACE
556.95 SQ.M.

S.No : 3 / 1
Area - 10100.00 Sqm

S.No : 3 / 3
Area - 2500.00 Sqm

CP9
EP

Existing Road
- Existing Nalha

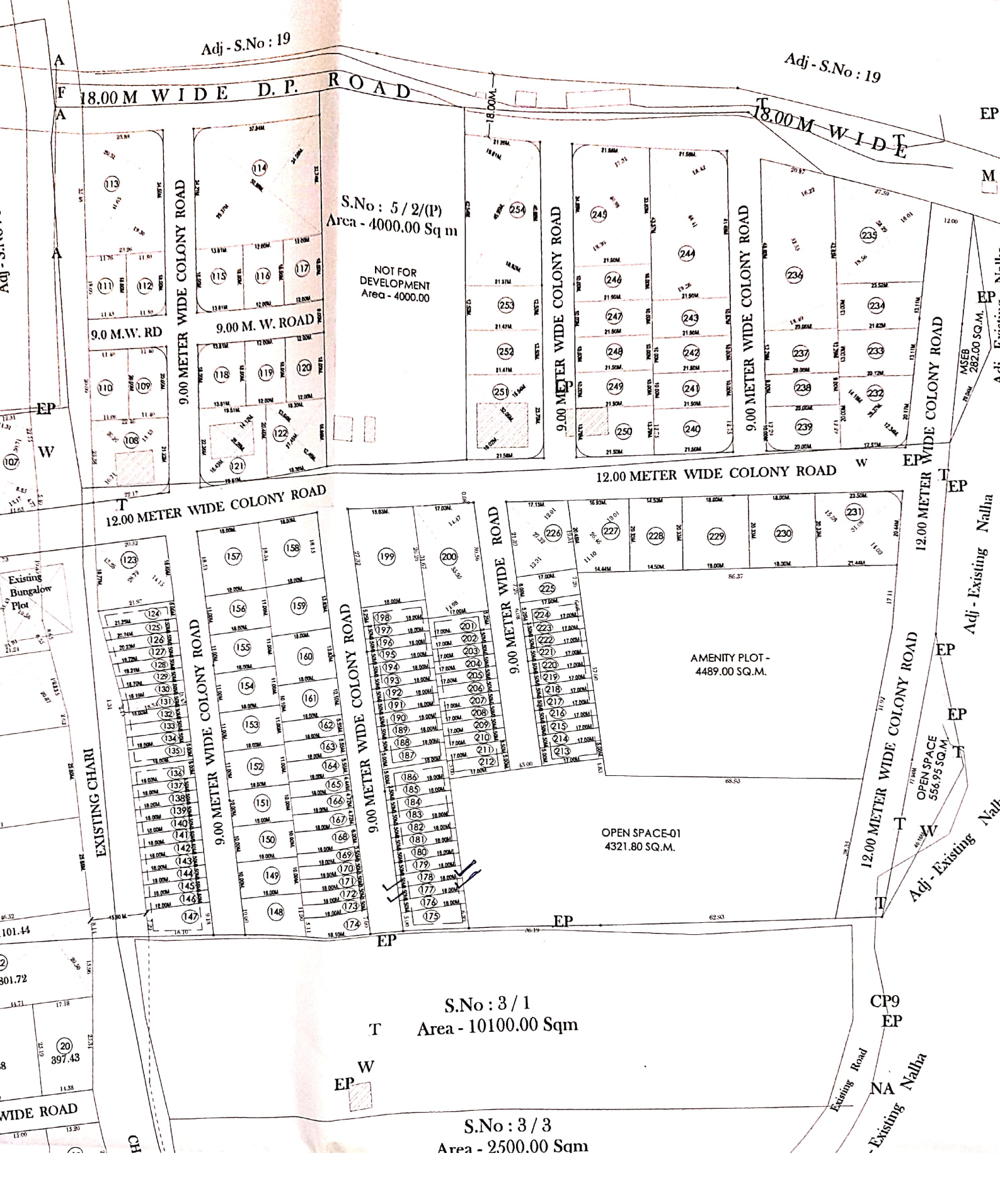

Adj - S.No : 19

Adj - S.No : 19

18.00 M WIDE D.P. ROAD

18.00 M WIDE

S.No : 5 / 2 (P)
Area - 4000.00 Sq m

NOT FOR
DEVELOPMENT
Area - 4000.00

9.00 METER WIDE COLONY ROAD

9.00 METER WIDE COLONY ROAD

9.00 METER WIDE COLONY ROAD

12.00 METER WIDE COLONY ROAD

12.00 METER WIDE COLONY ROAD

9.00 METER WIDE ROAD

12.00 METER WIDE COLONY ROAD

AMENITY PLOT -
4489.00 SQ.M.

OPEN SPACE-01
4321.80 SQ.M.

OPEN SPACE
556.99 SQ.M.

S.No : 3 / 1

Area - 10100.00 Sqm

CP9
EP

ing Road
NA
Nalha

EP
M

EP
Adj - Existing Nalha

Adj - S.No : 47

EP
Adj - Existing Nalha

EP

Adj - Existing Nalha

EP

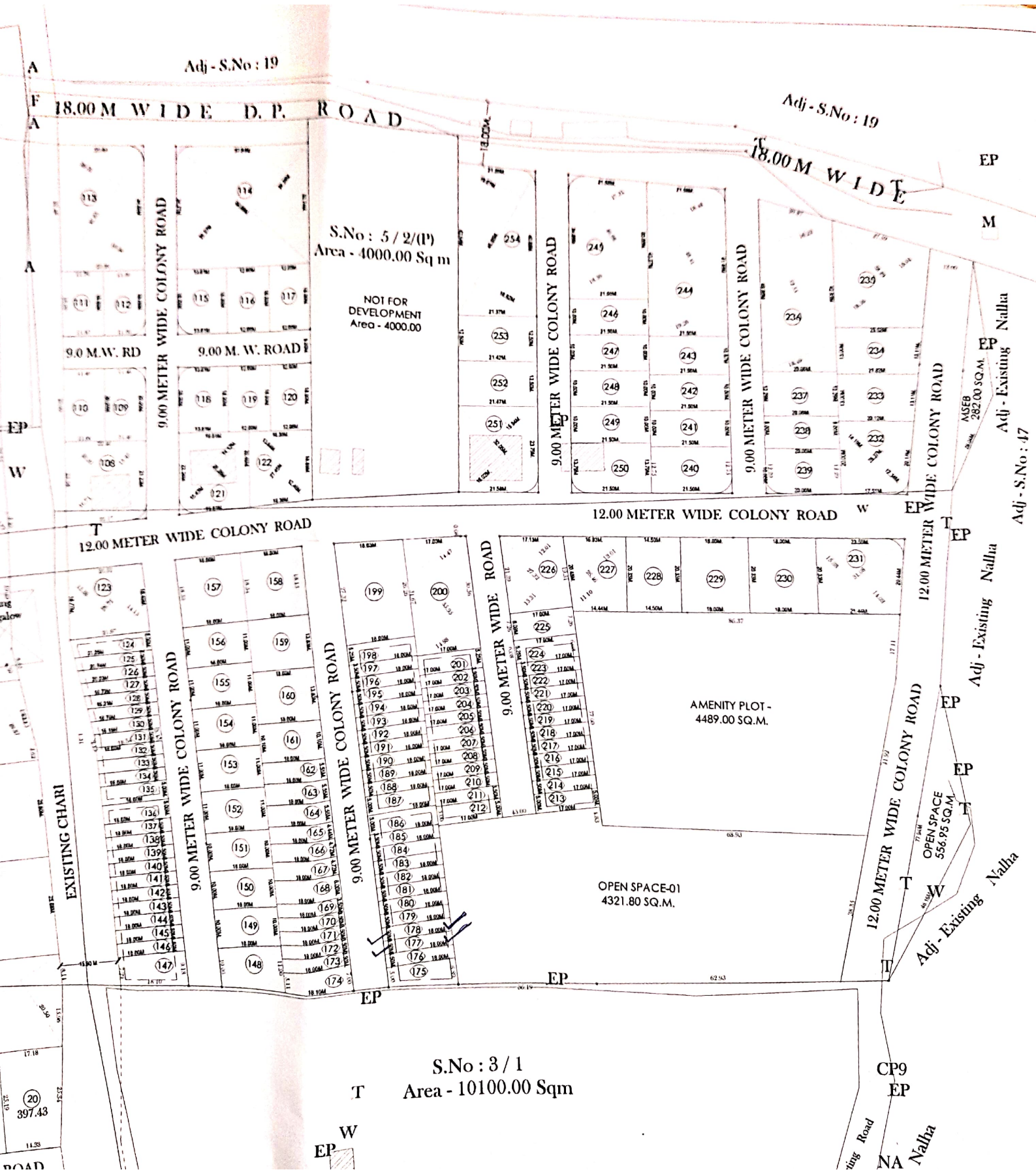

EP
W

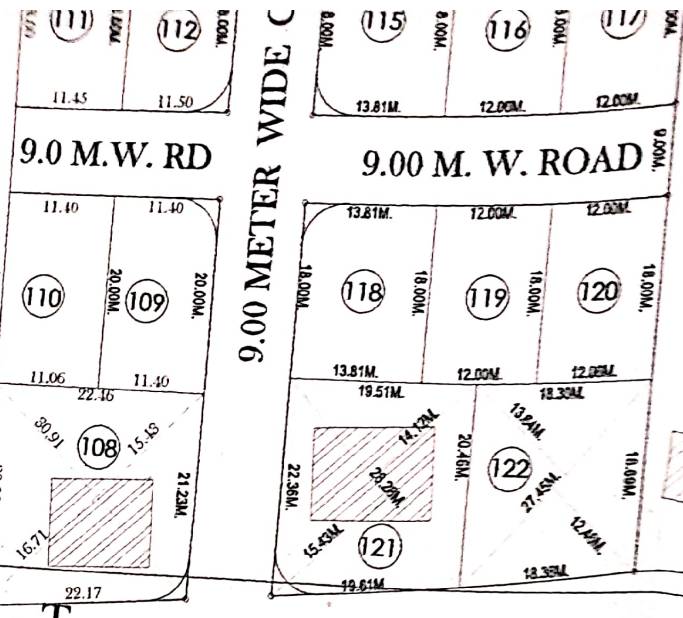

NOT FOR DEVELOPMENT
Area - 4000.00

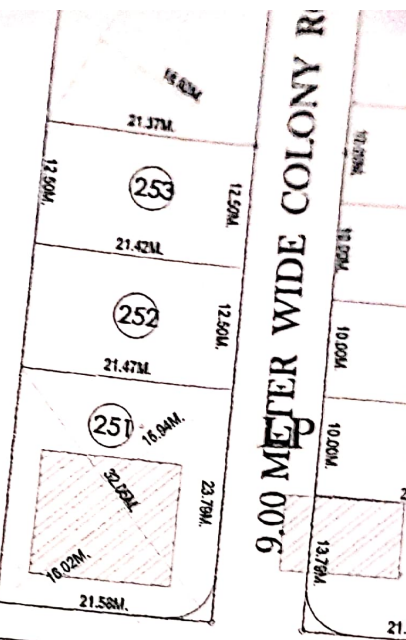

T
12.00 METER WIDE COLONY ROAD

EXISTING CHARI

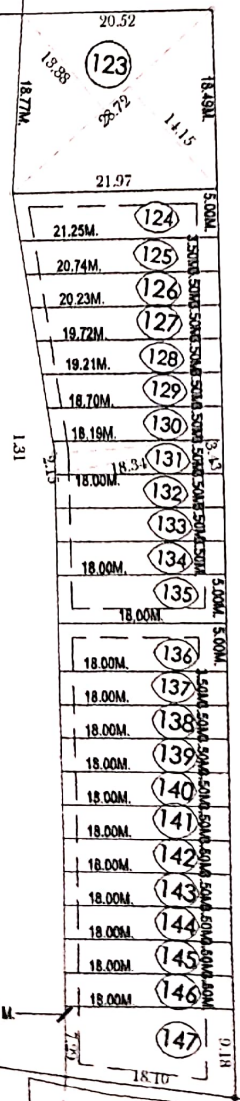

9.00 METER WIDE COLONY ROAD

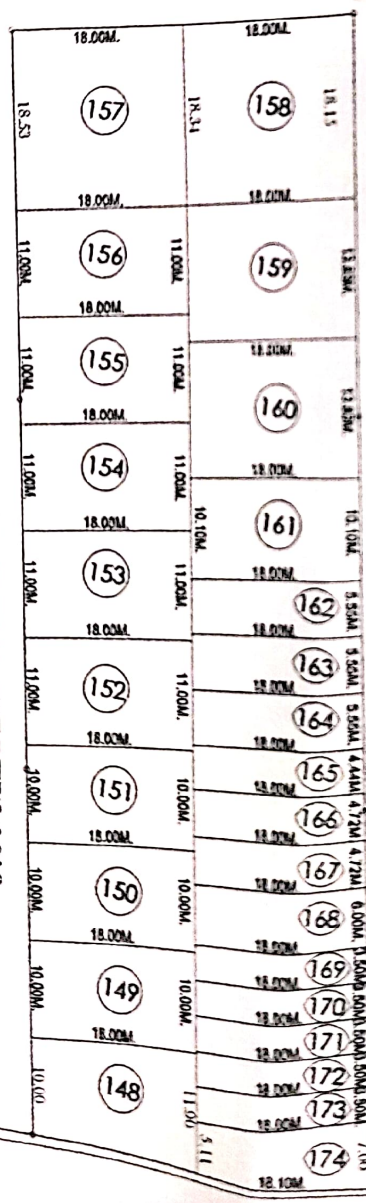

9.00 METER WIDE COLONY ROAD

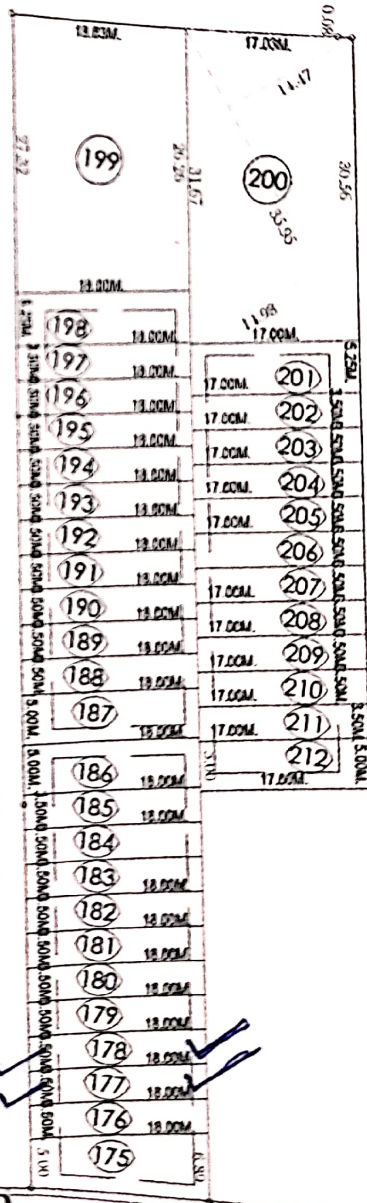

9.00 METER WIDE ROAD

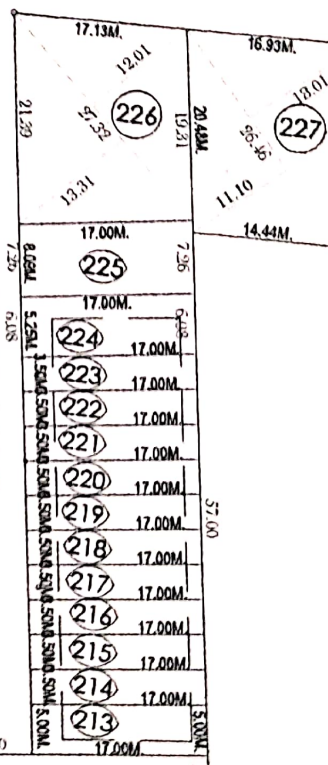

OPEN SPACE
4321.80 SQ

EP

EP

S.No : 3/1

A D

Adj - S.No : 19

: 5 / 2 / (P)
000.00 Sq m

NOT FOR
DEVELOPMENT
a - 4000.00

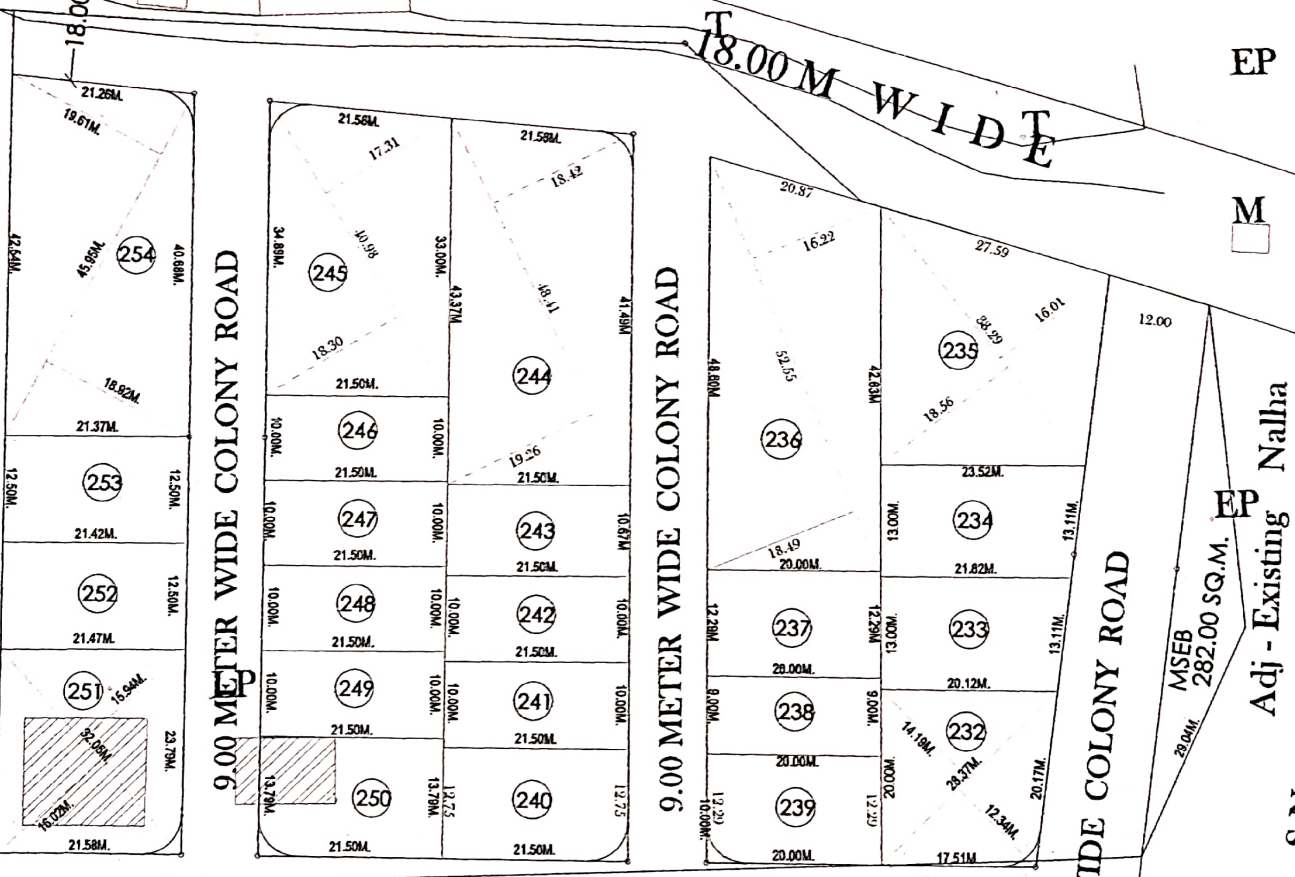

EP

M

Adj - Existing Nalha
MSEB
282.00 SQ.M.

Adj - S.No : 47

12.00 METER WIDE COLONY ROAD

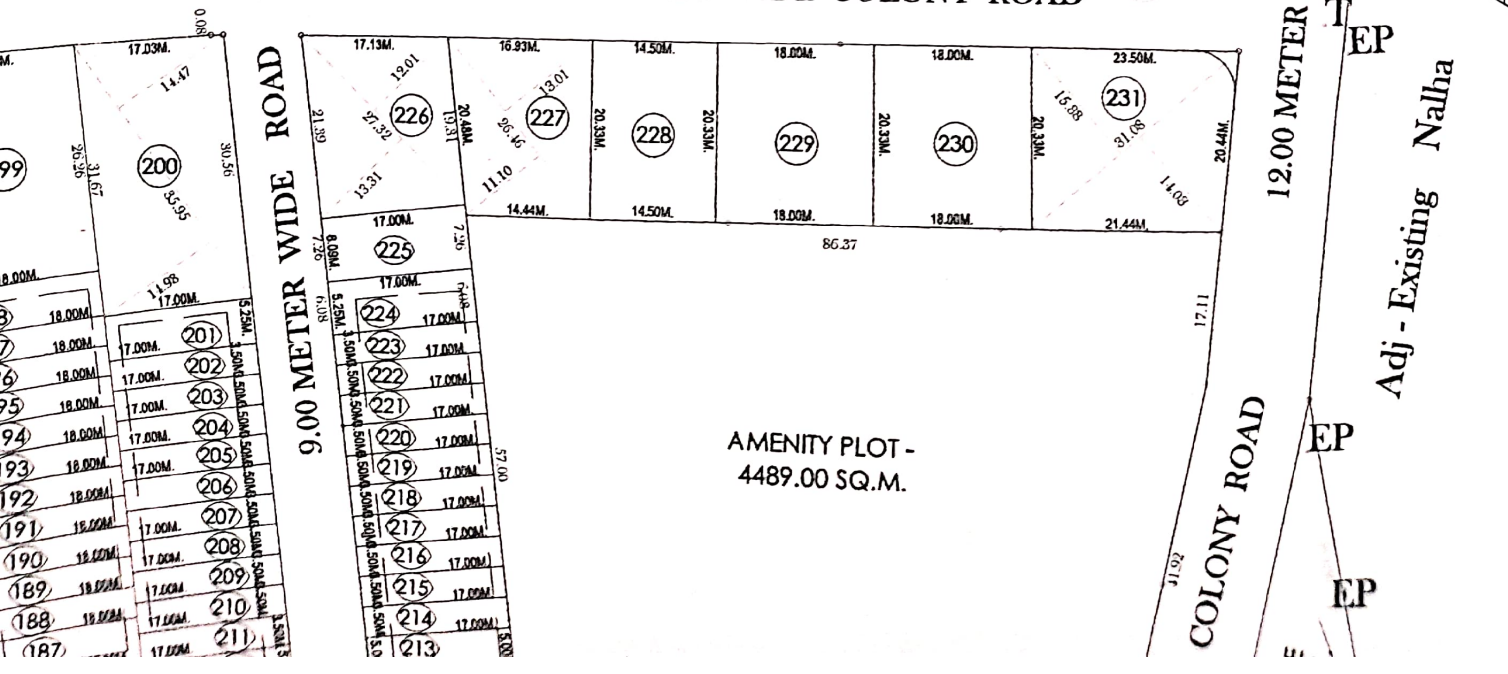

Adj - Existing Nalha

EP

EP

F 18.00 M W I D E D . P . R O A D

A

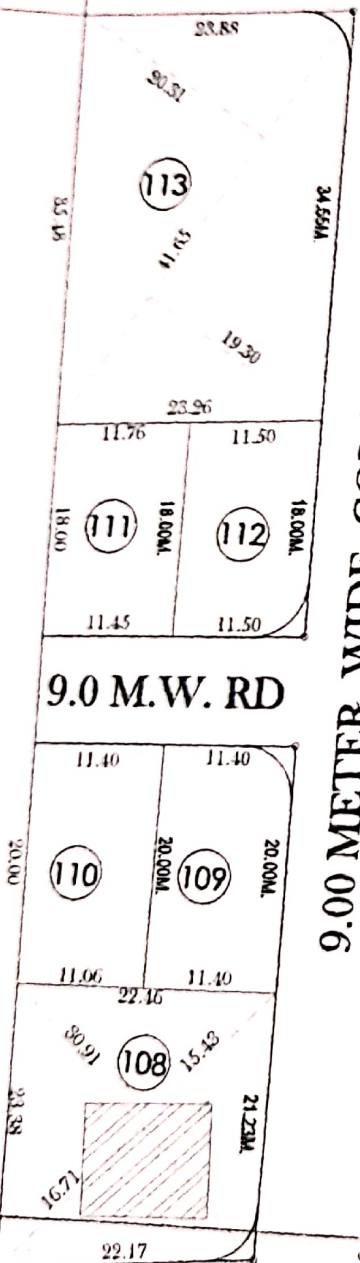

9.00 METER WIDE COLONY ROAD

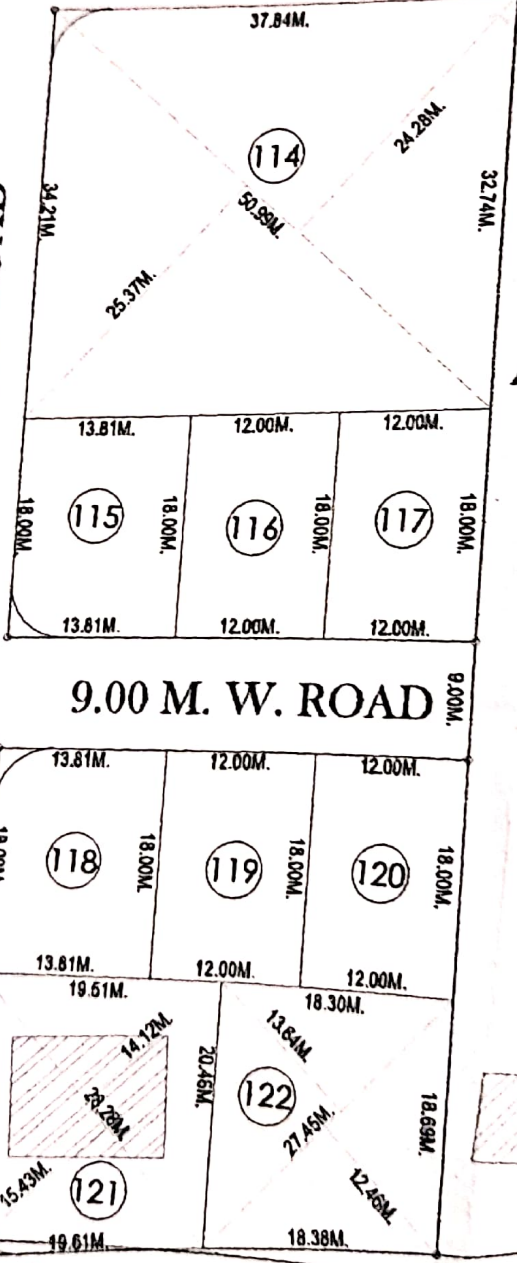

S.No : 5 / 2 / (P)
Area - 4000.00 Sq m

NOT FOR DEVELOPMENT
Area - 4000.00

9.00 M . W . R O A D

9.0 M . W . R D

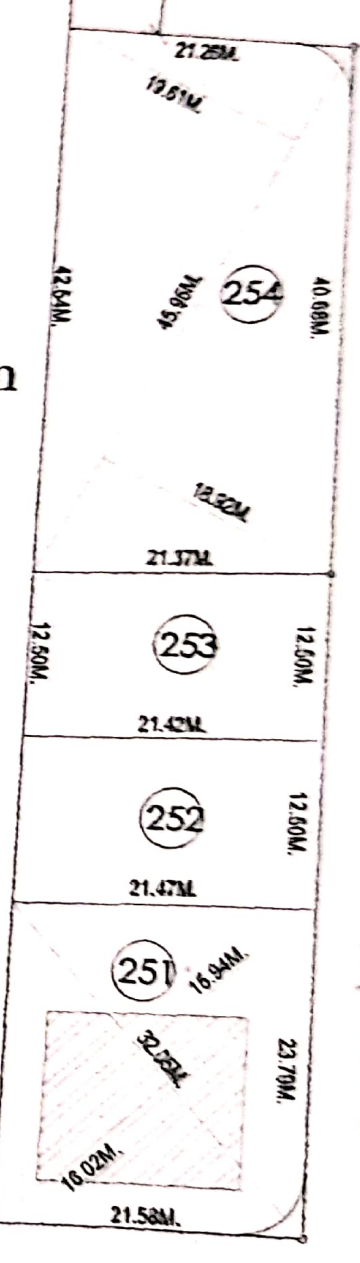

9.00 METER WIDE COLONY ROAD

T 12.00 METER WIDE COLONY ROAD

S.No : 6
Area - 19800.00 Sqm
M.R.No: 4214/2014

ADDRESS
CENT. APPR. LAYOUT NO. 400/2021/D1 (18.06.2021)
AMENITY PLOT
OPEN SPACE 20

Adj - S.No : 6

Adj - S.No : 6

Adj - S.No : 288

Adj - S.No : 287

Adj - S.No : 13

OPEN SPACE-02
2566.55

Existing Bungalow Plot

EXISTING CHARI

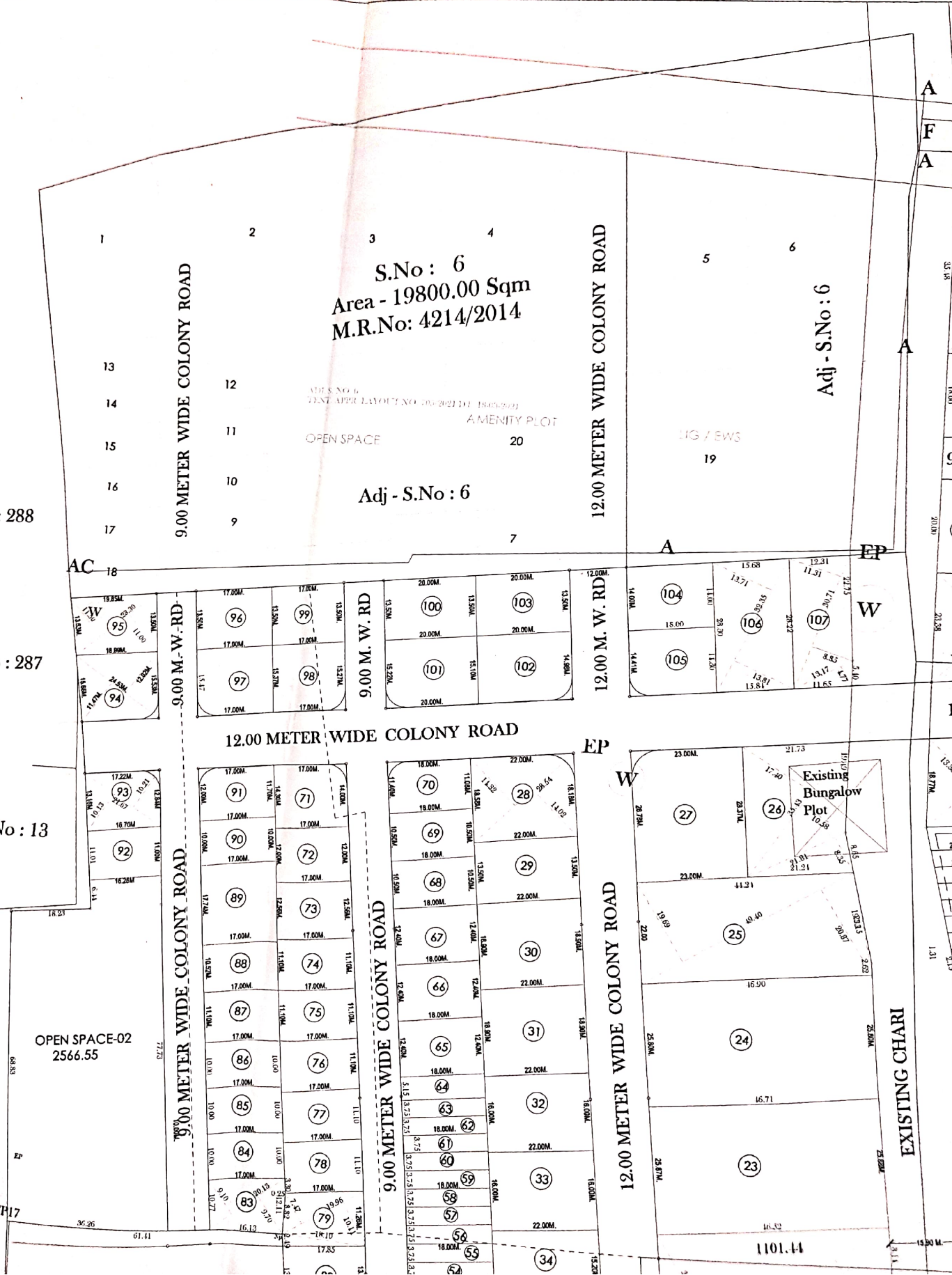

Adj - S.No : 287

Adj - S.No : 13

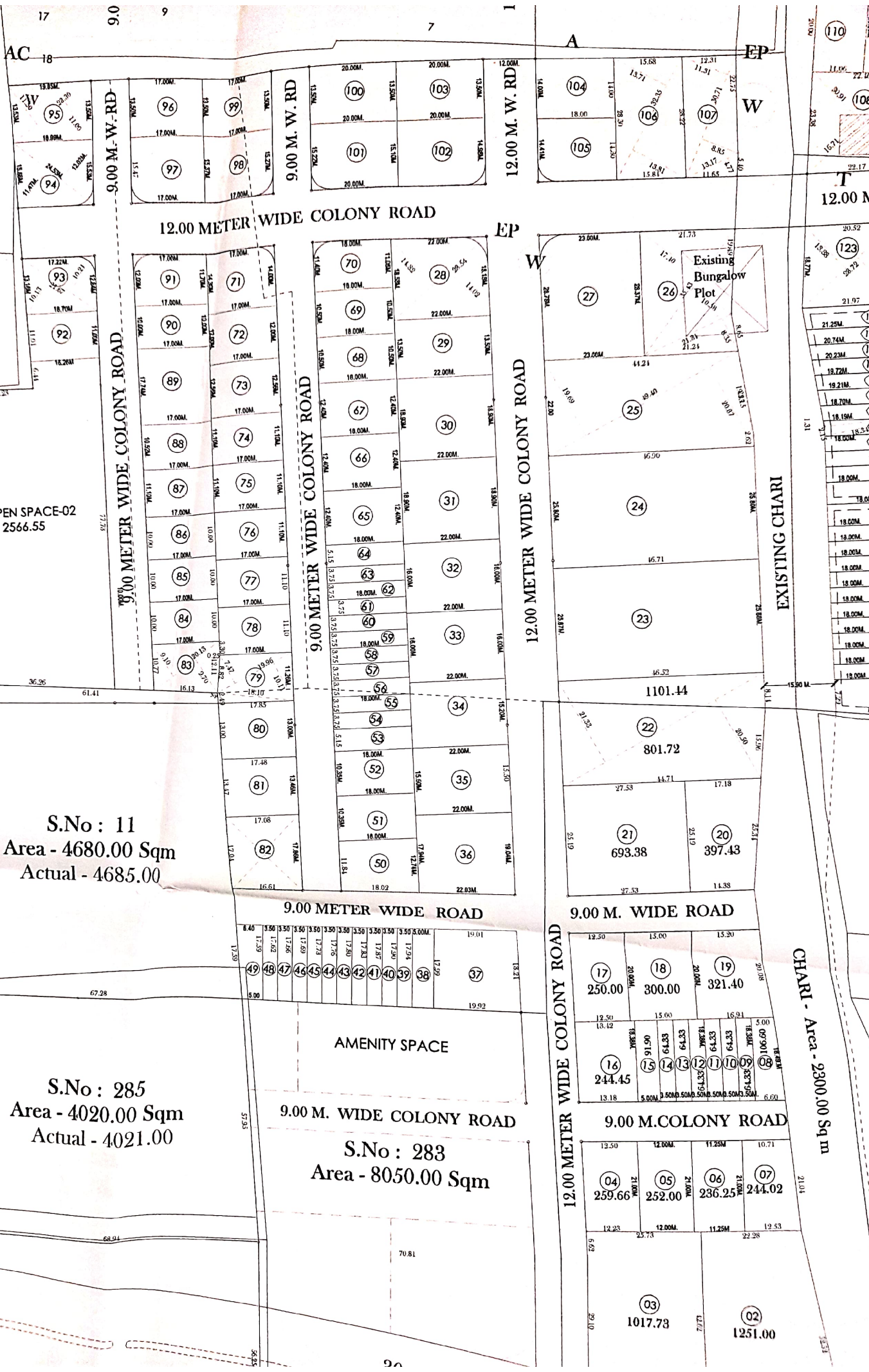

S.No : 11
Area - 4680.00 Sqm
Actual - 4685.00

S.No : 285
Area - 4020.00 Sqm
Actual - 4021.00

S.No : 283
Area - 8050.00 Sqm

S.No : 11
 Area - 4680.00 Sqm
 Actual - 4685.00

S.No : 285
 Area - 4020.00 Sqm
 Actual - 4021.00

9.00 METER WIDE ROAD

AMENITY SPACE

9.00 M. WIDE COLONY ROAD

S.No : 283
 Area - 8050.00 Sqm

30.00 M WIDE

D.P. ROAD

S.No : 286
 Area - 10650.00 Sqm

S.No : 284
 Area - 4980.00 Sqm

OPEN SPACE + M.S.E.B
 1169.88 SQ.M.

Adj - Existing Nalla

AREA STATEMENT

1) TOTAL AREA OF LAND AS PER 7/12	102605.00 Sq m
2) AREA NOT FOR DEVELOPMENT	4000.00 Sq m
3) NET AREA UNDER DEVELOPMENT	98605.00 Sq m
4) AREA UNDER D.P. ROADS	3427.00 Sq m
5) AREA UNDER CHARRI	5400.00 Sq m
6) AREA UNDER OPEN SPACE	7445.30 Sq m
7) AREA UNDER M. S. E. D. C. L. SPACE	282.00 Sq m
8) AREA UNDER AMENITY SPACE	4489.00 Sq m
9) AREA UNDER PLOTS	57828.11 Sq m
10) AREA UNDER COLONY ROADS	19733.59 Sq m

T
12.00 METER WIDE COLONY ROAD

12.00 METER WIDE COLONY ROAD

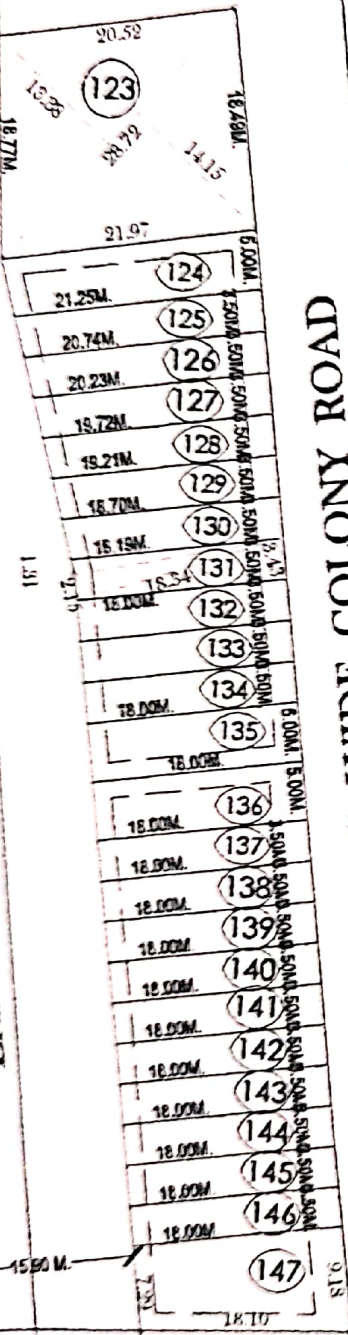

9.00 METER WIDE COLONY ROAD

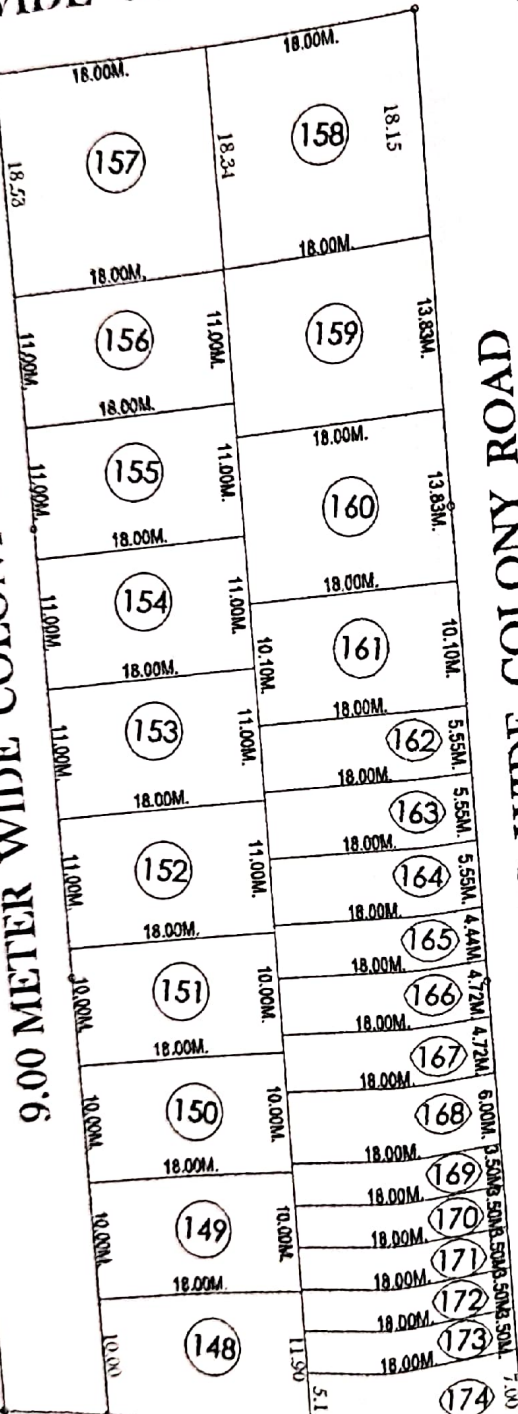

9.00 METER WIDE COLONY ROAD

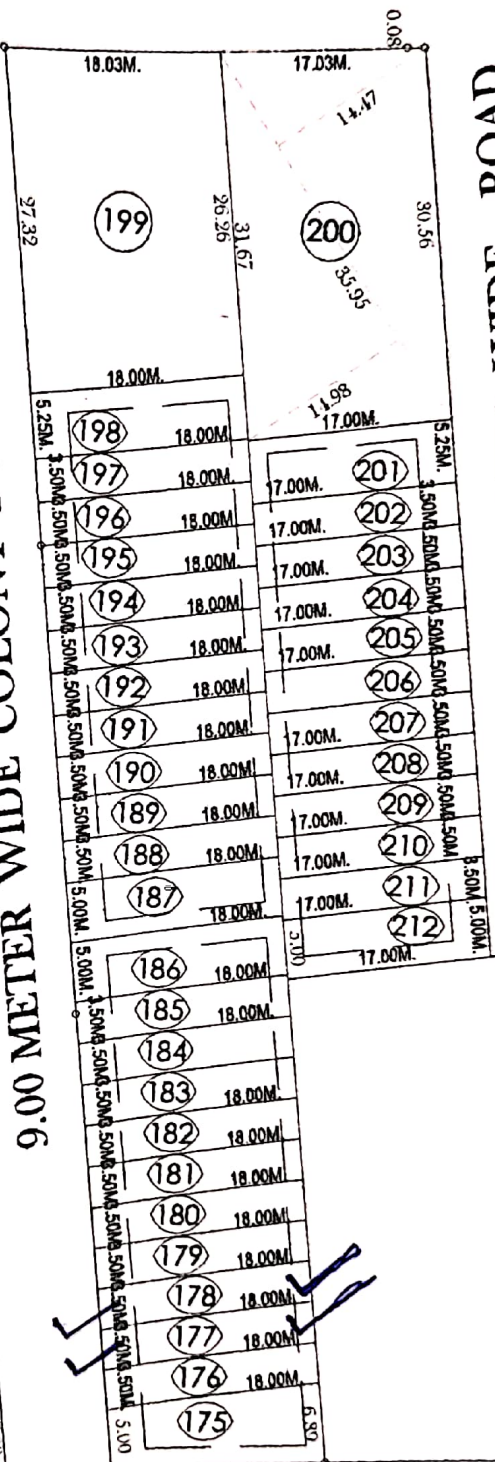

9.00 METER WIDE ROAD

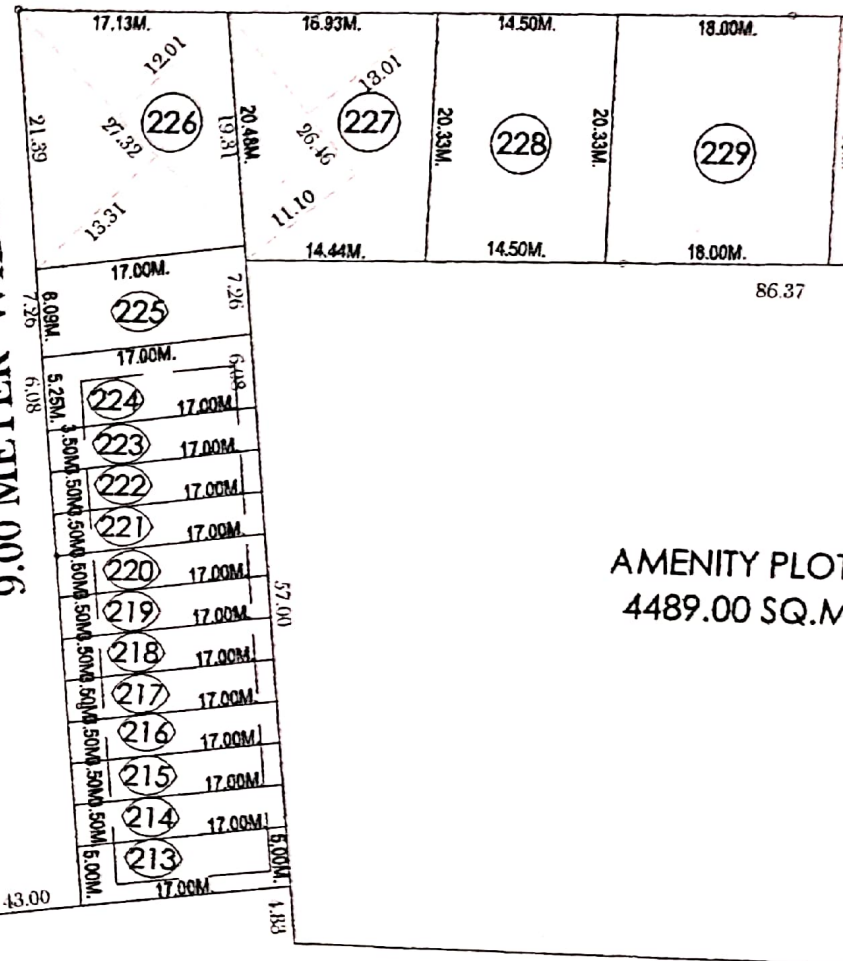

AMENITY PLOT
4489.00 SQ.M.

OPEN SPACE-01
4321.80 SQ.M.

EP