

SECTION G - G  
1:100

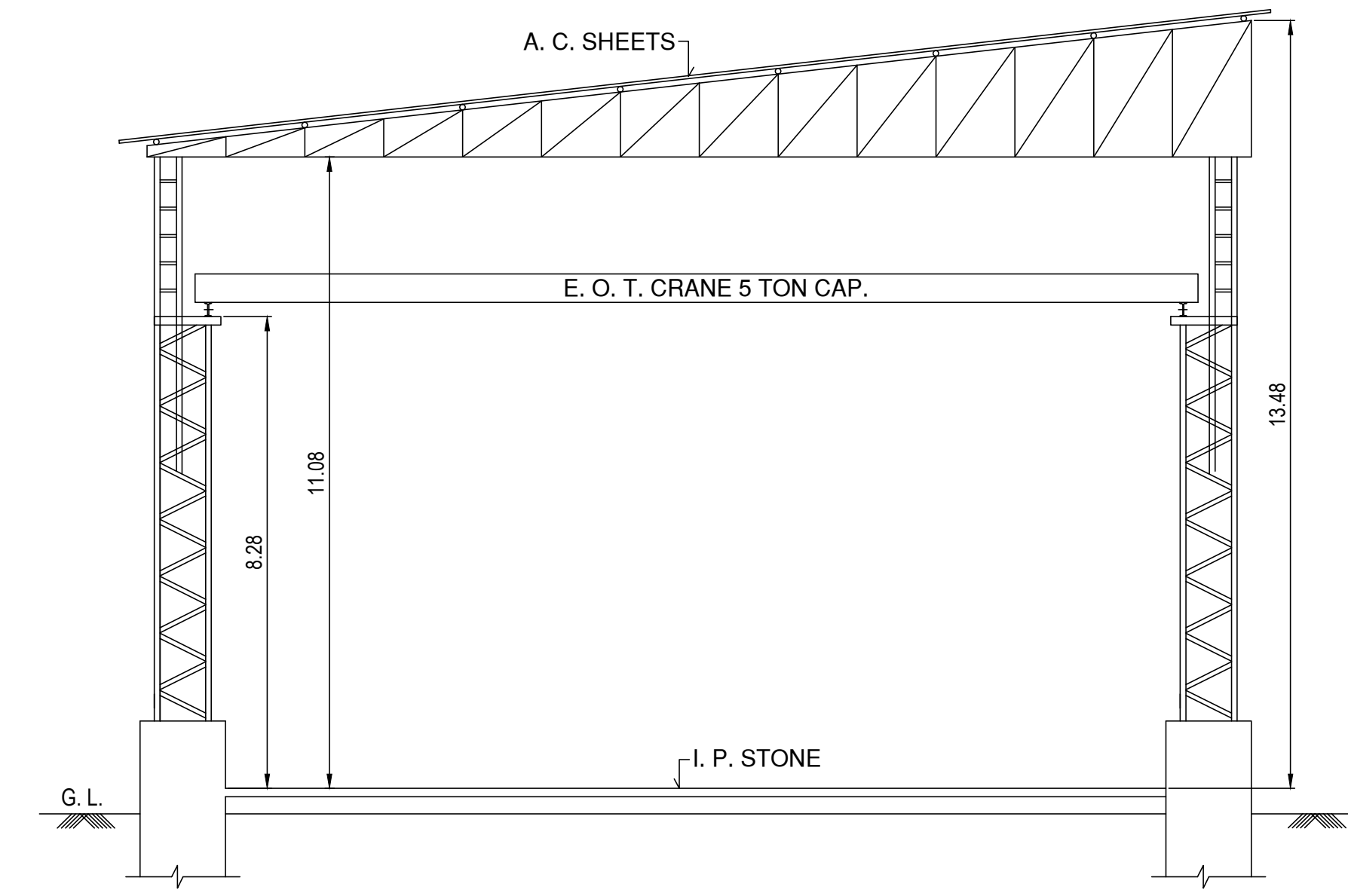

SECTION H - H  
1:100

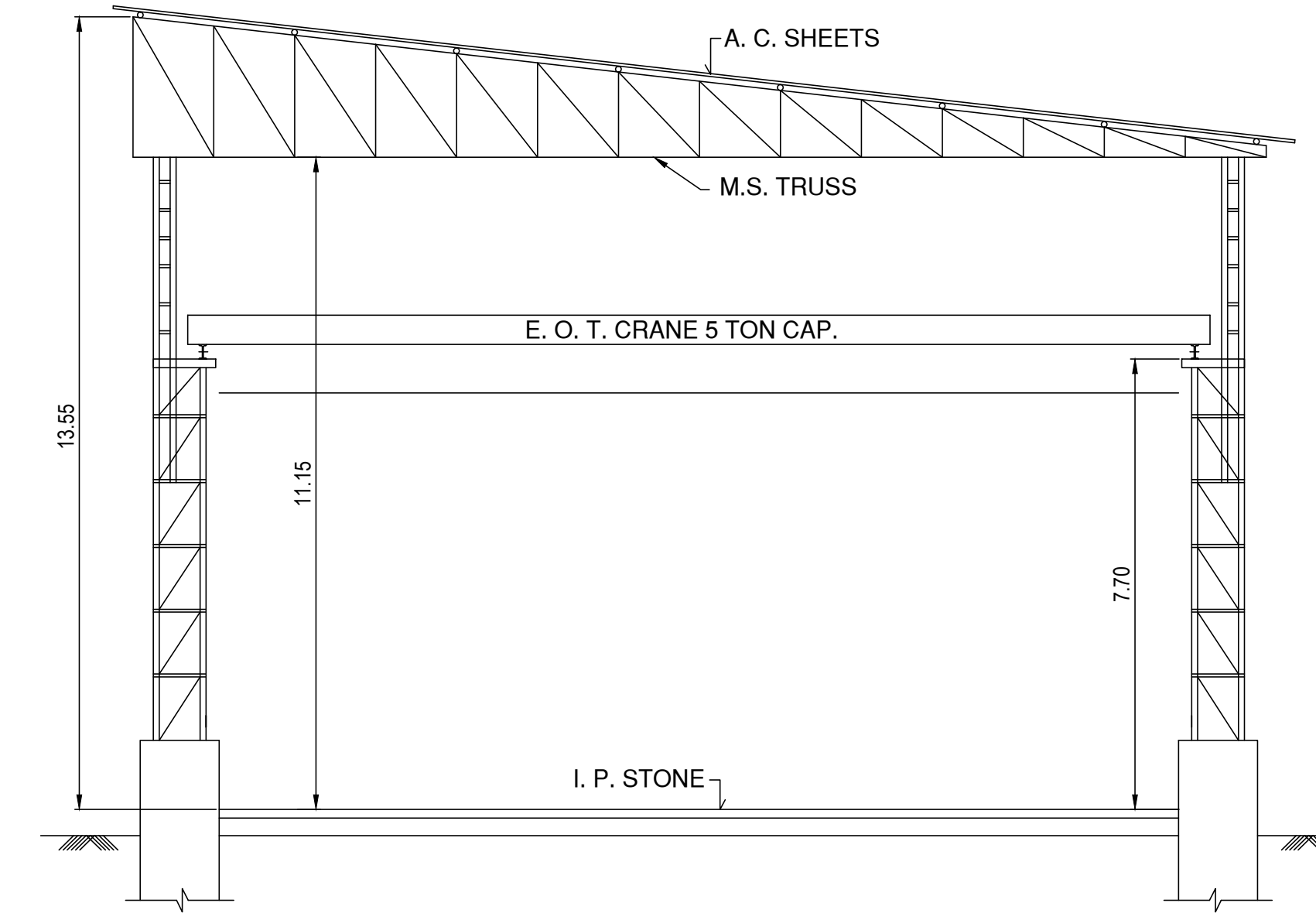

SECTION J - J  
1:100

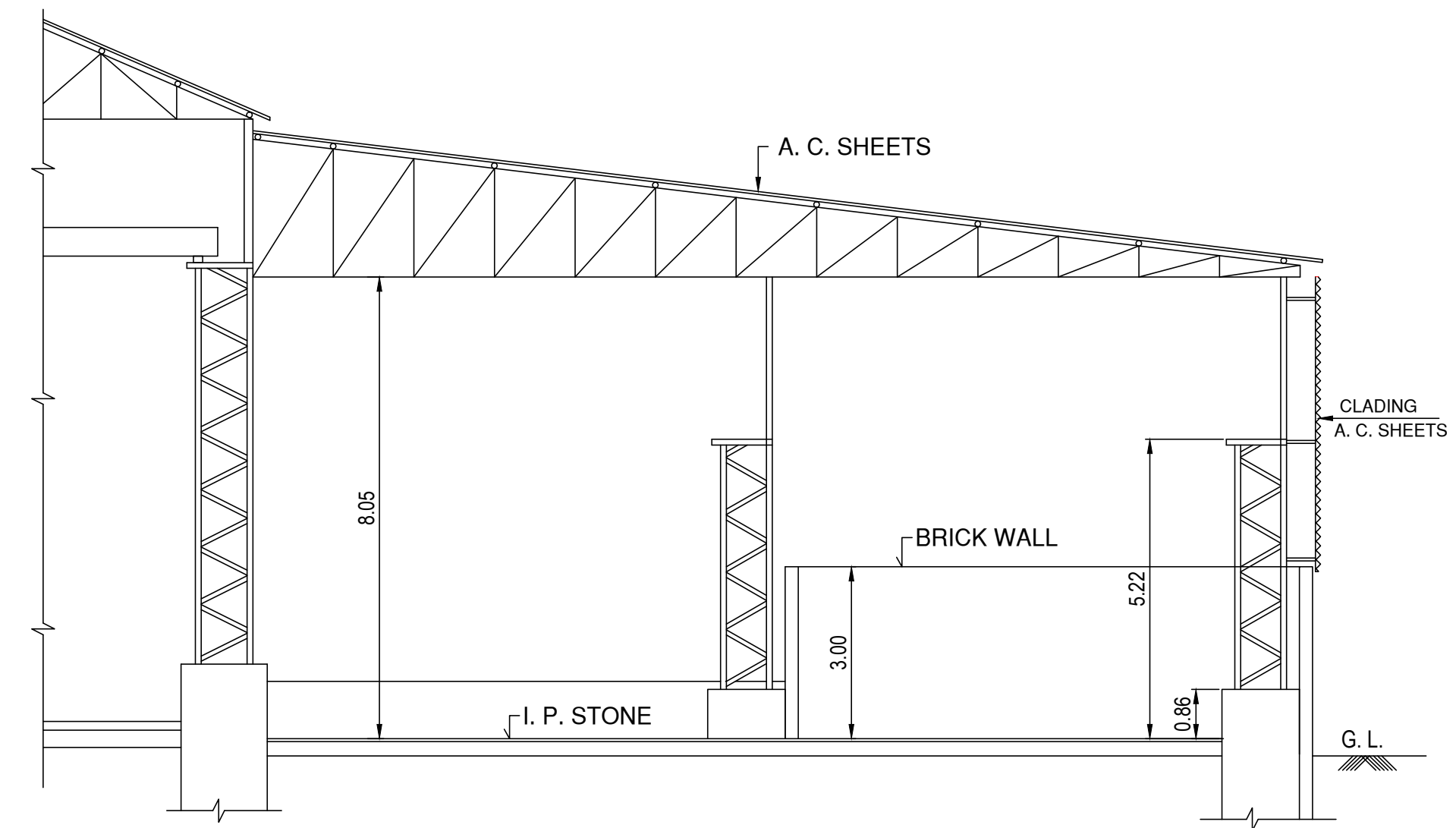

SECTION K - K  
1:100

MACHINERY STATEMENT

S.N.	MARK	NAME	NOS.	SIZE	REMARK
1.	M1	DRILL MC	1	1.60X0.70	
2.	M2	LATHE MC	2	5.25X2.95	
3.	M3	SHAPPING MC	1	1.40X2.60	
4.	M4	LATHE MC	1	5.10X1.95	
5.	M5	LATHE MC	4	3.90X1.90	
6.	M6	LATHE MC	1	5.15X2.00	
7.	M7	LATHE MC	1	5.25X1.60	
8.	M8	LATHE MC	1	3.90X1.90	
9.	M9	LATHE MC	1	4.00X1.50	
10.	M10	LATHE MC	1	2.70X1.17	
11.	M11	ROLLING MC	3	6.50X13.20	
12.	M12	ROLLING MC	1	6.50X15.77	
13.	M13	WATER STARTER	4	1.90X1.00	
14.	M14	POWER PRESS	2	1.55X2.10	
15.	M15	BLOWER	1	1.10X0.90	
16.	M16	RE-HEATING FURNACE	1	25.10X4.90	
17.	M17	PUSHER	1	2.50X2.70	
18.	M18	INJECTOR	1	1.50X2.20	
19.	M19	COAL FEEDER	2	2.25X1.90	
20.	M20	HOPPER	1	1.70X2.50	
21.	M21	BLOWER	4	0.50X1.00	
22.	M22	HOPPER	1	2.48X2.25	
23.	M23	ROLLING MILL	1	3.00X14.20	
24.	M24	POWER PRESS	1	1.25X1.60	
25.	M25	STRAIGHTNING	1	2.16X2.00	
26.	M26	BENCH GRINDER	2	0.45X0.25	
27.	M27	GRINDER	1	0.74X0.50	
28.	M28	TESTING MC	1	1.58X0.60	
29.	M29	UNIVERSAL TESTING MC	1	2.10X0.75	

EARLIER APPROVAL NO.  
PLN/KN/VVK/315/7018/08  
DATED = 01-12-2008



GROUND FLOOR PLAN  
1:100

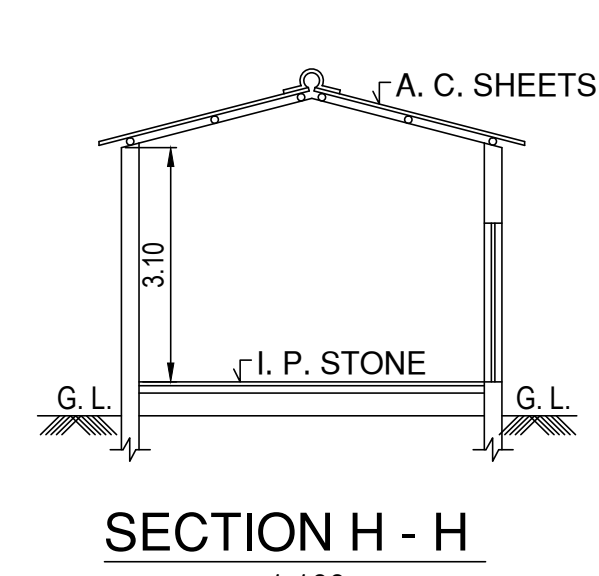

SECTION H - H  
1:100

- NOTES-
1. APPLICANT'S PREMISES SHOWN THUS
  2. MACHINERY SHOWN THUS
  3. URINALS SHOWN THUS
  4. WASH BASINS SHOWN THUS