

(A) PLOT BEFORE SUB DIVISION

PLOT NO	AREA AS PER 7/12	AREA AS PER LAYOUT	ROAD WIDENING AREA	NET PLOT AREA
30	300.00 Sqmt	278.70 Sqmt	11.43 Sqmt.	267.27 Sqmt.
TOTAL	300.00 Sqmt	278.70 Sqmt	11.43 Sqmt.	267.27 Sqmt.

(B) PLOT AFTER SUB DIVISION

PLOT NO	AREA AS PER 7/12 (Sqmt)	AREA AS PER LAYOUT (Sqmt)	ROAD WINDING AREA (Sqmt)	NET PLOT AREA (Sqmt)	NET PLOT AREA AS PER 7/12 (Sqmt)
30/A	110.83	102.96	4.2225	98.74	106.6075
30/B	78.34	72.78	2.9850	69.79	75.355
30/C	110.83	102.96	4.2225	98.74	106.6075
TOTAL AREA	300.00	278.70	11.4300	267.27	288.57

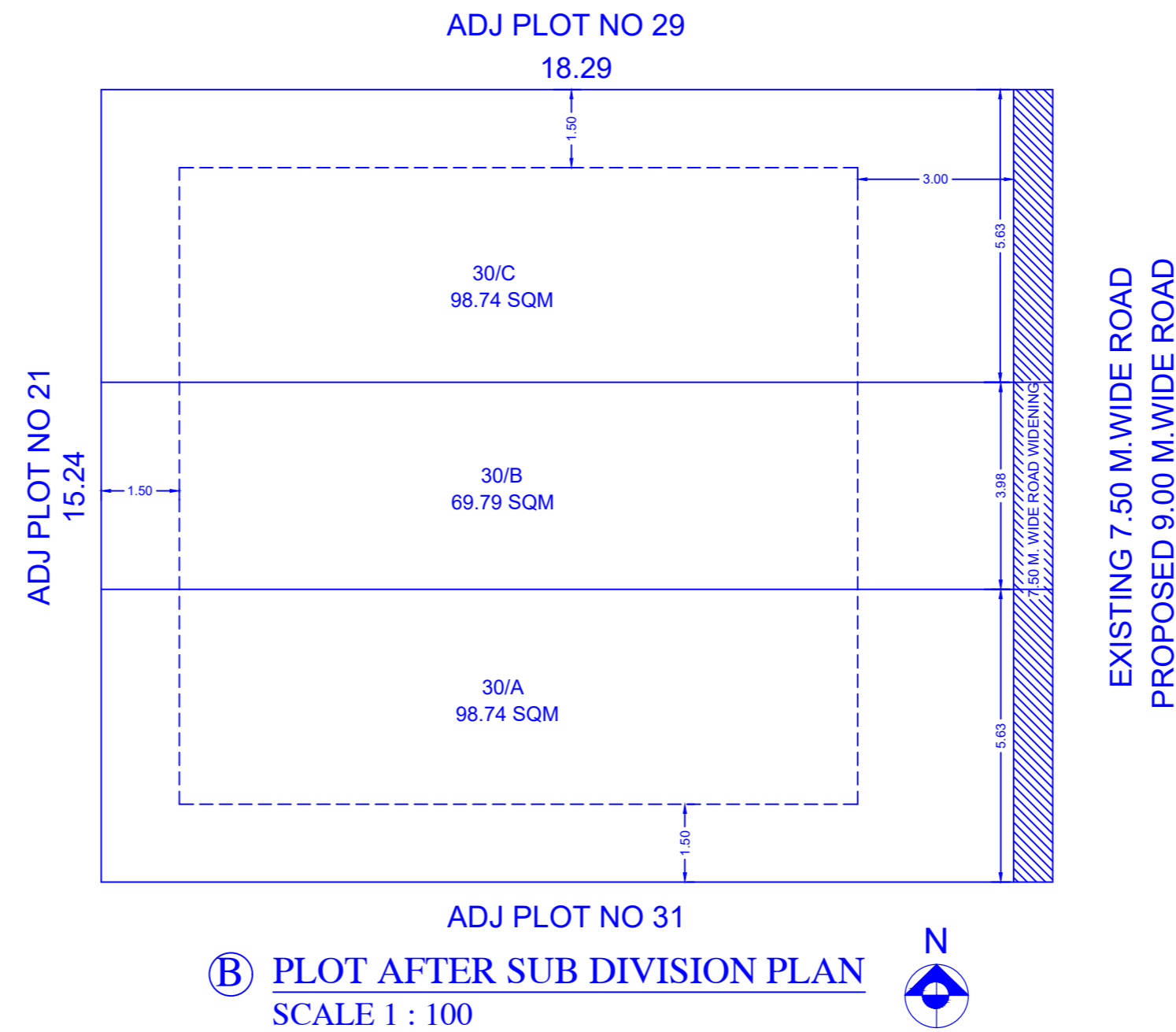
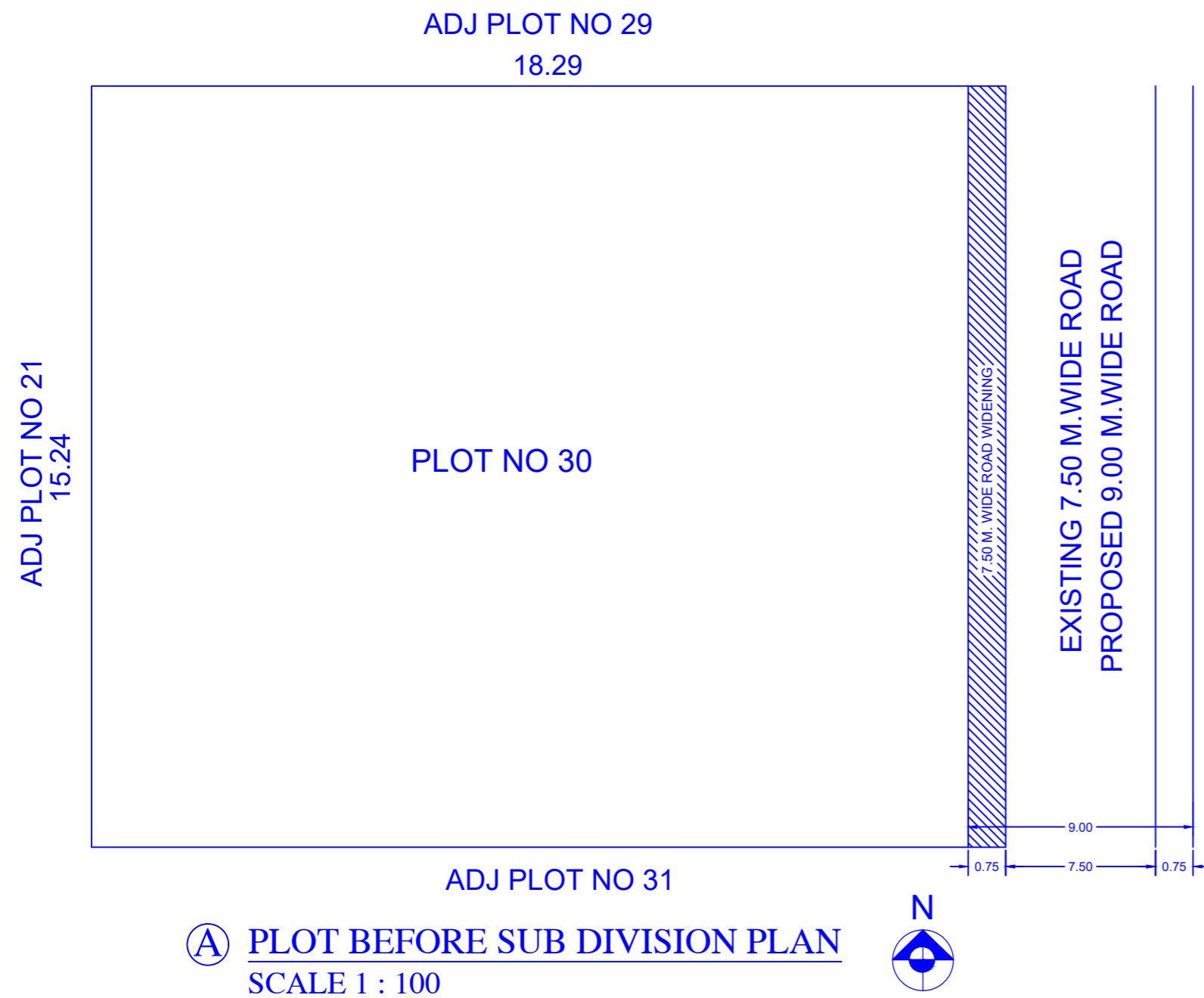

STAMP OF APPROVAL

PROPOSED SUB DIVISION AT PLOT NO. 30 S.NO. 245/28, MHASRUL SHIWAR NEAR MAKHMALABAD - MHASRUL LINK ROAD, PANCHAWATI, NASHIK. FOR GOPICHAND PUNDLIK WAGH & CHANDRAKANT RAMCHANDRA VIDHATE.

Approved For Amalgamations/Subdivision of Plots as Amended In Colour As Per Conditions Mentioned - 211/संशोधन In The Letter No. NMC/ADTP/ 129 Date 14/01/2022

[Signature]
Deputy Director of Town Planning
Nashik Municipal Corporation
Nashik

OWNER'S CONFIRMATION

I/we undersigned hereby confirm that I/we would abide by plans sanctioned by nashik municipal corporation. I/we would execute the structure as per sanctioned plans also. I/we would execute the work under supervision of proper technical person so as to ensure the quality and safety at the work site.

[Signature]
Sign of Owner

CERTIFICATE OF AREA:

Certified that the plot under reference was surveyed by me on 19/12/2021 and the dimensions of sides etc. of plot stated on plan are as measured on site and the area so worked out tallies with the area stated in document of Ownership/ T.P. Scheme Records /Land Records Department/City Survey records.

[Signature]
Signature
(Licensed Engineer.)

Er. RISHIKESH S. KSHIRSAGAR

SWAMI ASSOCIATES

BUILDING PLANNERS & PROJESCT CONSULTANT
OFFICE-10 ,WHITE HOUSE BUILDING, SHARANPUR-TRIMBAK
LINK ROAD OPP. ST. ANDRIYA CHURCH, NASHIK
MOB. - 9604909021.

Drawing No.	Scale	Drawn by	Checked by	Registration / License no. of Engineer
	As shown			reg.no.856834