

ISED SECOND FLOOR

MTS.

FLOOR - 131.81 - 37.19 SQ.MTS.
- 94.62 SQ.MTS.

MENT

AREA

MTS.

MTS.

MTS.

MTS.

MENT

ED 1/3	PROPOSED
TER	PERIMETER
MT.	31.40 RMT.

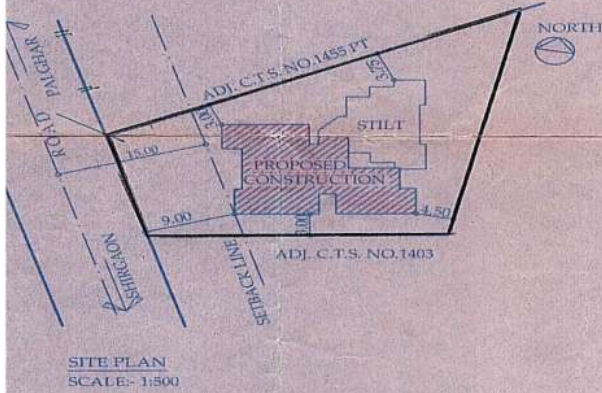

REMARKS OF APPROVAL

या कार्यालयाचे पत्र क्र. वि/रेज/कन/बां/मौ. पाळघर/ता. पाळघर/सि.स.नं. १०१६/नर पालघर/...२३६... दि. ०२/०२/११. मधील शर्तीना अधीन ररिवास।
रहून हिरव्या रंगाने दुरुस्ती सुचविल्याप्रमाणे 'ररिवास' व ररुघासमुख्य डुकामे वापरासाठी नकाशांना मंजूरीसाठी शिफारस.

(Signature)

नगर रचनाकार,
शाखा कार्यालय, पालघर.



Corporation Engineer
Municipal Council, Palghar

मंजूर

माहिती क्र. / पानप / बांधकाम / १२६/२०१०-१०११
दिनांक: ३०/०२/२०१० की ००५५ नवाबलवाड
वापरासाठी मंजूर / परवानगी मंजूर

(Signature)
नगर परिषद पाळघर

AREA STATEMENT		F.S.I. STATEMENT	
PLOT AREA STATEMENT	SQ.M.	F.S.I. STATEMENT	SQ.M.
TOTAL AREA OF LAND	788.10	F.S.I. ALLOWED	788.10
ALLOWED BUILT UP AREA	262.70	F.S.I. CONSUMED	
PROPOSED BUILT UP AREA	252.82	GROUND FLOOR	168.12
		FIRST FLOOR	252.82
		SECOND FLOOR	252.82
		RAISED SECOND FLOOR	94.62
		TOTAL	768.38
			768.38 < 788.10

NOTE :-
PLOT BOUNDARY SHOWN IN BLACK
PROP CONST SHOWN IN PINK
SEWAGE LINE SHOWN IN YELLOW

NOTE :-
1. ARCHITECTS/ENGINEERS ARE NOT RESPONSIBLE FOR COMMENCEMENT OF WORK BEFORE APPROVAL AND FOR ANY WORKS DEVIATING FROM THE ACTUAL APPROVED PLANS FROM THE COMPETENT AUTHORITIES.
2. THE DRAWINGS ARE PREPARED ON THE PROJECT AND DO NOT TAKE EFFECT FROM THE CLIENTS & THE ARCHITECTS HOLD NO RESPONSIBILITY FOR THE AUTHENTICITY OF THE DOCUMENTS.

NAME	SIGN.
1. SHRI. HIREN MANSUKHLAL SHAH	<i>(Signature)</i>
2. SHRI. ARPIT YOGESH SHAH	<i>(Signature)</i>
3. SHRI. RISHIL YOGESH SHAH	<i>(Signature)</i>
4. MRS. MITA YOGESH SHAH	<i>(Signature)</i>

SCHEDULE OF DOORS & WINDOWS		
TYPE	SIZE	DESCRIPTION
D	1.00 X 2.13	WATERPROOF FLUSH DOOR.
D1	0.90 X 2.13	COMMERCIAL FLUSH DOOR
D2	0.76 X 2.00	SYNTEX DOOR.
W	1.83 X 1.20	ALUMINIUM SLIDING WINDOW.
W1	1.20 X 1.20	ALUMINIUM SLIDING WINDOW.
V	0.60 X 0.90	ALUMINIUM LOUVERED VENTILATOR.
RS	2.40 X 2.40	M.S ROLLING SHUTTER

PROPOSED CONSTRUCTION OF A RESIDENTIAL AND COMMERCIAL BUILDING SITUATED ON LAND BEARING S.NO. 96/A, 1A/1A, H. NO. 6/2 PT. (C.T.S. NO. 1416) AT VILLAGE :- PALGHAR, TAL. :- PALGHAR, DIST. :- THANE.
FOR :- 1. SHRI. HIREN MANSUKHLAL SHAH
2. SHRI. ARPIT YOGESH SHAH
3. SHRI. RISHIL YOGESH SHAH
4. MRS. MITA YOGESH SHAH

DRG.No.	
SHEET No.	
OWNERS SIGN	<i>(Signature)</i>



ANNALS ASSOCIATE
CONSULTING ARCHITECTS & ENGINEERS
14, GIRIRAJ APARTMENT, KACHERI ROAD,
PALGHAR - 401 404.

E-MAIL ID :- annalsassociates@gmail.com